

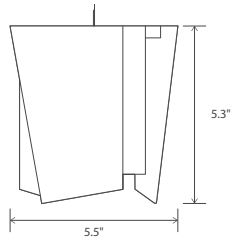

Levis AP, beech wood veneer

Levis
accent pendant



Dimensions: 5.3" Ø, 5.5" H
 Materials: polymer, veneer and aluminum options
 Product weight: 1 lb
 Energy efficient LED light source
 Light output: 345 Lumens (source)
 Light color: 2700 K (warm) or 3500 K (cool)
 Color accuracy: 90+ CRI
 LED power consumption: 3.2W
 Dimmable (see driver below)
 Driver location: must be housed in J-box
 Driver dimensions: 2" x 1.3" x 1", included
 Brushed aluminum (CM-006) Low-Profile Square Canopy included
 Canopy dimensions: 4.5" x 4.5", 0.38"
 Must use included external LED driver (2.25" x 1.5" x 1")
 Accent pendants can be clustered by using Multi-Point Round Canopy or Multi-Point Linear Canopy
 See website for more canopy information
 6'-0" drop length, field adjustable
 Suitable for a sloped ceiling
 Wood grain will vary
 Specifications subject to change

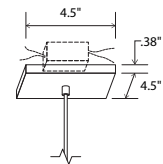

Levis low-profile square canopy



beech wood veneer (CM-019)



brushed aluminum (CM-012)



The Levis is simple and clean at first glance: complex upon closer review. The rhythm in the facets gives a dynamic feel from different vantage points, creating a sophistication to its presence.

Nick Sheridan
Designer

MATERIAL & FINISH OPTIONS

Levis accent part # 06-100-	-
Shade	
frosted polymer (CM-024)	F
beech wood veneer (CM-019)	B
brushed aluminum (CM-012)	A
Lamping	
2700 K LED	27
3500 K LED	35
Driver	
120 V AC input voltage	P1
ELV dimming only	

