

Project

Contact

Fill in the shaded boxes using the information listed below

Order Code **R-0065** - - - - - - -

Model **A** EXTERIOR SHADE FINISH **B** INTERIOR SHADE FINISH **C** LIGHT ENGINE DISC **D** LAMPING CCT **E** LIGHT OUTPUT **F** OPTION CODE

EXAMPLE ORDER CODE R-0065 - 049 - 117 - 095 - 30 - F - EM



Rincon ceiling mount, Brushed Brass exterior, Brushed Brass interior, Washed White Oak light engine disc, 3000K.



Textured White exterior, Textured White interior, Walnut light engine disc.



Textured Black exterior, Brushed Brass interior, Washed White Oak light engine disc.

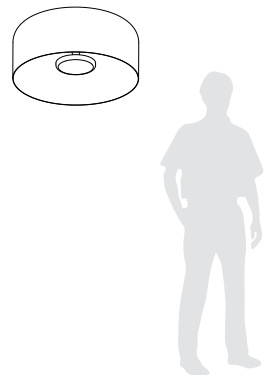
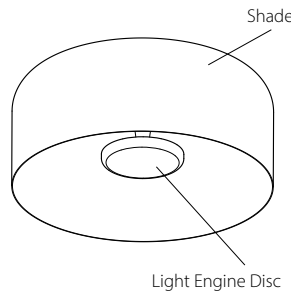
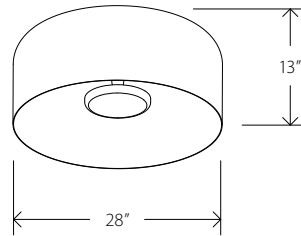

B EXTERIOR SHADE FINISH

- 049** Textured Black
- 060** Textured White
- 119** Brushed Aluminum
- 120** Brushed Brass
- 117** Distressed Brass

C INTERIOR SHADE FINISH

- 060** Textured White
- 119** Brushed Aluminum*
- 120** Brushed Brass*
- 117** Distressed Brass*

*finish will reduce delivered lumens

D LIGHT ENGINE DISC

- 001** Walnut
- 002** Dark Stained Walnut
- 095** White Washed Oak
- 049** Textured Black
- 060** Textured White
- 119** Brushed Aluminum
- 120** Brushed Brass
- 117** Distressed Brass

E LAMPING CCT

- 27** 2700K LED
 - 30** 3000K LED
 - 35** 3500K LED
 - 40** 4000K LED
- CRI 90+

Photometric Polar Graph

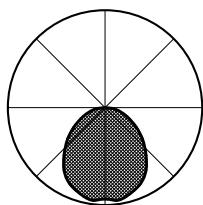

F LIGHT OUTPUT

- F** Full Output - Wattage
- R** 50% Reduced Output - Wattage
- C** Custom Reduction Percentage

Full output:
1945 Lumens (delivered)
30 Watts

Custom Reduction Percentage to reduce both lumens and wattage.

Full output based on Textured White shade interior with 3000K.

G OPTION CODE

EM Emergency Backup option.



Fixture Specs

Dimensions: 28" Ø x 13"
 Materials: Spun Aluminum Shade, Solid Wood or Spun Metal Accent,
 Protective Powder Coated Finishes
 Product weight: 19 lb
 Light source: Integrated LED
 Light output: 1945 Lumens (Textured White shade interior)
 Color accuracy: 90+ CRI

Driver Specs

120-277 VAC Input
 0-10V dimming down to 1% with dim to off
 LED driver integrated into fixture

Ⓐ EXTERIOR SHADE FINISH

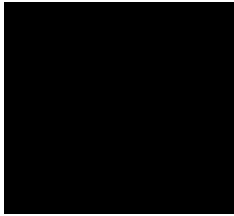

049
Textured Black
Powder Coat (CM-049)

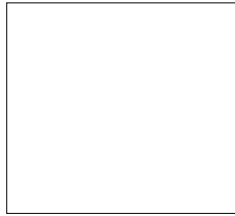

060
Textured White
Powder Coat (CM-060)



119
Brushed Aluminum
(CM-119)



120
Brushed Brass
(CM-120)



117
Distressed Brass
(CM-117)

Ⓑ INTERIOR SHADE FINISH

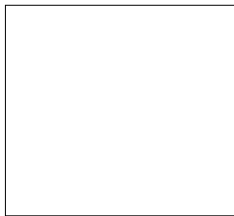

060
Textured White
Powder Coat (CM-060)



119
Brushed Aluminum
(CM-119)



120
Brushed Brass
(CM-120)



117
Distressed Brass
(CM-117)

Ⓒ LIGHT ENGINE DISC FINISH



001
Walnut (CM-001)

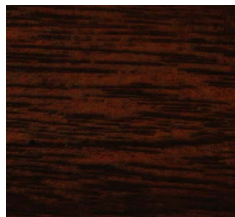

002
Dark Stained Walnut
(CM-002)



095
White Washed Oak
(CM-095)

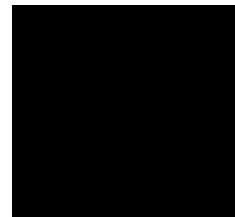

049
Textured Black
Powder Coat (CM-049)

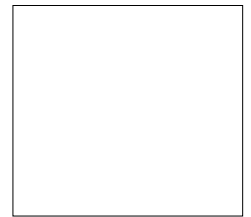

060
Textured White
Powder Coat (CM-060)



119
Brushed Aluminum
(CM-119)



120
Brushed Brass
(CM-120)



117
Distressed Brass
(CM-117)