

## Creo sconce

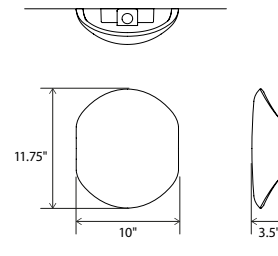

Dimensions: 11.75" x 10" x 3.5"  
 Product weight: 6 lb  
 Light source: integrated LED  
 Light output: see options below  
 Light color options: 2700 K, 3000 K, 3500 K, or 4000 K  
 Color accuracy: 90+ CRI  
 Power usage: 14 W  
 Dimmable (see options below)  
 UL listed for wet locations, suitable for use indoor and outdoors  
 Specifications subject to change



### MATERIAL & FINISH OPTIONS

Creo part # 03-245-

#### Shade Finish

Natural Terracotta (CM-125)

#### Lamping\*

2700 K LED  
 3000 K LED  
 3500 K LED  
 4000 K LED

#### Light Distribution and Driver Options

##### Uplight & Downlight

120-277 V AC input voltage  
 Standard output - 1130 Lumens (source)  
 120 V input - TRIAC, ELV & 0-10 V dimmable  
 240 & 277 V input - only 0-10 V dimmable

Reduced output - 540 Lumens (source)  
 Nondimmable

##### Downlight Only

120-277 V AC input voltage  
 Standard output - 1130 Lumens (source)  
 120 V input - TRIAC, ELV & 0-10 V dimmable  
 240 & 277 V input - only 0-10 V dimmable

Reduced output - 540 Lumens (source)  
 Nondimmable

J-box centered behind fixture

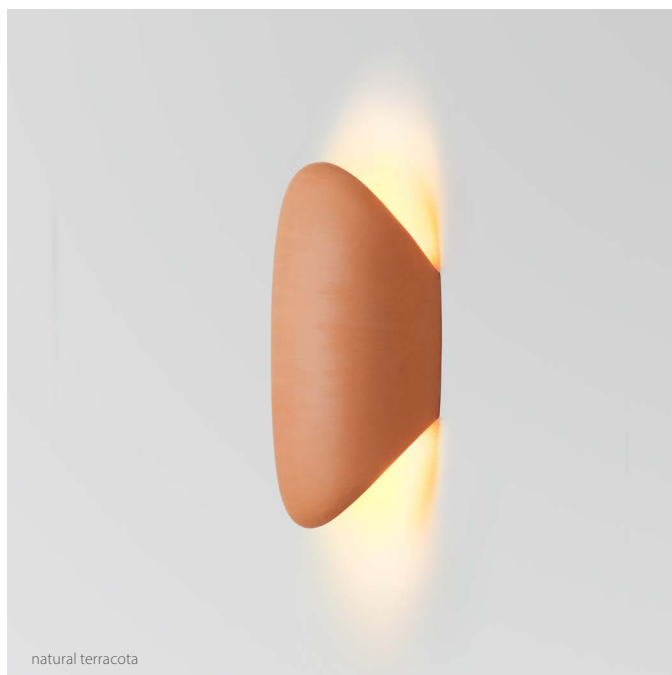
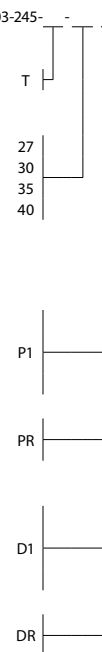

The Creo's ceramic shade is hand-crafted in Laguna Beach. The terracotta is unglazed, accentuating the clay's natural red earth coloring. The modern form works well in clean, minimalist outdoor and indoor environments as well as in more transitional spaces. Inspired by nature and designed to handle the elements.

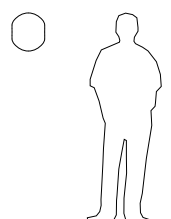

**⚠ WARNING.** California Proposition 65 Warning for California Consumers. This product can expose you to chemicals including wood dust and lead which are known to the State of California to cause cancer or birth defects or other reproductive harm. For more information go to [www.P65Warnings.ca.gov](http://www.P65Warnings.ca.gov)