

Project

Contact

Fill in the shaded boxes using the information listed below

Order Code

**R-0065**

MODEL

**(A)** EXTERIOR  
SHADE FINISH

**(B)** INTERIOR  
SHADE FINISH

**(C)** LIGHT  
ENGINE DISC

**(D)** LAMPING CCT

**(E)** LIGHT  
OUTPUT

**(F)** OPTION  
CODE

EXAMPLE  
ORDER CODE

R-0065

049

117

095

30

F

EM



Rincon ceiling mount, Brushed Brass exterior, Brushed Brass interior, Washed White Oak light engine disc, 3000K.

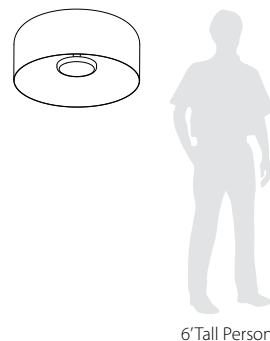
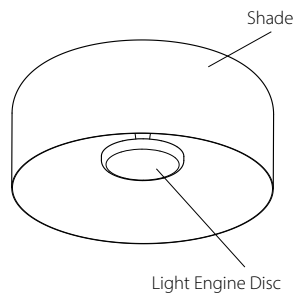
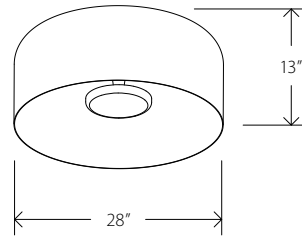

### **(A)** EXTERIOR SHADE FINISH

- 049** Textured Black
- 060** Textured White
- 119** Brushed Aluminum
- 120** Brushed Brass
- 117** Distressed Brass

### **(B)** INTERIOR SHADE FINISH

- 060** Textured White
- 119** Brushed Aluminum\*
- 120** Brushed Brass\*
- 117** Distressed Brass\*

\* Finish will reduce delivered lumens

### **(C)** LIGHT ENGINE DISC

- 001** Walnut
- 002** Dark Stained Walnut
- 095** White Washed Oak
- 049** Textured Black
- 060** Textured White
- 119** Brushed Aluminum
- 120** Brushed Brass
- 117** Distressed Brass

### **(D)** LAMPING CCT

- 27** 2700K LED
- 30** 3000K LED
- 35** 3500K LED
- 40** 4000K LED

CRI 90+



Textured White exterior, Textured White interior, Walnut light engine disc.



Textured Black exterior, Brushed Brass interior, Washed White Oak light engine disc.

### **(E)** LIGHT OUTPUT

- F** Full Output - Wattage
- R** 50% Reduced Output - Wattage
- C** Custom Reduction Percentage

Full output:  
1945 Lumens (delivered)  
30 Watts

Custom Reduction  
Percentage to reduce  
both lumens and  
wattage.

Full output based on  
Textured White shade  
interior with 3000K.

### **(F)** OPTION CODE

**EM** Emergency Backup option.

### PHOTOMETRIC POLAR GRAPH

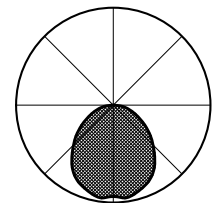

FIXTURE SPECS

Dimensions: 28" Ø x 13"  
Materials: Spun Aluminum Shade, Solid Wood or Spun Metal Accent,  
Protective Powder Coated Finishes  
Product weight: 19 lb  
Light source: Integrated LED  
Light output: 1945 Lumens (Textured White shade interior)  
Color accuracy: 90+ CRI

DRIVER SPECS

120-277 VAC Input  
0-10V dimming down to 1% with dim to off  
LED driver integrated into fixture

Ⓐ EXTERIOR SHADE FINISH

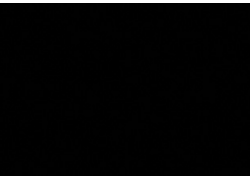

Textured Black Powder Coat  
CM-049

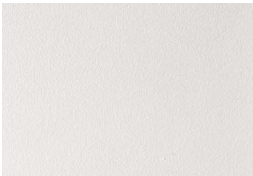

Textured White Powder Coat  
CM-060



Brushed Aluminum  
CM-119



Brushed Brass  
CM-120



Distressed Brass  
CM-117

Ⓑ INTERIOR SHADE FINISH

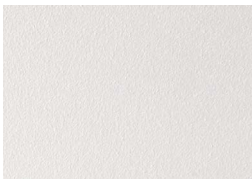

Textured White Powder Coat  
CM-060



Brushed Aluminum  
CM-119



Brushed Brass  
CM-120



Distressed Brass  
CM-117

Ⓒ LIGHT ENGINE DISC FINISH



Walnut  
CM-001



Dark Stained Walnut  
CM-002



White Washed Oak  
CM-095

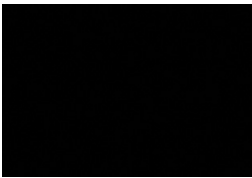

Textured Black Powder Coat  
CM-049



Textured White Powder Coat  
CM-060

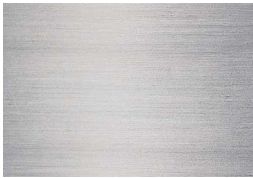

Brushed Aluminum  
CM-119

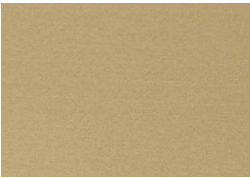

Brushed Brass  
CM-120



Distressed Brass  
CM-117