

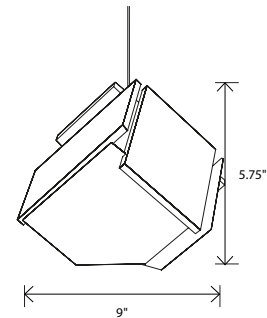

The Mica is simply a cube, which has been carefully deconstructed to a sculptural state. By way of the fixture's orientation and petal material composition, it exudes a certain organic symmetry. The Mica accent pendant acts as a beautiful node, creating a sense of space marked with an ambient glow.

Nick Sheridan,
Designer

Mica S accent pendant



Dimensions: 9" Ø, 5.75"
 Materials: solid wood, polymer
 Product weight: 3 lb
 Light source: integrated LED
 Light output: 915 Lumens (source), based on 2700K
 Light color*: 2700 K or 3500 K
 Color accuracy: 90+ CRI
 Power usage: 9 W
 Dimmable: 0-10 V dimming at 120-277 V AC
 TRIAC and ELV dimming at 120 V AC only
 Driver location: must be housed in J-box
 Driver dimensions: 3.3" x 1.6" x 1.0"
 Brushed aluminum (CM-006) low-profile square canopy with white braided cord included
 Canopy dimensions: 4.5" x 4.5", 0.38"
 External LED driver (3.3" x 1.6" x 1.0")
 Accent pendants can be clustered by using multi-point round canopy or multi-point linear canopy
 See website for more canopy information
 6'-0" drop length, field adjustable
 Suitable for a sloped ceiling
 Wood grain will vary
 Specifications subject to change

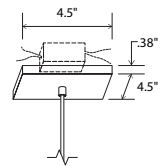

low-profile square canopy



walnut (CM-001)

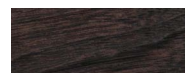

dark stained walnut (CM-002)

MATERIAL & FINISH OPTIONS

	Mica part # 06-160-
Wood Body	
walnut (CM-001)	W
dark stained walnut (CM-002)	D
Lamping*	
2700 K LED	27
3500 K LED	35
Driver	
120 V AC input voltage	P1
TRIAC, ELV, or 0-10 V dimmable	

Includes: frosted polymer (CM-024)

*Available in 3000K, 4000K and other color temperatures upon request

