



dark stained walnut



walnut



Mica accent pendant

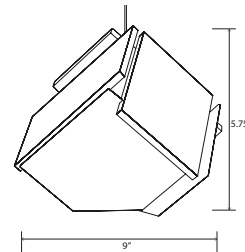

Dimensions: 9" Ø, 5.75"
 Materials: solid wood, polymer
 Product weight: 3 lb
 Light source: integrated LED
 Light output: 915 Lumens (source), based on 2700K
 Light color*: 2700 K or 3500 K
 Color accuracy: 90+ CRI
 Power usage: 9 W
 Dimmable: 0-10 V dimming at 120-277 V AC
 TRIAC and ELV dimming at 120 V AC only
 Driver location: must be housed in J-box
 Driver dimensions: 3.3" x 1.6" x 1.0"
 Brushed aluminum (CM-006) low-profile square canopy with white braided cord included
 Canopy dimensions: 4.5" x 4.5", 0.38"
 External LED driver (3.3" x 1.6" x 1.0")
 Accent pendants can be clustered by using multi-point round canopy or multi-point linear canopy
 See website for more canopy information
 6'-0" drop length, field adjustable
 Suitable for a sloped ceiling
 Wood grain will vary
 Specifications subject to change

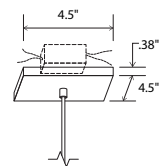

low-profile square canopy



MATERIAL & FINISH OPTIONS

Mica part # 06-160-

Wood Body
 walnut (CM-001)
 dark stained walnut (CM-002)

Lamping*
 2700 K LED
 3500 K LED

Driver
 120 V AC input voltage
 TRIAC, ELV, or 0-10 V dimmable

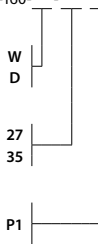

walnut (CM-001)

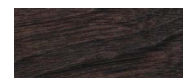

dark stained walnut (CM-002)

Includes
 frosted polymer (CM-024)

*Available in 3000K, 4000K and other color temperatures upon request

The Mica is simply a cube, which has been carefully deconstructed to a sculptural state. By way of the fixture's orientation and petal material composition, it exudes a certain organic symmetry. The Mica accent pendant acts as a beautiful node, creating a sense of space marked with an ambient glow.

Nick Sheridan,
 Designer

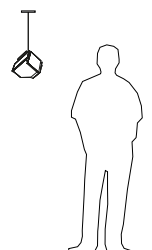

▲WARNING. California Proposition 65 Warning for California Consumers. This product can expose you to chemicals including wood dust and lead which are known to the State of California to cause cancer or birth defects or other reproductive harm. For more information go to www.P65Warnings.ca.gov