



Brevis 42, brushed aluminum



Brevis 28, brushed aluminum



Brevis 28, brushed aluminum, close detail

A clean, minimal fixture finely executed. With multiple down and up lights, the Brevis provides lots of usable light in a very unobtrusive design.

Nick Sheridan
Designer

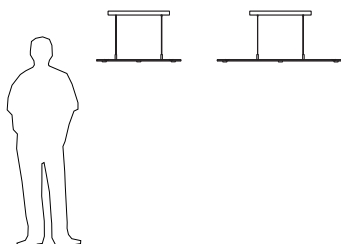

Brevis 28 / 42

linear pendant

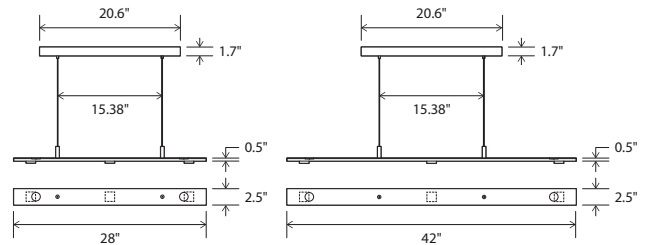

Brevis 28 dimensions: 28" x 2.5", 0.5"

Brevis 42 dimensions: 42" x 2.5", 0.5"

Materials: aluminum, polymer

Brevis 28 weight: 7 lb

Brevis 42 weight: 8 lb

Light source: integrated LED

Light output - total: 1720 Lumens (source)

Light output - downlight: 1030 Lumens (source)

Light output - uplight: 690 Lumens (source)

Light color: 2700 K or 3500 K

Color accuracy: 90+ CRI

Power usage: 16 W

Dimmable (see driver below)

Linear canopy included

Canopy dimensions: 20.6" x 4.6" X 1.7"

Canopy color matches fixture's metal color

Wood canopy covers are available:

Walnut (CM-001) cover: part # 60-241-001W

Dark Stained Walnut (CM-002) cover: part # 60-241-001D

White Washed Oak (CM-095) cover: part # 60-241-001O

See website for more canopy information

6'-0" drop length, field adjustable

Suitable for a sloped ceiling

Specifications subject to change

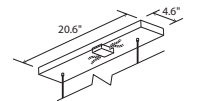

linear canopy, brushed aluminum



brushed aluminum (CM-006)



flat black (CM-030)

MATERIAL & FINISH OPTIONS

	Brevis part # 06-
Size	
Brevis 28	920
Brevis 42	910
Metal Finish	
brushed aluminum (CM-006)	A
flat black (CM-030)	B
Lamping*	
2700 K LED	27
3500 K LED	35
Driver	
AC Input Voltage Range: 120-277 V	
120 V input: TRIAC, ELV & 0-10 V dimmable	P1
240 & 277 V input: only 0-10 V dimmable	

Includes: white polymer shade (CM-052)

*Available in 3000K, 4000K and other color temperatures upon request