

# Cerno Art Light - Standard Mount

Installation Instructions

cerno®

## General Product Information

This product is suitable for indoor dry and damp locations only.

THIS IS A LOW VOLTAGE (24VDC) FIXTURE AND MUST BE USED WITH THE SUPPLIED OR MANUFACTURER APPROVED POWER SUPPLY



### CAUTION - RISK OF FIRE



The hardwire version requires installation by a qualified electrician. Before installing be sure to read all instructions and TURN POWER OFF TO THE JUNCTION BOX.

Dimmable Version Only:

This fixture is only compatible with TRIAC, ELV, and 0-10V dimming.

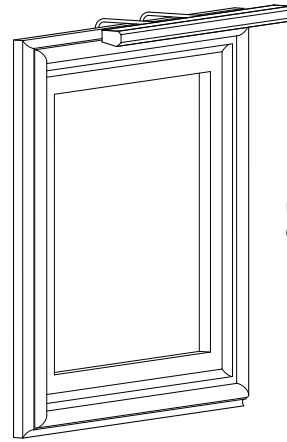

US Patent # 7,070,293 and 9,134,004.  
Other US and International Patents Pending

## Installing the Mounting Bracket

- 1 Attach the plastic mounting bracket and reinforcement bracket to the back of the frame using the supplied #8 panhead screws.
- 2 If necessary, use the included spacers to ensure that when the mounting arms are slid into the bracket, they will be clear of any obstructions on the back of the frame and canvas.

Alternatively, if desired, the mounting bracket can be attached to the wall behind the artwork.

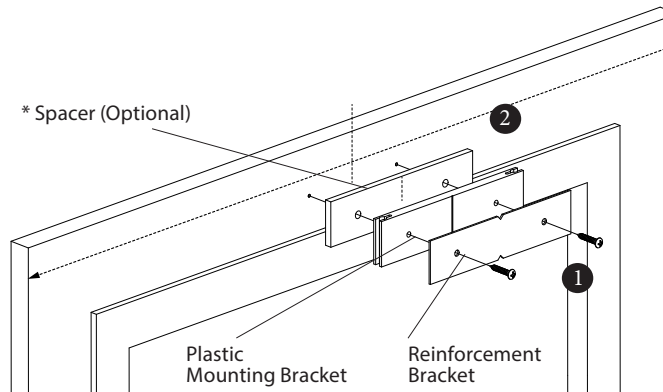

## Installing Fixture to the Mounting Bracket

- 3 Attach the fixture to the mounting bracket by sliding the arms vertically into the mounting bracket. Do not snap the mounting arms into sides!
- 4 Adjust the height of the fixture and level it by sliding the mounting arms up or down in the slots in the mounting bracket. The bottom of the fixture should be about 4 inches above the top edge of the canvas.

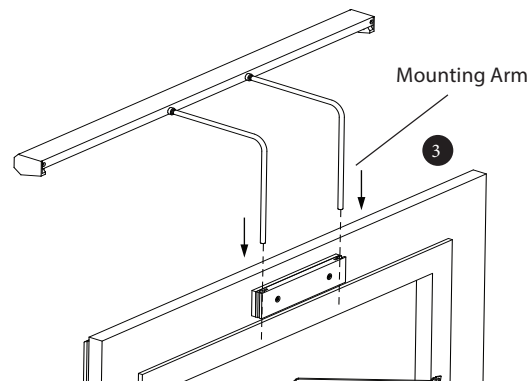
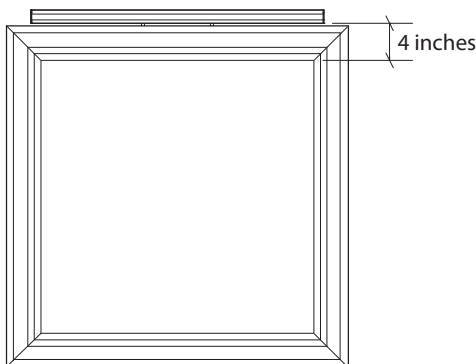

## Electrical Connections

### 5 For Plug-In Version Only

The included plug-in power supply and in-line rocker switch can be mounted to the wall behind the painting, attached to the back of the frame, or installed remotely.

### 6 For Hardwired Version Only:

A junction box is required to place the power supply and electrical connections. A 4in square deep junction box is recommended. Use wire nuts to make the connections between the undimmed line voltage wires and the power supply. Use wire nuts or the provided low voltage connectors to make the electrical connections between the low voltage output wires and the fixture leads.

### 5 Plug-In Version

PLUG-IN  
Standard Mount Only

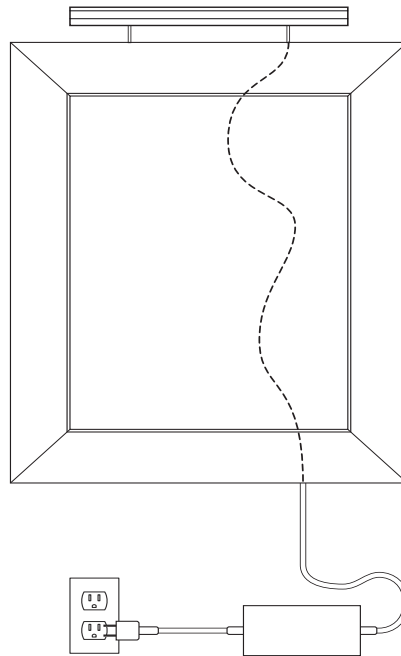
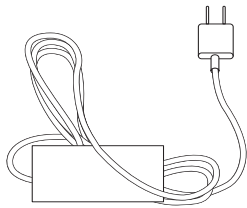

### 6 Hardwired Version

HARDWIRE  
Standard or Direct Wire Mount

j-box by  
others

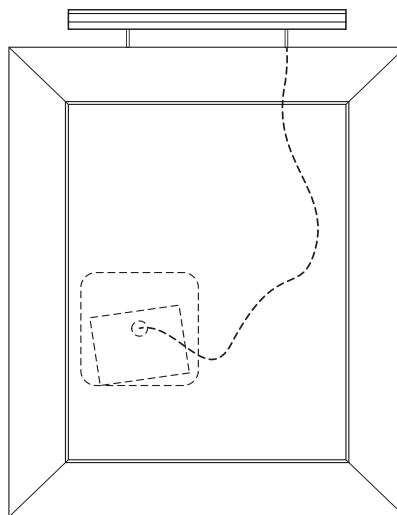
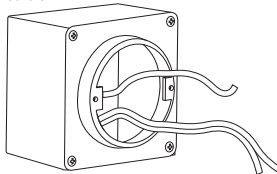

## WARNING

CONNECTING THE FIXTURE DIRECTLY TO LINE VOLTAGE WILL DESTROY IT AND VOID THE WARRANTY!

MAKE SURE THAT THE RED WIRE IS CONNECTED TO THE POSITIVE (+) LEAD ON THE POWER SUPPLY, AND THE BLACK WIRE IS CONNECTED TO THE NEGATIVE (-) or GROUND LEAD ON THE POWER SUPPLY.

For Hardwired Version Only:

(Dimmable Version Only)

In addition to TRIAC and ELV phase dimming, the fixture can alternatively be controlled by connecting the purple and grey/pink wires to a dimmer or control system that uses the industry standard 0-10V dimming interface. More than one fixture can be attached to the same dimmer. Dimmers should be installed by a licensed electrician and in accordance with the manufacturer's instructions. The wiring diagram for using 0-10V dimming is shown below. If 0-10V dimming is not being used, cap the 0-10V dimming leads separately.

### 7 Hardwired Version Continued

#### Hardwire Wiring Diagram Using a Remote 0-10V Dimmer Switch or Control System

