

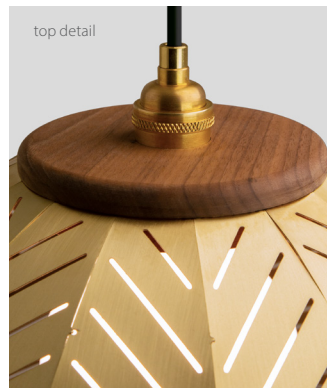

distressed brass, walnut



distressed brass, under view



top detail

Amicus 16 pendant

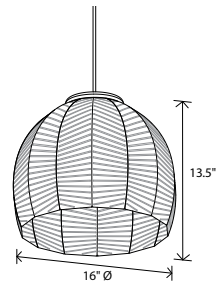

Dimensions: 15.8" Ø, 13.5"
Product weight: 4 lb
Suitable for a sloped ceiling

Integrated LED Specifications

Light output: 915 Lumens (source), based on 2700 K
Light color: 2700 K, 3500 K (other color temperatures available upon request)
Color accuracy: 90+ CRI
Power usage: 9 W
Dimmability: TRIAC, ELV & 0-10 V dimming

E26 Medium Base Specifications

Lamping: E26 base, 60 W max, G40 recommended
Bulb not included
Input voltage: 250 V AC max

Textured Black Powdercoat (CM-049) Canopy with SVT-3 Cord, Black (CM-039)
Two canopy options included: round extended canopy and round low profile canopy
Canopy dimensions:
Low Profile Canopy Dimensions: 5" Ø, 0.3"
Extended Canopy Dimensions: 5.5" Ø, 2"
Field adjustable drop length: 0'6" min - 8'0" max

Wood grain will vary
Specifications subject to change
Suitable for dry or damp locations



MATERIAL & FINISH OPTIONS

Amicus 16 part # 06-290-16

Metal Shade

brushed brass (CM-047)
distressed brass (CM-096)
brushed aluminum (CM-012)
brushed rose gold (CM-046)
black powder coat (CM-049)
white powder coat (CM-060)

Wood Top

walnut (CM-001)
dark stained walnut (CM-002)
white washed oak (CM-095)

Lamping

2700 K LED
3500 K LED
medium base E26 socket

Power Option (LED version only)

120-277 V AC input voltage
TRIAC, ELV, and 0-10V dimming

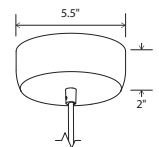
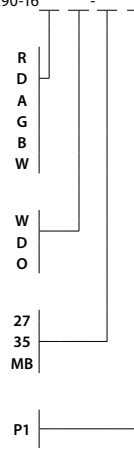

round extended canopy

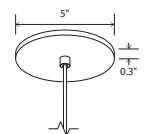

round low profile canopy



brushed brass (CM-047)



distressed brass (CM-096)



brushed aluminum (CM-012)



brushed rose gold (CM-046)



black powder coat (CM-049)

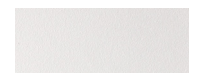

white powder coat (CM-060)

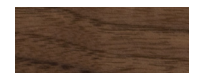

walnut (CM-001)

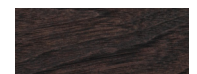

dark stained walnut (CM-002)



white washed oak (CM-095)

Traveling through Morocco, I was in awe of the skilled craftspeople and their impressive work. I was most enamored with the detail and intricacy of the perforated metal light fixtures. The artistry, patterns, and old-world techniques inspired me and ultimately inspired the Amicus.

*Nick Sheridan,
Designer*

