

cerno®



D E S I G N E D A N D M A D E I N C A L I F O R N I A



BELIEF

With no backyards but access to beaches and idyllic doses of salt and sun, our business story began with the adventures of three boys.

Laguna Beach's creative culture and natural environment shaped our professional and aesthetic ideals. Looking back it's now clear that our childhood projects and experiments grew into our best adventure yet: building Cerno.

THE BEGINNING



*Cerno founders, 1998. Left to right:
Nick Sheridan, Dan Wacholder, Bret Englander.*

Our drive and influences come from many different sources. One source that influenced all of us is Daniel's late grandfather, Steve. Steve grew up on a remote homestead where the existence of most objects depended on people's ability to create and fix them. For all of his 101 years, he embodied the saying "where there's a will, there's a way." On the California coast we were raised with this mentality and today we share it with the rest of the Cerno team.

CERNO

- Verb (Latin)

1. To resolve, distinguish, decide, sift, determine, to perceive.





OUR TEAM

Each finished product is a celebration of the inventive minds and industrious hands that brought it to life. Dreams do not manifest themselves; skilled people bring dreams to life. The passion of our steadily growing team and their commitment to the product is inspiring. We are grateful for every individual that is part of our collaborative creative process.

Table of Contents

Floor	9	Plura	65
Fons 8 / Fons 10	10	Ceiling Mount	67
Valeo	11	Casia 14	68
Nauta Floor	14	Casia 18	69
Altus	15	Casia 22	71
Forma Floor	16	Plura	73
Silva Giant	18	Outdoor Sconces	75
Linear Pendants	21	Tersus Outdoor	76
Lenis	23	Calx Outdoor	77
Arca	24	Ansa Outdoor	78
Camur	25	Acuo Outdoor	79
Aeris 30 / Aeris 54	27	Creo Outdoor	80
Vix 34 / Vix 48	29	Dea Outdoor	81
Vix 82	30	Vanity	83
Penna 40 / Penna 64	31	Allavo	84
Virga	32	Merus	85
Brevis 28 / Brevis 42	33	Sconces	87
Pendants	35	Talea	89
Amicus 12	36	Via	90
Amicus 16	37	Calx	91
Amicus 21	39	Penna 16 / Penna 40 / Penna 64	92
Casia 14	40	Vesper	93
Casia 18	41	Acuo	94
Casia 22	42	Capio S / Capio L	96
Abeo	43	Oris	97
Cano	44	Tersus	100
Bimar	45	Sedo	101
Muto	46	Ansa	103
Astrum 11	47	Fortis	104
Astrum 17	49	Claudo	105
Imber 17 / Imber 24	50	Libri	107
Ignis 17 / Ignis 24	51	Levo / Levo Shelf Option	109
Ico	53	Table	111
Calx 10 / Calx 19	54	Forma Table	112
Calx 36	55	Nauta Table	113
Veris 12	56	Adesse	114
Veris 22	57	Revelite AL	117
Veris 34	59	Accessories	118
Levis / Levis L	60	Motus Swing Arm Bracket	118
Mica / Mica L	61	Canopy Accessories	118
Claudo	62	Finish and Material Options	119
Salix	63		



Floor



Fons Family



Valeo



Silva Giant



Altus



Forma

Fons 8 / Fons 10
floor

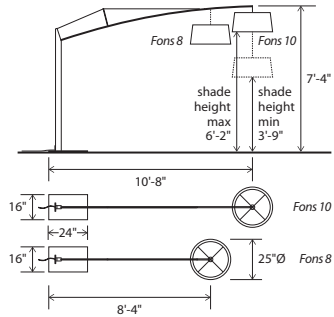

Dimensions: 25" Ø shade, 7'-4"
Materials: solid wood, metal, linen shade
Product weight: 65 lb
Light source: medium base E26 socket
Lamping: E26 base, type A lamp, 60 W max
Input voltage: 120 V AC max
Includes 6'-0" clear silver cord with
inline foot switch 24" from base
Bottom diffuser included (CM-051)
Wood grain will vary
Specifications subject to change



Included dimmable LED A19 bulb
Light output: 800 Lumens (source)
Light color: 2700 K
Color accuracy: 90+
Power usage: 11 W

MATERIAL & FINISH OPTIONS

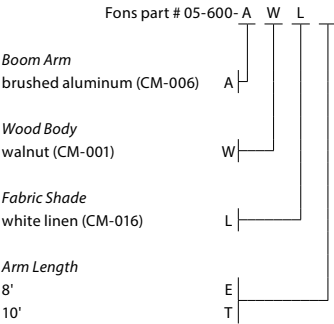

Includes
stainless steel tension cable (CM-053)
black powder coated steel base (CM-049)
frosted polymer diffuser (CM-051)

Alternate voltage/plug styles are available



ARM LENGTH
Available in 10'-8" and 8'-4" arm lengths
Arm length is from back of base to center of shade
Arm lengths are not adjustable

SHADE HEIGHT
Shade height (floor to bottom edge of shade) can be adjusted between 6'-2" maximum and 3'-9" minimum.

The goal with the Fons was to minimize the structure and visual massing of the fixture while maximizing the reach or cantilever. The delicate boom arm, upheld by a tension cable, gently bends while reaching out to almost horizontal where it suspends the light. The structural design is an extremely effective way to resolve the forces associated with such a long reach. It is so effective and efficient that it seems to float with a weightlessness at the tip.

Nick Sheridan
Designer

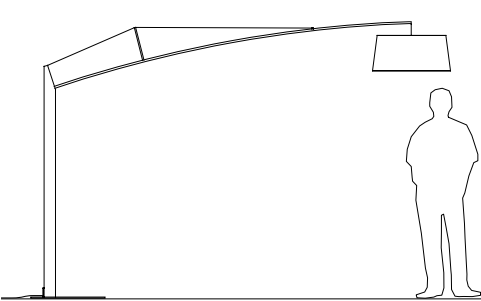

When reaching such a distance with a fixture, it is important that it feels visually efficient in its form but is still far from fragile, inviting one to linger under it. The adjustability in the reach and the height of the shade make it possible to custom fit the piece to its surroundings - an important characteristic for such a large piece.

Nick Sheridan
Designer



Valeo
floor

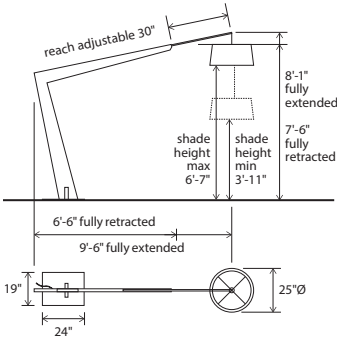

Dimensions: 8'1" H max, 25" Ø shade
Materials: solid wood, metal, linen shade
Product weight: 95 lb
Light source: medium base E26 socket
Lamping: E26 base, type A lamp, 60 W max
Input voltage: 120 V AC max
Includes 72" clear silver cord with
inline foot switch 24" from base
Bottom diffuser included (CM-051)
Wood grain will vary
Specifications subject to change



Included dimmable LED A19 bulb
Light output: 800 Lumens (source)
Light color: 2700 K
Color accuracy: 90+ CRI
Power usage: 11 W

MATERIAL & FINISH OPTIONS

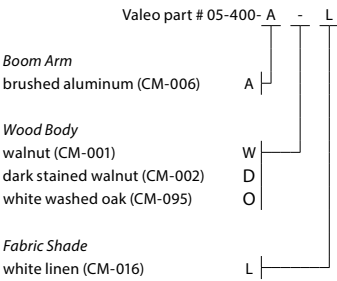

Includes
textured black powdercoated base (CM-049)
frosted polymer diffuser (CM-051)

Alternate voltage/plug styles are available

ARM LENGTH
Arm length (from back of base to center of shade) can be adjusted between 9'-6" maximum and 6'-6" minimum.

SHADE HEIGHT
Shade height (floor to bottom edge of shade) can be adjusted between 6'-7" maximum and 3'-11" minimum.

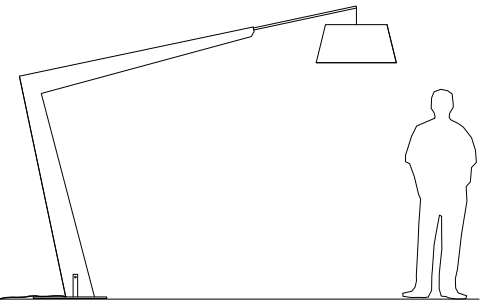



in collaboration with
DESIRON FRANK CARFARO
HAND CRAFTED AMERICAN FURNITURE

Nauta Floor
floor

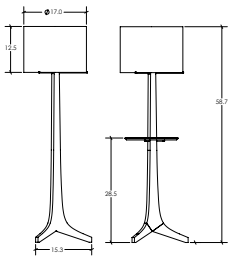

Dimensions: 17" Ø, 59"
Materials: solid wood, aluminum, fabric shade
Product weight: 8 lb
Light source: medium base E26 socket
Lamping: E26 base, 60 W max
Input voltage: 250 V AC max
Includes 8' clear silver cord with white plug
On/Off rocker switch on socket
Wood grain will vary
Specifications subject to change
SHELF IS OPTIONAL
UL
E100
Included dimmable LED A19 bulb
Light output: 800 Lumens (source)
Light color: 2700 K
Color accuracy: 90+ CRI
Power usage: 11 W

MATERIAL & FINISH OPTIONS

Nauta Floor part #: 05-110-

Metal Finish

brushed aluminum (CM-006)
brushed brass (CM-120)

Wood Body

walnut (CM-001)
dark stained walnut (CM-002)
white washed oak (CM-095)

Shade

black amaretto (CM-018)
white linen (CM-016)
burlap (CM-017)

Optional Shelf Accessory

no shelf
matching wood shelf -
exposed wood top surface
matching wood shelf -
black HPL top surface (CM-092)
matching wood shelf -
white HPL top surface (CM-093)

** Shelf is optional and cannot be removed
by customer



walnut, brushed aluminum, burlap



walnut, brushed aluminum, white linen



walnut, brushed brass, black amaretto



walnut, brushed aluminum, burlap, black shelf

Efficiency and simplicity guided the design process for the Nauta table lamp. We designed the Forma several years ago with Frank Carfaro of Desiron, which profoundly influenced the Nauta's form. Our goal was to distill the Forma design without compromising it. The Nauta is clean, modern, and priced competitively.

Nick Sheridan
Designer

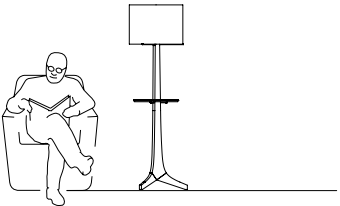

Altus, walnut body, distressed brass metal finish, white linen shade



The Altus is a robust fixture that also carries an air of elegance and subtle proportion. It has the mass and impact to anchor a space while still showing balance and grace. It is always exciting to see how the solid wood trunk comes out; admiring the wood grain all the way through.

Nick Sheridan
Co-Designer

Altus
floor

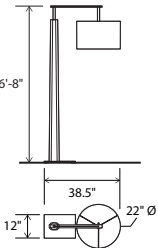

Dimensions: 6'-8" H, 22" Ø shade
Materials: solid wood, metal, fabric shade
Product weight: 45 lb
Light source: medium base E26 socket
Lamping: E26 base, type A lamp, 60 W max
120 V AC max
Dimmable on fixture
Wood grain will vary
Specifications subject to change
UL
E100

Included dimmable LED A19 bulb
Light output: 800 Lumens (source)
Light color: 2700 K
Color accuracy: 90+ CRI
Power usage: 11 W

MATERIAL & FINISH OPTIONS

Altus part # 05-700-

Metal Finish

brushed brass (CM-008)
distressed brass (CM-009)
oiled bronze (CM-010)

Wood Body

walnut (CM-001)
dark stained walnut (CM-002)

Fabric Shade

burlap (CM-017)
white linen (CM-016)
black amaretto (CM-018)

Alternate voltage/plug styles are available

in collaboration with
DESIRON FRANK CARFARO
HAND CRAFTED AMERICAN FURNITURE

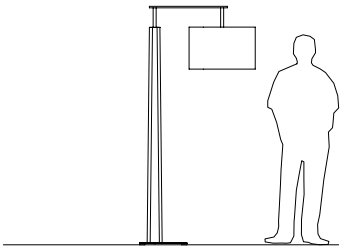

in collaboration with
DESIRON FRANK CARFARO
HAND CRAFTED AMERICAN FURNITURE

Forma
floor

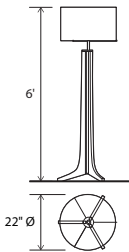

Dimensions: 22" Ø shade, 6'
Materials: solid wood, aluminum, fabric shade
Product weight: 15 lb
Light source: medium base E26 socket
Lamping: E26 base, type A lamp, 60 W max
Input voltage: 120 V AC max
Dimmable on fixture
Wood grain will vary
Specifications subject to change



Included dimmable LED A19 bulb
Light output: 800 Lumens (source)
Light color: 2700 K
Color accuracy: 90+ CRI
Power usage: 11 W

MATERIAL & FINISH OPTIONS

Forma Floor part # 05-300-

Metal Finish

brushed aluminum (CM-006) A
black anodized aluminum (CM-007) B

Wood Body

walnut (CM-001) W
dark stained walnut (CM-002) D
maple (CM-005) M

Fabric Shade

burlap (CM-017) N
white linen (CM-016) L
black amaretto (CM-018) A

Alternate voltage/plug styles are available
Also available in smaller version



Forma, brushed aluminum, walnut, burlap shade



Frank Carfaro and I worked to design a piece that embraced both Cerno and Desiron's aesthetic, without deviating too much from either brand's design language. I am really pleased with the fluidity, posture and scale we achieved with the Forma.

Nick Sheridan
Co-Designer

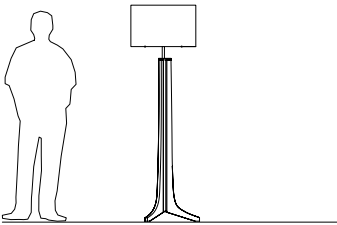

Silva Giant
floor

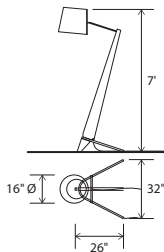

walnut
(CM-001)



dark stained walnut
(CM-002)

Dimensions: 32" x 26", 7", 16" Ø shade
Materials: solid wood, aluminum, linen shade
Product weight: 60 lb
Light source: medium base E26 socket
Lamping: E26 base, type A lamp, 60 W max
Input voltage: 120 V AC max
Includes 72" clear silver cord with
inline foot switch 24" from base
Bottom diffuser included (CM-057)
Wood grain will vary
Specifications subject to change



Included dimmable LED A19 bulb
Light output: 800 Lumens (source)
Light color: 2700 K
Color accuracy: 90+ CRI
Power usage: 11 W

MATERIAL & FINISH OPTIONS

	Silva Giant part # 05-200-	A	L
Metal Finish	brushed aluminum (CM-006)	A	L
Wood Body	walnut (CM-001)	W	
		D	
Fabric Shade	white linen (CM-058)	L	

Alternate voltage/plug styles are available
Also available in 2 smaller versions



Silva Giant, brushed aluminum, walnut body, white linen shade

The Silva Giant, as the name suggests, is a giant version of our Silva table fixture. Its scale gives it a strong presence even in very large spaces, while its distilled form gives it a simplicity that can be seen from across the room. A fun piece with a huge personality.

Nick Sheridan
Designer

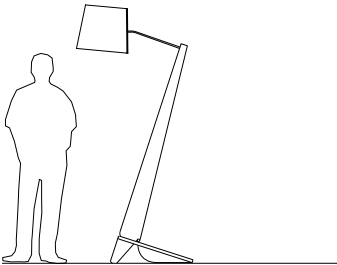

Linear Pendants



Lenis



Lenis



Vix



Vix

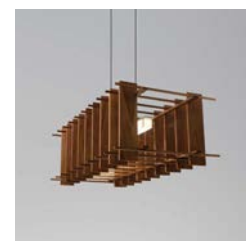

Arca



Camur



Penna Pendant



Vix 82



Aeris



Aeris



Virga



Brevis



Lenis, brushed aluminum



Bret, Dan and I have always loved the ocean and boats. In fact, the first project we built together as young boys was a sailboat. Our appreciation for the beauty of a well-designed craft is what initially inspired the Lenis fixture; the form is created by bending wood stringers over a series of bulkheads. The organic and sculptural structure deviates from our mostly rectilinear forms, which introduced many new challenges, yet it also breathed new life into the design process for us. Ultimately, we were searching for that balance between the curved fluidity of its lines and the twisting movement. Thanks to our team's determination, after countless studies and prototypes, we found the balance we were looking for.

Nick Sheridan,
Designer

Lenis linear pendant

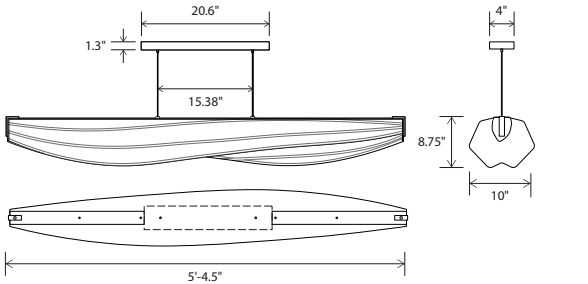

Dimensions: 5'-4.5" x 10", 8.75"
Materials: aluminum, stretch fabric
Product weight: 10 lb
Light source: integrated LED
Light output: 5000 Lumens (source)
Light color*: 2700 K or 3500 K
Color accuracy: 90+ CRI
Power usage: 70 W
Dimmable (see driver below)
Brushed Aluminum (CM-006)
linear canopy included
Canopy dimensions: 20.6" x 4", 1.3"
Wood canopy covers are available:
Walnut (CM-001) cover:
part # 60-130-005W
Dark stained walnut (CM-002) cover:
part # 60-130-005D
See website for more canopy information
72" drop length, field adjustable
Suitable for a sloped ceiling
Wood grain will vary
Specifications subject to change
Patent No.: US D857,968 S



MATERIAL & FINISH OPTIONS

Lenis part # 07-220-	
Shade	
white fabric (CM-079)	L
End Detail	
brushed aluminum (CM-006)	A
dark stained walnut (CM-002)	D
walnut (CM-001)	W
Lamping*	
2700 K LED	27
3500 K LED	35
Driver	
120 V AC input voltage	P1
TRIAC, ELV & 0-10 V dimming	
277 V AC input voltage	P2
TRIAC, ELV & 0-10 V dimming	

Includes
brushed aluminum (CM-006)
*Available in 3000K, 4000K and other color temperatures upon request



linear canopy,
brushed aluminum



brushed aluminum
(CM-006)



walnut
(CM-001)



dark stained walnut
(CM-002)

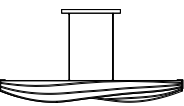

Arca
linear pendant

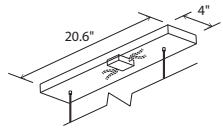
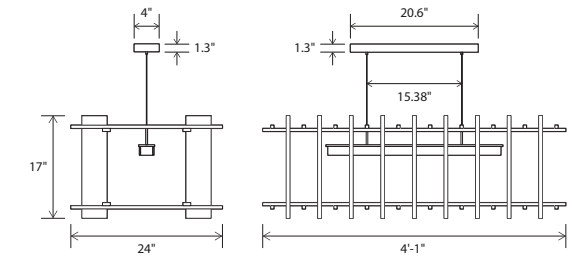

linear canopy,
brushed aluminum



brushed aluminum
(CM-006)



black anodized aluminum
(CM-007)



walnut
(CM-001)



dark stained walnut
(CM-002)

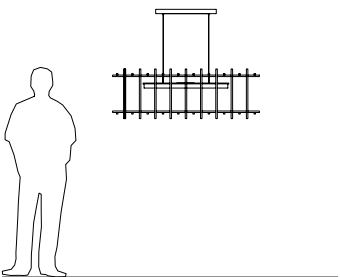

Dimensions: 4'-1" x 24", 17"
 Materials: solid wood, aluminum, polymer
 Product weight: 20 lb
 Light source: integrated LED
 Light output: 1720 Lumens (source)
 Light color*: 2700 K or 3500 K
 Color accuracy: 90+ CRI
 Power usage: 16 W
 Dimmable (see driver below)
 Linear canopy included
 Canopy dimensions: 20.6" x 4", 1.3"
 Canopy finish matches fixture's metal finish
 Wood canopy covers are available:
 Walnut (CM-001) cover: part # 60-130-005W
 Dark stained walnut (CM-002) cover:
 part # 60-130-005D
 See website for more canopy information
 72" drop length, field adjustable
 Suitable for a sloped ceiling
 Wood grain will vary
 Specifications subject to change



MATERIAL & FINISH OPTIONS

Arca part # 07-120-		
Metal Finish	brushed aluminum (CM-006)	A
	black anodized aluminum (CM-007)	B
Wood Body	walnut (CM-001)	W
	dark stained walnut (CM-002)	D
Lamping*	2700 K LED	27
	3500 K LED	35
Driver	AC Input Voltage Range: 120-277 V	
	120 V input: TRIAC, ELV & 0-10 V dimmable	P1
	240 & 277 V input: only 0-10 V dimmable	

Includes
 polymer shade (CM-052)
 frosted acrylic diffuser (CM-024)
 *Available in 3000K, 4000K and other color temperatures upon request



Arca, walnut, brushed aluminum



Arca, walnut, brushed aluminum

The Arca is an experiment with density and mass. As one moves around the room, the fixture morphs from a commanding presence of solid walnut into a graceful bar of light surrounded by an elegant porous cage.

Nick Sheridan
 Designer

Camur
linear pendant

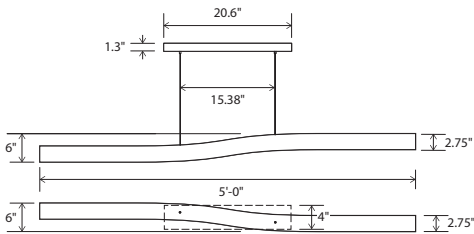

Dimensions: 5'-0" x 2.75", 2.75"
 Materials: solid wood, polymer
 Product weight: 6 lb
 Light source: integrated LED
 Light output: 2500 Lumens (source)
 Light color*: 2700 K or 3500 K
 Color accuracy: 90+ CRI
 Power usage: 35 W
 Dimmable (see driver below)
 Brushed aluminum (CM-006) camur canopy included
 Canopy dimensions: 20.6" x 4", 1.3"
 Wood camur canopy covers are available:
 Walnut (CM-001) wood camur canopy cover:
 part # 60-150-005W
 Dark stained walnut (CM-002) wood camur canopy cover:
 part # 60-150-005D
 See website for more canopy information
 72" drop length, field adjustable
 Suitable for a sloped ceiling
 Wood grain will vary
 Specifications subject to change



MATERIAL & FINISH OPTIONS

Camur part # 07-210-		
Wood Body	walnut (CM-001)	W
	dark stained walnut (CM-002)	D
Lamping*	2700 K LED	27
	3500 K LED	35
Driver	120 V AC input voltage	
	TRIAC, ELV & 0-10V dimming	P1
	277 V AC input voltage	P2
	TRIAC, ELV & 0-10V dimming	

The true beauty of the Camur is difficult to appreciate in print. When experiencing this fixture in person you begin to see the subtlety and grace of its vertical and horizontal movements. As you walk around this fixture the shape will morph from a beautiful curve to a straight line. We have created a video to help celebrate these details at www.cernogroup.com/camur

*Available in 3000K, 4000K and other color temperatures upon request

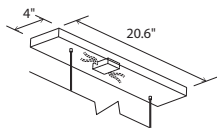

Camur canopy,
brushed aluminum



Camur canopy cover,
walnut



walnut
(CM-001)



dark stained walnut
(CM-002)

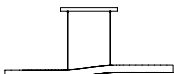

Camur, walnut



Light and delicate, subtly unique while simple, the camur must be experienced to really be appreciated. The gentle curve appears from the bottom just the same as it does from the side: but the perspectives found between the two intrigue.

Nick Sheridan,
 Designer



in collaboration with
DESIRON FRANK CARFARO
HAND CRAFTED AMERICAN FURNITURE



Aeris 54, walnut, brushed aluminum



Aeris 54, walnut, brushed aluminum

The Aeris was a collaboration with New York based designer Frank Carfaro of Desiron. The organic and often wild swirls of walnut grain are interrupted by rigorous slits and inlays that punctuate each face to create a beautiful juxtaposition, making each fixture unique. The glow of the illuminated wood seen through the cut slits creates a rich composition of light and shadow.

Nick Sheridan
Co-Designer

cerno®

Aeris 30 / Aeris 54 linear pendant

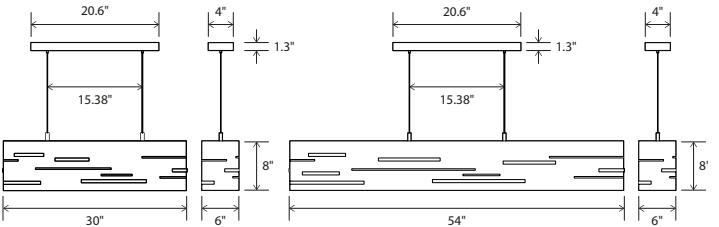

Aeris 30 dimensions: 30" x 6", 8"
Aeris 54 dimensions: 54" x 6", 8"
Materials: solid wood, aluminum
Aeris 30 weight: 11 lb
Aeris 54 weight: 15 lb
Light source: integrated LED
Light output - total: 1720 Lumens (source)
Light output - downlight: 1030 Lumens (source)
Light output - uplight: 690 Lumens (source)
Light color*: 2700 K or 3500 K
Color accuracy: 90+ CRI
Power usage: 16 W
Dimmable (see driver below)
Linear canopy included
Canopy dimensions: 20.6" x 4", 1.3"
Canopy finish matches fixture's metal finish
Wood canopy covers are available:
Walnut (CM-001) cover: part # 60-130-005W
Dark stained walnut (CM-002) cover:
part # 60-130-005D
See website for more canopy information
72" drop length, field adjustable
Suitable for a sloped ceiling
Wood grain will vary
Specifications subject to change



MATERIAL & FINISH OPTIONS

	Aeris Part # 07 -
Aeris 30	110
Aeris 54	100
Metal Finish	
brushed aluminum (CM-006)	A
black anodized aluminum (CM-007)	B
Wood Body	
walnut (CM-001)	W
dark stained walnut (CM-002)	D
Lamping*	
2700 K LED	27
3500 K LED	35
Driver	
AC Input Voltage Range: 120-277 V	
120 V input: TRIAC, ELV & 0-10 V dimmable	P1
240 & 277 V input: only 0-10 V dimmable	

Includes
polymer shade (CM-052)
*Available in 3000K, 4000K and other color temperatures upon request

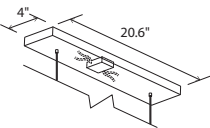

linear canopy,
brushed aluminum



brushed aluminum
(CM-006)



black anodized aluminum
(CM-007)



walnut
(CM-001)



dark stained walnut
(CM-002)

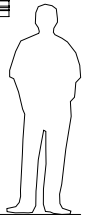
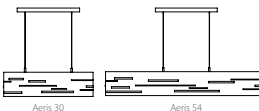



Vix 34 / Vix 48
linear pendant

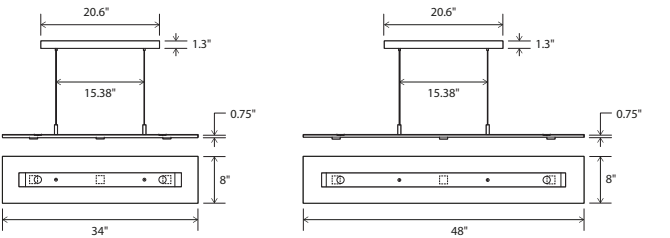

Vix 34 dimensions: 34" x 8", 0.75"
Vix 48 dimensions: 48" x 8", 0.75"
Materials: solid wood, polymer, aluminum
Vix 34 weight: 10 lb
Vix 48 weight: 15 lb
Light source: integrated LED
Light output - total: 1720 Lumens (source)
Light output - downlight: 1030 Lumens (source)
Light output - uplight: 690 Lumens (source)
Light color*: 2700 K or 3500 K
Color accuracy: 90+ CRI
Power usage: 16 W
Dimmable (see driver below)
Brushed aluminum (CM-006) linear canopy included
Canopy dimensions: 20.6" x 4", 1.3"
Wood canopy cover available:
Walnut (CM-001) cover: part # 60-130-005W
Dark stained walnut (CM-002) cover:
part # 60-130-005D
See website for more canopy information
72" drop length, field adjustable
Suitable for a sloped ceiling
Wood grain will vary
Specifications subject to change

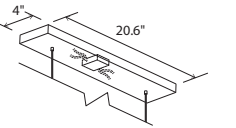

linear canopy,
brushed aluminum



walnut
(CM-001)



dark stained walnut
(CM-002)

MATERIAL & FINISH OPTIONS



A clean, modern fixture finely executed. With multiple down and up lights, the Vix provides lots of usable light in a very unobtrusive design.

Nick Sheridan
Designer

Vix Part # 07 -	
Vix 34	140
Vix 48	130
Wood Body	
walnut (CM-001)	W
dark stained walnut (CM-002)	D
Lamping*	
2700 K LED	27
3500 K LED	35
Driver	
AC Input Voltage Range:	
120-277 V	
120 V input: TRIAC, ELV & 0-10 V dimmable	
240 & 277 V input: only 0-10 V dimmable	

Includes
polymer shade (CM-052)
*Available in 3000K, 4000K and other color
temperatures upon request

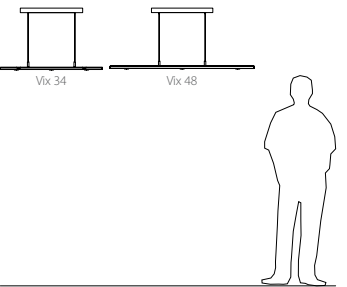

Virga
linear pendant

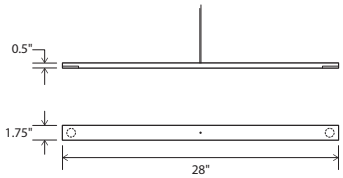

Dimensions: 28" x 1.75", 0.5"
Materials: aluminum, polymer
Product weight: 6 lb
Light source: integrated LED
Light output: 1126 Lumens (source)
Light color: 2700 K or 3500 K
Color accuracy: 90+ CRI
Power usage: 13 W
Dimmable (see driver below)
Extended-profile square canopy included,
required to house LED driver (3.25" x 2.25" x 1.25")
Canopy dimensions: 4.5" x 4.5", 1.63"
Canopy finish matches fixture's metal finish
See website for more canopy information
48" suspension tube (can be shortened in field)
Swivel option available for sloped ceilings,
see drawing below
Specifications subject to change



MATERIAL & FINISH OPTIONS

Virga part # 06-130-		-
Metal Finish	A	brushed aluminum (CM-006)
		black anodized aluminum (CM-007)
Lamping	27	2700 K LED
	35	3500 K LED
	P1	dimmmable
Driver		
AC Input Voltage Range: 120-277 V		
120 V input: TRIAC, ELV & 0-10 V		
dimmmable		
240 & 277 V input: only 0-10 V		
dimmmable		
Includes		
polymer shade (CM-052)		

Available for sloped ceilings:
Sloped Extended-Profile Square Canopy



Virga, brushed aluminum



Virga, black anodized aluminum

A clean, minimal fixture executed without compromise. The very simple and sleek down light bar can be installed in very close proximity to its user – and withstand close scrutiny.

Nick Sheridan
Designer



Brevis 28, brushed aluminum



Brevis 28, brushed aluminum

A clean, minimal fixture finely executed. With multiple down and up lights, the Brevis provides lots of usable light in a very unobtrusive design

Nick Sheridan
Designer

Brevis 28 / Brevis 42
linear pendants

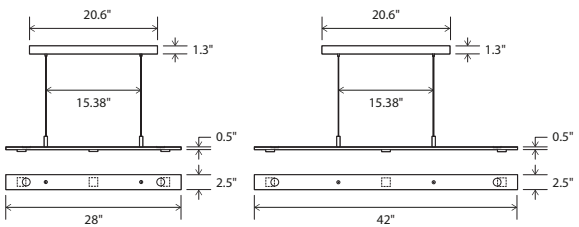

Brevis 28 dimensions: 28" x 2.5", 0.5"
Brevis 42 dimensions: 42" x 2.5", 0.5"
Materials: aluminum, polymer
Brevis 28 weight: 7 lb
Brevis 42 weight: 8 lb
Light source: integrated LED
Light output - total: 1720 Lumens (source)
Light output - downlight: 1030 Lumens (source)
Light output - uplight: 690 Lumens (source)
Light color*: 2700 K or 3500 K
Color accuracy: 90+ CRI
Power usage: 16 W
Dimmable (see driver below)
Linear canopy included
Canopy dimensions: 20.6" x 4", 1.3"
Canopy finish matches fixture's metal finish
Wood canopy covers are available:
Walnut (CM-001) cover: part # 60-130-005W
Dark stained walnut (CM-002) cover:
part # 60-130-005D
See website for more canopy information
72" drop length, field adjustable
Suitable for a sloped ceiling
Specifications subject to change



MATERIAL & FINISH OPTIONS

Brevis Part # 06-		-
Brevis 28	A	brushed aluminum (CM-006)
		black anodized aluminum (CM-007)
Brevis 42	27	2700 K LED
	35	3500 K LED
	P1	dimmmable
Driver		
AC Input Voltage Range: 120-277 V		
120 V input: TRIAC, ELV & 0-10 V		
dimmmable		
240 & 277 V input: only 0-10 V		
dimmmable		

Includes
polymer shade (CM-052)
*Available in 3000K, 4000K and other color
temperatures upon request

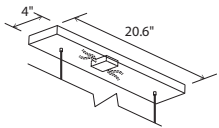

linear canopy,
brushed aluminum



brushed aluminum
(CM-006)



black anodized aluminum
(CM-007)

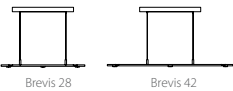

Brevis 28

Brevis 42

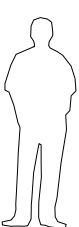

Pendants



Amicus 12



Amicus 16

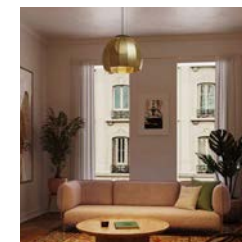

Amicus 21



Casia 14



Casia 18



Casia 22



Abeo

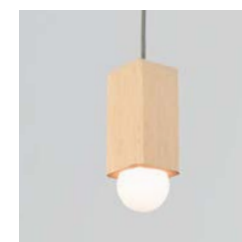

Cano



Bimar



Muto



Astrum 11



Astrum 17



Imber



Ignis



Ico



Calx 19



Calx 36



Veris 12



Veris 22

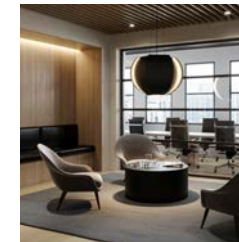

Veris 34



Levis family

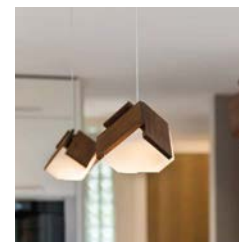

Mica family



Claudo



Salix

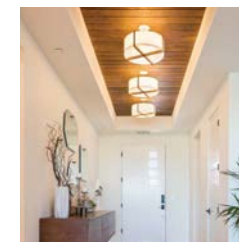

Plura

Amicus 12
pendant

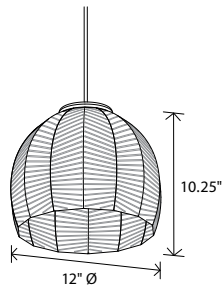

Dimensions: 12" Ø, 10.25"
Product weight: 3 lb
Suitable for a sloped ceiling

Integrated LED Specifications
Light Color Options*:
2700 K - 831 Lumens (source)
3500 K - 873 Lumens (source)
Color accuracy: 90+ CRI
Power usage: 10 W
Dimmable (see power options below)
JA8-2019 Compliant

E26 Medium Base Specifications
Lamping: E26 base, 60 W max, G40 recommended
Bulb not included
Input voltage: 250 V AC max

Textured Black Powdercoat (CM-049) low profile round canopy with SVT-3 Cable, Black (CM-039)
Canopy dimensions: 5" Ø, 0.3"
See website for more canopy information
Field adjustable drop length: 0'6" min - 8'0" max
Wood grain will vary
Specifications subject to change
Suitable for dry or damp locations

MATERIAL & FINISH OPTIONS

Amicus 12 part # 06-290-12	
Metal Shade	
brushed brass (CM-047)	R
distressed brass (CM-096)	D
brushed aluminum (CM-012)	A
brushed rose gold (CM-046)	G
textured black powdercoat (CM-049)	B
textured white powdercoat (CM-060)	W

Wood Top	
walnut (CM-001)	W
dark stained walnut (CM-002)	D
white washed oak (CM-095)	O

Lamping*	
2700 K LED	27
3500 K LED	35
medium base E26 socket	MB

Power Option (LED version only)	
120-277 V AC input voltage TRIAC and ELV dimming	P1

*Available in 3000K, 4000K and other color temperatures upon request



Amicus 12, dark stain walnut, brushed brass



Amicus socketed top detail

Traveling through Morocco, I was in awe of the skilled craftspeople and their impressive work. I was most enamored with the detail and intricacy of the perforated metal light fixtures. The artistry, patterns, and old-world techniques inspired me and ultimately inspired the Amicus.

Nick Sheridan
Designer



Amicus 16, white washed oak, brushed brass



Amicus integrated LED top detail

Traveling through Morocco, I was in awe of the skilled craftspeople and their impressive work. I was most enamored with the detail and intricacy of the perforated metal light fixtures. The artistry, patterns, and old-world techniques inspired me and ultimately inspired the Amicus.

Nick Sheridan
Designer



Amicus 16
pendant

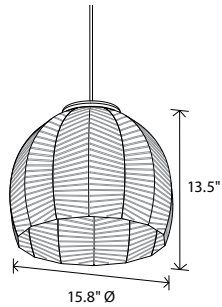

Dimensions: 15.8" Ø, 13.5"
Product weight: 4 lb
Suitable for a sloped ceiling

Integrated LED Specifications
Light Color Options*:
2700 K - 831 Lumens (source)
3500 K - 873 Lumens (source)
Color accuracy: 90+ CRI
Power usage: 10 W
Dimmable (see power options below)
JA8-2019 Compliant

E26 Medium Base Specifications
Lamping: E26 base, 60 W max, G40 recommended
Bulb not included
Input voltage: 250 V AC max

Textured Black Powdercoat (CM-049) low profile round canopy with SVT-3 Cable, Black (CM-039)
Canopy dimensions: 5" Ø, 0.3"
See website for more canopy information
Field adjustable drop length: 0'6" min - 8'0" max
Wood grain will vary
Specifications subject to change
Suitable for dry or damp locations

MATERIAL & FINISH OPTIONS

Amicus 16 part # 06-290-16	
Metal Shade	
brushed brass (CM-047)	R
distressed brass (CM-096)	D
brushed aluminum (CM-012)	A
brushed rose gold (CM-046)	G
textured black powdercoat (CM-049)	B
textured white powdercoat (CM-060)	W

Wood Top	
walnut (CM-001)	W
dark stained walnut (CM-002)	D
white washed oak (CM-095)	O

Lamping*	
2700 K LED	27
3500 K LED	35
medium base E26 socket	MB

Power Option (LED version only)	
120-277 V AC input voltage TRIAC and ELV dimming	P1

*Available in 3000K, 4000K and other color temperatures upon request



low-profile round canopy with SVT-3 Cable

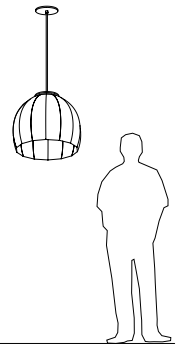



Traveling through Morocco, I was in awe of the skilled craftspeople and their impressive work. I was most enamored with the detail and intricacy of the perforated metal light fixtures. The artistry, patterns, and old-world techniques inspired me and ultimately inspired the Amicus.

Nick Sheridan
Designer

white washed oak (CM-095)	textured white powdercoat (CM-060)	brushed rose gold (CM-046)
walnut (CM-001)	textured black powdercoat (CM-049)	brushed brass (CM-047)
dark stained walnut (CM-002)	brushed aluminum (CM-012)	distressed brass (CM-096)

Amicus 21
pendant

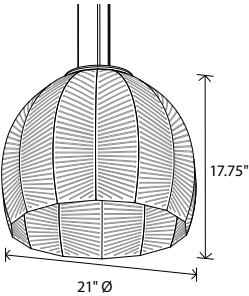

Dimensions: 21" Ø, 17.75"
Product weight: 6 lb
Suitable for a sloped ceiling

Integrated LED Specifications
Light Color Options*:
2700 K - 831 Lumens (source)
3500 K - 873 Lumens (source)
Color accuracy: 90+ CRI
Power usage: 10 W
Dimmable (see power options below)
JA8-2019 Compliant

E26 Medium Base Specifications
Lamping: E26 base, 60 W max, G40 recommended
Bulb not included
Input voltage: 250 V AC max

Textured Black Powdercoat (CM-049) extended round canopy with SVT-3 Cable, Black (CM-039) and 1/16" Stainless Steel Cables (CM-053)
Canopy dimensions: 5" Ø, 2"
See website for more canopy information
Field adjustable drop length: 1'0" min - 8'0" max
Wood grain will vary
Specifications subject to change
Suitable for dry or damp locations



MATERIAL & FINISH OPTIONS

Amicus 21 part # 06-290-21		
Metal Shade		
brushed brass (CM-047)	R	
distressed brass (CM-096)	D	
brushed aluminum (CM-012)	A	
brushed rose gold (CM-046)	G	
textured black powdercoat (CM-049)	B	
textured white powdercoat (CM-060)	W	
Wood Top		
walnut (CM-001)	W	
dark stained walnut (CM-002)	D	
white washed oak (CM-095)	O	
Lamping*		
2700 K LED	27	
3500 K LED	35	
medium base E26 socket	MB	
Power Option (LED version only)		
120-277 V AC input voltage TRIAC and ELV dimming	P1	

*Available in 3000K, 4000K and other color temperatures upon request

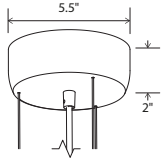

extended round canopy with SVT-3 Cable

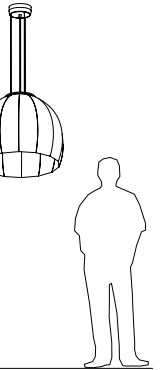

Casia 14
pendant

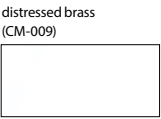
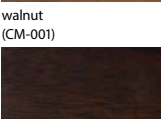
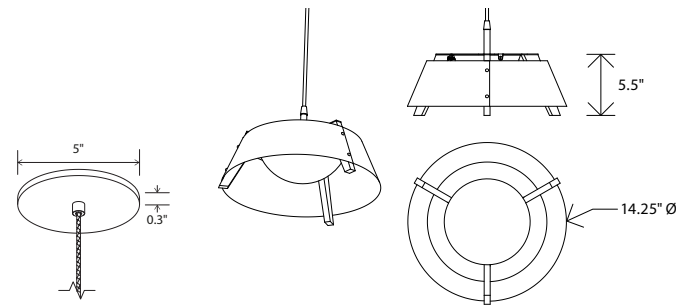

gloss white
(CM-054)

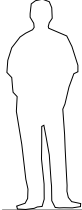

Dimensions: 14.25" Ø, 5.5"
Product weight: 3 lb
Light output: minimum 831 Lumens (source)
See Lamping options below
Light Color Options*:
2700 K - 831 Lumens (source)
3500 K - 873 Lumens (source)
Color accuracy: 90+ CRI
Power usage: 10 W
Dimmable (see power options below)
Low profile round canopy with SVT-3 Cable
Canopy dimensions: 5" Ø, 0.3"
See website for more canopy information
Field adjustable drop length: 0'6" min - 8'0" max
Gloss White (CM-054) shade option ships with Textured
White Powdercoat Canopy and SVT-3 Cable, White (CM-040)
All other shade option ship with Textured Black Powdercoat
(CM-049) and SVT-3 Cable, Black (CM-039)
Wood grain will vary
Specifications subject to change

MATERIAL & FINISH OPTIONS

Casia 14 pendant part # 06-280-14

Shade Material		
matte black (CM-085) with matte white interior	B	
distressed brass (CM-009)	D	
gloss white (CM-054)	W	
Wood Body		
walnut (CM-001)	W	
dark stained walnut (CM-002)	D	
white washed oak (CM-095)	O	
Lamping*		
2700 K LED - 831 Lumens (source)	27	
3500 K LED - 873 Lumens (source)	35	
Power Option		
120-277 V AC input voltage TRIAC and ELV dimming	P1	

Includes: white glass diffuser (CM-109)
Available in ceiling mount version
*Available in 3000K, 4000K and other color temperatures upon request



Casia Pendant 14, white washed oak, gloss white



Casia detail

The Casia Pendant was a natural progression after releasing the Casia Ceiling mount in early 2020. The wood arms, metal shade, and glass diffuser combine to create a minimalist form well suited for a modern environment or a traditional space. Each carefully selected material plays an integral role in the aesthetic design and performance.

Casia 18
pendant

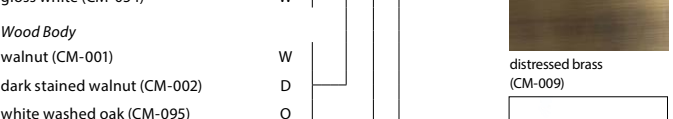
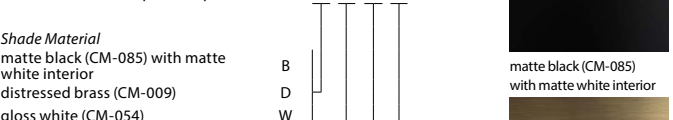
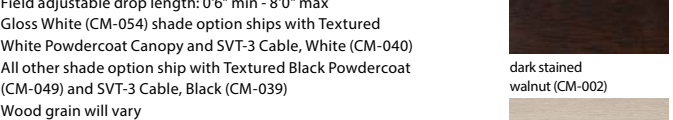
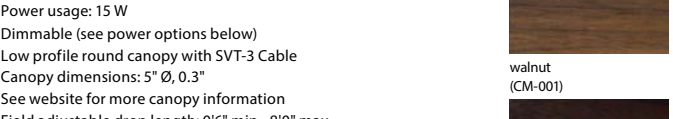
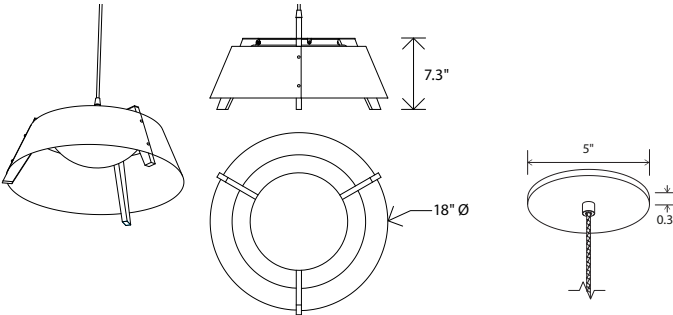

gloss white
(CM-054)

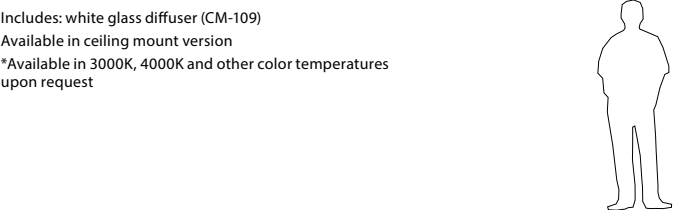

Dimensions: 18" Ø, 7.3"
Product weight: 4 lb
Light output: minimum 1310 Lumens (source)
See Lamping options below
Light Color Options*:
2700 K - 1310 Lumens (source)
3500 K - 1378 Lumens (source)
Color accuracy: 90+ CRI
Power usage: 15 W
Dimmable (see power options below)
Low profile round canopy with SVT-3 Cable
Canopy dimensions: 5" Ø, 0.3"
See website for more canopy information
Field adjustable drop length: 0'6" min - 8'0" max
Gloss White (CM-054) shade option ships with Textured
White Powdercoat Canopy and SVT-3 Cable, White (CM-040)
All other shade option ship with Textured Black Powdercoat
(CM-049) and SVT-3 Cable, Black (CM-039)
Wood grain will vary
Specifications subject to change

MATERIAL & FINISH OPTIONS

Casia 18 pendant part # 06-280-18

Shade Material		
matte black (CM-085) with matte white interior	B	
distressed brass (CM-009)	D	
gloss white (CM-054)	W	
Wood Body		
walnut (CM-001)	W	
dark stained walnut (CM-002)	D	
white washed oak (CM-095)	O	
Lamping*		
2700 K LED - 1310 Lumens (source)	27	
3500 K LED - 1378 Lumens (source)	35	
Power Option		
120-277 V AC input voltage TRIAC and ELV dimming	P1	

Includes: white glass diffuser (CM-109)
Available in ceiling mount version
*Available in 3000K, 4000K and other color temperatures upon request



Casia Pendant 18, dark stain walnut, matte black with matte white interior

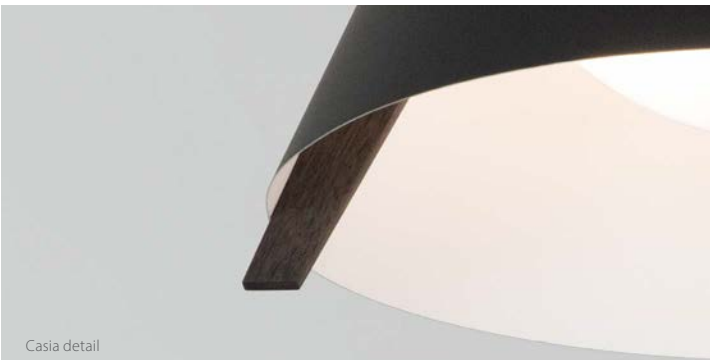

Casia detail

The Casia Pendant was a natural progression after releasing the Casia Ceiling mount in early 2020. The wood arms, metal shade, and glass diffuser combine to create a minimalist form well suited for a modern environment or a traditional space. Each carefully selected material plays an integral role in the aesthetic design and performance.

Casia 22
pendant

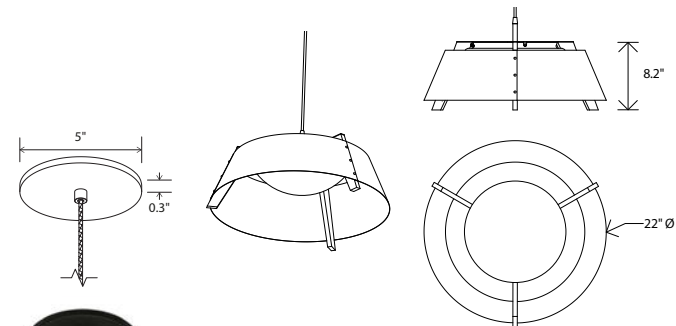

low-profile round canopy
with braided cord



walnut
(CM-001)



dark stained
walnut (CM-002)



white washed oak
(CM-095)



matte black (CM-085)
with matte white interior



distressed brass
(CM-009)



gloss white
(CM-054)



Dimensions: 21.5" Ø, 8.2"
Product weight: 5 lb
Light output: minimum 1981 Lumens (source)

See Lamping options below

Light Color Options*:

2700 K - 1981 Lumens (source)

3500 K - 2083 Lumens (source)

Color accuracy: 90+ CRI

Power usage: 23 W

Dimmable (see power options below)

Low profile round canopy with SVT-3 Cable

Canopy dimensions: 5" Ø, 0.3"

See website for more canopy information

Field adjustable drop length: 0'6" min - 8'0" max

Gloss White (CM-054) shade option ships with Textured

White Powdercoat Canopy and SVT-3 Cable, White (CM-040)

All other shade option ship with Textured Black Powdercoat

(CM-049) and SVT-3 Cable, Black (CM-039)

Wood grain will vary

Specifications subject to change



MATERIAL & FINISH OPTIONS

Casia 22 pendant part # 06-280-22

Shade Material

matte black (CM-085) with matte

white interior

distressed brass (CM-009)

gloss white (CM-054)

Wood Body

walnut (CM-001)

dark stained walnut (CM-002)

white washed oak (CM-095)

Lamping*

2700 K LED - 1981 Lumens (source)

3500 K LED - 2083 Lumens (source)

Power Option

120-277 V AC input voltage

TRIAC and ELV dimming

Includes: white glass diffuser (CM-109)

Available in ceiling mount version

*Available in 3000K, 4000K and other color temperatures

upon request

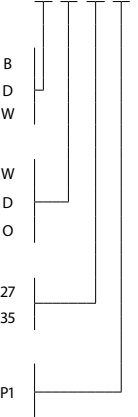

Casia Pendant 22, dark stain walnut, distressed brass

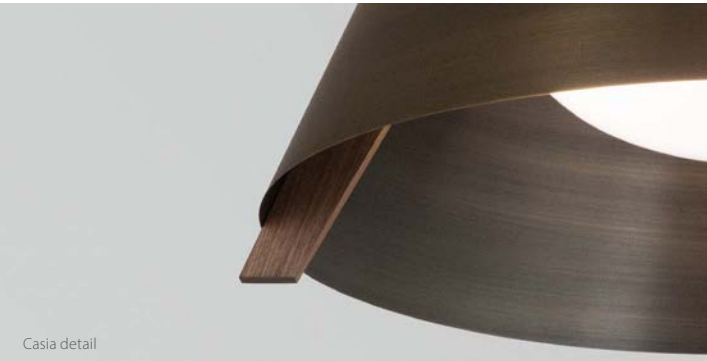

Casia detail

The Casia Pendant was a natural progression after releasing the Casia Ceiling mount in early 2020. The wood arms, metal shade, and glass diffuser combine to create a minimalist form well suited for a modern environment or a traditional space. Each carefully selected material plays an integral role in the aesthetic design and performance.



Abeo, walnut



I wanted to create a simple geometric sculpture that lets the light inside just sneak out around the floating walnut planes: letting the natural wood fall in and out of the light. It is this play with contrast and light and shadow that makes the Abeo such a dynamic piece.

Nick Sheridan
Designer

Abeo
pendant

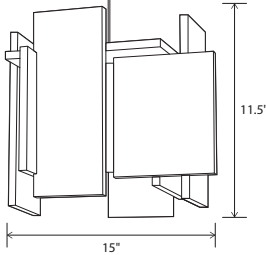

Dimensions: 15" Ø, 11.5"

Materials: solid wood, polymer

Product weight: 7 lb

Light source: integrated LED

Light output: 1250 Lumens (source)

Light color*: 2700 K or 3500 K

Color accuracy: 90+ CRI

Power usage: 13 W

Dimmable (see driver below)

White (CM-060) extended-profile round canopy

with white braided cord and steel cable included

Canopy dimensions: 5.5"Ø, 2"

Canopy required to house LED driver

(3.3" x 1.6" x 1.0")

See website for more canopy information

72" drop length, field adjustable

Suitable for a sloped ceiling

Wood grain will vary

Specifications subject to change



MATERIAL & FINISH OPTIONS

Abeo part # 06-190-

Wood Body

walnut (CM-001)

dark stained walnut (CM-002)

Lamping*

2700 K LED

3500 K LED

Driver

AC Input Voltage Range: 120-

277 V

120 V input: TRIAC, ELV & 0-10

V dimmable

240 & 277 V input: only 0-10

V dimmable

Includes

frosted polymer (CM-024)

*Available in 3000K, 4000K and other color

temperatures upon request

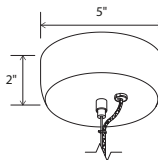

Extended-profile
round canopy



walnut
(CM-001)



dark stained walnut
(CM-002)

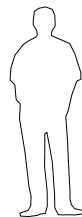

Cano
pendant

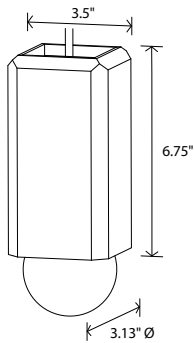

Dimensions: 3.5" x 3.5", 6.75"
Materials: solid wood
Product weight: 2 lb
Light source: medium base E26 socket
Lamping: E26 base, type G25 lamp, 20 W max
Input voltage: 250 V AC max
Suspension Details: Textured Black Powdercoat (CM-049) low profile round canopy with Grey Cloth Covered Cord (CM-106)
Canopy dimensions: 5" Ø, 0.3"
See website for more canopy information
Field adjustable drop length: 0'6" min - 6'0" max
Suitable for a sloped ceiling
Wood grain will vary
Specifications subject to change



Optional dimmable LED G25 bulb
Light output: 500 Lumens (source)
Color accuracy: 90+ CRI
Power usage: 5.5 W

MATERIAL & FINISH OPTIONS

Cano part # 06-251- - MB

Wood Shade

walnut (CM-001)
dark stained walnut (CM-002)
white washed oak (CM-095)

Bulb Options

2700 K G25 LED bulb included
no bulb included

W
D
O
27
00

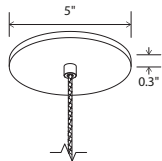

low-profile round canopy
with braided cord



walnut
(CM-001)



dark stained
walnut (CM-002)



white washed oak
(CM-095)

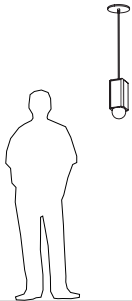

Cano, white washed oak



Cano, dark stained walnut



Cano, walnut

Designing with LEDs often lends itself to hiding, or using a low profile light source. The Cano pendant does the opposite; the light bulb is an integral part of the design. The solid hardwood faceted body is enhanced when paired with a spherical glowing bulb.

Bimar
pendant

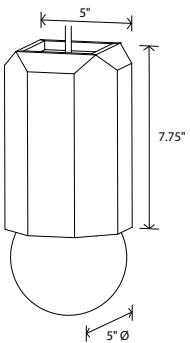

Dimensions: 5" x 5", 7.75"
Materials: solid wood
Product weight: 3 lb
Light source: medium base E26 socket
Lamping: E26 base, type G40 lamp, 20 W max
Input voltage: 250 V AC max
Textured Black Powdercoat (CM-049) low profile round canopy with Grey Cloth Covered Cord (CM-106)
Canopy dimensions: 5" Ø, 0.3"
See website for more canopy information
Field adjustable drop length: 0'6" min - 6'0" max
Suitable for a sloped ceiling
Wood grain will vary
Specifications subject to change



Optional dimmable LED G40 bulb
Light output: 1000 Lumens (source)
Color accuracy: 90+ CRI
Power usage: 11 W

MATERIAL & FINISH OPTIONS

Bimar part # 06-250- - MB

Wood Shade

walnut (CM-001)
dark stained walnut (CM-002)
white washed oak (CM-095)

Bulb Options

2700 K G40 LED bulb included
no bulb included

W
D
O
27
00

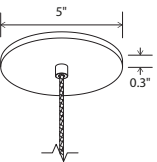

low-profile round canopy
with braided cord



walnut
(CM-001)



dark stained
walnut (CM-002)



white washed oak
(CM-095)

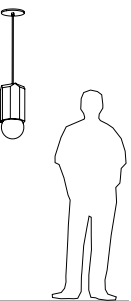

Bimar, white washed oak



Bimar, dark stained walnut



Bimar, walnut

Built of one inch thick solid hardwood, the Bimar showcases the beauty of natural woodgrain. Eight faceted sides compose a design that works well in a modern or transitional space. The combination of natural wood and a glowing sphere bulb warms up any environment.

Muto
large pendant

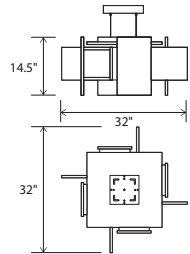

Dimensions: 32" x 32", 14.5"
Materials: solid wood, polymer
Product weight: 17 lb
Light source: integrated LED
Light output - total: 2626 Lumens (source)
Light output - ambient: 1376 Lumens (source)
Light output - downlight: 1250 Lumens (source)
Light color*: 2700 K or 3500 K
Color accuracy: 90+ CRI
Power usage: 25 W
Dimmable (see driver below)
Brushed aluminum (CM-006) 8" square canopy with black mesh cables included
See instructions for additional canopy details at cernogroup.com
72" drop length, field adjustable
Suitable for a sloped ceiling
Wood grain will vary
Specifications subject to change



MATERIAL & FINISH OPTIONS

Muto part # 06-140-

Wood Body
walnut (CM-001) W
dark stained walnut (CM-002) D

Lamping*
2700 K LED 27
3500 K LED 35

Driver
AC Input Voltage Range: 120-277 V
120 V input: TRIAC, ELV & 0-10 V dimmable
240 & 277 V input: only 0-10 V dimmable
P1

Includes
frosted polymer diffuser (CM-024)
*Available in 3000K, 4000K and other color temperatures upon request



Muto, walnut



Muto, walnut



The way the walnut planes in the Muto both block and bounce light makes for a very dynamic composition of light and shadow, from any vantage point. While the pinwheel form with its repeating elements is symmetric, it appears very sculptural from any one view. The modern floating ideal is realized in the Muto. By holding each walnut element away from its neighbor, so each plane floats, the whole fixture feels weightless as if it were floating itself.

Nick Sheridan
Designer

Astrum 11
pendant

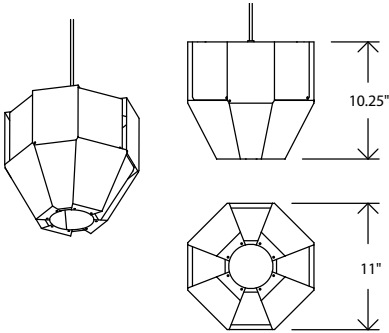

Dimensions: 11" x 11", 10.25"
Product weight: 2 lb
Suitable for a sloped ceiling

Integrated LED Specifications
Light output: 1690 Lumens (source)
Light color: 2700 K, 3000 K, 3500 K or 4000 K
Color accuracy: 90+ CRI
Power usage: 19.5 W
Dimmable (see driver below)
Driver must be housed in J-box
Driver dimensions: 3.3" x 1.6" x 1", included

E26 Medium Base Specifications
Lamping: E26 base, type A lamp, 60 W max
Input voltage: 250 V AC max
Bulb not included

Textured Black Powdercoat (CM-049) low profile round canopy with SVT-3 Cable, Black (CM-039)
Canopy dimensions: 5" Ø, 0.3"
See website for more canopy information
Field adjustable drop length: 0'6" min - 8'0" max
Specifications subject to change



MATERIAL & FINISH OPTIONS

Astrum 11 part # 06-270-11

Shade Material
matte black (CM-085) with matte white interior B
distressed brass (CM-096) D
gloss white (CM-054) W

Lamping
2700 K LED 27
3000 K LED 30
3500 K LED 35
4000 K LED 40
medium base E26 socket MB

Driver (LED version only)
AC Input Voltage Range: 120-277 V
120 V input: TRIAC, ELV & 0-10 V dimmable
240 & 277 V input: only 0-10 V dimmable
P1



Astrum 11, distressed brass



Astrum, detail

Inspiration for the Astrum dates back to the first light fixture the three of us ever made after starting Cerno. The varying depths of the flat panels strategically obstruct a direct view of the light source. Light reflects off the inside of the outer panels and bounces off the inner panels producing a halo washing effect. The oculus at the bottom functions to emit a useful amount of downlighting. This design manages to pay homage to past modern designs while also feeling a bit futuristic.

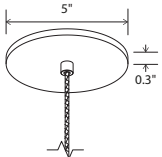

low-profile round canopy with braided cord



matte black (CM-085) with matte white interior



distressed brass (CM-096)



gloss white (CM-054)

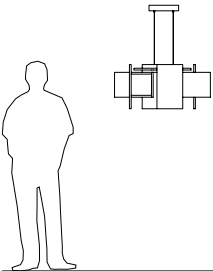
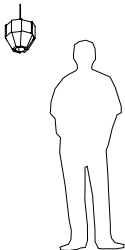



Astrum 17, gloss white



Astrum, detail

Inspiration for the Astrum dates back to the first light fixture the three of us ever made after starting Cerno. The varying depths of the flat panels strategically obstruct a direct view of the light source. Light reflects off the inside of the outer panels and bounces off the inner panels producing a halo washing effect. The oculus at the bottom functions to emit a useful amount of downlighting. This design manages to pay homage to past modern designs while also feeling a bit futuristic.

Astrum 17
pendant

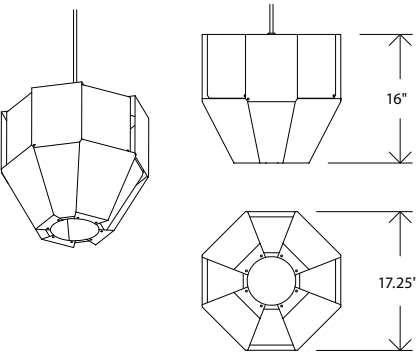

Dimensions: 17.25" x 17.25", 16"
Product weight: 4 lb
Suitable for a sloped ceiling

Integrated LED Specifications
Light output: 1690 Lumens (source)
Light color: 2700 K, 3000 K, 3500 K or 4000 K
Color accuracy: 90+ CRI
Power usage: 19.5 W
Dimmable (see driver below)
Driver must be housed in J-box
Driver dimensions: 3.3" x 1.6" x 1", included

E26 Medium Base Specifications
Lamping: 2x E26 base, type A lamp, 60 W max
Input voltage: 250 V AC max
Bulb not included

Textured Black Powdercoat (CM-049) low profile round canopy with SVT-3 Cable, Black (CM-039)
Canopy dimensions: 5" Ø, 0.3"
See website for more canopy information
Field adjustable drop length: 0'6" min - 8'0" max
Specifications subject to change



MATERIAL & FINISH OPTIONS

Astrum 17 part # 06-270-17		
Shade Material		
	matte black (CM-085) with matte white interior	B
	distressed brass (CM-096)	D
	gloss white (CM-054)	W
Lamping	2700 K LED	27
	3000 K LED	30
	3500 K LED	35
	4000 K LED	40
	medium base E26 socket	MB
Driver (LED version only)		
AC Input Voltage Range:		
120-277 V		
120 V input: TRIAC, ELV & 0-10 V dimmable		P1
240 & 277 V input: only 0-10 V dimmable		

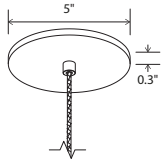

low-profile round canopy with braided cord



matte black (CM-085) with matte white interior



distressed brass (CM-096)



gloss white (CM-054)

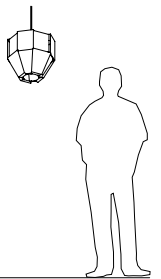

Imber 17 / Imber 24
pendant

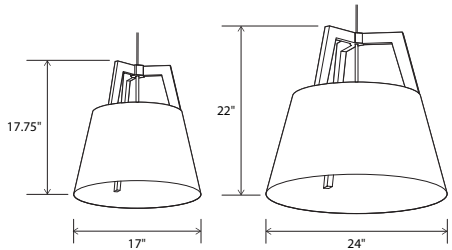

Imber 17 dimensions: 17" Ø, 17.75"
Imber 24 dimensions: 24" Ø, 22"
Materials: solid wood, metal
Imber 17 weight: 7 lb
Imber 24 weight: 12 lb
Wood grain will vary
Specifications subject to change

Lamping
Integrated LED Specifications
Light output: 1250 Lumens (source)
Light color*: 2700 K or 3500 K
Color accuracy: 90+ CRI
Power usage: 13 W
Input voltage: 120-277 V AC
Dimmable: 0-10 V dimming at 120-277 V AC
TRIAC and ELV dimming at 120 V AC only

Medium Base E26 Specifications
Imber 17 lamping:
1x E26 base, type A lamp, 75 W max
Imber 24 lamping:
3x E26 base, type A lamp, 75 W max each
Bulbs not included
Input voltage: 250 V AC max

Suspension Type
Corded
96" length of SVT wire is used. Wire is field adjustable and suitable for a sloped ceiling.
Rigid
Stem comes 6' long and is field cuttable to length (0.38" Ø).

Suspension and Hardware Finish
Standard Combinations
Come with either black or satin nickel suspension, canopy, and sockets:
Black: DW, DD, RW, GD, BD, BO, BW
Satin Nickel: WO
Corded Versions
White cord: satin nickel hardware
Black cord: black hardware
24" Imber corded uses a .06" Ø steel cable for suspension

*Available in 3000K, 4000K and other color temperatures upon request



Diffuser
Frosted white diffuser (CM-024)
Diffuser is recommended when fixture location may allow for direct glare.
Integrated LED option always comes with a diffuser



Imber 24, distressed brass, walnut

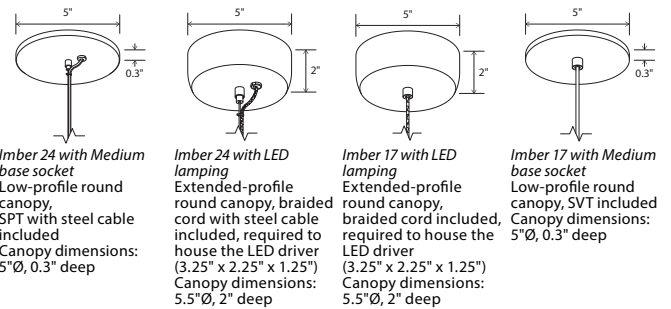

Ignis 24, brass, walnut

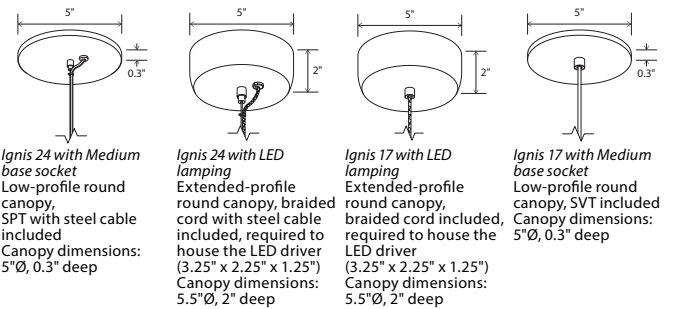

Ignis 17 / Ignis 24
pendant

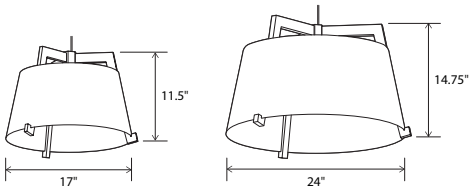

Ignis 17 dimensions: 17" Ø, 11.5"
Ignis 24 dimensions: 24" Ø, 14.75"
Materials: solid wood, metal
Ignis 17 weight: 7 lb
Ignis 24 weight: 11 lb
Wood grain will vary
Specifications subject to change



MATERIAL & FINISH OPTIONS

Ignis part # 06-220-
Fixture Size
17" Ø
24" Ø

Standard Combinations

(Shade, Frame)

distressed brass, walnut
distressed brass,
dark stained walnut
brushed brass, walnut
brushed rose gold,
dark stained walnut

matte black with matte white
interior, dark stained walnut

matte black with matte white
interior, white washed oak

matte black with matte white
interior, walnut

gloss white, white washed
oak

Suspension Type

corded

rigid

*Lamping**

integrated LED

with diffuser - 2700K

integrated LED

with diffuser - 3500K

medium base socket

without diffuser

medium base socket

with diffuser

The Ignis and Imber were inspired by the same design principles that make Cerno and ICRAVE well suited to collaborate. Honesty, simplicity, elemental, timeless and quality are words that sit at the core of both companies' design ethos and we believe these light fixtures embrace these qualities well. Each fixture was reduced to its essential parts – frame and shade – highlighting the interplay of the components, and accentuating the clean lines of the form.

ICRAVE / Cerno

Lamping
Integrated LED Specifications
Light output: 1250 Lumens (source)
Light color*: 2700 K or 3500 K
Color accuracy: 90+ CRI
Power usage: 13 W
Input voltage: 120-277 V AC
Dimmable: 0-10 V dimming at 120-277 V AC
TRIAC and ELV dimming at 120 V AC only

Medium Base E26 Specifications

Ignis 17 lamping:

1x E26 base, type A lamp, 75 W max

Ignis 24 lamping:

3x E26 base, type A lamp, 75 W max each

Bulbs not included

Input voltage: 250 V AC max

Suspension Type

Corded

8'-0" length of SVT wire is used. Wire is field adjustable and suitable for a sloped ceiling.

Rigid

Stem comes 6' long and is field cuttable to length (.038" Ø)

Suspension and Hardware Finish

Standard Combinations

Come with either black or satin nickel

suspension, canopy, and sockets:

Black: DW, DD, RW, GD, BD, BO, BW

Satin Nickel: WO

Corded Versions

White cord: satin nickel hardware

Black cord: black hardware

24" Ignis corded uses a 1/16" Ø steel

cable for suspension

*Available in 3000K, 4000K and other color temperatures upon request

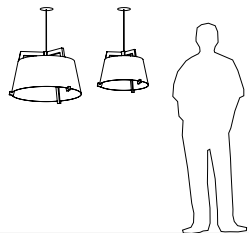



Ico
pendant

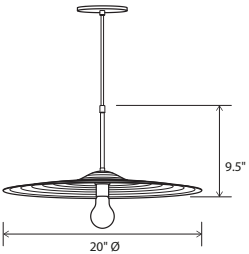

Dimensions: 20" Ø, 9.5"
Materials: solid brass
Product weight: 6 lb
Light source: medium base E26 socket
Lamping: 1x E26 base, 60 W max
Bulbs not included
Input voltage: 250 V AC max
Textured Black Powdercoat (CM-049)
low profile round canopy with Black Cloth Covered Cord (CM-090)
Canopy dimensions: 5" Ø, 0.3"
See website for more canopy information
Field adjustable drop length: 0'9" min - 8'0" max
Suitable for a sloped ceiling
Specifications subject to change

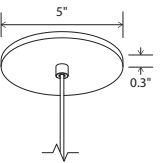

low-profile round canopy



MATERIAL & FINISH OPTIONS

	Ico part # 06-240-20	R	C
Fixture Size	20"		
Shade Finish			
spun solid brass (CM-091)		R	
Suspension			
corded (CM-008)			C

Includes
brushed brass (CM-008)



After working with drum cymbals on a few custom projects, we grew to appreciate the design and engineering that goes into these beautiful objects. Cymbals have a simple form, rich texture, and a beautiful brass finish. Modernism is often about utilizing what already exists and repurposing things, which is what we did with this fixture. The Ico looks excellent when paired with a simple light bulb.

Nick Sheridan
Designer

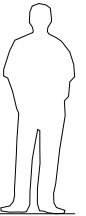

Calx 10
accent pendant

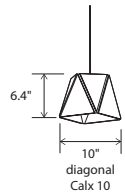

Dimensions: 6.75" x 6.75", 6.4"
Materials: wood, metal, polymer
Product weight: 2 lb
Light source: integrated LED
Light output: 345 Lumens (source)
Light color*: 2700 K or 3500 K
Color accuracy: 90+ CRI
Power usage: 3.2 W
Dimmable (see driver below)
Driver location: must be housed in J-box
Driver dimensions: 2" x 1.3" x 1", included
White (CM-060) low-profile round canopy with
white braided cord included
Canopy dimensions: 5"Ø, 0.3"
See website for more canopy information
72" drop length, field adjustable
Suitable for a sloped ceiling
Wood grain will vary
Specifications subject to change



MATERIAL & FINISH OPTIONS

Calx 10 part # 06-200-10

Metal Finish

brushed aluminum (CM-012)
brushed rose gold (CM-046)
brushed brass (CM-047)

Wood Finish

walnut (CM-055)
dark stained walnut (CM-056)

Lamping*

2700 K LED
3500 K LED

Driver

120VAC input voltage
ELV dimming only

Calx sconce also available. Click here.

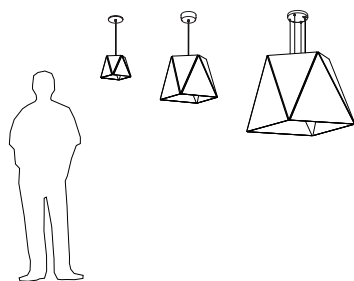

Calx 19
pendant

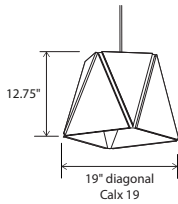

Dimensions: 13" x 13", 12.75"
Materials: wood, metal, polymer
Product weight: 7 lb
Suitable for a sloped ceiling

Integrated LED Specifications
Light output: 1250 Lumens (source)
Light color*: 2700 K or 3500 K
Color accuracy: 90+ CRI
Power usage: 13 W
Dimmable (see driver below)
White (CM-060) extended-profile round canopy
with white braided cord and steel cable included
Canopy dimensions: 5"Ø, 2"
Canopy required to house LED driver
(3.3" x 1.6" x 1.0")
See below for more canopy information
72" drop length, field adjustable

Medium Base Specifications

Lamping: 1x E26 base, type A lamp, 60 W max
Bulb not included
Input voltage: 250 V AC max
White (CM-060) low-profile round canopy with
white SPT cord and steel cable included
Canopy dimensions: 5"Ø, 0.3"
72" drop length, field adjustable
Suitable for a sloped ceiling
Wood grain will vary
Specifications subject to change



MATERIAL & FINISH OPTIONS

Calx 19 part # 06-200-19

Metal Finish

brushed aluminum (CM-012)
brushed rose gold (CM-046)
brushed brass (CM-047)

Wood Finish

walnut (CM-055)
dark stained walnut (CM-056)

Lamping*

2700 K LED
3500 K LED
medium base E26 socket

Driver (LED version only)

AC Input Voltage Range: 120-277 V
120 V input: TRIAC, ELV & 0-10 V dimmable
240 & 277 V input: only 0-10 V dimmable

Includes

frosted polymer diffuser (CM-057)

*Available in 3000K, 4000K and other color temperatures upon request



Calx 10, walnut, brushed brass



Calx 19, walnut, brushed brass



The Calx is an example of modern design where the methods and the materials themselves are integral to its very conception, aligning form and function, which creates a synergy that is evident. The fixture ultimately forms a square aperture but enjoys a beautifully simple faceted structure.

Nick Sheridan,
Designer



Calx 36, walnut, brushed brass

Calx 36
pendant

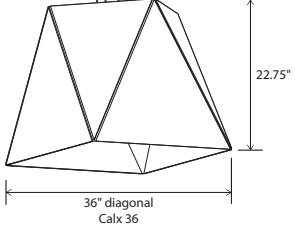

Dimensions: 25" x 25", 22.75"
Materials: wood, metal, polymer
Product weight: 18 lb
Light source: 4x GU-24 base socket
Lamping: 4x GU-24 base, 18 W max each
Bulbs not included
Input voltage: 300 V AC max
White (CM-060) 8" round canopy included
Canopy dimensions: 8"Ø, 1.25"
See page left and website for more canopy information
96" drop length, field adjustable
Suitable for a sloped ceiling
Wood grain will vary
Specifications subject to change



MATERIAL & FINISH OPTIONS

Calx 36 part # 06-200-36

Metal Finish

brushed aluminum (CM-012)
brushed rose gold (CM-046)
brushed brass (CM-047)

Wood Finish

walnut (CM-055)
dark stained walnut (CM-056)

Includes

frosted polymer diffuser (CM-057)

Calx sconce also available. Click here.

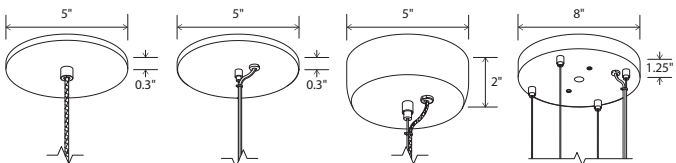

Calx 10
low-profile round canopy
with braided cord



Calx 19 E26
low-profile round
canopy with white SPT
with steel cable



Calx 19 Integrated LED
extended-profile round
canopy braided cord
with steel cable



Calx 36
8" round canopy
clear SPT with
four 1/16" Ø steel cables



brushed brass
(CM-047)



brushed aluminum
(CM-012)



brushed rose gold
(CM-046)



walnut
(CM-055)



dark stained walnut
(CM-056)

Veris 12
pendant

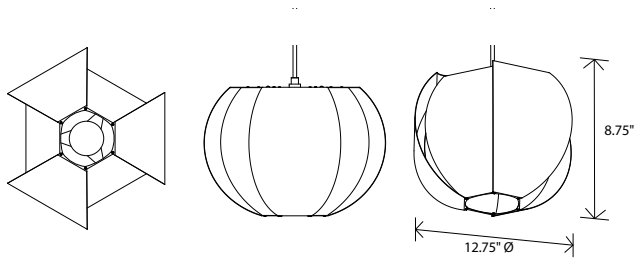

Dimensions: 12.75" Ø, 8.75"
Product weight: 2 lb
Suitable for a sloped ceiling



matte black (CM-085)
with matte white interior



brushed aluminum
(CM-012)



brushed rose gold
(CM-046)



brushed brass
(CM-047)



distressed brass
(CM-096)



gloss white
(CM-054)

Integrated LED Specifications
Light output: 1690 Lumens (source)
Light color: 2700 K, 3000 K, 3500 K or 4000 K
Color accuracy: 90+ CRI
Power usage: 19.5 W
Dimmable (see driver below)
Driver must be housed in J-box

E26 Medium Base Specifications
Driver dimensions: 3.3" x 1.6" x 1", included
Lamping: E26 base, type A lamp, 60 W max
Input voltage: 250 V AC max
Bulb not included

Textured Black Powdercoat (CM-049) low profile
round canopy with SVT-3 Cable, Black (CM-039)
Canopy dimensions: 5" Ø, 0.3"
See website for more canopy information
Field adjustable drop length: 0'6" min - 8'0" max
Specifications subject to change



MATERIAL & FINISH OPTIONS

Veris part # 06-260-12

Shade Material

matte black (CM-085) with matte white interior	B
brushed aluminum (CM-012)	A
brushed rose gold (CM-046)	G
brushed brass (CM-047)	R
distressed brass (CM-096)	D
gloss white (CM-054)	W

Lamping

2700 K LED	27
3000 K LED	30
3500 K LED	35
4000 K LED	40
medium base E26 socket	MB

Driver (LED version only)

AC Input Voltage Range:
120-277 V
120 V input: TRIAC, ELV & 0-10
V dimmable
240 & 277 V input: only 0-10
V dimmable

P1



Veris 12, matte black with matte white interior



Veris, details

Veris was a concept we started exploring ten years ago. Two offset layers of petals simultaneously shield the light source while allowing reflected light to wash the inside petals, creating a dramatic ambient luminaire. The form materializes through a series of processes that utilize cutting edge CNC laser technology but still rely on skilled hand-rolling and bending of the aluminum petals.

Veris 22
pendant

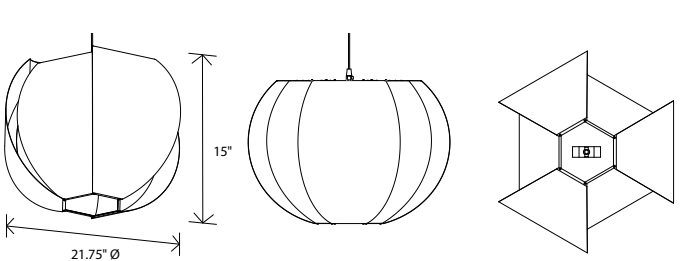

Dimensions: 21.75" Ø, 15"
Product weight: 4 lb
Suitable for a sloped ceiling

Integrated LED Specifications
Light output: 1690 Lumens (source)
Light color: 2700 K, 3000 K, 3500 K or 4000 K
Color accuracy: 90+ CRI
Power usage: 19.5 W
Dimmable (see driver below)
Driver must be housed in J-box

E26 Medium Base Specifications
Driver dimensions: 3.3" x 1.6" x 1", included
Lamping: 2x E26 base, type A lamp, 60 W max each
Input voltage: 250 V AC max
Bulb not included

Textured Black Powdercoat (CM-049) low profile
round canopy with SVT-3 Cable, Black (CM-039)
Canopy dimensions: 5" Ø, 0.3"
See website for more canopy information
Field adjustable drop length: 0'6" min - 8'0" max
Specifications subject to change



MATERIAL & FINISH OPTIONS

Veris part # 06-260-22

Shade Material

matte black (CM-085) with matte white interior	B
brushed aluminum (CM-012)	A
brushed rose gold (CM-046)	G
brushed brass (CM-047)	R
distressed brass (CM-096)	D
gloss white (CM-054)	W

Lamping

2700 K LED	27
3000 K LED	30
3500 K LED	35
4000 K LED	40
medium base E26 socket	MB

Driver (LED version only)

AC Input Voltage Range:
120-277 V
120 V input: TRIAC, ELV & 0-10
V dimmable
240 & 277 V input: only 0-10
V dimmable

P1



Veris 22, matte black with matte white interior



Veris, details

Veris was a concept we started exploring ten years ago. Two offset layers of petals simultaneously shield the light source while allowing reflected light to wash the inside petals, creating a dramatic ambient luminaire. The form materializes through a series of processes that utilize cutting edge CNC laser technology but still rely on skilled hand-rolling and bending of the aluminum petals.



matte black (CM-085)
with matte white interior



brushed aluminum
(CM-012)



brushed rose gold
(CM-046)



brushed brass
(CM-047)



distressed brass
(CM-096)



gloss white
(CM-054)





Veris 34, matte black with matte white interior

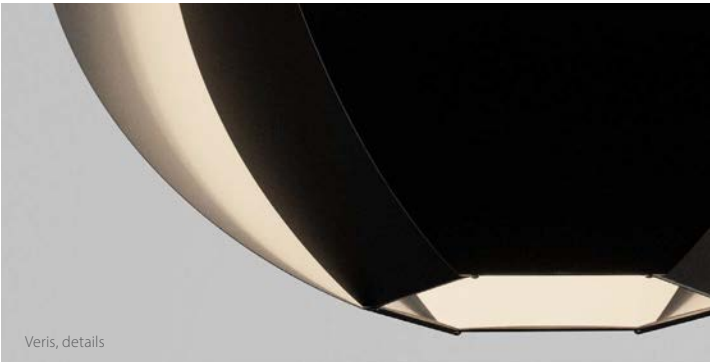

Veris, details

Veris was a concept we started exploring ten years ago. Two offset layers of petals simultaneously shield the light source while allowing reflected light to wash the inside petals, creating a dramatic ambient luminaire. The form materializes through a series of processes that utilize cutting edge CNC laser technology but still rely on skilled hand-rolling and bending of the aluminum petals.

Veris 34
pendant

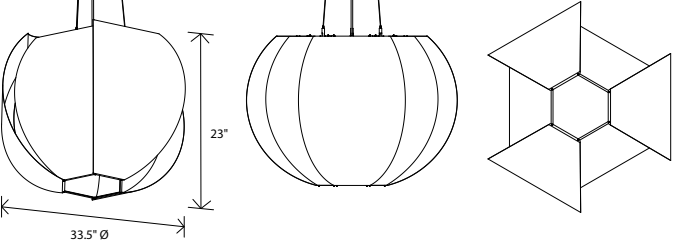

Dimensions: 33.5" Ø, 23"
Product weight: 8 lb
Suitable for a sloped ceiling

Integrated LED Specifications
Light output: 2815 Lumens (source)
Light color: 2700 K, 3000 K, 3500 K or 4000 K
Color accuracy: 90+ CRI
Power usage: 32.5 W
Dimmable (see driver below)
Driver housed in extended canopy
Driver dimensions: 3.3" x 2.4" x 1", included

E26 Medium Base Specifications
Lamping: 3x E26 base, type A lamp, 60 W max each
Input voltage: 250 V AC max
Bulb not included

Textured Black Powdercoat (CM-049) extended round canopy with SVT-3 Cable, Black (CM-039) and 1/16" Stainless Steel Cables (CM-053)
Canopy dimensions: 5" Ø, 2"
See website for more canopy information
Field adjustable drop length: 1'0" min - 8'0" max
Specifications subject to change



MATERIAL & FINISH OPTIONS

Veris part # 06-260-34		-	
<i>Shade Material</i>			
matte black (CM-085) with matte white interior	B		
brushed aluminum (CM-012)	A		
brushed rose gold (CM-046)	G		
brushed brass (CM-047)	R		
distressed brass (CM-096)	D		
gloss white (CM-054)	W		
<i>Lamping</i>			
2700 K LED	27		
3000 K LED	30		
3500 K LED	35		
4000 K LED	40		
medium base E26 socket	MB		
<i>Driver (LED version only)</i>			
AC Input Voltage Range: 120-277 V			
120 V input: TRIAC, ELV & 0-10 V dimmable	P1		
240 & 277 V input: only 0-10 V dimmable			

matte black (CM-085) with matte white interior

brushed aluminum (CM-012)

brushed rose gold (CM-046)

brushed brass (CM-047)

distressed brass (CM-096)

gloss white (CM-054)

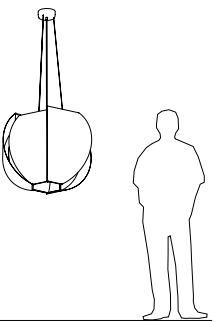

Levis
accent pendant

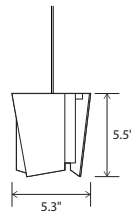

Dimensions: 5.3" Ø, 5.5" H
Materials: polymer, veneer and aluminum options
Product weight: 1 lb
Energy efficient LED light source
Light output: 345 Lumens (source)
Light color*: 2700 K (warm) or 3500 K (cool)
Color accuracy: 90+ CRI
LED power consumption: 3.2W
Dimmable (see driver below)
Driver location: must be housed in J-box
Driver dimensions: 2" x 1.3" x 1", included
Brushed aluminum (CM-006) Low-Profile Square Canopy included
Canopy dimensions: 4.5" x 4.5", 0.38"
Must use included external LED driver (2.25" x 1.5" x 1")
Accent pendants can be clustered by using Multi-Point Round Canopy or Multi-Point Linear Canopy
See website for more canopy information
6'-0" drop length, field adjustable
Suitable for a sloped ceiling
Wood grain will vary
Specifications subject to change



MATERIAL & FINISH OPTIONS

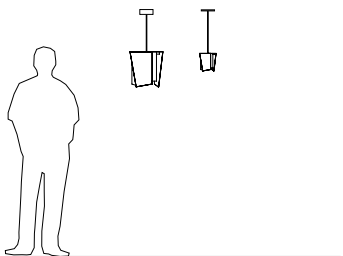
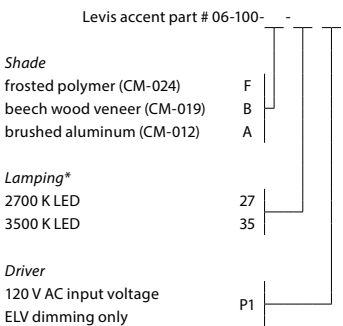

Levis L
pendant

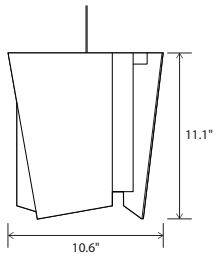

Dimensions: 10.6" Ø, 11.1"
Materials: polymer, veneer and aluminum options
Product weight: 7 lb
Suitable for a sloped ceiling

Integrated LED Specifications
Light output: 1250 Lumens (source)
Light color*: 2700 K or 3500 K
Color accuracy: 90+ CRI
Power usage: 13 W
Dimmable (see driver below)
Brushed aluminum (CM-006) extended-profile square canopy with white braided cord included
Canopy dimensions: 4.5" x 4.5", 1.63"
Canopy required to house LED driver (3.3" x 1.6" x 1.0")
See website for more canopy information
6'-0" drop length, field adjustable

Medium Base Specifications
Lamping: E26 base, type A lamp, 60 W max
Input voltage: 250 V AC Max
White (CM-060) low-profile round canopy with clear SVT cord included
Canopy dimensions: 5"Ø, 0.3"
6'-0" drop length, field adjustable
Specifications subject to change



MATERIAL & FINISH OPTIONS

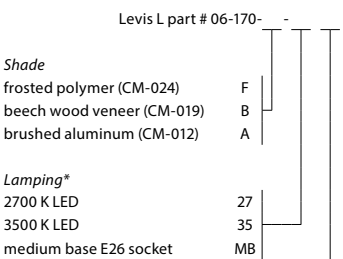

Driver (LED version only)
AC Input Voltage Range: 120-277 V
120 V input: TRIAC, ELV & 0-10 V dimmable
240 & 277 V input: only 0-10 V dimmable

*Available in 3000K, 4000K and other color temperatures upon request



Levis L, frosted polymer

The Levis is simple and clean at first glance: complex upon closer review. The rhythm in the facets gives a dynamic feel from different vantage points, creating a sophistication to its presence.

Nick Sheridan
Designer

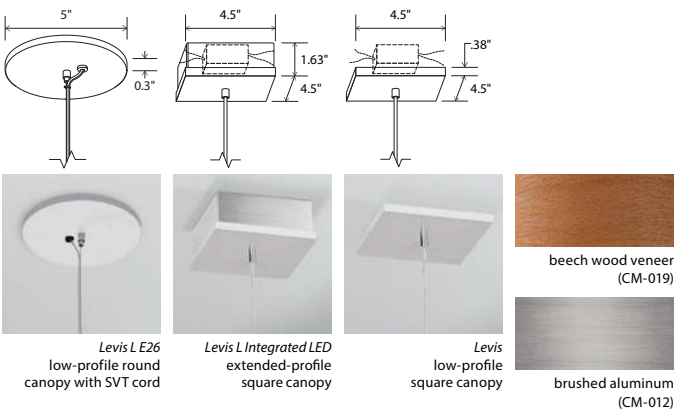

Mica, walnut

The Mica is simply a cube, which has been carefully deconstructed to a sculptural state. By way of the fixture's orientation and petal material composition, it exudes a certain organic symmetry. The Mica accent pendant acts as a beautiful node, creating a sense of space marked with an ambient glow.

Nick Sheridan
Designer

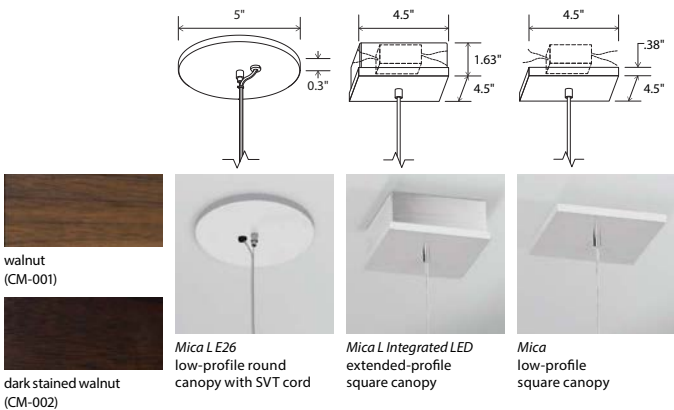

walnut (CM-001)



dark stained walnut (CM-002)

Mica L
pendant

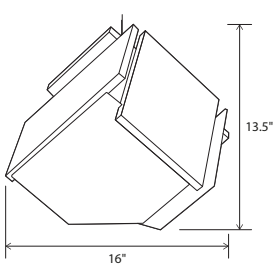

Dimensions: 16" Ø, 13.5"
Materials: solid wood, polymer
Product weight: 8 lb
Suitable for a sloped ceiling

Integrated LED Specifications
Light output: 1250 Lumens (source)
Light color*: 2700 K or 3500 K
Color accuracy: 90+ CRI
Power usage: 13 W
Dimmable (see driver below)
Brushed aluminum (CM-006) extended-profile square canopy with white braided cord included
Canopy dimensions: 4.5" x 4.5", 1.63"
Canopy required to house LED driver (3.3" x 1.6" x 1.0")
See website for more canopy information
6'-0" drop length, field adjustable

Medium Base Specifications
Lamping: E26 base, type A lamp, 60 W max
Bulb not included
Input voltage: 250 V AC max
White (CM-060) low-profile round canopy with clear SVT cord included
Canopy dimensions: 5"Ø, 0.3"
6'-0" drop length, field adjustable

Wood grain will vary
Specifications subject to change



MATERIAL & FINISH OPTIONS

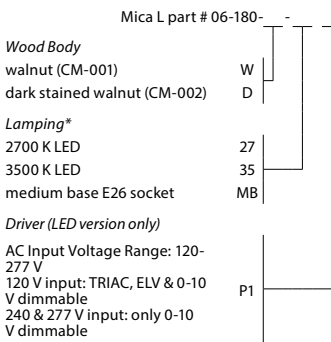

Includes
frosted polymer (CM-024)
*Available in 3000K, 4000K and other color temperatures upon request

Mica
accent pendant

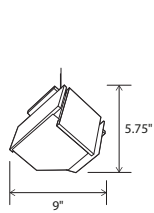

Dimensions: 9" Ø, 5.75"
Materials: solid wood, polymer
Product weight: 3 lb
Light source: integrated LED
Light output: 345 Lumens (source)
Light color*: 2700 K or 3500 K
Color accuracy: 90+ CRI
Power usage: 3.2 W
Dimmable (see driver below)
Driver location: must be housed in J-box
Driver dimensions: 2" x 1.3" x 1", included
Brushed aluminum (CM-006) low-profile square canopy with white braided cord included
Canopy dimensions: 4.5" x 4.5", 0.38"
External LED driver (2.25" x 1.5" x 1")
Accent pendants can be clustered by using multi-point round canopy or multi-point linear canopy
See website for more canopy information
6'-0" drop length, field adjustable
Suitable for a sloped ceiling
Wood grain will vary
Specifications subject to change



MATERIAL & FINISH OPTIONS

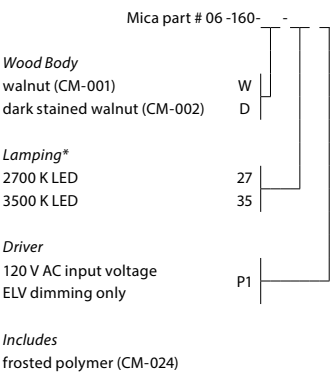

Includes
frosted polymer (CM-024)

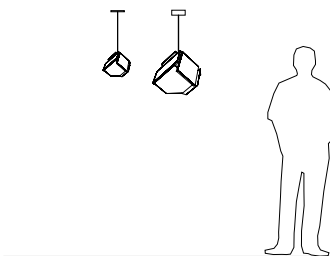

Claudo

Claudo
accent pendant

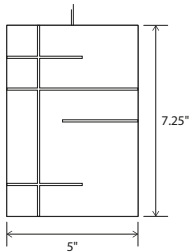

Dimensions: 5" x 5", 7.25"
Materials: solid wood, polymer
Product weight: 3 lb
Light source: integrated LED
Light output: 345 Lumens (source)
Light color*: 2700 K or 3500 K
Color accuracy: 90+ CRI
Power usage: 3.2 W
Dimmable (see driver below)
Driver location: must be housed in J-box
Driver dimensions: 2" x 1.3" x 1", included
Brushed aluminum (CM-006) low-profile square canopy with white braided cord included
Canopy dimensions: 4.5" x 4.5", 0.38"
Must use included external LED driver (2.25" x 1.5" x 1")
Accent pendants can be clustered by using multi-point round canopy or multi-point linear canopy
See website for more canopy information
72" drop length, field adjustable
Suitable for a sloped ceiling
Wood grain will vary
Specifications subject to change

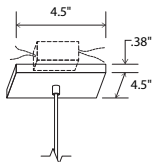

low-profile square canopy



walnut (CM-001)



dark stained walnut (CM-002)



Claudo, walnut

MATERIAL & FINISH OPTIONS

Claudo part # 06-110-		-
Wood Body	W	-
		D
walnut (CM-050)		
dark stained walnut (CM-002)		
Lamping*	27	
		35
2700 K LED		
3500 K LED		
Driver	P1	
120 V AC input voltage		
ELV dimming only		

Includes
frosted polymer (CM-024)

Also available in a sconce version

*Available in 3000K, 4000K and other color temperatures upon request



The Claudio showcases the beautiful natural walnut wood grain and sets it against the rigorous slits cut in each face as they wrap around the simple, clean shade form. A beautiful glow emanates from each slit, showing the striking rectilinear composition, in which all four sides are unique.

Nick Sheridan
Designer



Salix, brushed aluminum

Salix
accent pendant

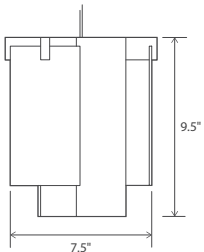

Dimensions: 7.5" x 7.5", 9.0"
Materials: solid wood, polymer, aluminum
Product weight: 3 lb
Light source: integrated LED
Light output: 345 Lumens (source)
Light color*: 2700 K or 3500 K
Color accuracy: 90+ CRI
Power usage: 3.2 W
Dimmable (see driver below)
Driver location: must be housed in J-box
Driver dimensions: 2" x 1.3" x 1", included
Brushed aluminum (CM-006) low-profile square canopy with white braided cord included
Canopy dimensions: 4.5" x 4.5", 0.38"
Must use included external LED driver (2.25" x 1.5" x 1")
Accent pendants can be clustered by using multi-point round canopy or multi-point linear canopy
See website for more canopy information
6'-0" drop length, field adjustable
Suitable for a sloped ceiling
Wood grain will vary
Specifications subject to change

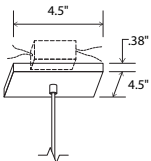

low-profile square canopy

MATERIAL & FINISH OPTIONS

Salix part # 06-120-W		A
Wood Body	W	-
walnut (CM-001)		
Metal Finish	A	-
brushed aluminum (CM-012)		
Lamping*	27	
		35
2700 K LED		
3500 K LED		
Driver	P1	
120VAC input voltage		
ELV dimming only		

Includes
frosted polymer (CM-024)

*Available in 3000K, 4000K and other color temperatures upon request



The Salix pendant's materials and proportions are in perfect harmony. The brushed aluminum set against the oiled walnut in this fixture still feels strikingly fresh and beautiful after years of production.

Nick Sheridan
Designer



Salix, brushed aluminum

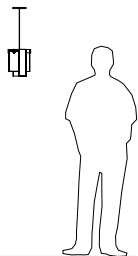
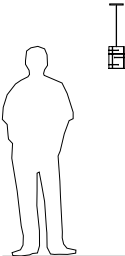



The Plura is a simple, straight forward fixture that is excellently executed. With the Plura it was about resolving the seams and edges and their relationships to one another. The result is a scalable fixture that has a sharp, sophisticated feel.

Nick Sheridan
Designer

BOBBY BERK INTERIORS AND DESIGN



Plura
pendant

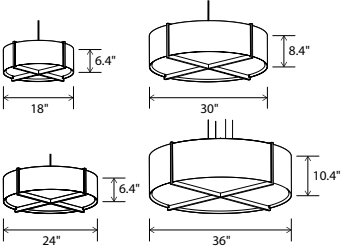

Dimensions:
Plura 18: 18" Ø, 6.4"
Plura 24: 24" Ø, 6.4"
Plura 30: 30" Ø, 8.4"
Plura 36: 36" Ø, 10.4"
Materials: solid wood, polymer
Product weight:
Plura 18: 5 lb
Plura 24: 6 lb
Plura 30: 9 lb
Plura 36: 13 lb

Integrated LED Specifications
Light output:
Plura 18 & 24: 1690 Lumens (source)
Plura 30 & 36: 2815 Lumens (source)
Light color*: 2700 K or 3500 K
Color accuracy: 90+ CRI
Power usage:
Plura 18 & 24: 19.5 W
Plura 30 & 36: 32.5 W
Dimmable (see driver below)
Plura 18 & 24 driver location: must be housed in J-box
Driver dimensions: 3.3" x 1.6" x 1", included
Plura 30 & 36 driver location: housed in canopy

GU-24 Base Specifications
Light source:
Plura 18 & 24: 2x GU-24 base socket
Plura 30 & 36: 4x GU-24 base socket
Lamping:
Plura 18 & 24: 2x GU-24 base, 18 W max each
Plura 30 & 36: 4x GU-24 base, 18 W max each
Bulbs not included
Input voltage: 300 V AC max

96" drop length, field adjustable
Suitable for a sloped ceiling
Wood grain will vary
Specifications subject to change

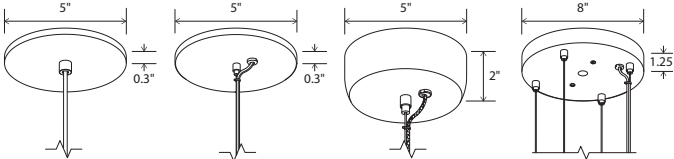

Plura 18 and Plura 24 low-profile round canopy with white SVT
Plura 30 GU-24 Base Sockets low-profile round canopy clear SPT with steel cable
Plura 30 Integrated LED extended round canopy, clear SPT with steel cable
Plura 36 8" round canopy clear SPT with four 1/16" Ø steel cables



MATERIAL & FINISH OPTIONS

Plura pendant part # 06-230-		
Ø:		
18" Ø	18	
24" Ø	24	
30" Ø	30	
36" Ø	36	
Wood Body		
walnut (CM-001)	W	
dark stained walnut (CM-002)	D	
white washed oak (CM-095)	O	
Shade Material		
frosted polymer (CM-051)	F	
matte black (CM-085)	B	
with matte white interior		
brushed aluminum (CM-012)	A	
brushed rose gold (CM-046)	G	
brushed brass (CM-047)	R	
distressed brass (CM-096)	D	
gloss white (CM-054)	W	
Lamping*		
2700 K LED	27	
3500 K LED	35	
GU-24 base sockets	GU	
Driver (LED version only)		
AC Input Voltage Range: 120-277 V		
120 V input: TRIAC, ELV & 0-10 V dimmable		
240 & 277 V input: only 0-10 V dimmable		
Includes frosted polymer (CM-051)		
*Available in 3000K, 4000K and other color temperatures upon request		

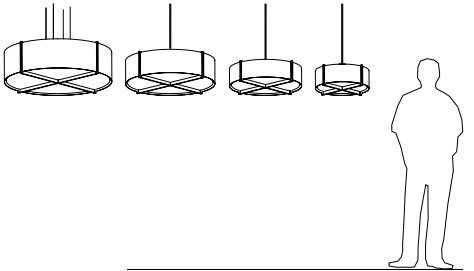

Ceiling Mount



Casia



Plura Ceiling Mount



Casia 14
ceiling mount

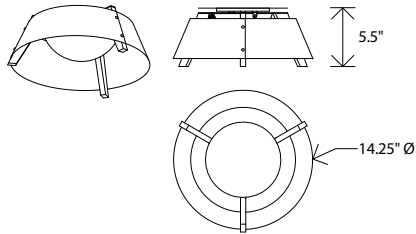

walnut
(CM-001)



dark stained
walnut (CM-002)



white washed oak
(CM-095)



matte black (CM-085)
with matte white interior



distressed brass
(CM-009)



gloss white
(CM-054)

Dimensions: 14.25" Ø, 5.5"
Product weight: 3 lb
Light output: minimum 831 Lumens (source)
See Lamping options below
Light Color Options*:
2700 K - 831 Lumens (source)
3500 K - 873 Lumens (source)
Color accuracy: 90+ CRI
Power usage: 10 W
Dimmable (see power options below)
Wood grain will vary
Specifications subject to change



MATERIAL & FINISH OPTIONS

Casia 14 part # 08-110-14

Shade Material

matte black (CM-085) with matte
white interior
distressed brass (CM-009)
gloss white (CM-054)

B
D
W

Wood Body

walnut (CM-001)
dark stained walnut (CM-002)
white washed oak (CM-095)

W
D
O

Lamping

2700 K LED - 831 Lumens (source)
3500 K LED - 873 Lumens (source)

27
35

Power Option

120-277 V AC input voltage
TRIAC and ELV dimming

P1

Includes: white glass diffuser (CM-109)
Available in a pendant version
*Available in 3000K, 4000K and other color temperatures
upon request



Casia 14, white washed oak, gloss white



Casia detail

Casia is a fresh and innovative approach to a ceiling mount light fixture. Each carefully selected material plays an integral role in the aesthetic design and performance. The wood arms, metal shade, and glass diffuser combine to create a minimalist form well suited for a modern environment or a more traditional space. The 14" version works well in bathrooms, closets, narrow corridors, and smaller kitchens. The 18" and 22" sizes are incredibly dynamic and work well in different environments such as commercial, residential, and hospitality applications.

Casia 18
ceiling mount

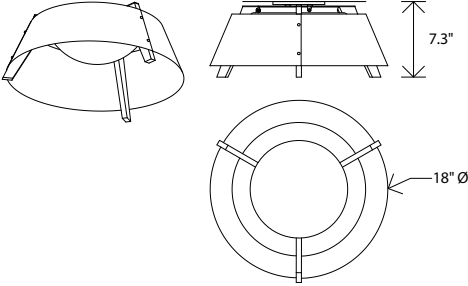

Dimensions: 18" Ø, 7.3"
Product weight: 4 lb
Light output: minimum 1310 Lumens (source)
See Lamping options below
Light Color Options*:
2700 K - 1310 Lumens (source)
3500 K - 1378 Lumens (source)
Color accuracy: 90+ CRI
Power usage: 15 W
Dimmable (see power options below)
Wood grain will vary
Specifications subject to change



MATERIAL & FINISH OPTIONS

Casia 18 part # 08-110-18

Shade Material

matte black (CM-085) with matte
white interior
distressed brass (CM-009)
gloss white (CM-054)

B
D
W

Wood Body

walnut (CM-001)
dark stained walnut (CM-002)
white washed oak (CM-095)

W
D
O

Lamping*

2700 K LED - 1310 Lumens (source)
3500 K LED - 1378 Lumens (source)

27
35

Power Option

120-277 V AC input voltage
TRIAC and ELV dimming

P1

Includes: white glass diffuser (CM-109)
Available in a pendant version
*Available in 3000K, 4000K and other color temperatures
upon request



walnut
(CM-001)



dark stained
walnut (CM-002)



white washed oak
(CM-095)



matte black (CM-085)
with matte white interior



distressed brass
(CM-009)



gloss white
(CM-054)



Casia 18, dark stain walnut, matte black with matte white interior

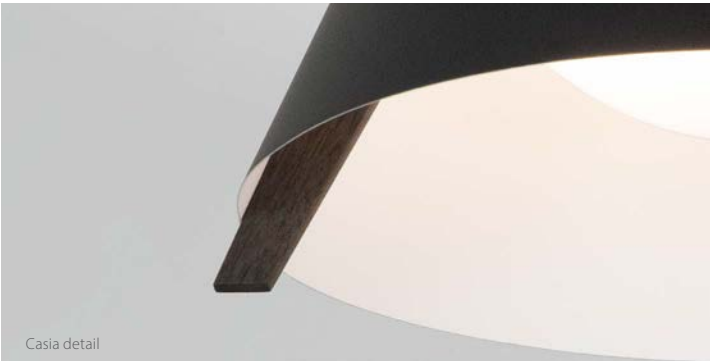

Casia detail

Casia is a fresh and innovative approach to a ceiling mount light fixture. Each carefully selected material plays an integral role in the aesthetic design and performance. The wood arms, metal shade, and glass diffuser combine to create a minimalist form well suited for a modern environment or a more traditional space. The 14" version works well in bathrooms, closets, narrow corridors, and smaller kitchens. The 18" and 22" sizes are incredibly dynamic and work well in different environments such as commercial, residential, and hospitality applications.

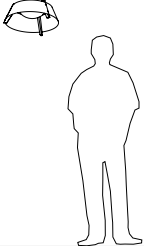
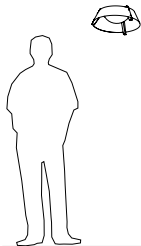



Casia 22, dark stain walnut, distressed brass



Casia detail

Casia is a fresh and innovative approach to a ceiling mount light fixture. Each carefully selected material plays an integral role in the aesthetic design and performance. The wood arms, metal shade, and glass diffuser combine to create a minimalist form well suited for a modern environment or a more traditional space. The 14" version works well in bathrooms, closets, narrow corridors, and smaller kitchens. The 18" and 22" sizes are incredibly dynamic and work well in different environments such as commercial, residential, and hospitality applications.

Casia 22
ceiling mount

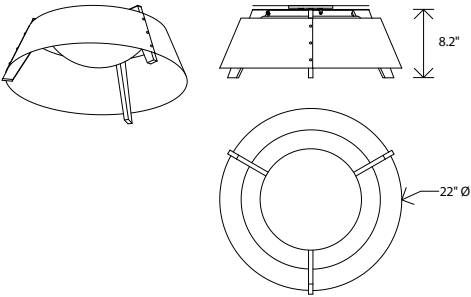

Dimensions: 21.5" Ø, 8.2"
Product weight: 5 lb
Light output: minimum 1981 Lumens (source)
See Lamping options below
Light Color Options*:
2700 K - 1981 Lumens (source)
3500 K - 2083 Lumens (source)
Color accuracy: 90+ CRI
Power usage: 23 W
Dimmable (see power options below)
Wood grain will vary
Specifications subject to change

MATERIAL & FINISH OPTIONS

Casia 22 part # 08-110-22		
Shade Material		
matte black (CM-085) with matte white interior	B	
distressed brass (CM-009)	D	
gloss white (CM-054)	W	
Wood Body		
walnut (CM-001)	W	
dark stained walnut (CM-002)	D	
white washed oak (CM-095)	O	
Lamping*		
2700 K LED - 1981 Lumens (source)	27	
3500 K LED - 2083 Lumens (source)	35	
Power Option		
120-277 V AC input voltage TRIAC and ELV dimming	P1	

Includes: white glass diffuser (CM-109)
Available soon in a pendant version
*Available in 3000K, 4000K and other color temperatures upon request



walnut
(CM-001)



dark stained
walnut (CM-002)



white washed oak
(CM-095)



matte black (CM-085)
with matte white interior

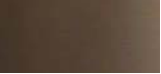

distressed brass
(CM-009)



gloss white
(CM-054)

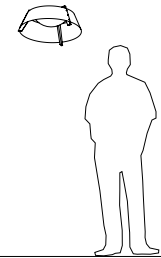



Plura 36 ceiling mount, walnut

The Plura is a simple, straight forward fixture that is excellently executed. With the Plura it was about resolving the seams and edges and their relationships to one another. The result is a scalable fixture that has a sharp, sophisticated feel.

Nick Sheridan
Designer

white washed oak
(CM-095)

walnut
(CM-001)

dark stained
walnut (CM-002)

frosted polymer
(CM-051)

matte black (CM-085)
with matte white interior

brushed aluminum
(CM-012)

brushed rose gold
(CM-046)

brushed brass
(CM-047)

distressed brass
(CM-096)

gloss white
(CM-054)

Plura
ceiling mount

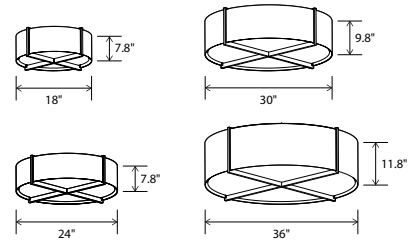

Dimensions:
Plura 18: 18" Ø, 7.8"
Plura 24: 24" Ø, 7.8"
Plura 30: 30" Ø, 9.8"
Plura 36: 36" Ø, 11.8"
Materials: solid wood, metal, polymer
Product weight:
Plura 18: 5 lb
Plura 24: 6 lb
Plura 30: 9 lb
Plura 36: 13 lb

Integrated LED Specifications
Light output:
Plura 18 & 24: 1690 Lumens (source)
Plura 30 & 36: 2815 Lumens (source)
Light color: 2700 K or 3500 K
Color accuracy: 90+ CRI
Power usage:
Plura 18 & 24: 19.5 W
Plura 30 & 36: 32.5 W
Dimmable (see driver below)

GU-24 Base Specifications
Light source:
Plura 18 & 24: 2x GU-24 base socket
Plura 30 & 36: 4x GU-24 base socket
Lamping:
Plura 18 & 24: 2x GU-24 base, 18 W max each
Plura 30 & 36: 4x GU-24 base, 18 W max each
Bulbs not included
Input voltage: 300 V AC max

Suitable for a sloped ceiling
Wood grain will vary
Specifications subject to change

Emergency backup option available upon request
Also available in a pendant version

MATERIAL & FINISH OPTIONS

Plura ceiling mount part # 08-100-			
Ø:			
18" Ø	18		
24" Ø	24		
30" Ø	30		
36" Ø	36		
Wood Body			
walnut (CM-001)	W		
dark stained walnut (CM-002)	D		
white washed oak (CM-095)	O		
Shade Material			
frosted polymer (CM-051)	F		
matte black (CM-085)	B		
with matte white interior			
brushed aluminum (CM-012)	A		
brushed rose gold (CM-046)	G		
brushed brass (CM-047)	R		
distressed brass (CM-096)	D		
gloss white (CM-054)	W		
Lamping			
2700 K LED	27		
3500 K LED	35		
GU-24 base sockets	GU		
Driver (LED version only)			
AC Input Voltage Range:			
120-277 V			
120 V input: TRIAC, ELV & 0-10 V dimmable			
240 & 277 V input: only 0-10 V dimmable			

Includes
frosted polymer (CM-051)

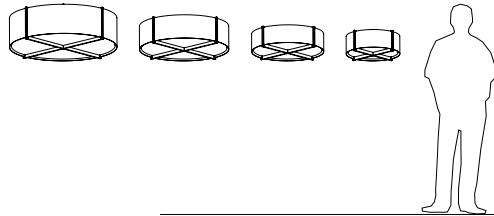

Outdoor Sconces



Tersus Outdoor



Calx Outdoor



Ansa Outdoor



Acuo Outdoor



Creo Outdoor



Dea Outdoor



Tersus Outdoor
sconce

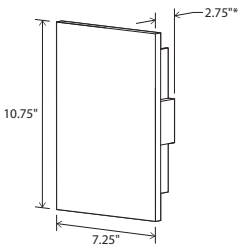

Dimensions: 10.75" x 7.25" x 2.75" (3.5" concrete)
Product weight: 4 lb (9 lb concrete)
Light source: integrated LED
Light output: see options below
Light color options: 2700 K, 3000K, 3500 K, or 4000 K
Color accuracy: 90+ CRI
Power usage: 13 W
Dimmable (see options below)
UL listed for wet locations, suitable for use indoor and outdoors
Antique bronze and concrete finishes will vary
Antique bronze is a living finish and will change over time depending
on environmental conditions
Custom backlit address or room numbers available
Specifications subject to change
J-box centered behind fixture



MATERIAL & FINISH
OPTIONS

Tersus part # 03-242-

Shade Material			
white concrete (CM-104)	W		
black concrete (CM-105)	B		
marine grade brushed stainless steel (CM-102)	S		
antique bronze (CM-103)	R		
textured black powdercoat (CM-099)	K		
textured white powdercoat (CM-100)	Y		
matte grey powdercoat (CM-101)	G		
Lamping			
2700 K LED	27		
3000 K LED	30		
3500 K LED	35		
4000 K LED	40		
Light Distribution and Driver Options			
Uplight & Downlight			
120-277 V AC input voltage			
Standard output - 1130 Lumens (source)			
120 V input: TRIAC, ELV & 0-10 V dimmable	P1		
240 & 277 V input: only 0-10 V dimmable			
Reduced output - 540 Lumens (source)			
Nondimmable	PR		
Downlight Only - Dark Sky Compliant			
120-277 V AC input voltage			
Standard output - 1130 Lumens (source)			
120 V input: TRIAC, ELV & 0-10 V dimmable	D1		
240 & 277 V input: only 0-10 V dimmable			
Reduced output - 540 Lumens (source)			
Nondimmable	DR		

Includes
marine grade brushed stainless steel (CM-102)
(except for Antique Bronze version)
2700 K & 3000 K downlight only options are dark sky compliant



Tersus Outdoor, antique bronze



Textured white powdercoat



Black concrete

Cerno's Tersus Outdoor sconce is an existing design that we modified to withstand the elements. The materials and components were meticulously designed and engineered to comply and pass UL's wet location requirements.

Nick Sheridan
Designer



textured white powdercoat



antique bronze



marine grade brushed stainless steel

Cerno's Calx Outdoor sconce is an existing design that we modified to withstand the elements. The materials and components were meticulously designed and engineered to comply and pass UL's wet location requirements.

Nick Sheridan
Designer

Calx Outdoor
sconce

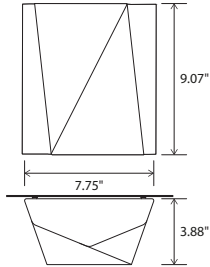

Dimensions: 9.07" x 7.75" x 3.88"
Product weight: 2 lb
Light source: integrated LED
Light output: see options below
Light color options: 2700 K, 3000K, 3500 K, or 4000 K
Color accuracy: 90+ CRI
Power usage: 13 W
Dimmable (see options below)
UL listed for wet locations, suitable for use indoor and outdoors
Antique bronze finishes will vary
Antique bronze is a living finish and will change over time
depending on environmental conditions
Custom backlit address or room numbers available
Specifications subject to change
J-box centered behind fixture



MATERIAL & FINISH
OPTIONS

Calx Outdoor Sconce part # 03-244 -

Shade Material			
marine grade brushed stainless steel (CM-102)	S		
antique bronze (CM-103)	R		
textured black powdercoat (CM-099)	K		
textured white powdercoat (CM-100)	Y		
matte grey powdercoat (CM-101)	G		
Lamping			
2700 K LED	27		
3000 K LED	30		
3500 K LED	35		
4000 K LED	40		
Light Distribution and Driver Options			
Uplight & Downlight			
120-277 V AC input voltage			
Standard output - 1130 Lumens (source)			
120 V input: TRIAC, ELV & 0-10 V dimmable	P1		
240 & 277 V input: only 0-10 V dimmable			
Reduced output - 540 Lumens (source)			
Nondimmable	PR		
Downlight Only - Dark Sky Compliant			
120-277 V AC input voltage			
Standard output - 1130 Lumens (source)			
120 V input: TRIAC, ELV & 0-10 V dimmable	D1		
240 & 277 V input: only 0-10 V dimmable			
Reduced output - 540 Lumens (source)			
Nondimmable	DR		

2700 K & 3000 K downlight only options are dark sky compliant



marine grade brushed stainless steel (CM-102)



antique bronze (CM-103)



textured black powdercoat (CM-099)



textured white powdercoat (CM-100)



matte grey powdercoat (CM-101)

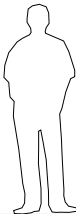

Ansa Outdoor
sconce

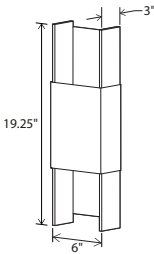

Dimensions: 19.25" x 6" x 3"
Product weight: 5 lb
Light source: integrated LED
Light output: see options below
Light color options: 2700 K, 3000K, 3500 K, or 4000 K
Color accuracy: 90+ CRI
Power usage: 13 W
Dimmable (see options below)
UL listed for wet locations, suitable for use indoor and outdoors
Antique bronze finishes will vary
Antique bronze is a living finish and will change over time depending on environmental conditions
Custom backlit address or room numbers available
Specifications subject to change
J-box centered behind fixture



MATERIAL & FINISH OPTIONS

Ansa Outdoor part # 03-243-



marine grade brushed stainless steel (CM-102)



antique bronze (CM-103)



textured black powdercoat (CM-099)



textured white powdercoat (CM-100)



matte grey powdercoat (CM-101)

Shade Material

marine grade brushed stainless steel (CM-102) S
antique bronze (CM-103) R
textured black powdercoat (CM-099) K
textured white powdercoat (CM-100) Y
matte grey powdercoat (CM-101) G

Lamping

2700 K LED 27
3000 K LED 30
3500 K LED 35
4000 K LED 40

Light Distribution and Driver Options

Uplight & Downlight

120-277 V AC input voltage
Standard output - 1130 Lumens (source)
120 V input: TRIAC, ELV & 0-10 V dimmable P1
240 & 277 V input: only 0-10 V dimmable
Reduced output - 540 Lumens (source) PR
Nondimmable



antique bronze



matte grey powdercoat



white powdercoat

Cerno's Ansa Outdoor sconce is an existing design that we modified to withstand the elements.
The materials and components were meticulously designed and engineered to comply and pass UL's wet location requirements.

Nick Sheridan
Designer

Acuo Outdoor
sconce

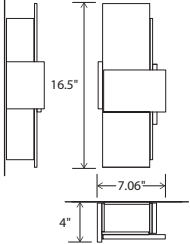

Dimensions: 16.5" x 7.06" x 4"
Product weight: 6 lb
Light source: integrated LED
Light output: see options below
Light color options: 2700 K, 3000K, 3500 K, or 4000 K
Color accuracy: 90+ CRI
Power usage: 13 W
Dimmable (see options below)
UL listed for wet locations, suitable for use indoor and outdoors
Specifications subject to change
J-box centered behind fixture



MATERIAL & FINISH OPTIONS

Acuo Outdoor part # 03-241-

Shade Material

textured black powdercoat (CM-099) K
textured white powdercoat (CM-100) Y
matte grey powdercoat (CM-101) G

Lamping

2700 K LED 27
3000 K LED 30
3500 K LED 35
4000 K LED 40

Light Distribution and Driver Options

Uplight & Downlight

120-277 V AC input voltage
Standard output - 1130 Lumens (source)
120 V input: TRIAC, ELV & 0-10 V dimmable P1
240 & 277 V input: only 0-10 V dimmable
Reduced output - 540 Lumens (source) PR
Nondimmable

Includes

frosted polymer (CM-024)



textured black powdercoat (CM-099)



textured white powdercoat (CM-100)



matte grey powdercoat (CM-101)



Powdercoat Black



matte grey powdercoat



powdercoat white

Cerno's Acuo Outdoor sconce is an existing design that we modified to withstand the elements.
The materials and components were meticulously designed and engineered to comply and pass UL's wet location requirements.

Nick Sheridan
Designer

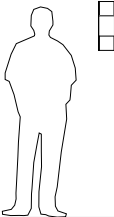
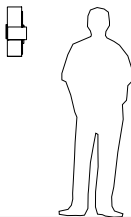

Creo
outdoor sconce

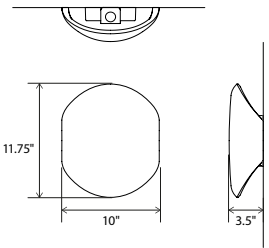

Dimensions: 11.75" x 10" x 3.5"
Product weight: 6 lb
Light source: integrated LED
Light output: see options below
Light color options: 2700 K, 3000 K, 3500 K, or 4000 K
Color accuracy: 90+ CRI
Power usage: 14 W
Dimmable (see options below)
UL listed for wet locations, suitable for use indoor and outdoors
Specifications subject to change



MATERIAL & FINISH OPTIONS

Creo part # 03-245-

Shade Finish
Natural Terracotta (CM-125)

Lamping*
2700 K LED
3000 K LED
3500 K LED
4000 K LED

Light Distribution and Driver Options

Uplight & Downlight
120-277 V AC input voltage
Standard output - 1130 Lumens (source)
120 V input - TRIAC, ELV & 0-10 V dimmable
240 & 277 V input - only 0-10 V dimmable

Reduced output - 540 Lumens (source)
Nondimmable

Downlight Only
120-277 V AC input voltage
Standard output - 1130 Lumens (source)
120 V input - TRIAC, ELV & 0-10 V dimmable
240 & 277 V input - only 0-10 V dimmable

Reduced output - 540 Lumens (source)
Nondimmable

J-box centered behind fixture



The Creo's ceramic shade is hand-crafted in Laguna Beach by ceramic artists Scott and Naomi Schoenherr for Cerno. The terracotta is unglazed, accentuating the clay's natural red earth coloring. The modern form works well in clean minimalist outdoor and indoor environments as well as in more transitional spaces. Inspired by nature and designed to handle the elements.

Dea
outdoor sconce

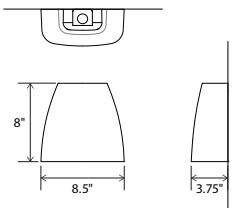

Dimensions: 8" x 8.5" x 3.75"
Product weight: 5 lb
Light source: integrated LED
Light output: see options below
Light color options: 2700 K, 3000 K, 3500 K, or 4000 K
Color accuracy: 90+ CRI
Power usage: 14 W
Dimmable (see options below)
UL listed for wet locations, suitable for use indoor and outdoors
Specifications subject to change



MATERIAL & FINISH OPTIONS

Dea part # 03-246-

Shade Finish
natural terracotta (CM-125)

Lamping*
2700 K LED
3000 K LED
3500 K LED
4000 K LED

Light Distribution and Driver Options

Uplight & Downlight
120-277 V AC input voltage
Standard output - 1130 Lumens (source)
120 V input - TRIAC, ELV & 0-10 V dimmable
240 & 277 V input - only 0-10 V dimmable

Reduced output - 540 Lumens (source)
Nondimmable

Downlight Only
120-277 V AC input voltage
Standard output - 1130 Lumens (source)
120 V input - TRIAC, ELV & 0-10 V dimmable
240 & 277 V input - only 0-10 V dimmable

Reduced output - 540 Lumens (source)
Nondimmable

J-box centered behind fixture



The Dea's ceramic shade is hand-crafted in Laguna Beach by ceramic artists Scott and Naomi Schoenherr for Cerno. The terracotta is unglazed, accentuating the clay's natural red earth coloring. The modern form works well in clean minimalist outdoor and indoor environments as well as in more transitional spaces. Inspired by nature and designed to handle the elements.

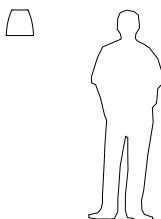
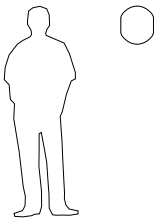

Vanity Lighting



Allavo, walnut



Allavo



Merus

Allavo

vanity sconce

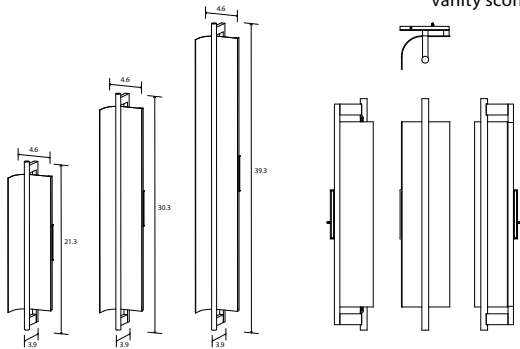

Allavo 22 dimensions: 21.3" x 4.6" x 3.9"
Allavo 31 dimensions: 30.3" x 4.6" x 3.9"
Allavo 40 dimensions: 39.3" x 4.6" x 3.9"

Allavo 22/31 weight: 2 lb

Allavo 40 weight: 3 lb

Light source: integrated LED

Allavo 22 light output: 780 Lumens (source)

Allavo 31 light output: 1170 Lumens (source)

Allavo 40 light output: 1560 Lumens (source)

Light color options: 2700 K, 3000K, 3500 K, or 4000 K

Color accuracy: 90+ CRI

Allavo 22 power usage: 11 W

Allavo 31 power usage: 16 W

Allavo 40 power usage: 21 W

Dimmable (see options below)

Specifications subject to change

Driver location: must be housed in J-box

Allavo 22 driver dimensions: 2.63" x 1.25" x 0.8", included

Allavo 31 driver dimensions: 3.0" x 1.0" x 1.5", included

Allavo 40 driver dimensions: 2.82" x 2.5" x 1.2", included

The Allavo can be oriented as a vertical sconce or horizontal sconce. When oriented vertically, a right or left orientation can be achieved by flipping the fixture vertically.



MATERIAL & FINISH OPTIONS

Allavo part # 03-250-

Size

22"

31"

40"

Metal Finish

matte black (CM-085) exterior

with matte white reflector

matte white (CM-107) exterior

with matte white reflector

Wood Finish

walnut (CM-001)

dark stained walnut (CM-002)

white washed oak (CM-095)

Lamping

2700 K LED

3000 K LED

3500 K LED

4000 K LED

Driver

120 V AC input voltage

TRIAC, ELV & 0-10 V dimming

277 V AC input voltage

TRIAC, ELV & 0-10 V dimming

Includes

brushed aluminum (CM-006)

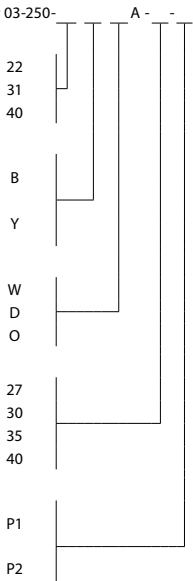

matte white, walnut



matte white



Cerno's product development team prioritized the utility of the Allavo vanity, while not ignoring the importance of the aesthetic. Drawing from our experience with product photography, we knew that a large diffuse light source was the key to achieving our goal. The novel design uses indirect lighting that bounces off a curved metal surface. Cerno's signature use of wood is integrated seamlessly into a design we believe harmonizes usefulness and beauty.

Merus

sconce

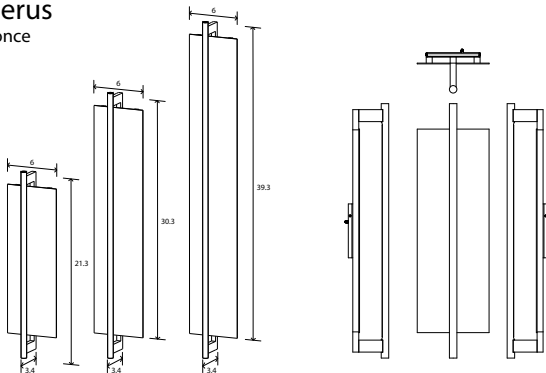

Merus 22 dimensions: 21.3" x 6" x 3.4"

Merus 31 dimensions: 30.3" x 6" x 3.4"

Merus 40 dimensions: 39.3" x 6" x 3.4"

Merus 22/31 weight: 2 lb

Merus 40 weight: 3 lb

Light source: integrated LED

Merus 22 light output: 780 Lumens (source)

Merus 31 light output: 1170 Lumens (source)

Merus 40 light output: 1560 Lumens (source)

Light color options: 2700 K, 3000 K, 3500 K, or 4000 K

Color accuracy: 90+ CRI

Merus 22 power usage: 11 W

Merus 31 power usage: 16 W

Merus 40 power usage: 21 W

Dimmable (see options below)

Specifications subject to change

Driver location: must be housed in J-box

Merus 22 driver dimensions: 2.63" x 1.25" x 0.8", included

Merus 31 driver dimensions: 3.0" x 1.0" x 1.5", included

Merus 40 driver dimensions: 2.82" x 2.5" x 1.2", included

The Merus can be oriented as a vertical sconce or horizontal sconce. When oriented vertically, a right or left orientation can be achieved by flipping the fixture vertically.



MATERIAL & FINISH OPTIONS

Merus part # 03-251-

Size

22"

31"

40"

Wood Finish

walnut (CM-001)

dark stained walnut (CM-002)

white washed oak (CM-095)

Lamping

2700 K LED

3000 K LED

3500 K LED

4000 K LED

Driver

120 V AC input voltage

TRIAC, ELV & 0-10 V dimming

277 V AC input voltage

TRIAC, ELV & 0-10 V dimming

Includes

matte black (CM-085) exterior with matte white reflector

brushed aluminum (CM-006)

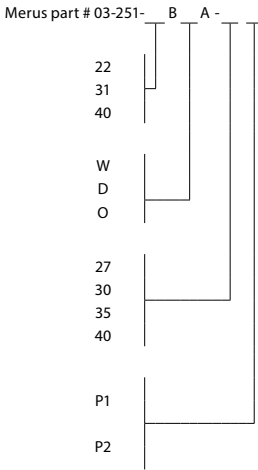

matte white, white washed oak



walnut



Merus is a quintessential Cerno design. Clean, modern lines paired with a novel indirect light source compose a form that balances beauty and usefulness. Our team used Cerno's signature material palette of wood and metal.

Acuo, walnut



walnut (CM-001)



dark stain walnut (CM-002)



white washed oak (CM-095)



matte black (CM-085) exterior with matte white reflector

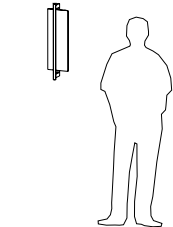

Sconces

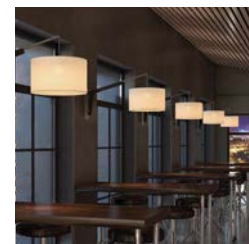

Talea



Talea



Tersus



Sedo



Via

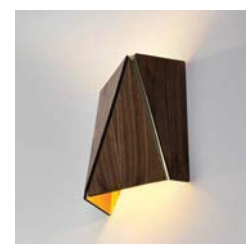

Calx Sconce



Ansa



Ansa



Penna



Vesper



Fortis

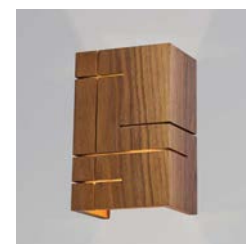

Claudo Sconce



Acuo



Acuo



Libri



Levo



Capio family



Oris



Talea, burlap shade, walnut body, textured black powdercoat



white linen shade, dark stained walnut, brushed aluminum



black amaretto shade, dark stained walnut, textured black powdercoat



The adaptive and interactive features of the Talea introduced exciting challenges to the design process. I believe we found a balance that allows this fixture to thrive in a range of spaces and different applications. I am really pleased with how the design language turned out, specifically how the expressive hinge suggests its ability to swing, and how the wood to metal arm detailing suggests the arm can telescope. It's a beautiful mixture of utility and elegance.

Nick Sheridan
Designer

Talea, white linen shade, dark stained walnut body, brushed aluminum,

Talea
articulate wall sconce

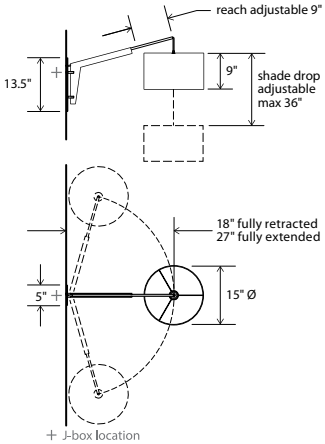

Dimensions: 18.38" x 5" x 34.75", 15" Ø shade
Materials: solid wood, metal
Product weight: 5 lb
Light source: medium base E26 socket
Lamping: E26 base, type A lamp, 60 W max
Bulb not included
Input voltage: 250 V AC max
Clear SVT-3 cord included
Top and bottom diffusers included (CM-051)
Wood grain will vary
Specifications subject to change
Patent No.: US D846,180 S



SWING ARM LENGTH

Arm length (from the wall to center of shade)
can be adjusted between 18" and 27"

DROP LENGTH

Max drop length from tip of extended arm to top
of shade is 36"

SWING ARM ROTATION

Adjustable resistance in pivot hinge

MATERIAL & FINISH OPTIONS

Talea part # 03-210-

Metal Finish

brushed aluminum (CM-006) A
textured black powdercoat (CM-049) B

Wood Body

walnut (CM-001) W
dark stained walnut (CM-002) D

Fabric Shade

burlap (CM-017) N
white linen (CM-016) L
black amaretto (CM-018) A

Includes

frosted polymer diffuser (CM-051)

For additional products that utilize the swing arm
bracket, please see our Motus Swing Arm Bracket
on page 78



brushed aluminum
(CM-006)



textured black
(CM-049)



walnut
(CM-001)



dark stained walnut
(CM-002)



burlap
(CM-017)



white linen
(CM-016)



black amaretto
(CM-018)

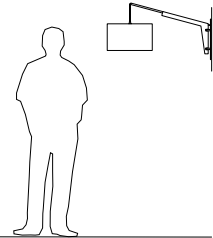

Via
sconce or ceiling ceiling mount

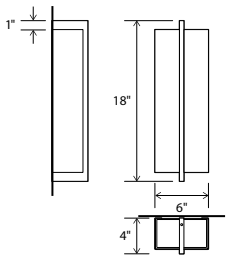

Dimensions: 18" x 6" x 4"
Materials: solid wood, polymer
Product weight: 2 lb

Integral LED Specifications

Light output: 500 Lumens (source)
Light color*: 2700 K or 3500 K
Color accuracy: 90+ CRI
Power usage: 7 W
Dimmable (see driver below)
Input voltage: 24 V DC (driver included)
Driver location: must be housed in J-box
Driver dimensions: 3" x 1.5" x 1"
Mounting: ceiling or wall

Candelabra Base Specifications

Lamping: 2x candelabra E12 base sockets,
10 W max each (bulbs not included)
Select bulbs can achieve over 500 lumens each
Input voltage: 120 V AC max
Mounting: wall only



MATERIAL & FINISH OPTIONS

Via part # 03-190-	
Wood Body	
walnut (CM-001)	W
dark stained walnut (CM-002)	D
Lamping*	
2700 K LED	27
3500 K LED	35
Candelabra E12 socket	CB
Driver (LED version only)	
120 V AC input voltage	P1
TRIAC, ELV & 0-10V dimming	
277 V AC input voltage	P2
TRIAC, ELV & 0-10V dimming	

Includes
frosted polymer (CM-051)
Inquire about other input voltages
Emergency backup option available upon request
*Available in 3000K, 4000K and other color
temperatures upon request



Via, walnut, candelabra E12 socket



Via, walnut, LED



Via ceiling flushmount, walnut, LED

*The Via has an understated geometry with sophisticated detailing and proportion
The substantial glowing volume of the Via is punctuated by a thin plane of rich American
walnut striking a balance and harmony.*

Nick Sheridan
Designer

Calx

sconce

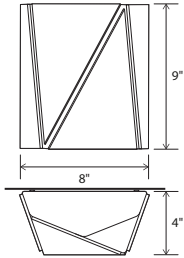

Dimensions: 8" x 9" x 4"

Materials: wood, metal

Product weight: 2 lb

Light source: integrated LED

Light output: 1130 Lumens (source)

Light color*: 2700 K or 3500 K

Color accuracy: 90+ CRI

Power usage: 13 W

Dimmable (see driver below)

Wood grain will vary

Specifications subject to change



MATERIAL & FINISH OPTIONS

Calx sconce part # 03-138-	
Metal Finish	
brushed aluminum (CM-012)	A
brushed rose gold (CM-046)	G
brushed brass (CM-047)	R
Wood Finish	
walnut (CM-055)	W
dark stained walnut (CM-056)	D
Lamping*	
2700 K LED	27
3500 K LED	35
Driver	
AC Input Voltage Range:	
120-277 V	
120 V input: TRIAC, ELV & 0-10 V dimmable	P1
240 & 277 V input: only 0-10 V dimmable	

Calx pendants also available. [Click here.](#)
*Available in 3000K, 4000K and other color
temperatures upon request

*Inspired by the Calx pendant, the materials and method inform the
design greatly. While the Calx sconce is clean and simple, it also
offers a beautiful texture and subtle complexity to a wall.*

Nick Sheridan
Designer



Calx, walnut, brushed brass

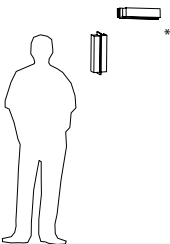

* LED version only

Penna 16 / Penna 40 / Penna 64
sconce

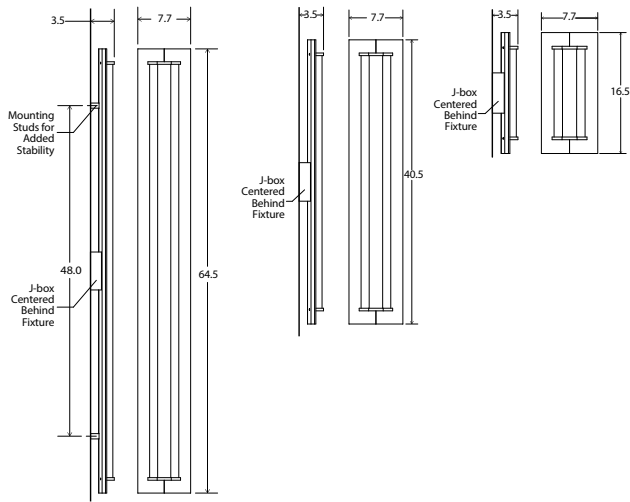

Penna 16 dimensions: 16.5" x 7.7" x 3.5"
Penna 40 dimensions: 40.5" x 7.7" x 3.5"
Penna 64 dimensions: 64.5" x 7.7" x 3.5"

MATERIAL & FINISH OPTIONS

Penna sconce part # 03-220-		B	-
Penna 16	16		
Penna 40	40		
Penna 64	64		
Metal Finish		R	
brushed brass (CM-008)		D	
Wood Body		W	
walnut (CM-001)		D	
dark stained walnut (CM-002)			
Lamping*		27	
2700 K LED		35	
3500 K LED			
Driver		P1	
120 V AC input voltage		P2	
TRIAC, ELV & 0-10 V dimming			
277 V AC input voltage			
TRIAC, ELV & 0-10 V dimming			
Includes			
frosted polymer (CM-057)			
*Available in 3000K, 4000K and other			
color temperatures upon request			

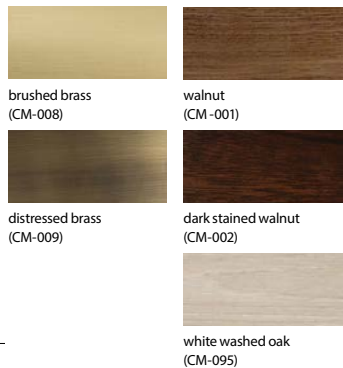

On our Cerno journey, we continue to evolve as designers and craftsmen. The Penna is a celebration of us drawing and reflecting on our last ten years. This design is an embodiment of all the lessons that we have learned from designing and building thousands of lights. This fixture balances utility and sophisticated beauty well. The walnut, brass, and leather work in concert to compose a modern form with materials that have been used for thousands of years.

Nick Sheridan
Designer



Vesper
sconce

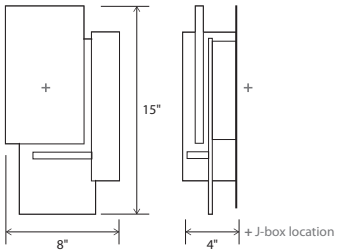

Dimensions: 15" x 8" x 4"
Materials: solid wood, polymer, aluminum
Product weight: 4 lbs
Light source: integrated LED
Light output: 1130 Lumens (source)
Light color*: 2700 K or 3500 K
Color accuracy: 90+ CRI
LED power consumption: 13W
Dimmable (see driver below)
ADA compliant hotel room signage with tactile numbering and corresponding braille available
Wood grain will vary
Specifications subject to change



MATERIAL & FINISH OPTIONS

Vesper part # 03-132-		-
Wood Body	W	
walnut (CM-001)	D	
dark stained walnut (CM-002)		
Lamping*		27
2700 K LED		35
3500 K LED		
Driver		P1
AC Input Voltage Range:		
120-277 V		
120 V input: TRIAC, ELV & 0-10 V dimmable		
240 & 277 V input: only 0-10 V dimmable		
Includes		
frosted polymer (CM-024)		
brushed aluminum (CM-006)		
*Available in 3000K, 4000K and other color		
temperatures upon request		

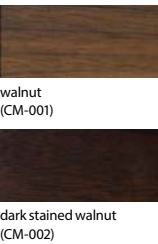

The Vesper is a very simple geometric sculpture composed of brushed aluminum, American black walnut, and white polymer. The light not only washes up and down the wall but also filters out through the composition, exhibiting the fixture's depth in three dimensions.

Nick Sheridan
Designer

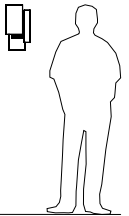

Acuo
sconce

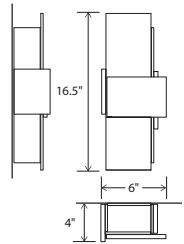

Dimensions: 16.5" x 6" x 4"
Materials: solid wood, polymer, aluminum
Product weight:
3 lb (CM-001/CM-002)
5 lb (CM-006)
Integrated LED Specifications
Light output: 1130 Lumens (source)
Light color*: 2700 K or 3500 K
Color accuracy: 90+ CRI
Power usage: 14 W
Dimmable (see driver below)

GU-24 Base Specifications
Lamping: 2x GU-24 base sockets, 18 W max each
Input voltage: 300 V AC max

ADA compliant hotel room signage with tactile
numbering and corresponding braille available

Wood grain will vary
Specifications subject to change



MATERIAL & FINISH OPTIONS

Acuo part # 03-130-

<i>Body</i>	
walnut (CM-001)	W
dark stained walnut (CM-002)	D
brushed aluminum (CM-006)	A
<i>Lamping*</i>	
2700 K LED	27
3500 K LED	35
GU-24 base sockets	GU
<i>Driver (LED version only)</i>	
AC Input Voltage Range: 120-277 V	
120 V input: TRIAC, ELV & 0-10 V dimmable	P1
240 & 277 V input: only 0-10 V dimmable	

Includes
frosted polymer (CM-024)
J-box centered behind wood/
aluminum body
*Available in 3000K, 4000K and
other color temperatures upon
request



Acuo, walnut



Acuo, walnut



Acuo, brushed aluminum

*It's a 3 sided box, which has been carefully deconstructed to a sculptural state. The careful
composition of overlap and void create interest and complexity to a very straightforward, well-
functioning wall sconce. The tectonic disconnection in form allows you to witness the solid
American black walnut's grain as it travels through each solid block.*

Nick Sheridan
Designer

Emergency backup option available upon request, requires oversized J-box.



Acuo, walnut

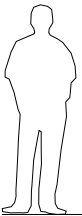

Capio S
sconce

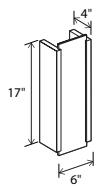

Dimensions: 17" x 6" x 4"
Materials: solid wood, polymer
Product weight: 4 lb
Light source: integrated LED
Light output: 500 Lumens (source)
Light color*: 2700 K or 3500 K
Color accuracy: 90+ CRI
Power usage: 7 W
Dimmable (see driver below)
Input voltage: 24 V DC (driver included)
Driver location: must be housed in J-box
Driver dimensions: 2.6" x 1.3" x 0.8" ADA
compliant hotel room signage with tactile
numbering and corresponding braille available
Wood grain will vary
Specifications subject to change



MATERIAL & FINISH OPTIONS

Capio S part # 03-180- S	
Wood Body	
walnut (CM-001)	W
dark stained walnut (CM-002)	D
maple (CM-005)	M
Lamping*	
2700 K LED	27
3500 K LED	35
Driver	
120 V AC input voltage	P1
TRIAC, ELV & 0-10 V dimming	
277 V AC input voltage	P2
TRIAC, ELV & 0-10 V dimming	
Includes	
frosted polymer (CM-024)	

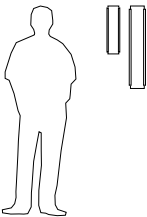

Capio L
sconce



Dimensions: 28.5" x 6" x 4"
Materials: solid wood, polymer
Product weight: 7 lb
Light source: integrated LED
Light output: 1000 Lumens (source)
Light color*: 2700 K or 3500 K
Color accuracy: 90+ CRI
Power usage: 14 W
Dimmable (see driver below)
Input voltage: 24 V DC (driver included)
Driver location: must be housed in J-box
Driver dimensions: 3" x 1.5" x 1"
ADA compliant hotel room signage with tactile
numbering and corresponding braille available
Wood grain will vary
Specifications subject to change



MATERIAL & FINISH OPTIONS

Capio L part # 03-180- L	
Wood Body	
walnut (CM-001)	W
dark stained walnut (CM-002)	D
maple (CM-005)	M
Lamping*	
2700 K LED	27
3500 K LED	35
Driver	
120 V AC input voltage	P1
TRIAC, ELV & 0-10 V dimming	
277 V AC input voltage	P2
TRIAC, ELV & 0-10 V dimming	
Includes	
frosted polymer (CM-024)	
*Available in 3000K, 4000K and other color temperatures upon request	



The Capio is an exercise in restraint and efficiency consisting of just two solid wood sides that capture a single light diffusing lens. The clean and simple design allows for horizontal or vertical mounting as well as compelling compositions when used in multiples.

Nick Sheridan
Designer

Emergency backup option available upon request, requires oversized J-box.



The Oris has a strong and commanding presence with its highly architectonic form. The thick solid stock walnut and solid aluminum central fin give the Oris a feeling of permanence and integration into the surrounding architecture. The simple asymmetrical composition adds an understated complexity, as well as excellent illumination, to any wall.

Nick Sheridan
Designer

Emergency backup option available upon request, requires oversized J-box.

Oris
sconce

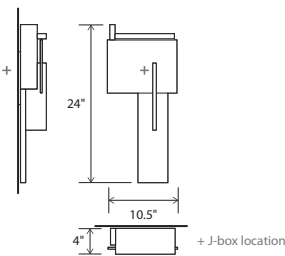

Dimensions: 24" x 10.5" x 4"
Materials: solid wood, polymer, aluminum
Product weight: 6 lbs
Light source: integrated LED
Light output: 1130 Lumens (source)
Light color*: 2700 K or 3500 K
Color accuracy: 90+ CRI
LED power consumption: 13W
Dimmable (see driver below)
ADA compliant hotel room signage with tactile
numbering and corresponding braille available
Wood grain will vary
Specifications subject to change



MATERIAL & FINISH OPTIONS

Oris part # 03-140-	
Metal Finish	
brushed aluminum (CM-006)	A
Wood Body	
walnut (CM-001)	W
dark stained walnut (CM-002)	D
Lamping*	
2700 K LED	27
3500 K LED	35
Driver	
AC Input Voltage Range:	
120-277 V	
120 V input: TRIAC, ELV & 0-10 V dimmable	P1
240 & 277 V input: only 0-10 V dimmable	
Includes	
frosted polymer (CM-024)	
*Available in 3000K, 4000K and other color temperatures upon request	

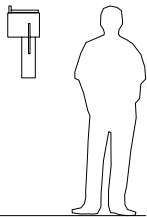



Tersus
sconce

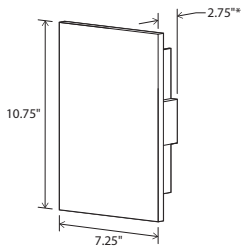

Dimensions: 10.75" x 7.25" x 2.75" (*3.13" marble)
Materials: solid wood, polymer, metal option, stone option
Product weight: 2 lb (5 lb marble)
Light source: integrated LED
Light output: 1130 Lumens (source)
Light color*: 2700 K or 3500 K
Color accuracy: 90+ CRI
Power usage: 13 W
Dimmable (see driver below)
Wood grain and stone will vary
Specifications subject to change



MATERIAL & FINISH OPTIONS

Tersus part # 03-136-

Wood Body		
walnut (CM-001)	W	<div></div>
dark stained walnut (CM-002)	D	
maple (CM-005)	M	
white washed oak (CM-095)	O	
Optional Face Material		
brushed aluminum (CM-012)	A	<div></div>
brushed rose gold (CM-046)	G	
brushed brass (CM-047)	R	
carrara marble (CM-078)	C	
none (leave blank)		
Lamping*		
2700 K LED	27	<div></div>
3500 K LED	35	
Driver		
AC Input Voltage Range: 120-277 V		<div></div>
120 V input: TRIAC, ELV & 0-10 V dimmable		
240 & 277 V input: only 0-10 V dimmable		
		P1

Includes
frosted polymer (CM-024)
J-box centered behind fixture
*Available in 3000K, 4000K and other color temperatures upon request

Nick Sheridan
Designer



Tersus, walnut, carrara marble



Tersus, walnut, rose gold



Tersus, dark stained walnut

Sedo
sconce

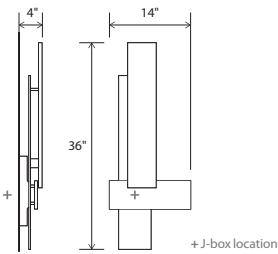

Dimensions: 36" x 14" x 4"
Materials: solid wood, polymer
Product weight: 6 lbs
Light source: integrated LED
Light output: 1130 Lumens (source)
Light color*: 2700 K or 3500 K
Color accuracy: 90+ CRI
Power usage: 13 W
Dimmable (see driver below)
ADA compliant hotel room signage with tactile numbering and corresponding braille available
Wood grain will vary
Specifications subject to change



MATERIAL & FINISH OPTIONS

Sedo part # 03-133-

Wood Body		
walnut (CM-001)	W	<div></div>
dark stained walnut (CM-002)	D	
Lamping*		
2700 K LED	27	<div></div>
3500 K LED	35	
Driver		
AC Input Voltage Range: 120-277 V		<div></div>
120 V input: TRIAC, ELV & 0-10 V dimmable		
240 & 277 V input: only 0-10 V dimmable		
		P1

Includes
frosted polymer (CM-024)
*Available in 3000K, 4000K and other color temperatures upon request

Includes
frosted polymer (CM-024)
*Available in 3000K, 4000K and other color temperatures upon request



Sedo, walnut

The Sedo is composed of just three floating planes all kept parallel to the wall. This simple composition cloaks the light engine from view and filters the light as it is delivered far up and down the wall. It's this wall grazing and diffuser glow that gives the Sedo a strong architectural presence.

Nick Sheridan
Designer

Emergency backup option available upon request, requires oversized J-box.

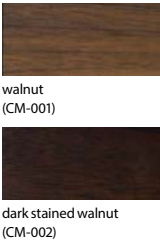

walnut
(CM-001)

dark stained walnut
(CM-002)

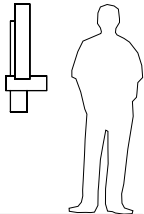

The Tersus is an example of the simplest form unlocking a myriad of design possibilities. The long reaching light pattern cast on the wall coupled with the numerous finishes and materials offered makes the Tersus well versed for all kinds of compositions and applications.

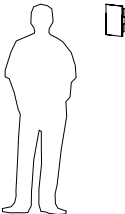



Ansa, distressed brass



The Ansa is a simple form that has been detailed and executed without compromise. The robust metal collar broadly trains the light while the light diffusing blades closely attenuate the wash pattern on the wall, yielding a simple and sophisticated feel.

Nick Sheridan
Designer

Ansa
sconce

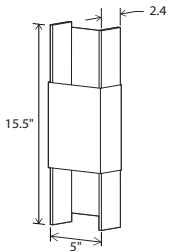

Dimensions: 15.5" x 5" x 2.4"
Materials: metal, polymer
Product weight: 3 lbs
Light source: integrated LED
Light output: 1130 Lumens (source)
Light color*: 2700 K or 3500 K
Color accuracy: 90+ CRI
Power usage: 13 W
Dimmable (see driver below)
Specifications subject to change



MATERIAL & FINISH OPTIONS

Ansa part # 03-137 -		-
<i>Body</i>		
brushed aluminum (CM-006)	A	
brushed brass (CM-008)	R	
distressed brass (CM-009)	D	
oiled bronze (CM-010)	Z	
<i>Lamping*</i>		
2700 K LED	27	
3500 K LED	35	
AC Input Voltage Range:		
120-277 V		
120 V input: TRIAC, ELV & 0-10 V dimmable		
240 & 277 V input: only 0-10 V dimmable		
	P1	

Includes
frosted polymer (CM-024)

J-box centered behind fixture
*Available in 3000K, 4000K and other color temperatures upon request

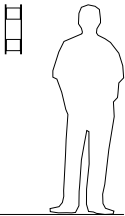
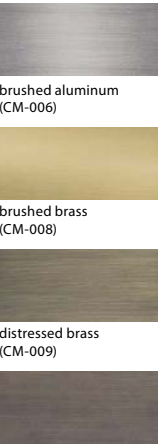

in collaboration with
DESIRON FRANK CARFARO
HAND CRAFTED AMERICAN FURNITURE

Fortis
sconce

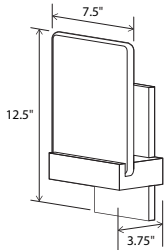

Dimensions: 12.5" x 7.5" x 3.75"
Materials: solid wood, metal,
artisan glass option, marble option
Product weight: 10 lb
Light source: integrated LED
Light output: 565 Lumens (source)
Light color*: 2700 K or 3500 K
Color accuracy: 90+ CRI
Power usage: 7 W
Dimmable (see driver below)
Wood grain, bubbles in glass, and stone will vary
Specifications subject to change



MATERIAL & FINISH OPTIONS

Fortis part # 03-170-

Metal Finish

brushed brass (CM-008)	R
distressed brass (CM-009)	D
oiled bronze (CM-010)	Z
brushed aluminum (CM-006)	A

Wood Finish

walnut (CM-001)	W
dark stained walnut (CM-002)	D

Diffuser

artisan bubble glass (CM-059)	B
carrara marble (CM-078)	C

*Lamping**

2700 K LED	27
3500 K LED	35

Driver

120 V AC input voltage	P1
TRIAC & ELV dimming	
277 V AC input voltage	P2
0-10V dimming	

J-box centered behind metal plate
*Available in 3000K, 4000K and other color
temperatures upon request



Fortis, dark stained walnut, carrara marble, oiled bronze



dark stained walnut, artisan glass, brushed brass



dark stained walnut, artisan glass, oiled bronze

The Fortis wall sconce is a great example of the collaborative design process. The initial concept from the New York based Desiron was refined over many iterations. We then worked with the local Southern California artisan glass company Siemon & Salazar to achieve a very specific bubbled glass lens that diffuses the light. It is a strong and sophisticated display of three elements: a piece of metal, a piece of wood, and a piece of glass all beautifully showcased in light.

Nick Sheridan
Co-Designer



Claudio, walnut

The Claudio sconce showcases the beautiful natural walnut wood grain and sets it against the rigorous slits cut in each face as they wrap around the simple, clean shade form. A beautiful glow emanates from each slit, showing the striking rectilinear composition, in which all three sides are unique.

Nick Sheridan
Designer

Claudio
sconce

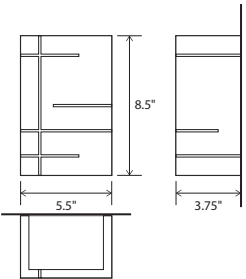

Dimensions: 8.5" x 5.5" x 3.75"
Materials: solid wood, polymer
Product weight: 4 lb
Light source: integrated LED
Light output: 1130 Lumens (source)
Light color*: 2700 K or 3500 K
Color accuracy: 90+ CRI
Power usage: 13 W
Dimmable (see driver below)
Wood grain will vary
Specifications subject to change



MATERIAL & FINISH OPTIONS

Claudio sconce part # 03-150-

Wood Body

walnut (CM-050)	W
dark stained walnut (CM-002)	D

*Lamping**

2700 K LED	27
3500 K LED	35

AC Input Voltage Range:

120-277 V	
120 V input: TRIAC, ELV & 0-10 V dimmable	P1
240 & 277 V input: only 0-10 V dimmable	

Includes

frosted polymer (CM-024)

J-box centered behind fixture

Also available in a pendant version

*Available in 3000K, 4000K and other color
temperatures upon request



walnut
(CM-050)



dark stained walnut
(CM-002)

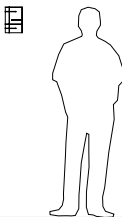
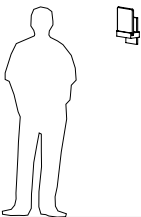



Libri
bedside sconce reading light

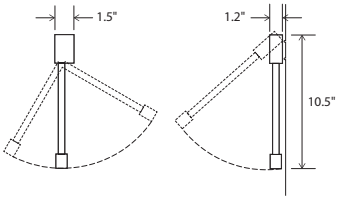

Dimensions: 10.5" x 1.5" x 1.2"
Materials: aluminum, polymer, optional solid wood mounting
Product weight: 1 lb
Light source: integrated LED
Light output: 160 Lumens (source)
Light color: 2700 K
Color accuracy: 90+ CRI
Power usage: 2 W
Automatic ON/OFF when arm is pulled away from wall
Specifications subject to change



MATERIAL & FINISH OPTIONS

	Libri part # 03-160-
Direction	
left model	L
right model	R
Finish	
brushed aluminum (CM-006)	A
white (CM-060)	Y
Installation	
corded (plug-in)	C
hardwired*	H

Alternate voltage / plug styles available
J-box centered behind fixture

DIRECTION

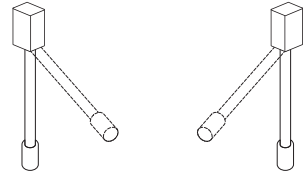

INSTALLATION

*Hardwired installation requires room in the J-box for the included external power adapter (2" x 1" x 1.25"). Typically mounting kit is used. See mounting options on this page

The Libri is about function and ease: an extremely articulate directional task light in a discrete and sturdy form that is very intuitive to use.

*Nick Sheridan,
Designer*

MOUNTING OPTIONS

Mounting kits are sold separately from the Libri fixture.
No Mounting kit is required if the Libri fixture is to be installed using the Direct Mount option.

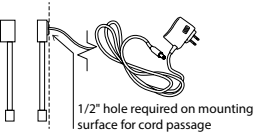

Direct Mount

Direct mount option is used when mounting directly to a headboard. There is no backplate and the cord must be fed through a hole in the headboard directly behind where the fixture is mounted and plugged into a wall outlet using the included AC adapter.

Libri Mounting Kit
sconce backplate

J-box Backplate: Mounting Kit (3)
J-box backplate is typically used when mounting to a J-box. Hardwired installation requires room in the J-box for the included external power adapter (2" x 1" x 1.25").

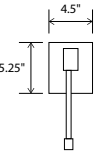

Wall Mount Plug-in Backplate: Mounting Kit (1, 2)
Wall mount plug-in backplate is used when mounting directly to the wall and plugging into a wall outlet. The wall mount is an elongated rectangle that allows the cord to exit discreetly below the fixture.

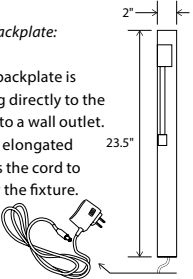

MOUNTING KIT OPTIONS

	Mounting Kit Part # 03-160-10-
Direction	
wall mount plug-in, left	1
wall mount plug-in, right	2
J-box backplate	3
Finish	
brushed aluminum (CM-006)	A
walnut (CM-001)	W
white (CM-060)	Y



Left model, aluminum fixture, hardwired with walnut wall mount plug-in backplate mounting kit



Left model, aluminum fixture, hardwired with walnut J-box plug-in backplate mounting kit



Left model, aluminum fixture, hardwired with aluminum J-box plug-in backplate mounting kit



Levo, walnut

REDDYMADE ARCHITECTURE AND DESIGN



Levo, right model



Levo
bedside wall sconce/reading
lamp hybrid with USB charger

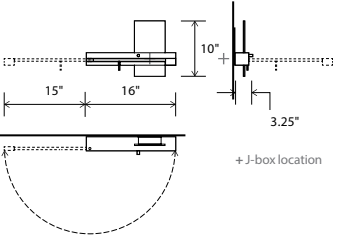

Dimensions: 10" x 16" x 3.25"
Materials: solid wood, aluminum, polymer
Product weight: 3 lb
Light source: 2x integrated LED
Static sconce light + swim arm
with rotating head light
Light output of static sconce source:
565 Lumens (source)
Light output of swing arm source:
160 Lumens (source)
Light color: 2700 K
Color accuracy: 90+ CRI
Power usage: 20 W total (10 W USB charger)
USB charge current: 2 A
Fully dimmable static sconce light with
Automatic ON/OFF swing arm light source
Swing arm light is not dimmable
Input voltage: 12 V DC (adapter included)
Hardwired and corded versions available
Hardwired model includes an external power
supply (2.75" x 1.63" x 1.13")
Requires space in J-box for included power adapter
Alternate voltage/plug styles available
Hardwired adapter input voltage: 120-277 V AC
Corded adapter input voltage: 120 V AC
Wood grain will vary
Specifications subject to change



MATERIAL & FINISH OPTIONS

Levo part # 03-120-

Direction
left model
right model

Installation
hardwired
corded

Includes
solid walnut body (CM-001)
brushed aluminum (CM-006)
frosted polymer (CM-024)

Alternate voltage / plug styles available

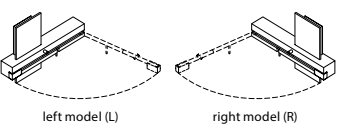

left model (L)

right model (R)

Levo Shelf Option



Levo, right model with shelf option

The introduction of the optional shelf for the Levo increases the utility of this fixture without compromising any aspect of the design. The shelf provides a perfect place to rest your phone or tablet while charging it. It is important to note that shelf is purchased separately from the Levo and can be retrofitted on existing Levos.

MATERIAL & FINISH OPTIONS

Levo Shelf part # 60-220-

Direction
left model
right model

Includes
solid walnut shelf (CM-001)
brushed aluminum (CM-006)

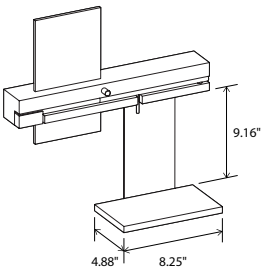

left model with shelf option

The goal for the Levo was to create a bedside wall fixture with great task lighting articulation that was intuitive enough to be used without prior knowledge of the fixture: all the while making it slender, sexy, and very robust.

Nick Sheridan,
Designer

Table



Nauta



Forma



Adesse





in collaboration with
DESIRON FRANK CARFARO
HAND CRAFTED AMERICAN FURNITURE



Nauta Table
desk/table

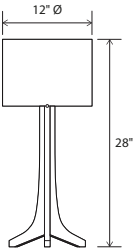

Dimensions: 12" Ø, 28"
Materials: solid wood, aluminum, fabric shade
Product weight: 3 lb
Light source: medium base E26 socket
Lamping: E26 base, 60 W max
Input voltage: 250 V AC max
Includes 8' clear silver cord with white plug
On/Off rocker switch on socket
Wood grain will vary
Specifications subject to change



Included dimmable LED A19 bulb
Light output: 800 Lumens (source)
Light color: 2700 K
Color accuracy: 90+ CRI
Power usage: 11 W

MATERIAL & FINISH OPTIONS

Nauta Table part # 02-160-	
<i>Metal Finish</i>	
brushed aluminum (CM-006)	A
brushed brass (CM-120)	R
<i>Wood Body</i>	
walnut (CM-001)	W
dark stained walnut (CM-002)	D
white washed oak (CM-095)	O
<i>Shade</i>	
black amaretto (CM-018)	A
white linen (CM-016)	L
burlap (CM-017)	N



black amaretto
(CM-018)



white linen
(CM-016)



burlap
(CM-017)



walnut
(CM-001)



dark stained walnut
(CM-002)



white washed oak
(CM-095)



brushed brass
(CM-120)



brushed aluminum
(CM-006)

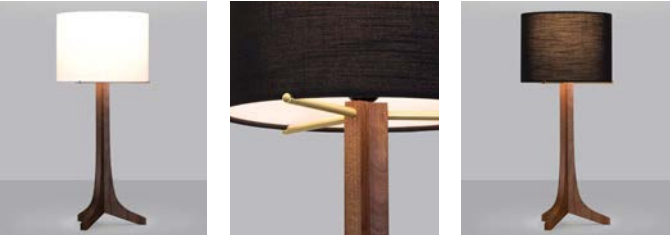

Efficiency and simplicity guided the design process for the Nauta table lamp. We designed the Forma several years ago with Frank Carfaro of Desiron, which profoundly influenced the Nauta's form. Our goal was to distill the Forma design without compromising it. The Nauta is clean, modern, and priced competitively.

Nick Sheridan
Designer

in collaboration with
DESIRON FRANK CARFARO
HAND CRAFTED AMERICAN FURNITURE

Forma Table
desk/table

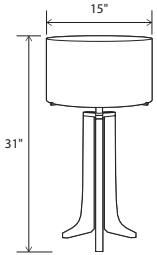

Dimensions: 15" Ø shade, 31"
Materials: solid wood, aluminum, fabric shade
Product weight: 10 lb
Light source: medium base E26 socket
Lamping: E26 base, type A lamp, 60 W max
Input voltage: 120 V AC max
Dimmable on fixture
Wood grain will vary
Specifications subject to change

 **UL**
Listed

Included dimmable LED A19 bulb
Light output: 800 Lumens (source)
Light color: 2700 K
Color accuracy: 90+ CRI
Power usage: 11 W

MATERIAL & FINISH OPTIONS

Forma Table part # 02-150-

Metal Finish

brushed aluminum (CM-006) A
black anodized aluminum (CM-007) B

Wood Body

walnut (CM-001) W
dark stained walnut (CM-002) D

Shade

black amaretto (CM-018) A
white linen (CM-016) L
burlap (CM-017) N

Alternate voltage / plug styles available
Also available as a Floor Lamp



Forma Table, walnut, black anodized aluminum, white linen



Being our most traditional fixture, Frank Carfaro and I worked to design a piece that embraced both Cerno and Desiron's aesthetic, without deviating too much from either brand's design language. I am really pleased with the fluidity, posture and scale we achieved with the Forma table, and its likeness to the Forma floor lamp.

Nick Sheridan
Co-Designer



Adesse, walnut, textured black, brass metal accents



Cerno's Adesse desk/table lamp exemplifies purpose-driven analog design. The solid brass toggle is a nod to the past. The two slits can hold a charging cord and the large cutout is for your phone or tablet. The design is absent of technology yet able to accommodate it. The solid walnut base, black metal shade, and brass components celebrate Cerno's use of quality materials.

Adesse
desk/table

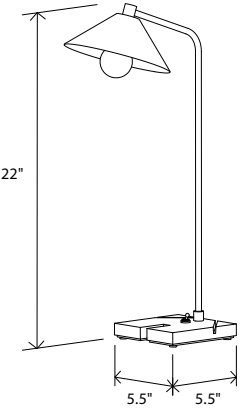

Dimensions: 11" x 7", 22"
Product weight: 3 lb
Light source: candelabra base E12 socket
Lamping: E12 base, type G16.5 lamp, 7 W max
Input voltage: 120 V AC max
Includes 72" clear silver cord with white plug
On/Off toggle switch on base
Wood grain will vary
Specifications subject to change

 **UL**
Listed

Included dimmable LED G16.5 bulb
Light output: 350 Lumens (source)
Light color: 2700 K
Color accuracy: 90+ CRI
Power usage: 5 W

MATERIAL & FINISH OPTIONS

Adesse part # 02-170-

Wood & Metal Finishes

walnut (CM-001) with
textured black (CM-049) BW
white washed oak (CM-095) with
textured white (CM-060) WO

Includes:
brushed brass metal accents (CM-008)

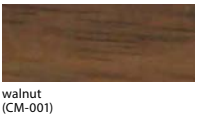

walnut
(CM-001)



white washed oak
(CM-095)



Textured black
(CM-049)



Textured white
(CM-060)



brushed brass metal accents
(CM-008)

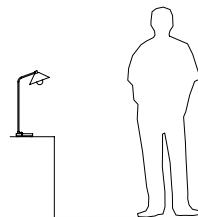



Artist: Roy Nachum STACI RUIZ LIGHTING CONSULTANT PHOTO BY ARI BURLING



Guy Rose, Impressionist

Revelite AL art light

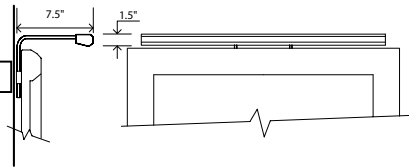

The Revelite AL brings art to life. A challenge resolved by a slim luminaire that discreetly and evenly illuminates an artwork surface with beautiful color rendering accuracy.

CUSTOMIZED
Each AL is custom built and factory calibrated for an artwork's specific dimensions, distributing even illumination across the full width and height of the surface.

HIGH COLOR ACCURACY
To accurately reflect the artist's vision, the LED light source was designed to provide full color spectrum lighting with a color rendering index over 90 and an R9 value of 83.

ART SAFE
Revelite AL's LED technology provides a much safer alternative to legacy sources that emit excessive and damaging UV and heat.

LOW PROFILE
The minimal form virtually disappears against the frame or wall and pairs well with various styles of art, including contemporary, photographs behind glass and more traditional works.

VISIT
www.revelite.com for detailed specifications and options.

US Patent # 7,070,293 and 9,134,004.
Other US and International Patents Pending.

These lights revealed subtleties in paintings you just don't see with ordinary lights. I think we are seeing, truly for the first time, what the artist really wanted us to see.

Pat Trenton, Ph.D.
Art expert, curator and writer



Wolfgang Bloch, Contemporary



Tom Lamb, Photograph (behind glass)

Accessories



Motus Swing Arm Bracket
accessory

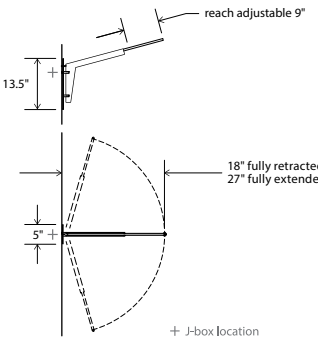

Dimensions: 18.38" x 5" x 26.8"
Materials: solid wood, metal
Product weight: 3 lb
Max suspension weight: 5 lb
Swing arm length can be adjusted from 18" to 27"
Max drop length from tip of extended arm to top of pendant is 36"
Swing arm rotation has adjustable resistance in pivot hinge
Wood grain will vary
Specifications subject to change
Patent No. : US D846,180 S



MATERIAL & FINISH OPTIONS

Motus Swing Arm Bracket part # 60-210-



brushed aluminum (CM-006)



textured black powder coat (CM-049)



walnut (CM-001)



dark stained walnut (CM-002)

Metal Finish
brushed aluminum (CM-006)
textured black powdercoat (CM-049)

Wood Body
walnut (CM-001)
dark stained walnut (CM-002)

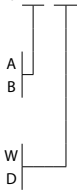

How it works: Build your own fixture

Pick one of the pendants listed below and pair it with the Motus Swing Arm Bracket for a unique and versatile light fixture. To order, you will need to select a SKU for the pendant that you choose and a SKU for the Motus Swing Arm Bracket. The SKU builder for the Motus Swing Arm Bracket is above, and the SKU builders for the pendants are located on their respective tear sheets.



Motus with Levis Pendant



Motus with Plura 18



Motus with Calx 10



Motus with Claudio



Motus with Mica



Motus with Salix

Canopy Accessories



Multi-Point Round Canopy

For 3 accent pendants

Dimensions: 12"Ø, 1.25" H

MATERIAL & FINISH OPTIONS

12" Round Canopy part # 60-120-R

Finish
brushed aluminum (CM-006)
black anodized (CM-007)



Multi-Point Linear Canopy

For linear pendants or 2 or 3 accent pendants

Dimensions: 20.6" x 4", 1.3" H

MATERIAL & FINISH OPTIONS

Multi-Point Linear Canopy part # 60-130-

Finish
brushed aluminum (CM-006)
black anodized (CM-007)



Number of Holes

2 Holes (linear pendant) leave blank
3 Holes (pendant cluster)



Wood Canopy Cover

Fits over linear canopies except for Camur canopy (Camur wood canopy is on page 23)

Dimensions: 21" x 4.6", 1.75" H

MATERIAL & FINISH OPTIONS

Wood Canopy Cover part # 60-130-005

Finish
walnut (CM-001)
dark stained walnut (CM-002)



Number of Holes

2 Holes (linear pendant) leave blank
3 Holes (pendant cluster)

Finish and Material Options

Hard Surface Shade



Beech Wood Veneer (CM-019)



Ebony Eco Veneer (CM-020)

Fabric Shade



White Linen (CM-016)
w/ Lamp Shade Backer



White Linen (CM-058)
White Linen w/ Frosted Backer



Burlap (CM-017)
Burlap w/ Lamp Shade Backer



Black Amaretto (CM-018)
Black Amaretto Fabric
w/ Lamp Shade Backer



Brown leather (CM-098)

Metal



Brushed Aluminum (CM-006)



Brushed Aluminum (CM-012)
Brushed Anodized Aluminum Veneer



Black Anodized Aluminum (CM-007)



Brushed Rose Gold (CM-046)
Brushed Rose Gold Anodized Aluminum Veneer



Brushed Brass (CM-047)
Brushed Brass Anodized Aluminum Veneer



Distressed Brass (CM-009)
Distressed Brass - Patina



Brushed Brass (CM-008)



Oiled Bronze (CM-010)
Oiled Bronze - Patina



Textured Black Powdercoat (CM-049)



Distressed brass (CM-096)



matte black (CM-085)
with matte white interior

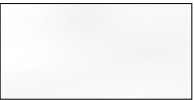

Textured White Powdercoat (CM-060)



Gloss White (CM-054)
White Powdercoat Aluminum Sheet

Polymer



Frosted Polymer (CM-051)
Frosted White Polycarbonate



Frosted Polymer (CM-057)
Frosted Polycarbonate



Frosted Polymer (CM-024)
Frosted Acrylic



Polymer (CM-052)
Natural Polyethylene

Wood



Walnut (CM-001)
Solid Oiled Walnut



Walnut (CM-055)
Oiled Walnut Veneer



Dark Stained Walnut (CM-002)
Solid Dark Stained Oiled Walnut

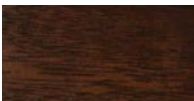

Dark Stained Walnut (CM-056)
Dark Stained Oiled Walnut Veneer



Double Dark Stained Walnut (CM-048), Solid Lacquered Double , Dark Stained Walnut



Maple (CM-005)
Solid Oiled Maple



White Washed Oak (CM-095)
Solid White Washed Oak

Stone



Carrara marble (CM-078)

Outdoor Finishes



White Concrete (CM-104)



Black Concrete (CM-105)



Marine Grade Brushed Stainless Steel (CM-102)



Antique Bronze (CM-103)



Textured Black Powdercoat (CM-099)



Textured White Powdercoat (CM-100)



Matte Grey Powdercoat (CM-101)



Natural Terracota (CM-125)

Artisan Bubble Glass

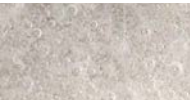

Artisan Bubble Glass (CM-059)

⚠ WARNING. California Proposition 65 Warning for California Consumers. This product can expose you to chemicals including wood dust and lead which are known to the State of California to cause cancer or birth defects or other reproductive harm. For more information go to www.P65Warnings.ca.gov

D E S I G N E D A N D M A D E I N C A L I F O R N I A



cerno®
DESIGNED AND MADE IN CALIFORNIA

22892 GLENWOOD DRIVE, ALISO VIEJO, CA 92656 | 949.715.1534 | WWW.CERNOGROUP.COM