

cerno®



D E S I G N E D   A N D   M A D E   I N   C A L I F O R N I A





## BELIEF

With no backyards but access to beaches and idyllic doses of salt and sun, our business story began with the adventures of three boys. Laguna Beach's creative culture and natural environment shaped our professional and aesthetic ideals. Looking back it's now clear that our childhood projects and experiments grew into our best adventure yet: building Cerno.



## THE BEGINNING



*Cerno founders, 1998. Left to right:  
Nick Sheridan, Dan Wacholder, Bret Englander.*

Our drive and influences come from many different sources. One source that influenced all of us is Daniel's late grandfather, Steve. Steve grew up on a remote homestead where the existence of most objects depended on people's ability to create and fix them. For all of his 101 years, he embodied the saying "where there's a will, there's a way." On the California coast we were raised with this mentality and today we share it with the rest of the Cerno team.

## CERNO

- Verb (Latin)

1. To resolve, distinguish, decide, sift, determine, to perceive.







# Table of Contents

## OUR TEAM

Each finished product is a celebration of the inventive minds and industrious hands that brought it to life. Dreams do not manifest themselves; skilled people bring dreams to life. The passion of our steadily growing team and their commitment to the product is inspiring. We are grateful for every individual that is part of our collaborative creative process.

|                        |           |                             |            |
|------------------------|-----------|-----------------------------|------------|
| <b>Floor</b>           | <b>9</b>  | <b>Outdoor Sconces</b>      | <b>67</b>  |
| Fons 8 / Fons 10       | 10        | Tersus Outdoor              | 68         |
| Valeo                  | 11        | Calx Outdoor                | 69         |
| Nauta Floor            | 14        | Ansa Outdoor                | 70         |
| Silva Floor            | 15        | Acuo Outdoor                | 71         |
| Forma                  | 16        | <b>Vanity</b>               | <b>73</b>  |
| Altus                  | 17        | Allavo                      | 74         |
| Silva Giant            | 18        | Merus                       | 75         |
| <b>Linear Pendants</b> | <b>21</b> | <b>Sconces</b>              | <b>77</b>  |
| Lenis                  | 23        | Talea                       | 79         |
| Arca                   | 24        | Via                         | 80         |
| Camur                  | 25        | Calx                        | 81         |
| Aeris 30 / Aeris 54    | 27        | Penna Sconce                | 82         |
| Vix 34 / Vix 48        | 29        | Vesper                      | 83         |
| Penna Pendant          | 30        | Acuo                        | 84         |
| Vix 82                 | 31        | Capio S                     | 86         |
| Virga                  | 32        | Capio L                     | 86         |
| Brevis 28 / Brevis 42  | 33        | Tersus                      | 90         |
| <b>Pendants</b>        | <b>35</b> | Sedo                        | 91         |
| Cano                   | 36        | Ansa                        | 93         |
| Bimar                  | 37        | Fortis                      | 94         |
| Muto                   | 38        | Claudo                      | 95         |
| Astrum                 | 39        | Cubo                        | 96         |
| Imber 17 / Imber 24    | 42        | Libri                       | 97         |
| Ignis 17 / Ignis 24    | 43        | Levo                        | 99         |
| Ico                    | 45        | Levo Shelf Option           | 99         |
| Calx 10 / Calx 19      | 46        | <b>Table</b>                | <b>101</b> |
| Calx 36                | 47        | Forma Table                 | 102        |
| Veris 12               | 48        | Nauta Table                 | 103        |
| Veris 22               | 49        | Silva                       | 104        |
| Veris 34               | 51        | Macto                       | 105        |
| Mica                   | 53        | <b>Revelite AL</b>          | <b>107</b> |
| Mica L                 | 53        | Accessories                 | 108        |
| Levis                  | 54        | Motus Swing Arm Bracket     | 108        |
| Levis L                | 54        | Canopy Accessories          | 108        |
| Salix                  | 55        | Finish and Material Options | 109        |
| Plura Pendant          | 57        |                             |            |
| <b>Flush Mount</b>     | <b>59</b> |                             |            |
| Casia                  | 61        |                             |            |
| Plura Flush Mount      | 65        |                             |            |





## Floor

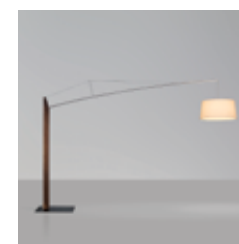

Fons Family



Valeo



Silva Giant



Silva Floor



Forma



Altus



**Fons 8 / Fons 10**  
floor

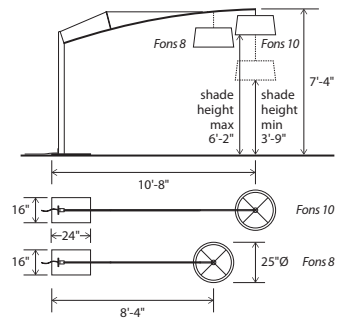

Dimensions: 25" Ø shade, 7'-4"  
 Materials: solid wood, metal, linen shade  
 Product weight: 65 lb  
 Light source: medium base E26 socket  
 Lamping: E26 base, type A lamp, 60 W max  
 Input voltage: 120 V AC max  
 Includes 6'-0" clear silver cord with inline foot switch 24" from base  
 Bottom diffuser included (CM-051)  
 Wood grain will vary  
 Specifications subject to change



Included dimmable LED A19 bulb  
 Light output: 800 Lumens (source)  
 Light color: 2700 K  
 Color accuracy: 90+  
 Power usage: 11 W

**MATERIAL & FINISH OPTIONS**

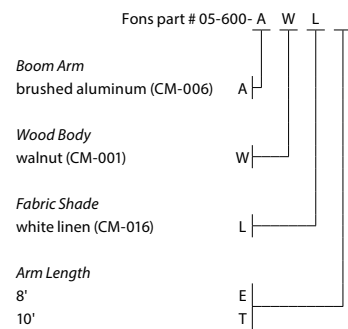

**Includes**  
 stainless steel tension cable (CM-053)  
 black powder coated steel base (CM-049)  
 frosted polymer diffuser (CM-051)

Alternate voltage/plug styles are available



**ARM LENGTH**  
 Available in 10'-8" and 8'-4" arm lengths  
 Arm length is from back of base to center of shade  
 Arm lengths are not adjustable

**SHADE HEIGHT**  
 Shade height (floor to bottom edge of shade) can be adjusted between 6'-2" maximum and 3'-9" minimum.

*The goal with the Fons was to minimize the structure and visual massing of the fixture while maximizing the reach or cantilever. The delicate boom arm, upheld by a tension cable, gently bends while reaching out to almost horizontal where it suspends the light. The structural design is an extremely effective way to resolve the forces associated with such a long reach. It is so effective and efficient that it seems to float with a weightlessness at the tip.*

Nick Sheridan  
 Designer

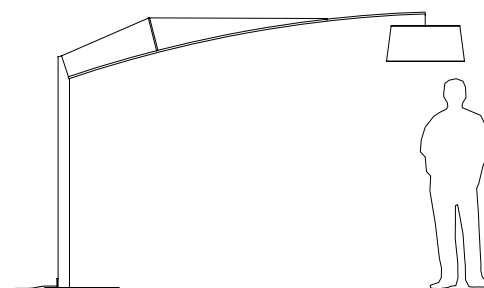

**Valeo**  
floor

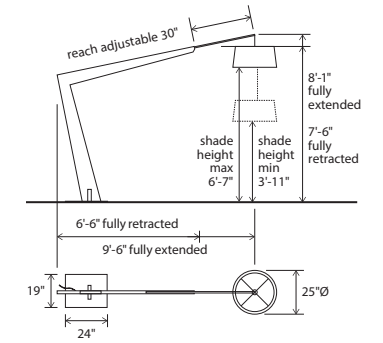

Dimensions: 8'1" H max, 25" Ø shade  
 Materials: solid wood, metal, linen shade  
 Product weight: 95 lb  
 Light source: medium base E26 socket  
 Lamping: E26 base, type A lamp, 60 W max  
 Input voltage: 120 V AC max  
 Includes 72" clear silver cord with inline foot switch 24" from base  
 Bottom diffuser included (CM-051)  
 Wood grain will vary  
 Specifications subject to change



Included dimmable LED A19 bulb  
 Light output: 800 Lumens (source)  
 Light color: 2700 K  
 Color accuracy: 90+ CRI  
 Power usage: 11 W

**MATERIAL & FINISH OPTIONS**

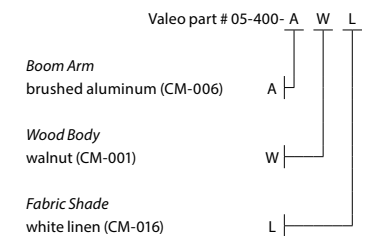

**Includes**  
 black powder coated steel base (CM-049)  
 frosted polymer diffuser (CM-051)

Alternate voltage/plug styles are available

*When reaching such a distance with a fixture, it is important that it feels visually efficient in its form but is still far from fragile, inviting one to linger under it. The adjustability in the reach and the height of the shade make it possible to custom fit the piece to its surroundings - an important characteristic for such a large piece.*

Nick Sheridan  
 Designer

**ARM LENGTH**  
 Arm length (from back of base to center of shade) can be adjusted between 9'-6" maximum and 6'-6" minimum.

**SHADE HEIGHT**  
 Shade height (floor to bottom edge of shade) can be adjusted between 6'-7" maximum and 3'-11" minimum.

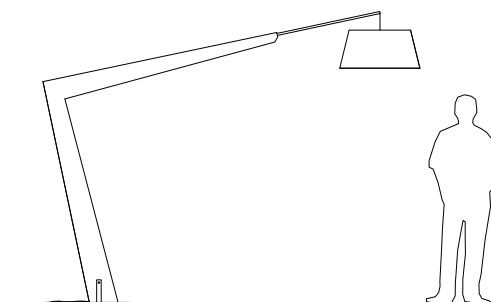







in collaboration with  
**DESIRON FRANK CARFARO**  
HAND CRAFTED AMERICAN FURNITURE

**Nauta Floor**  
floor

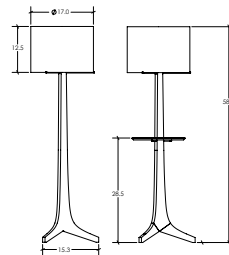

Dimensions: 17" Ø, 59"  
Materials: solid wood, aluminum, fabric shade  
Product weight: 8 lb  
Light source: medium base E26 socket  
Lamping: E26 base, 60 W max  
Input voltage: 250 V AC max  
Includes 8' clear silver cord with white plug  
On/Off rocker switch on socket  
Wood grain will vary  
Specifications subject to change  
**SHELF IS OPTIONAL**  
UL  
Included dimmable LED A19 bulb  
Light output: 800 Lumens (source)  
Light color: 2700 K  
Color accuracy: 90+ CRI  
Power usage: 11 W

**MATERIAL & FINISH OPTIONS**

Nauta Floor part #: 05-110-

**Metal Finish**

- brushed aluminum (CM-006) A
- brushed brass (CM-008)\* R

**Wood Body**

- walnut (CM-001) W
- dark stained walnut (CM-002) D
- white washed oak (CM-095) O

**Shade**

- black amaretto (CM-018) A
- white linen (CM-016) L
- burlap (CM-017) N

**Optional Shelf Accessory**

- no shelf N
- matching wood shelf -  
exposed wood top surface M
- matching wood shelf -  
black HPL top surface (CM-092) B
- matching wood shelf -  
white HPL top surface (CM-093) W

\*Brass shade support arms feature wood plug in end of arm  
\*\*Shelf is optional and cannot be removed by customer

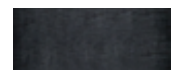

black amaretto (CM-018)



white linen (CM-016)



burlap (CM-017)



walnut (CM-001)

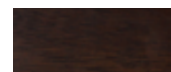

dark stained walnut (CM-002)



white washed oak (CM-095)



brushed brass (CM-008)

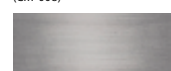

brushed aluminum (CM-006)



walnut, brushed aluminum, burlap

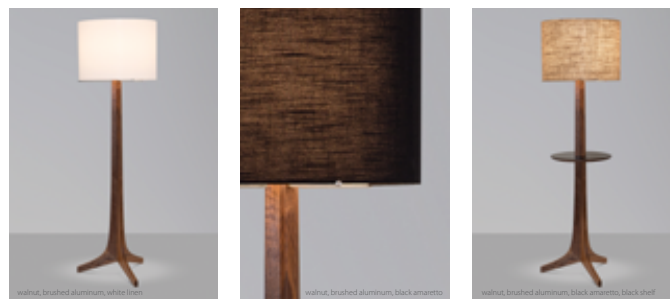

Efficiency and simplicity guided the design process for the Nauta table lamp. We designed the Forma several years ago with Frank Carfaro of Desiron, which profoundly influenced the Nauta's form. Our goal was to distill the Forma design without compromising it. The Nauta is clean, modern, and priced competitively.

Nick Sheridan  
Designer

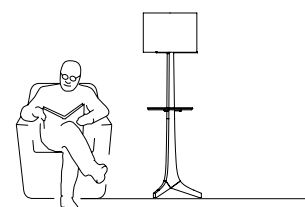

Silva Floor, walnut body, ebony eco veneer shade



Silva Floor, walnut, beech wood veneer shade  
Silva Floor, walnut, white linen shade

The Silva Floor is slender, elegant, and poised while delivering great functionality. The tri-leg base finds stability on uneven surfaces and allows the cord to exit discreetly and effectively. It feels signature and iconic while still keeping a clean and timeless modern aesthetic.

Nick Sheridan  
Designer

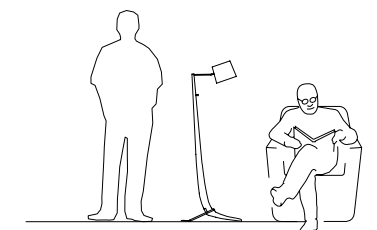

**Silva Floor**  
floor

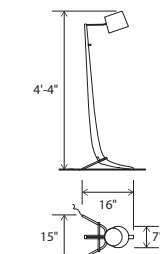

Dimensions: 16" x 15", 4'-4"  
Materials: solid wood, aluminum, bent shade  
Articulating head  
Product weight: 4 lb  
Light source: integrated LED  
Light output: 565 Lumens (source)  
Light color: 2700 K  
Color accuracy: 90+ CRI  
Power usage: 7 W  
Input voltage: 12V DC (adapter included)  
Includes 72" white braided cord  
Dimmable on fixture  
Wood grain will vary  
Specifications subject to change  
UL



beech wood veneer (CM-019)

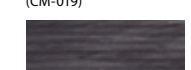

ebony eco veneer (CM-020)

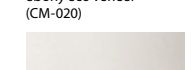

white linen (CM-058)

**MATERIAL & FINISH OPTIONS**

Silva Floor part # 05-100- A W

**Metal Finish**

- brushed aluminum (CM-006) A

**Wood Body**

- walnut (CM-001) W

**Bent Shade**

- beech wood veneer (CM-019) B
- ebony eco veneer (CM-020) E
- white linen (CM-058) L

Alternate voltage/plug styles are available  
Also available in larger version, see page 14, and smaller version, see page 74.



in collaboration with  
**DESIRON FRANK CARFARO**  
HAND CRAFTED AMERICAN FURNITURE

**Forma**  
floor

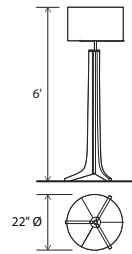

Dimensions: 22" Ø shade, 6'  
Materials: solid wood, aluminum, fabric shade  
Product weight: 15 lb  
Light source: medium base E26 socket  
Lamping: E26 base, type A lamp, 60 W max  
Input voltage: 120 V AC max  
Dimmable on fixture  
Wood grain will vary  
Specifications subject to change



Included dimmable LED A19 bulb  
Light output: 800 Lumens (source)  
Light color: 2700 K  
Color accuracy: 90+ CRI  
Power usage: 11 W

MATERIAL & FINISH OPTIONS

Forma Floor part # 05-300-

**Metal Finish**

- brushed aluminum (CM-006) A
- black anodized aluminum (CM-007) B

**Wood Body**

- walnut (CM-001) W
- dark stained walnut (CM-002) D
- maple (CM-005) M

**Fabric Shade**

- burlap (CM-017) N
- white linen (CM-016) L
- black amaretto (CM-018) A

Alternate voltage/plug styles are available  
Also available in smaller version, see page 73.



Forma, brushed aluminum, walnut, burlap shade



brushed aluminum (CM-006) black anodized aluminum (CM-007) walnut (CM-001) dark stained walnut (CM-002)  
maple (CM-005) burlap (CM-017) white linen (CM-016) black amaretto (CM-018)

Frank Carfaro and I worked to design a piece that embraced both Cerno and Desiron's aesthetic, without deviating too much from either brand's design language. I am really pleased with the fluidity, posture and scale we achieved with the Forma.

Nick Sheridan  
Co-Designer

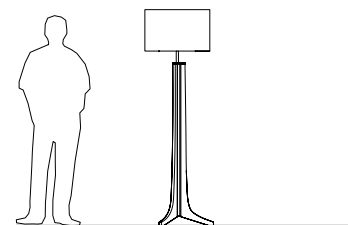

in collaboration with  
**DESIRON FRANK CARFARO**  
HAND CRAFTED AMERICAN FURNITURE

**Altus**  
floor

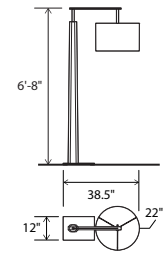

Dimensions: 6'-8" H, 22" Ø shade  
Materials: solid wood, metal, fabric shade  
Product weight: 45 lb  
Light source: medium base E26 socket  
Lamping: E26 base, type A lamp, 60 W max  
120 V AC max  
Dimmable on fixture  
Wood grain will vary  
Specifications subject to change



Included dimmable LED A19 bulb  
Light output: 800 Lumens (source)  
Light color: 2700 K  
Color accuracy: 90+ CRI  
Power usage: 11 W

MATERIAL & FINISH OPTIONS

Altus part # 05-700-

**Metal Finish**

- brushed brass (CM-008) R
- distressed brass (CM-009) D
- oiled bronze (CM-010) Z

**Wood Body**

- walnut (CM-001) W
- dark stained walnut (CM-002) D

**Fabric Shade**

- burlap (CM-017) N
- white linen (CM-016) L
- black amaretto (CM-018) A

Alternate voltage/plug styles are available



Altus, walnut body, distressed brass metal finish, white linen shade

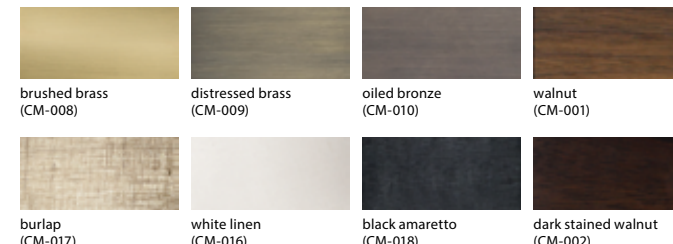

brushed brass (CM-008) distressed brass (CM-009) oiled bronze (CM-010) walnut (CM-001)  
burlap (CM-017) white linen (CM-016) black amaretto (CM-018) dark stained walnut (CM-002)

The Altus is a robust fixture that also carries an air of elegance and subtle proportion. It has the mass and impact to anchor a space while still showing balance and grace. It is always exciting to see how the solid wood trunk comes out; admiring the wood grain all the way through.

Nick Sheridan  
Co-Designer

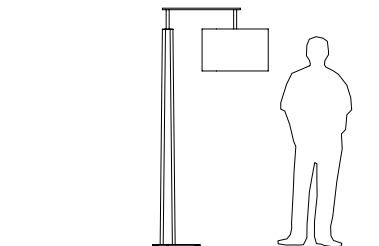



**Silva Giant**  
floor

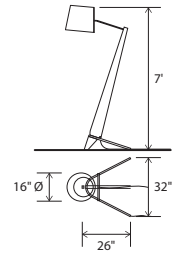

Dimensions: 32" x 26", 7", 16" Ø shade  
 Materials: solid wood, aluminum, linen shade  
 Product weight: 60 lb  
 Light source: medium base E26 socket  
 Lamping: E26 base, type A lamp, 60 W max  
 Input voltage: 120 V AC max  
 Includes 72" clear silver cord with inline foot switch 24" from base  
 Bottom diffuser included (CM-057)  
 Wood grain will vary  
 Specifications subject to change



walnut (CM-001)

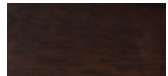

dark stained walnut (CM-002)



Included dimmable LED A19 bulb  
 Light output: 800 Lumens (source)  
 Light color: 2700 K  
 Color accuracy: 90+ CRI  
 Power usage: 11 W

**MATERIAL & FINISH OPTIONS**

|                              |                            |   |   |
|------------------------------|----------------------------|---|---|
|                              | Silva Giant part # 05-200- | A | L |
| <b>Metal Finish</b>          |                            |   |   |
| brushed aluminum (CM-006)    |                            | A |   |
| <b>Wood Body</b>             |                            |   |   |
| walnut (CM-001)              |                            | W |   |
| dark stained walnut (CM-002) |                            | D |   |
| <b>Fabric Shade</b>          |                            |   |   |
| white linen (CM-058)         |                            |   | L |

Alternate voltage/plug styles are available  
 Also available in 2 smaller versions  
 See pages 15 and 74.



Silva Giant, brushed aluminum, walnut body, white linen shade

*The Silva Giant, as the name suggests, is a giant version of our Silva table fixture. Its scale gives it a strong presence even in very large spaces, while its distilled form gives it a simplicity that can be seen from across the room. A fun piece with a huge personality.*

Nick Sheridan  
 Designer

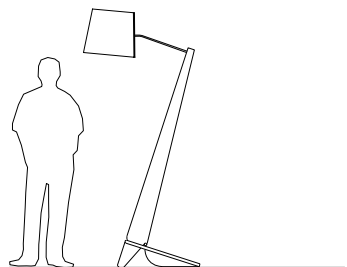





## Linear Pendants



Lenis



Lenis



Vix



Vix



Arca



Camur



Vix 82



Vix 82



Penna Pendant



Aeris



Virga



Brevis





**Lenis**  
linear pendant

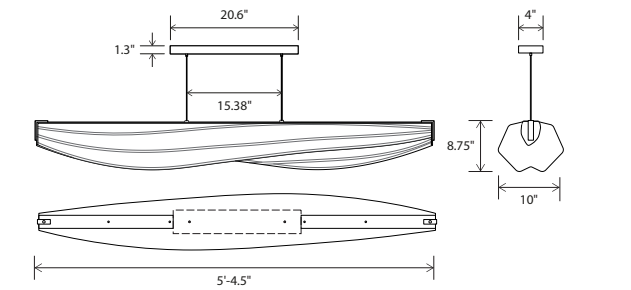

Dimensions: 5'-4.5" x 10", 8.75"  
 Materials: aluminum, stretch fabric  
 Product weight: 10 lb  
 Light source: integrated LED  
 Light output: 5000 Lumens (source)  
 Light color: 2700 K or 3500 K  
 Color accuracy: 90+ CRI  
 Power usage: 70 W  
 Dimmable (see driver below)  
 Brushed Aluminum (CM-006)  
 linear canopy included  
 Canopy dimensions: 20.6" x 4", 1.3"  
 Wood canopy covers are available:  
 Walnut (CM-001) cover:  
 part # 60-130-005W  
 Dark stained walnut (CM-002) cover:  
 part # 60-130-005D  
 See website for more canopy information  
 72" drop length, field adjustable  
 Suitable for a sloped ceiling  
 Wood grain will vary  
 Specifications subject to change  
 Patent No.: US D857,968 S



**MATERIAL & FINISH OPTIONS**

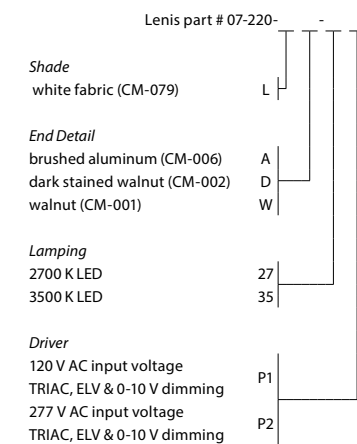

Shade  
white fabric (CM-079)

End Detail  
brushed aluminum (CM-006)  
dark stained walnut (CM-002)  
walnut (CM-001)

Lamping  
2700 K LED  
3500 K LED

Driver  
120 V AC input voltage  
TRIAC, ELV & 0-10 V dimming  
277 V AC input voltage  
TRIAC, ELV & 0-10 V dimming

Includes  
brushed aluminum (CM-006)

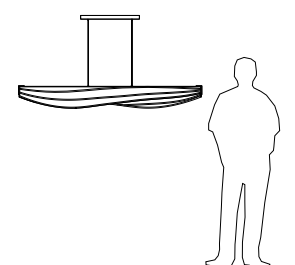
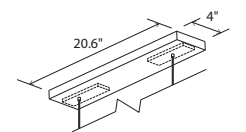

*Bret, Dan and I have always loved the ocean and boats. In fact, the first project we built together as young boys was a sailboat. Our appreciation for the beauty of a well-designed craft is what initially inspired the Lenis fixture; the form is created by bending wood stringers over a series of bulkheads. The organic and sculptural structure deviates from our mostly rectilinear forms, which introduced many new challenges, yet it also breathed new life into the design process for us. Ultimately, we were searching for that balance between the curved fluidity of its lines and the twisting movement. Thanks to our team's determination, after countless studies and prototypes, we found the balance we were looking for.*

Nick Sheridan,  
Designer



**Arca**  
linear pendant

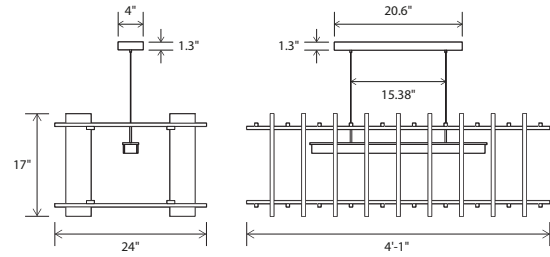

Dimensions: 4'-1" x 24", 17"  
 Materials: solid wood, aluminum, polymer  
 Product weight: 20 lb  
 Light source: integrated LED  
 Light output: 1720 Lumens (source)  
 Light color: 2700 K or 3500 K  
 Color accuracy: 90+ CRI  
 Power usage: 16 W  
 Dimmable (see driver below)  
 Linear canopy included  
 Canopy dimensions: 20.6" x 4", 1.3"  
 Canopy finish matches fixture's metal finish  
 Wood canopy covers are available:  
 Walnut (CM-001) cover: part # 60-130-005W  
 Dark stained walnut (CM-002) cover:  
 part # 60-130-005D  
 See website for more canopy information  
 72" drop length, field adjustable  
 Suitable for a sloped ceiling  
 Wood grain will vary  
 Specifications subject to change

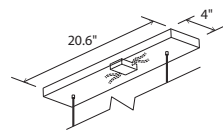

linear canopy,  
brushed aluminum

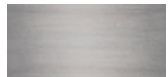

brushed aluminum  
(CM-006)



black anodized aluminum  
(CM-007)

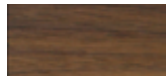

walnut  
(CM-001)



dark stained walnut  
(CM-002)

**MATERIAL & FINISH OPTIONS**

Arca part # 07-120-

**Metal Finish**  
 brushed aluminum (CM-006) A  
 black anodized aluminum (CM-007) B

**Wood Body**  
 walnut (CM-001) W  
 dark stained walnut (CM-002) D

**Lamping**  
 2700 K LED 27  
 3500 K LED 35

**Driver**  
 120-277 V AC input voltage  
 0-10V dimming P1  
 TRIAC and ELV dimming at 120 V AC only

**Includes**  
 polymer shade (CM-052)  
 frosted acrylic diffuser (CM-024)

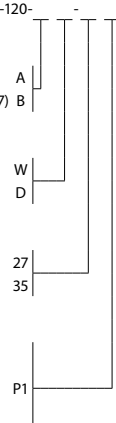

Arca, walnut, brushed aluminum



Arca, walnut, brushed aluminum

*The Arca is an experiment with density and mass. As one moves around the room, the fixture morphs from a commanding presence of solid walnut into a graceful bar of light surrounded by an elegant porous cage.*

Nick Sheridan  
Designer

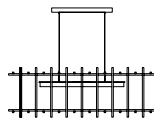

**Camur**  
linear pendant

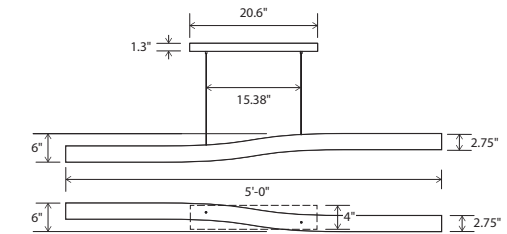

Dimensions: 5'-0" x 2.75", 2.75"  
 Materials: solid wood, polymer  
 Product weight: 6 lb  
 Light source: integrated LED  
 Light output: 2500 Lumens (source)  
 Light color: 2700 K or 3500 K  
 Color accuracy: 90+ CRI  
 Power usage: 35 W  
 Dimmable (see driver below)  
 Brushed aluminum (CM-006) camur canopy included  
 Canopy dimensions: 20.6" x 4", 1.3"  
 Wood camur canopy covers are available:  
 Walnut (CM-001) wood camur canopy cover:  
 part # 60-150-005W  
 Dark stained walnut (CM-002) wood camur canopy cover:  
 part # 60-150-005D  
 See website for more canopy information  
 72" drop length, field adjustable  
 Suitable for a sloped ceiling  
 Wood grain will vary  
 Specifications subject to change

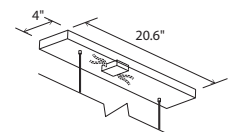

Camur canopy,  
brushed aluminum



Camur canopy cover,  
walnut

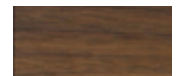

walnut  
(CM-001)



dark stained walnut  
(CM-002)

**MATERIAL & FINISH OPTIONS**

Camur part # 07-210-

**Wood Body**  
 walnut (CM-001) W  
 dark stained walnut (CM-002) D

**Lamping**  
 2700 K LED 27  
 3500 K LED 35

**Driver**  
 120 V AC input voltage  
 TRIAC, ELV & 0-10V dimming P1  
 277 V AC input voltage  
 TRIAC, ELV & 0-10V dimming P2

*The true beauty of the Camur is difficult to appreciate in print. When experiencing this fixture in person you begin to see the subtlety and grace of its vertical and horizontal movements. As you walk around this fixture the shape will morph from a beautiful curve to a straight line. We have created a video to help celebrate these details at [www.cernogroup.com/camur](http://www.cernogroup.com/camur)*



Camur, walnut



*Light and delicate, subtly unique while simple, the camur must be experienced to really be appreciated. The gentle curve appears from the bottom just the same as it does from the side: but the perspectives found between the two intrigue.*

Nick Sheridan,  
Designer

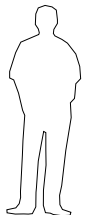
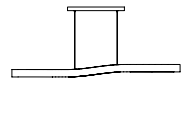



in collaboration with  
**DESIRON FRANK CARFARO**  
 HAND CRAFTED AMERICAN FURNITURE



The Aeris was a collaboration with New York based designer Frank Carfaro of Desiron. The organic and often wild swirls of walnut grain are interrupted by rigorous slits and inlays that punctuate each face to create a beautiful juxtaposition, making each fixture unique. The glow of the illuminated wood seen through the cut slits creates a rich composition of light and shadow.

Nick Sheridan  
 Co-Designer

**Aeris 30 / Aeris 54**  
 linear pendant

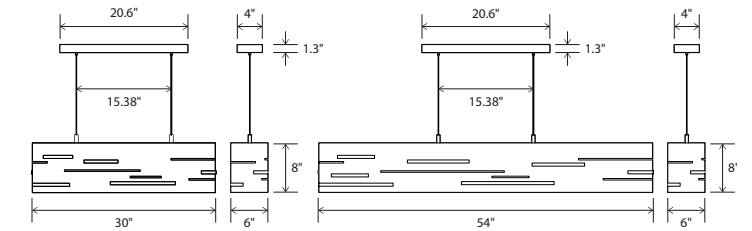

Aeris 30 dimensions: 30" x 6", 8"  
 Aeris 54 dimensions: 54" x 6", 8"  
 Materials: solid wood, aluminum  
 Aeris 30 weight: 11 lb  
 Aeris 54 weight: 15 lb  
 Light source: integrated LED  
 Light output - total: 1720 Lumens (source)  
 Light output - downlight: 1030 Lumens (source)  
 Light output - uplight: 690 Lumens (source)  
 Light color: 2700 K or 3500 K  
 Color accuracy: 90+ CRI  
 Power usage: 16 W  
 Dimmable (see driver below)  
 Linear canopy included  
 Canopy dimensions: 20.6" x 4", 1.3"  
 Canopy finish matches fixture's metal finish  
 Wood canopy covers are available:  
 Walnut (CM-001) cover: part # 60-130-005W  
 Dark stained walnut (CM-002) cover:  
 part # 60-130-005D  
 See website for more canopy information  
 72" drop length, field adjustable  
 Suitable for a sloped ceiling  
 Wood grain will vary  
 Specifications subject to change

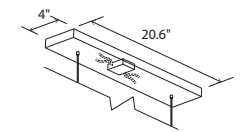

linear canopy,  
 brushed aluminum

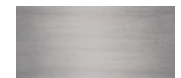

brushed aluminum  
 (CM-006)



black anodized aluminum  
 (CM-007)



walnut  
 (CM-001)



dark stained walnut  
 (CM-002)

**MATERIAL & FINISH OPTIONS**

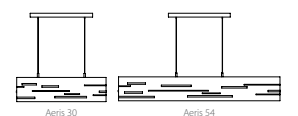
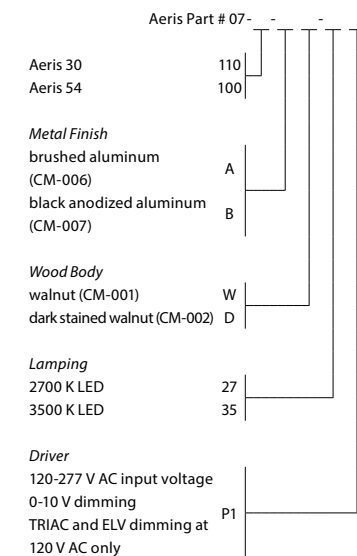

Includes  
 polymer shade (CM-052)





Vix 48, walnut



Vix 48, walnut

A clean, modern fixture finely executed. With multiple down and up lights, the Vix provides lots of usable light in a very unobtrusive design.

Nick Sheridan  
Designer

**Vix 34 / Vix 48**  
linear pendant

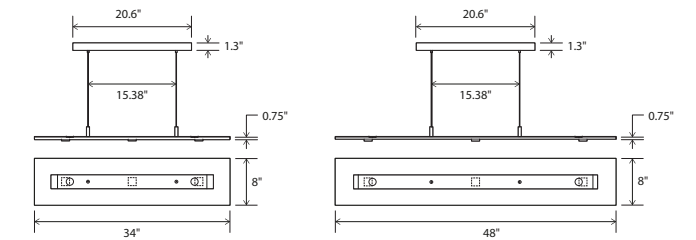

Vix 34 dimensions: 34" x 8", 0.75"  
 Vix 48 dimensions: 48" x 8", 0.75"  
 Materials: solid wood, polymer, aluminum  
 Vix 34 weight: 10 lb  
 Vix 48 weight: 15 lb  
 Light source: integrated LED  
 Light output - total: 1720 Lumens (source)  
 Light output - downlight: 1030 Lumens (source)  
 Light output - uplight: 690 Lumens (source)  
 Light color: 2700 K or 3500 K  
 Color accuracy: 90+ CRI  
 Power usage: 16 W  
 Dimmable (see driver below)  
 Brushed aluminum (CM-006) linear canopy included  
 Canopy dimensions: 20.6" x 4", 1.3"  
 Wood canopy cover available:  
 Walnut (CM-001) cover: part # 60-130-005W  
 Dark stained walnut (CM-002) cover:  
 part # 60-130-005D  
 See website for more canopy information  
 72" drop length, field adjustable  
 Suitable for a sloped ceiling  
 Wood grain will vary  
 Specifications subject to change

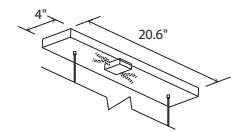

linear canopy,  
brushed aluminum

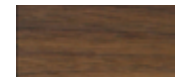

walnut  
(CM-001)



dark stained walnut  
(CM-002)

**MATERIAL & FINISH OPTIONS**

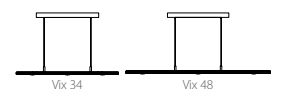
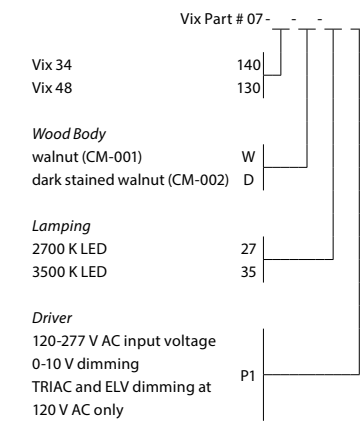

Includes  
polymer shade (CM-052)



**Penna 40 / Penna 64**  
linear pendant

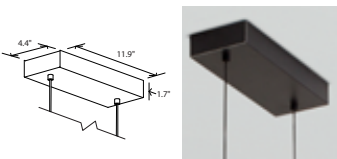
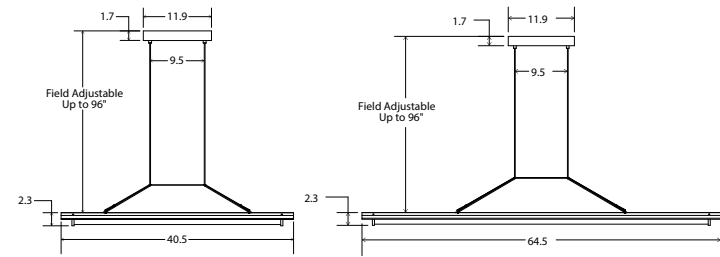

linear canopy, matte black finish



brushed brass (CM-008)

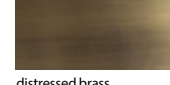

distressed brass (CM-009)

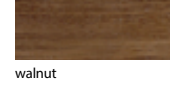

walnut (CM-001)

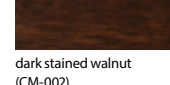

dark stained walnut (CM-002)

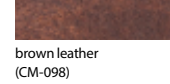

brown leather (CM-098)

Penna 40 dimensions: 40.5" x 7.7", 3.0"  
Penna 64 dimensions: 64.5" x 7.7", 3.0"  
Penna 40 weight: 7 lb  
Penna 64 weight: 10 lb  
Light source: integrated LED  
Penna 40 light output: 1530 Lumens (source)  
Penna 64 light output: 2550 Lumens (source)  
Light color: 2700 K or 3500 K  
Color accuracy: 90+ CRI  
Penna 40 power usage: 21 W  
Penna 64 power usage: 35 W  
Dimmable (see driver below)  
Linear canopy included  
Canopy dimensions: 11.9" x 4.4", 1.7"  
Canopy finish: matte black (CM-085)  
See website for more canopy information  
8"-0" drop length, field adjustable  
Suitable for a sloped ceiling  
Wood grain will vary  
Specifications subject to change

**MATERIAL & FINISH OPTIONS**

Penna pendant part # 07-150-

| Part   | Options |
|--|---------|
| Penna 40   | 40      |
| Penna 64   | 64      |
| <b>Metal Finish</b>                                |         |
| brushed brass (CM-008)                             | R       |
| distressed brass (CM-009)                          | D       |
| <b>Wood Body</b>                                   |         |
| walnut (CM-001)                                    | W       |
| dark stained walnut (CM-002)                       | D       |
| <b>Lamping</b>                                     |         |
| 2700 K LED   | 27      |
| 3500 K LED   | 35      |
| <b>Driver</b>                                      |         |
| 120 V AC input voltage TRIAC, ELV & 0-10 V dimming | P1      |
| 277 V AC input voltage TRIAC, ELV & 0-10 V dimming | P2      |

Includes brown leather (CM-098) frosted polymer (CM-057)

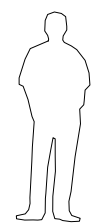

Penna 64, walnut, brushed brass



Penna 64, walnut, distressed brass



Penna 40, dark stained walnut, distressed brass

On our Cerno journey, we continue to evolve as designers and craftsmen. The Penna is a celebration of us drawing and reflecting on our last ten years. This design is an embodiment of all the lessons that we have learned from designing and building thousands of lights. This fixture balances utility and sophisticated beauty well. The walnut, brass, and leather work in concert to compose a modern form with materials that have been used for thousands of years.

Nick Sheridan  
Designer



Vix 82, walnut



Vix 82, walnut

A clean, modern fixture finely executed. With multiple down and up lights, the Vix provides lots of usable light in a very unobtrusive design.

Nick Sheridan  
Designer

**Vix 82**  
linear pendant

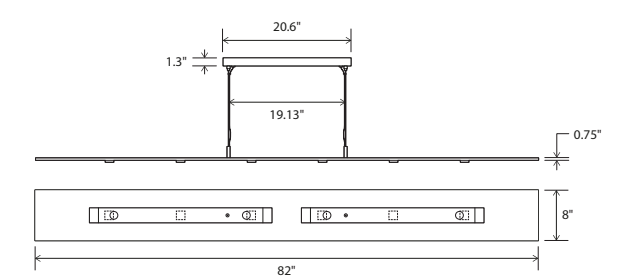

Dimensions: 82" x 8", 0.75"  
Materials: solid wood, polymer, aluminum  
Product weight: 19 lb  
Light source: integrated LED  
Light output - total: 3440 Lumens (source)  
Light output - downlight: 2060 Lumens (source)  
Light output - uplight: 1380 Lumens (source)  
Light color: 2700 K or 3500 K  
Color accuracy: 90+ CRI  
Power usage: 32 W  
Dimmable (see driver below)  
Brushed aluminum (CM-006) linear canopy included  
Canopy dimensions: 20.6" x 4", 1.3"  
See website for more canopy information  
Drop length field adjustable: 0'-10" min, 8'-0" max  
Suitable for a sloped ceiling  
Wood grain will vary  
Wood shade may slightly bow or twist along 82" length  
Specifications subject to change

**MATERIAL & FINISH OPTIONS**

Vix 82 part # 07-200-

| Part   | Options |
|--|---------|
| <b>Wood Body</b>   |         |
| walnut (CM-001)  | W       |
| dark stained walnut (CM-002)   | D       |
| <b>Lamping</b>   |         |
| 2700 K LED   | 27      |
| 3500 K LED   | 35      |
| <b>Driver</b>  |         |
| 120-277 V AC input voltage 0-10 V dimming TRIAC and ELV dimming at 120 V AC only | P1      |

Includes polymer shade (CM-052)

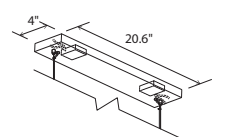

linear canopy, brushed aluminum



walnut (CM-001)

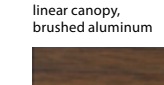

dark stained walnut (CM-002)

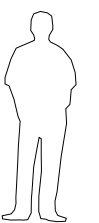
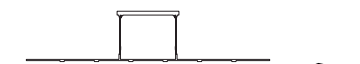



**Virga**  
linear pendant

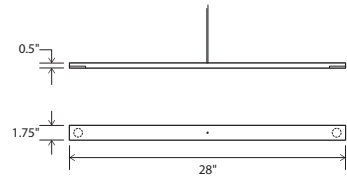

Dimensions: 28" x 1.75", 0.5"  
Materials: aluminum, polymer  
Product weight: 6 lb  
Light source: integrated LED  
Light output: 1126 Lumens (source)  
Light color: 2700 K or 3500 K  
Color accuracy: 90+ CRI  
Power usage: 13 W  
Dimmable (see driver below)

Extended-profile square canopy included, required to house LED driver (3.25" x 2.25" x 1.25")  
Canopy dimensions: 4.5" x 4.5", 1.63"  
Canopy finish matches fixture's metal finish  
See website for more canopy information  
48" suspension tube (can be shortened in field)  
Swivel option available for sloped ceilings, see drawing below

Specifications subject to change

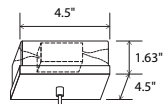

extended-profile square canopy  
brushed aluminum



brushed aluminum (CM-006)



black anodized aluminum (CM-007)

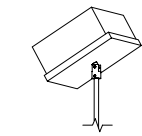

**MATERIAL & FINISH OPTIONS**

| Virga part # 06-130-                   |    |
|--|----|
| <b>Metal Finish</b>                    |    |
| brushed aluminum (CM-006)              | A  |
| black anodized aluminum (CM-007)       | B  |
| <b>Lamping</b>                         |    |
| 2700 K LED                             | 27 |
| 3500 K LED                             | 35 |
| <b>Driver</b>                          |    |
| 120-277 V AC input voltage             |    |
| 0-10V dimming                          |    |
| TRIAC and ELV dimming at 120 V AC only | P1 |

Includes polymer shade (CM-052)

Available for sloped ceilings:  
Sloped Extended-Profile Square Canopy



Virga, brushed aluminum



Virga, black anodized aluminum

A clean, minimal fixture executed without compromise. The very simple and sleek down light bar can be installed in very close proximity to its user – and withstand close scrutiny.

Nick Sheridan  
Designer

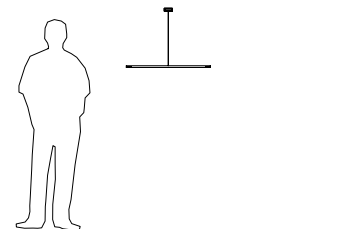

Brevis 28, brushed aluminum



Brevis 28, brushed aluminum

A clean, minimal fixture finely executed. With multiple down and up lights, the Brevis provides lots of usable light in a very unobtrusive design

Nick Sheridan  
Designer

**Brevis 28 / Brevis 42**  
linear pendants

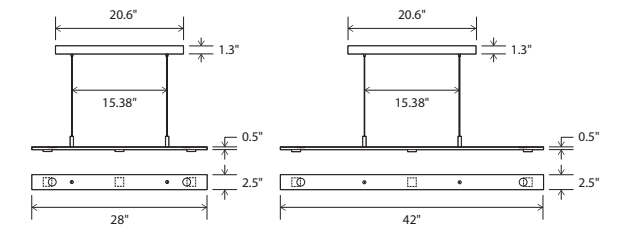

Brevis 28 dimensions: 28" x 2.5", 0.5"  
Brevis 42 dimensions: 42" x 2.5", 0.5"  
Materials: aluminum, polymer  
Brevis 28 weight: 7 lb  
Brevis 42 weight: 8 lb  
Light source: integrated LED  
Light output - total: 1720 Lumens (source)  
Light output - downlight: 1030 Lumens (source)  
Light output - uplight: 690 Lumens (source)  
Light color: 2700 K or 3500 K  
Color accuracy: 90+ CRI  
Power usage: 16 W  
Dimmable (see driver below)

Linear canopy included  
Canopy dimensions: 20.6" x 4", 1.3"  
Canopy finish matches fixture's metal finish  
Wood canopy covers are available:  
Walnut (CM-001) cover: part # 60-130-005W  
Dark stained walnut (CM-002) cover: part # 60-130-005D  
See website for more canopy information  
72" drop length, field adjustable  
Suitable for a sloped ceiling  
Specifications subject to change

Specifications subject to change

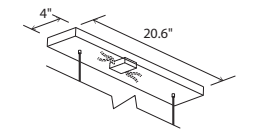

linear canopy, brushed aluminum



brushed aluminum (CM-006)



black anodized aluminum (CM-007)

**MATERIAL & FINISH OPTIONS**

| Brevis Part # 06-                      |     |
|--|-----|
| Brevis 28                              | 920 |
| Brevis 42                              | 910 |
| <b>Metal Finish</b>                    |     |
| brushed aluminum (CM-006)              | A   |
| black anodized aluminum (CM-007)       | B   |
| <b>Lamping</b>                         |     |
| 2700 K LED                             | 27  |
| 3500 K LED                             | 35  |
| <b>Driver</b>                          |     |
| 120-277 V AC input voltage             |     |
| 0-10 V dimming                         |     |
| TRIAC and ELV dimming at 120 V AC only | P1  |

Includes polymer shade (CM-052)

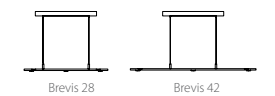

Brevis 28

Brevis 42



## Pendants



Cano



Bimar



Abeo



Claudo



Muto



Astrum

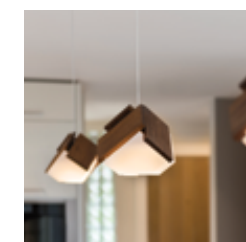

Mica



Mica Family



Imber

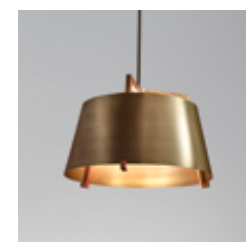

Ignis



Levis Family



Salix



Ico

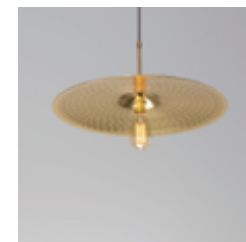

Ico

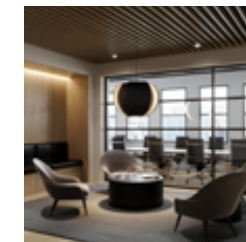

Veris



Plura Pendant



Calx





**Cano pendant**

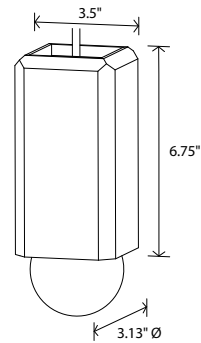

Dimensions: 3.5" x 3.5", 6.75"  
 Materials: solid wood  
 Product weight: 2 lb  
 Light source: medium base E26 socket  
 Lamping: E26 base, type G25 lamp, 20 W max  
 Input voltage: 250 V AC max  
 Suspension Details: Textured Black Powdercoat (CM-049) low profile round canopy with Grey Cloth Covered Cord (CM-106)  
 Canopy dimensions: 5" Ø, 0.3"  
 See website for more canopy information  
 Field adjustable drop length: 0'6" min - 6'0" max  
 Suitable for a sloped ceiling  
 Wood grain will vary  
 Specifications subject to change



Optional dimmable LED G25 bulb  
 Light output: 500 Lumens (source)  
 Color accuracy: 90+ CRI  
 Power usage: 5.5 W

**MATERIAL & FINISH OPTIONS**

Cano part # 06-251- - MB

|                              |    |
|------------------------------|----|
| <b>Wood Shade</b>            |    |
| walnut (CM-001)              | W  |
| dark stained walnut (CM-002) | D  |
| white washed oak (CM-095)    | O  |
| <b>Bulb Options</b>          |    |
| 2700 K G25 LED bulb included | 27 |
| no bulb included             | 00 |

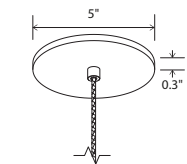

low-profile round canopy with braided cord

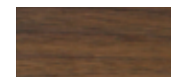

walnut (CM-001)

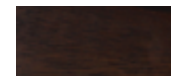

dark stained walnut (CM-002)



white washed oak (CM-095)

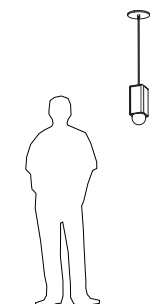

Cano, white washed oak

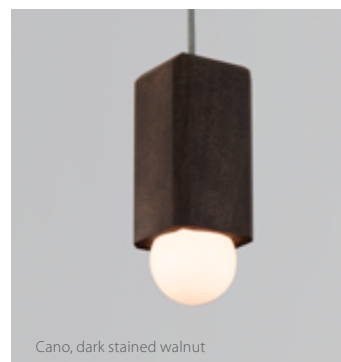

Cano, dark stained walnut

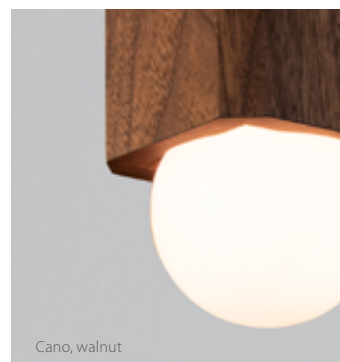

Cano, walnut

Designing with LEDs often lends itself to hiding, or using a low profile light source. The Cano pendant does the opposite; the light bulb is an integral part of the design. The solid hardwood faceted body is enhanced when paired with a spherical glowing bulb.

**Bimar pendant**

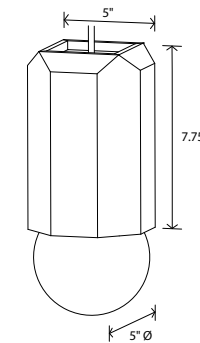

Dimensions: 5" x 5", 7.75"  
 Materials: solid wood  
 Product weight: 3 lb  
 Light source: medium base E26 socket  
 Lamping: E26 base, type G40 lamp, 20 W max  
 Input voltage: 250 V AC max  
 Textured Black Powdercoat (CM-049) low profile round canopy with Grey Cloth Covered Cord (CM-106)  
 Canopy dimensions: 5" Ø, 0.3"  
 See website for more canopy information  
 Field adjustable drop length: 0'6" min - 6'0" max  
 Suitable for a sloped ceiling  
 Wood grain will vary  
 Specifications subject to change



Optional dimmable LED G40 bulb  
 Light output: 1000 Lumens (source)  
 Color accuracy: 90+ CRI  
 Power usage: 11 W

**MATERIAL & FINISH OPTIONS**

Bimar part # 06-250- - MB

|                              |   |
|------------------------------|---|
| <b>Wood Shade</b>            |   |
| walnut (CM-001)              | W |
| dark stained walnut (CM-002) | D |
| white washed oak (CM-095)    | O |

|                              |    |
|------------------------------|----|
| <b>Bulb Options</b>          |    |
| 2700 K G40 LED bulb included | 27 |
| no bulb included             | 00 |

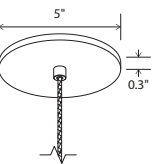

low-profile round canopy with braided cord

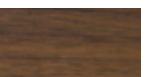

walnut (CM-001)



dark stained walnut (CM-002)



white washed oak (CM-095)

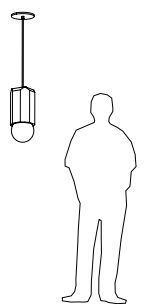

Bimar, white washed oak

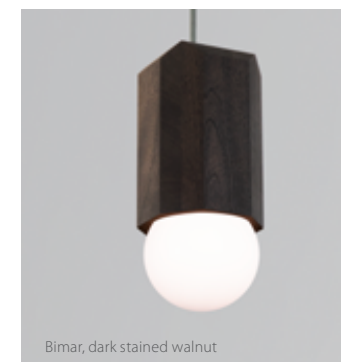

Bimar, dark stained walnut



Bimar, walnut

Built of one inch thick solid hardwood, the Bimar showcases the beauty of natural woodgrain. Eight faceted sides compose a design that works well in a modern or transitional space. The combination of natural wood and a glowing sphere warms up any environment.



**Muto**  
large pendant

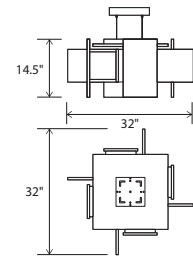

Dimensions: 32" x 32", 14.5"  
 Materials: solid wood, polymer  
 Product weight: 17 lb  
 Light source: integrated LED  
 Light output - total: 2626 Lumens (source)  
 Light output - ambient: 1376 Lumens (source)  
 Light output - downlight: 1250 Lumens (source)  
 Light color: 2700 K or 3500 K  
 Color accuracy: 90+ CRI  
 Power usage: 25 W  
 Dimmable (see driver below)  
 Brushed aluminum (CM-006) 8" square canopy with black mesh cables included  
 See instructions for additional canopy details at cernogroup.com  
 72" drop length, field adjustable  
 Suitable for a sloped ceiling  
 Wood grain will vary  
 Specifications subject to change

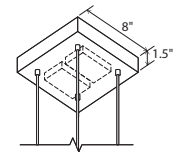

8" square canopy with black mesh cables

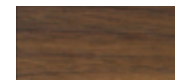

walnut (CM-001)

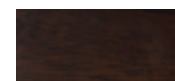

dark stained walnut (CM-002)

**MATERIAL & FINISH OPTIONS**

|  |                     |    |
|--|---------------------|----|
|  | Muto part # 06-140- |    |
| <b>Wood Body</b>                       |                     |    |
| walnut (CM-001)                        | W                   |    |
| dark stained walnut (CM-002)           | D                   |    |
| <b>Lamping</b>                         |                     |    |
| 2700 K LED                             | 27                  |    |
| 3500 K LED                             | 35                  |    |
| <b>Driver</b>                          |                     |    |
| 120-277 V AC input voltage             |                     | P1 |
| 0-10 V dimming                         |                     |    |
| TRIAC and ELV dimming at 120 V AC only |                     |    |
| <b>Includes</b>                        |                     |    |
| frosted polymer diffuser (CM-024)      |                     |    |

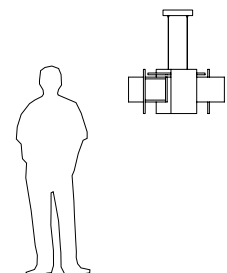

Muto, walnut



Muto, walnut



The way the walnut planes in the Muto both block and bounce light makes for a very dynamic composition of light and shadow, from any vantage point. While the pinwheel form with its repeating elements is symmetric, it appears very sculptural from any one view. The modern floating ideal is realized in the Muto. By holding each walnut element away from its neighbor, so each plane floats, the whole fixture feels weightless as if it were floating itself.

Nick Sheridan  
Designer



Astrum 11, distressed brass



Astrum, detail

Inspiration for the Astrum dates back to the first light fixture the three of us ever made after starting Cerno. The varying depths of the flat panels strategically obstruct a direct view of the light source. Light reflects off the inside of the outer panels and bounces off the inner panels producing a halo washing effect. The oculus at the bottom functions to emit a useful amount of downlighting. This design manages to pay homage to past modern designs while also feeling a bit futuristic.

**Astrum 11**  
pendant

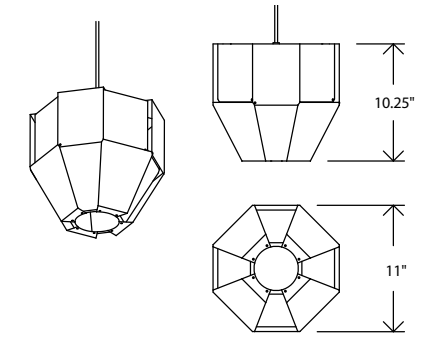

Dimensions: 11" x 11", 10.25"  
 Product weight: 2 lb  
 Suitable for a sloped ceiling

**Integrated LED Specifications**  
 Light output: 1690 Lumens (source)  
 Light color: 2700 K, 3000 K, 3500 K or 4000 K  
 Color accuracy: 90+ CRI  
 Power usage: 19.5 W  
 Dimmable (see driver below)  
 Driver must be housed in J-box  
 Driver dimensions: 3.3" x 1.6" x 1", included

**E26 Medium Base Specifications**  
 Lamping: E26 base, type A lamp, 60 W max  
 Input voltage: 250 V AC max  
 Bulb not included

Textured Black Powdercoat (CM-049) low profile round canopy with SVT-3 Cable, Black (CM-039)  
 Canopy dimensions: 5" Ø, 0.3"  
 See website for more canopy information  
 Field adjustable drop length: 0'6" min - 8'0" max  
 Specifications subject to change



**MATERIAL & FINISH OPTIONS**

|  |                            |    |
|--|----------------------------|----|
|  | Astrum 11 part # 06-270-11 |    |
| <b>Shade Material</b>                          |                            |    |
| matte black (CM-085) with matte white interior | B                          |    |
| distressed brass (CM-096)                      | D                          |    |
| gloss white (CM-054)                           | W                          |    |
| <b>Lamping</b>                                 |                            |    |
| 2700 K LED                                     | 27                         |    |
| 3000 K LED                                     | 30                         |    |
| 3500 K LED                                     | 35                         |    |
| 4000 K LED                                     | 40                         |    |
| <b>medium base E26 socket</b>                  | MB                         |    |
| <b>Driver (LED version only)</b>               |                            |    |
| 120-277 V AC input voltage                     |                            | P1 |
| 0-10 V dimming                                 |                            |    |
| TRIAC and ELV dimming at 120 V AC only         |                            |    |

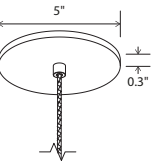

low-profile round canopy with braided cord



matte black (CM-085) with matte white interior



distressed brass (CM-096)



gloss white (CM-054)

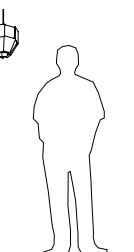





Astrum 17, matte black with matte white interior



Astrum, detail

Inspiration for the Astrum dates back to the first light fixture the three of us ever made after starting Cerno. The varying depths of the flat panels strategically obstruct a direct view of the light source. Light reflects off the inside of the outer panels and bounces off the inner panels producing a halo washing effect. The oculus at the bottom functions to emit a useful amount of downlighting. This design manages to pay homage to past modern designs while also feeling a bit futuristic.

**Astrum 17**  
pendant

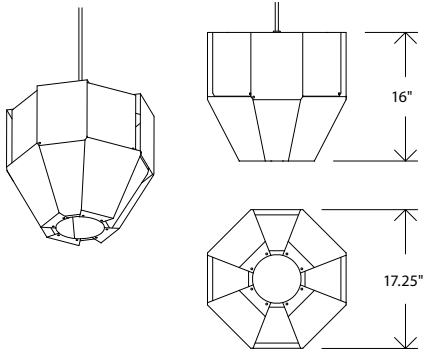

Dimensions: 17.25" x 17.25", 16"  
Product weight: 4 lb  
Suitable for a sloped ceiling

**Integrated LED Specifications**  
Light output: 1690 Lumens (source)  
Light color: 2700 K, 3000 K, 3500 K or 4000 K  
Color accuracy: 90+ CRI  
Power usage: 19.5 W  
Dimmable (see driver below)  
Driver must be housed in J-box  
Driver dimensions: 3.3" x 1.6" x 1", included

**E26 Medium Base Specifications**  
Lamping: 2x E26 base, type A lamp, 60 W max  
Input voltage: 250 V AC max  
Bulb not included

Textured Black Powdercoat (CM-049) low profile round canopy with SVT-3 Cable, Black (CM-039)  
Canopy dimensions: 5" Ø, 0.3"  
See website for more canopy information  
Field adjustable drop length: 0'6" min - 8'0" max  
Specifications subject to change



**MATERIAL & FINISH OPTIONS**

Astrum 17 part # 06-270-17

**Shade Material**  
matte black (CM-085) with matte white interior  
distressed brass (CM-096)  
gloss white (CM-054)

**Lamping**  
2700 K LED  
3000 K LED  
3500 K LED  
4000 K LED  
medium base E26 socket

**Driver (LED version only)**  
120-277 V AC input voltage  
0-10 V dimming  
TRIAC and ELV dimming at 120 V AC only

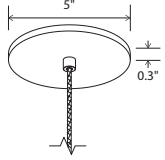
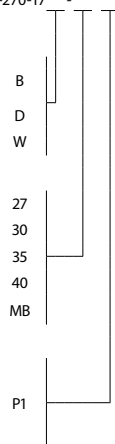

low-profile round canopy with braided cord



matte black (CM-085) with matte white interior

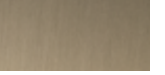

distressed brass (CM-096)



gloss white (CM-054)

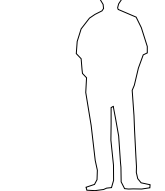
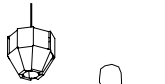



Imber 17 / Imber 24 pendant

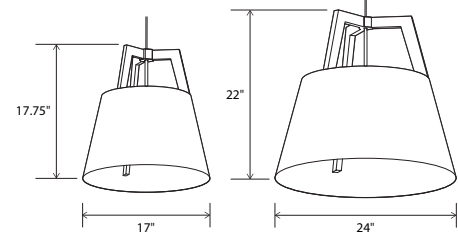

Imber 17 dimensions: 17" Ø, 17.75"  
 Imber 24 dimensions: 24" Ø, 22"  
 Materials: solid wood, metal  
 Imber 17 weight: 7 lb  
 Imber 24 weight: 12 lb  
 Wood grain will vary  
 Specifications subject to change

**Lamping**  
 Integrated LED Specifications  
 Light output: 1250 Lumens (source)  
 Light color: 2700 K or 3500 K  
 Additional color temperatures as well as sunset dimming are available upon request.  
 Color accuracy: 90+ CRI  
 Power usage: 13 W  
 Input voltage: 120-277 V AC  
 Dimmable: 0-10 V dimming at 120-277 V AC  
 TRIAC and ELV dimming at 120 V AC only

MATERIAL & FINISH OPTIONS

| Imber part # 06-210-                                       |         |
|--|---------|
| <b>Fixture Size</b>  |         |
| 17" Ø  | 17      |
| 24" Ø  | 24      |
| <b>Standard Combinations (Shade, Frame)</b>                |         |
| distressed brass, walnut                                   | DW      |
| distressed brass,  | DD      |
| dark stained walnut  | DD      |
| brushed brass, walnut                                      | RW      |
| brushed rose gold,   | GD      |
| dark stained walnut  | GD      |
| matte black with matte white interior, dark stained walnut | BD      |
| matte black with matte white interior, white washed oak    | BO      |
| matte black with matte white interior, walnut              | BW      |
| gloss white, white washed oak                              | WO      |
| <b>Suspension Type</b>                                     |         |
| corded   | C       |
| rigid  | R       |
| <b>Lamping</b>   |         |
| integrated LED with diffuser - 2700k                       | L-27 P1 |
| integrated LED with diffuser - 3500k                       | L-35 P1 |
| medium base socket without diffuser                        | S       |
| medium base socket with diffuser                           | D       |

Medium Base E26 Specifications

Imber 17 lamping:  
 1x E26 base, type A lamp, 75 W max  
 Imber 24 lamping:  
 3x E26 base, type A lamp, 75 W max each  
 Bulbs not included  
 Input voltage: 250 V AC max

Suspension Type

**Corded**  
 96" length of SVT wire is used. Wire is field adjustable and suitable for a sloped ceiling.  
**Rigid**  
 Stem comes 6' long and is field cuttable to length (0.38" Ø).

Suspension and Hardware Finish

**Standard Combinations**  
 Come with either black or satin nickel suspension, canopy, and sockets:  
 Black: DW, DD, RW, GD, BD, BO, BW  
 Satin Nickel: WO  
**Corded Versions**  
 White cord: satin nickel hardware  
 Black cord: black hardware  
 24" Imber corded uses a .06" Ø steel cable for suspension



Diffuser

Frosted white diffuser (CM-024)  
 Diffuser is recommended when fixture location may allow for direct glare.  
 Integrated LED option always comes with a diffuser



Imber 24, distressed brass, walnut

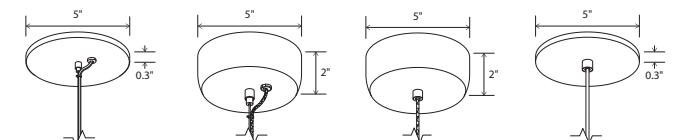

**Imber 24 with Medium base socket**  
 Low-profile round canopy, SPT with steel cable included  
 Canopy dimensions: 5.5"Ø, 2" deep

**Imber 24 with LED lamping**  
 Extended-profile round canopy, braided cord with steel cable included, required to house the LED driver (3.25" x 2.25" x 1.25")  
 Canopy dimensions: 5.5"Ø, 2" deep

**Imber 17 with LED lamping**  
 Extended-profile round canopy, braided cord included, required to house the LED driver (3.25" x 2.25" x 1.25")  
 Canopy dimensions: 5.5"Ø, 2" deep

**Imber 17 with Medium base socket**  
 Low-profile round canopy, SVT included  
 Canopy dimensions: 5"Ø, 0.3" deep



Ignis 24, brass, walnut

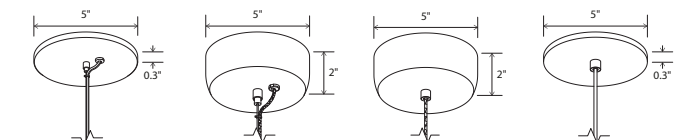

**Ignis 24 with Medium base socket**  
 Low-profile round canopy, SPT with steel cable included  
 Canopy dimensions: 5"Ø, 0.3" deep

**Ignis 24 with LED lamping**  
 Extended-profile round canopy, braided cord with steel cable included, required to house the LED driver (3.25" x 2.25" x 1.25")  
 Canopy dimensions: 5.5"Ø, 2" deep

**Ignis 17 with LED lamping**  
 Extended-profile round canopy, braided cord included, required to house the LED driver (3.25" x 2.25" x 1.25")  
 Canopy dimensions: 5.5"Ø, 2" deep

**Ignis 17 with Medium base socket**  
 Low-profile round canopy, SVT included  
 Canopy dimensions: 5"Ø, 0.3" deep

Ignis 17 / Ignis 24 pendant

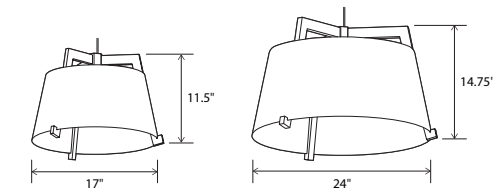

Ignis 17 dimensions: 17" Ø, 11.5"  
 Ignis 24 dimensions: 24" Ø, 14.75"  
 Materials: solid wood, metal  
 Ignis 17 weight: 7 lb  
 Ignis 24 weight: 11 lb  
 Wood grain will vary  
 Specifications subject to change



MATERIAL & FINISH OPTIONS

| Ignis part # 06-220-                                       |         |
|--|---------|
| <b>Fixture Size</b>  |         |
| 17" Ø  | 17      |
| 24" Ø  | 24      |
| <b>Standard Combinations (Shade, Frame)</b>                |         |
| distressed brass, walnut                                   | DW      |
| distressed brass,  | DD      |
| dark stained walnut  | DD      |
| brushed brass, walnut                                      | RW      |
| brushed rose gold,   | GD      |
| dark stained walnut  | GD      |
| matte black with matte white interior, dark stained walnut | BD      |
| matte black with matte white interior, white washed oak    | BO      |
| matte black with matte white interior, walnut              | BW      |
| gloss white, white washed oak                              | WO      |
| <b>Suspension Type</b>                                     |         |
| corded   | C       |
| rigid  | R       |
| <b>Lamping</b>   |         |
| integrated LED with diffuser - 2700K                       | L-27 P1 |
| integrated LED with diffuser - 3500K                       | L-35 P1 |
| medium base socket without diffuser                        | S       |
| medium base socket with diffuser                           | D       |

**Lamping**  
 Integrated LED Specifications  
 Light output: 1250 Lumens (source)  
 Light color: 2700 K or 3500 K  
 Additional color temperatures as well as sunset dimming are available upon request.  
 Color accuracy: 90+ CRI  
 Power usage: 13 W  
 Input voltage: 120-277 V AC  
 Dimmable: 0-10 V dimming at 120-277 V AC  
 TRIAC and ELV dimming at 120 V AC only

Medium Base E26 Specifications

Ignis 17 lamping:  
 1x E26 base, type A lamp, 75 W max  
 Ignis 24 lamping:  
 3x E26 base, type A lamp, 75 W max each  
 Bulbs not included  
 Input voltage: 250 V AC max

Suspension Type

**Corded**  
 8'-0" length of SVT wire is used. Wire is field adjustable and suitable for a sloped ceiling.  
**Rigid**  
 Stem comes 6' long and is field cuttable to length (0.38" Ø)

Suspension and Hardware Finish

**Standard Combinations**  
 Come with either black or satin nickel suspension, canopy, and sockets:  
 Black: DW, DD, RW, GD, BD, BO, BW  
 Satin Nickel: WO  
**Corded Versions**  
 White cord: satin nickel hardware  
 Black cord: black hardware  
 24" Ignis corded uses a 1/16" Ø steel cable for suspension

The Ignis and Imber were inspired by the same design principles that make Cerno and ICRAVE well suited to collaborate. Honesty, simplicity, elemental, timeless and quality are words that sit at the core of both companies' design ethos and we believe these light fixtures embrace these qualities well. Each fixture was reduced to its essential parts – frame and shade – highlighting the interplay of the components, and accentuating the clean lines of the form.

ICRAVE / Cerno

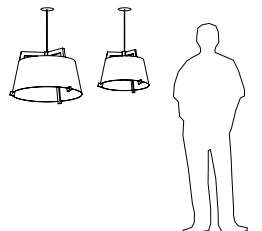





Ico pendant

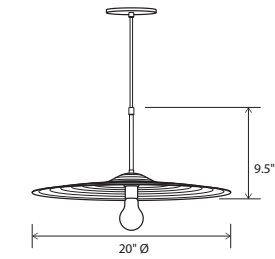

Dimensions: 20" Ø, 9.5"  
 Materials: solid brass  
 Product weight: 6 lb  
 Light source: medium base E26 socket  
 Lamping: 1x E26 base, 60 W max  
 Bulbs not included  
 Input voltage: 250 V AC max  
 Textured Black Powdercoat (CM-049)  
 low profile round canopy with Black Cloth Covered Cord (CM-090)  
 Canopy dimensions: 5" Ø, 0.3"  
 See website for more canopy information  
 Field adjustable drop length: 0'9" min - 8'0" max  
 Suitable for a sloped ceiling  
 Specifications subject to change

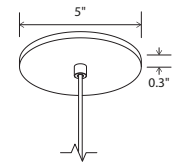

low-profile round canopy



MATERIAL & FINISH OPTIONS

|              |                           |       |
|--------------|---------------------------|-------|
|              | Ico part # 06-240-20      | R - C |
| Fixture Size | 20"                       |       |
| Shade Finish | spun solid brass (CM-091) | R     |
| Suspension   | corded (CM-008)           | C     |
| Includes     | brushed brass (CM-008)    |       |

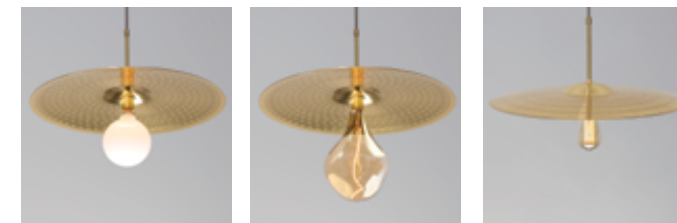

After working with drum cymbals on a few custom projects, we grew to appreciate the design and engineering that goes into these beautiful objects. Cymbals have a simple form, rich texture, and a beautiful brass finish. Modernism is often about utilizing what already exists and repurposing things, which is what we did with this fixture. The Ico looks excellent when paired with a simple light bulb.

Nick Sheridan  
 Designer

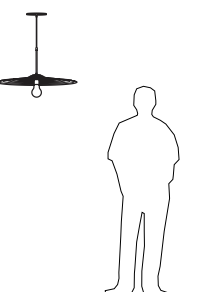



**Calx 10**  
accent pendant

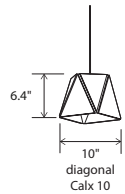

Dimensions: 6.75" x 6.75", 6.4"  
Materials: wood, metal, polymer  
Product weight: 2 lb  
Light source: integrated LED  
Light output: 345 Lumens (source)  
Light color: 2700 K or 3500 K  
Color accuracy: 90+ CRI  
Power usage: 3.2 W  
Dimmable (see driver below)  
Driver location: must be housed in J-box  
Driver dimensions: 2" x 1.3" x 1", included  
White (CM-060) low-profile round canopy with white braided cord included  
Canopy dimensions: 5"Ø, 0.3"  
See website for more canopy information  
72" drop length, field adjustable  
Suitable for a sloped ceiling  
Wood grain will vary  
Specifications subject to change



**MATERIAL & FINISH OPTIONS**

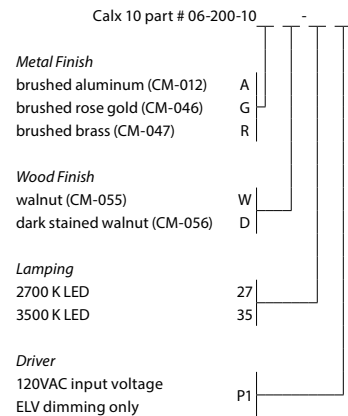

Calx sconce also available. Click here.

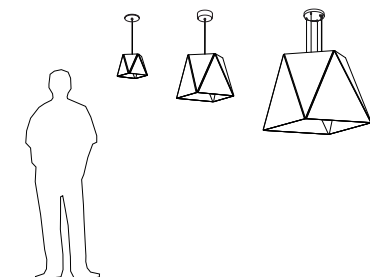

**Calx 19**  
pendant

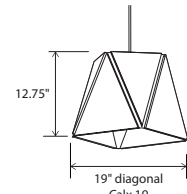

Dimensions: 13" x 13", 12.75"  
Materials: wood, metal, polymer  
Product weight: 7 lb  
Suitable for a sloped ceiling

**Integrated LED Specifications**  
Light output: 1250 Lumens (source)  
Light color: 2700 K or 3500 K  
Color accuracy: 90+ CRI  
Power usage: 13 W  
Dimmable (see driver below)  
White (CM-060) extended-profile round canopy with white braided cord and steel cable included  
Canopy dimensions: 5"Ø, 2"  
Canopy required to house LED driver (3.3" x 1.6" x 1.0")  
See below for more canopy information  
72" drop length, field adjustable

**Medium Base Specifications**  
Lamping: 1x E26 base, type A lamp, 60 W max  
Bulb not included  
Input voltage: 250 V AC max  
White (CM-060) low-profile round canopy with white SPT cord and steel cable included  
Canopy dimensions: 5"Ø, 0.3"  
72" drop length, field adjustable  
Suitable for a sloped ceiling  
Wood grain will vary  
Specifications subject to change



**MATERIAL & FINISH OPTIONS**

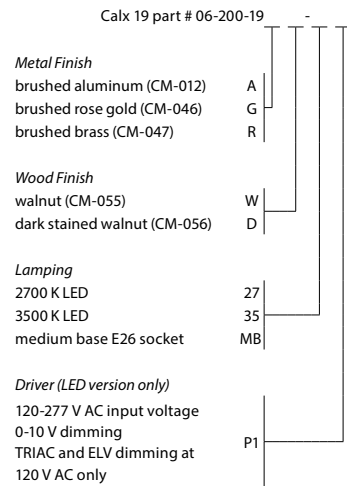

Includes frosted polymer diffuser (CM-057)

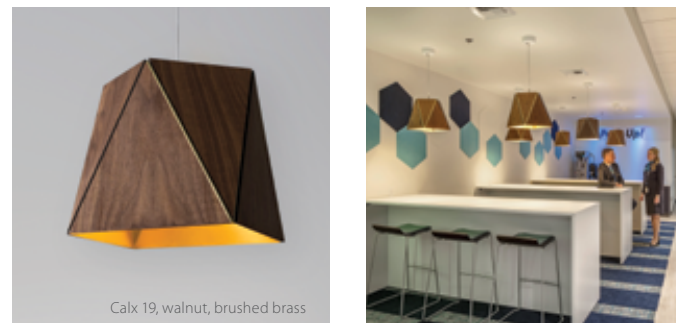

The Calx is an example of modern design where the methods and the materials themselves are integral to its very conception, aligning form and function, which creates a synergy that is evident. The fixture ultimately forms a square aperture but enjoys a beautifully simple faceted structure.

Nick Sheridan,  
Designer

**Calx 36**  
pendant

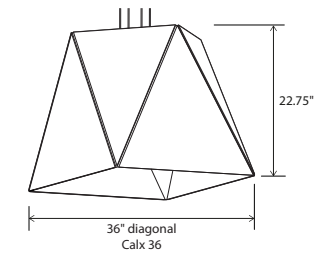

Dimensions: 25" x 25", 22.75"  
Materials: wood, metal, polymer  
Product weight: 18 lb  
Light source: 4x GU-24 base socket  
Lamping: 4x GU-24 base, 18 W max each  
Bulbs not included  
Input voltage: 300 V AC max  
White (CM-060) 8" round canopy included  
Canopy dimensions: 8"Ø, 1.25"  
See page left and website for more canopy information  
96" drop length, field adjustable  
Suitable for a sloped ceiling  
Wood grain will vary  
Specifications subject to change



**MATERIAL & FINISH OPTIONS**

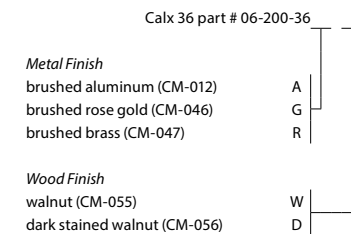

Includes frosted polymer diffuser (CM-057)

Calx sconce also available. Click here.

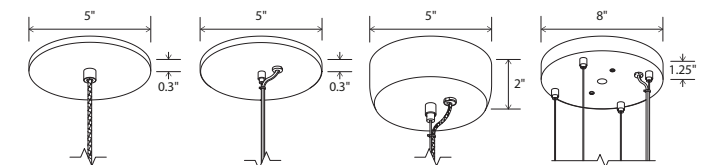

Calx 10 low-profile round canopy with braided cord  
Calx 19 E26 low-profile round canopy with white SPT with steel cable  
Calx 19 Integrated LED extended-profile round canopy with steel cable  
Calx 36 8" round canopy clear SPT with four 1/16" Ø steel cables





**Veris 12**  
pendant

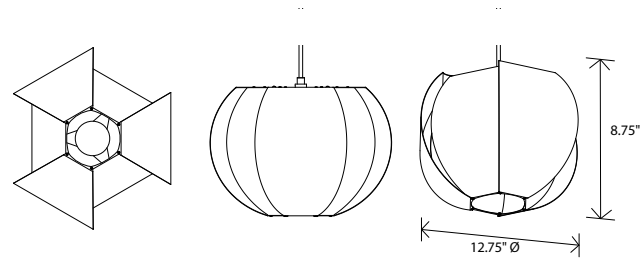

Dimensions: 12.75" Ø, 8.75"  
Product weight: 2 lb  
Suitable for a sloped ceiling

**Integrated LED Specifications**  
Light output: 1690 Lumens (source)  
Light color: 2700 K, 3000 K, 3500 K or 4000 K  
Color accuracy: 90+ CRI  
Power usage: 19.5 W  
Dimmable (see driver below)  
Driver must be housed in J-box

**E26 Medium Base Specifications**  
Driver dimensions: 3.3" x 1.6" x 1", included  
Lamping: E26 base, type A lamp, 60 W max  
Input voltage: 250 V AC max  
Bulb not included

Textured Black Powdercoat (CM-049) low profile round canopy with SVT-3 Cable, Black (CM-039)  
Canopy dimensions: 5" Ø, 0.3"  
See website for more canopy information  
Field adjustable drop length: 0'6" min - 8'0" max  
Specifications subject to change



**MATERIAL & FINISH OPTIONS**

Veris part # 06-260-12

**Shade Material**

- matte black (CM-085) with matte white interior B
- brushed aluminum (CM-012) A
- brushed rose gold (CM-046) G
- brushed brass (CM-047) R
- distressed brass (CM-096) D
- gloss white (CM-054) W

**Lamping**

- 2700 K LED 27
- 3000 K LED 30
- 3500 K LED 35
- 4000 K LED 40
- medium base E26 socket MB

**Driver (LED version only)**

- 120-277 V AC input voltage
- 0-10 V dimming
- TRIAC and ELV dimming at 120 V AC only



matte black (CM-085) with matte white interior



brushed aluminum (CM-012)



brushed rose gold (CM-046)



brushed brass (CM-047)



distressed brass (CM-096)



gloss white (CM-054)

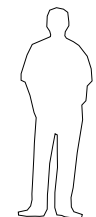
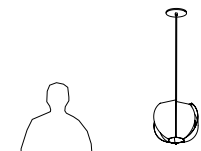

Veris 12, matte black with matte white interior

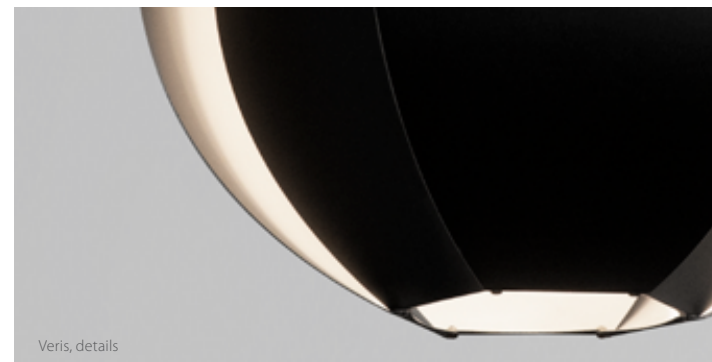

Veris, details

Veris was a concept we started exploring ten years ago. Two offset layers of petals simultaneously shield the light source while allowing reflected light to wash the inside petals, creating a dramatic ambient luminaire. The form materializes through a series of processes that utilize cutting edge CNC laser technology but still rely on skilled hand-rolling and bending of the aluminum petals.

**Veris 22**  
pendant

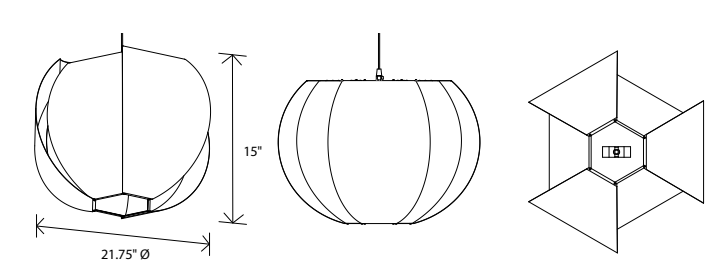

Dimensions: 21.75" Ø, 15"  
Product weight: 4 lb  
Suitable for a sloped ceiling

**Integrated LED Specifications**  
Light output: 1690 Lumens (source)  
Light color: 2700 K, 3000 K, 3500 K or 4000 K  
Color accuracy: 90+ CRI  
Power usage: 19.5 W  
Dimmable (see driver below)  
Driver must be housed in J-box

**E26 Medium Base Specifications**  
Driver dimensions: 3.3" x 1.6" x 1", included  
Lamping: 2x E26 base, type A lamp, 60 W max each  
Input voltage: 250 V AC max  
Bulb not included

Textured Black Powdercoat (CM-049) low profile round canopy with SVT-3 Cable, Black (CM-039)  
Canopy dimensions: 5" Ø, 0.3"  
See website for more canopy information  
Field adjustable drop length: 0'6" min - 8'0" max  
Specifications subject to change



**MATERIAL & FINISH OPTIONS**

Veris part # 06-260-22

**Shade Material**

- matte black (CM-085) with matte white interior B
- brushed aluminum (CM-012) A
- brushed rose gold (CM-046) G
- brushed brass (CM-047) R
- distressed brass (CM-096) D
- gloss white (CM-054) W

**Lamping**

- 2700 K LED 27
- 3000 K LED 30
- 3500 K LED 35
- 4000 K LED 40
- medium base E26 socket MB

**Driver (LED version only)**

- 120-277 V AC input voltage
- 0-10 V dimming
- TRIAC and ELV dimming at 120 V AC only



matte black (CM-085) with matte white interior



brushed aluminum (CM-012)



brushed rose gold (CM-046)



brushed brass (CM-047)



distressed brass (CM-096)



gloss white (CM-054)

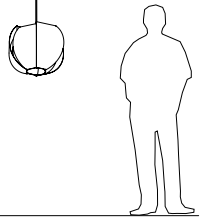
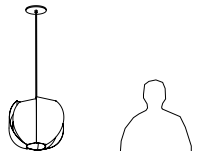

Veris 22, matte black with matte white interior

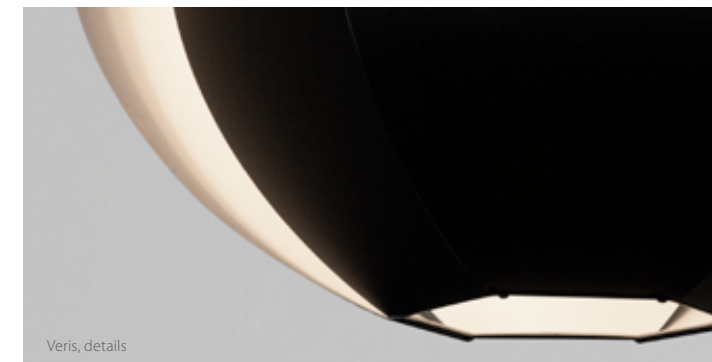

Veris, details

Veris was a concept we started exploring ten years ago. Two offset layers of petals simultaneously shield the light source while allowing reflected light to wash the inside petals, creating a dramatic ambient luminaire. The form materializes through a series of processes that utilize cutting edge CNC laser technology but still rely on skilled hand-rolling and bending of the aluminum petals.





Veris 34, matte black with matte white interior

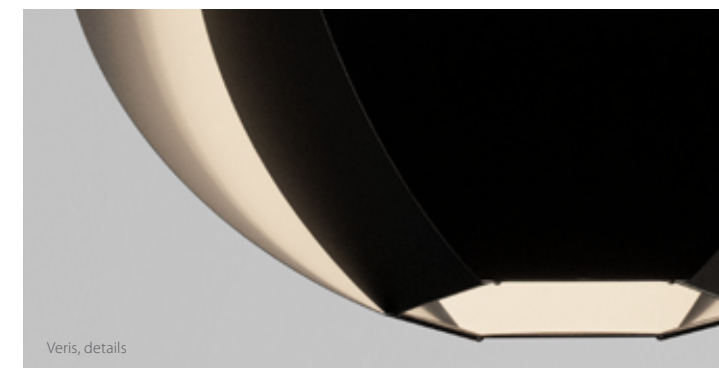

Veris, details

Veris was a concept we started exploring ten years ago. Two offset layers of petals simultaneously shield the light source while allowing reflected light to wash the inside petals, creating a dramatic ambient luminaire. The form materializes through a series of processes that utilize cutting edge CNC laser technology but still rely on skilled hand-rolling and bending of the aluminum petals.

**Veris 34**  
pendant

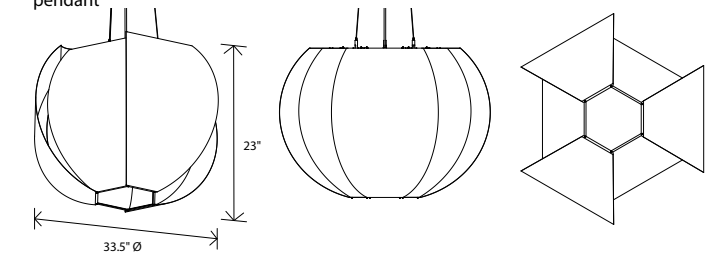

Dimensions: 33.5" Ø, 23"  
Product weight: 8 lb  
Suitable for a sloped ceiling

**Integrated LED Specifications**  
Light output: 2815 Lumens (source)  
Light color: 2700 K, 3000 K, 3500 K or 4000 K  
Color accuracy: 90+ CRI  
Power usage: 32.5 W  
Dimmable (see driver below)  
Driver housed in extended canopy  
Driver dimensions: 3.3" x 2.4" x 1", included

**E26 Medium Base Specifications**  
Lamping: 3x E26 base, type A lamp, 60 W max each  
Input voltage: 250 V AC max  
Bulb not included

Textured Black Powdercoat (CM-049) extended round canopy with SVT-3 Cable, Black (CM-039) and 1/16" Stainless Steel Cables (CM-053)  
Canopy dimensions: 5" Ø, 2"  
See website for more canopy information  
Field adjustable drop length: 1'0" min - 8'0" max  
Specifications subject to change



**MATERIAL & FINISH OPTIONS**

- matte black (CM-085) with matte white interior
- brushed aluminum (CM-012)
- brushed rose gold (CM-046)
- brushed brass (CM-047)
- distressed brass (CM-096)
- gloss white (CM-054)

| Veris part # 06-260-34                         |    |
|--|----|
| Shade Material                                 |    |
| matte black (CM-085) with matte white interior | B  |
| brushed aluminum (CM-012)                      | A  |
| brushed rose gold (CM-046)                     | G  |
| brushed brass (CM-047)                         | R  |
| distressed brass (CM-096)                      | D  |
| gloss white (CM-054)                           | W  |
| Lamping  |    |
| 2700 K LED                                     | 27 |
| 3000 K LED                                     | 30 |
| 3500 K LED                                     | 35 |
| 4000 K LED                                     | 40 |
| medium base E26 socket                         | MB |
| Driver (LED version only)                      |    |
| 120-277 V AC input voltage                     | P1 |
| 0-10 V dimming                                 |    |
| TRIAC and ELV dimming at 120 V AC only         |    |

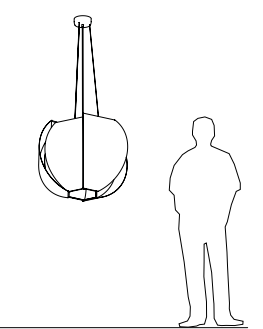





**Mica L**  
pendant

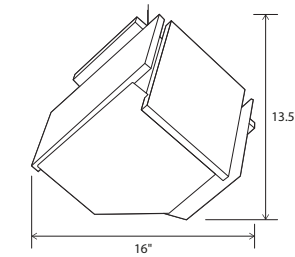

Dimensions: 16" Ø, 13.5"  
Materials: solid wood, polymer  
Product weight: 8 lb  
Suitable for a sloped ceiling

*Integrated LED Specifications*

Light output: 1250 Lumens (source)  
Light color: 2700 K or 3500 K  
Color accuracy: 90+ CRI  
Power usage: 13 W  
Dimmable (see driver below)  
Brushed aluminum (CM-006) extended-profile square canopy with white braided cord included  
Canopy dimensions: 4.5" x 4.5", 1.63"  
Canopy required to house LED driver (3.3" x 1.6" x 1.0")  
See website for more canopy information  
6'-0" drop length, field adjustable

*Medium Base Specifications*

Lamping: E26 base, type A lamp, 60 W max  
Bulb not included  
Input voltage: 250 V AC max  
White (CM-060) low-profile round canopy with clear SVT cord included  
Canopy dimensions: 5"Ø, 0.3"  
6'-0" drop length, field adjustable

Wood grain will vary  
Specifications subject to change



MATERIAL & FINISH OPTIONS

Mica L part # 06-180-

Wood Body  
walnut (CM-001) W  
dark stained walnut (CM-002) D

Lamping  
2700 K LED 27  
3500 K LED 35  
medium base E26 socket MB

Driver (LED version only)  
120-277 V AC input voltage  
0-10 V dimming  
TRIAC and ELV dimming at 120 V AC only

Includes  
frosted polymer (CM-024)

**Mica**  
accent pendant

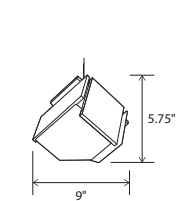

Dimensions: 9" Ø, 5.75"  
Materials: solid wood, polymer  
Product weight: 3 lb  
Light source: integrated LED  
Light output: 345 Lumens (source)  
Light color: 2700 K or 3500 K  
Color accuracy: 90+ CRI  
Power usage: 3.2 W  
Dimmable (see driver below)  
Driver location: must be housed in J-box  
Driver dimensions: 2" x 1.3" x 1", included  
Brushed aluminum (CM-006) low-profile square canopy with white braided cord included  
Canopy dimensions: 4.5" x 4.5", 0.38"  
External LED driver (2.25" x 1.5" x 1")  
Accent pendants can be clustered by using multi-point round canopy or multi-point linear canopy  
See website for more canopy information  
6'-0" drop length, field adjustable  
Suitable for a sloped ceiling  
Wood grain will vary  
Specifications subject to change

*Integrated LED Specifications*

Light output: 345 Lumens (source)  
Light color: 2700 K or 3500 K  
Color accuracy: 90+ CRI  
Power usage: 3.2 W  
Dimmable (see driver below)  
Driver location: must be housed in J-box  
Driver dimensions: 2" x 1.3" x 1", included  
Brushed aluminum (CM-006) low-profile square canopy with white braided cord included  
Canopy dimensions: 4.5" x 4.5", 0.38"  
External LED driver (2.25" x 1.5" x 1")  
Accent pendants can be clustered by using multi-point round canopy or multi-point linear canopy  
See website for more canopy information  
6'-0" drop length, field adjustable  
Suitable for a sloped ceiling  
Wood grain will vary  
Specifications subject to change

*Medium Base Specifications*

Lamping: E26 base, type A lamp, 60 W max  
Bulb not included  
Input voltage: 250 V AC max  
White (CM-060) low-profile round canopy with clear SVT cord included  
Canopy dimensions: 5"Ø, 0.3"  
6'-0" drop length, field adjustable

Wood grain will vary  
Specifications subject to change



MATERIAL & FINISH OPTIONS

Mica part # 06-160-

Wood Body  
walnut (CM-001) W  
dark stained walnut (CM-002) D

Lamping  
2700 K LED 27  
3500 K LED 35

Driver  
120 V AC input voltage  
ELV dimming only

Includes  
frosted polymer (CM-024)

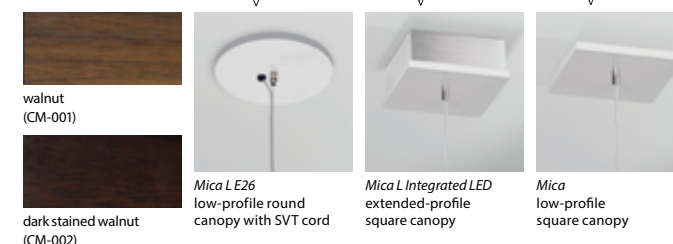
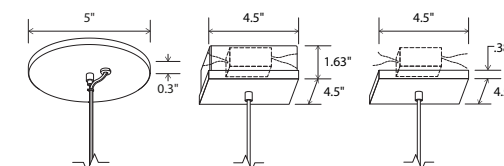

The Mica is simply a cube, which has been carefully deconstructed to a sculptural state. By way of the fixture's orientation and petal material composition, it exudes a certain organic symmetry. The Mica accent pendant acts as a beautiful node, creating a sense of space marked with an ambient glow.

Nick Sheridan  
Designer

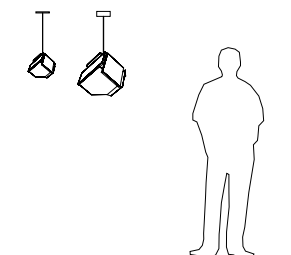



**Levis**  
accent pendant

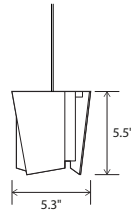

Dimensions: 5.3" Ø, 5.5" H  
 Materials: polymer, veneer and aluminum options  
 Product weight: 1 lb  
 Energy efficient LED light source  
 Light output: 345 Lumens (source)  
 Light color: 2700 K (warm) or 3500 K (cool)  
 Color accuracy: 90+ CRI  
 LED power consumption: 3.2W  
 Dimmable (see driver below)  
 Driver location: must be housed in J-box  
 Driver dimensions: 2" x 1.3" x 1", included  
 Brushed aluminum (CM-006) Low-Profile Square Canopy included  
 Canopy dimensions: 4.5" x 4.5", 0.38"  
 Must use included external LED driver (2.25" x 1.5" x 1")  
 Accent pendants can be clustered by using Multi-Point Round Canopy or Multi-Point Linear Canopy  
 See website for more canopy information  
 6'-0" drop length, field adjustable  
 Suitable for a sloped ceiling  
 Wood grain will vary  
 Specifications subject to change



**Levis L**  
pendant

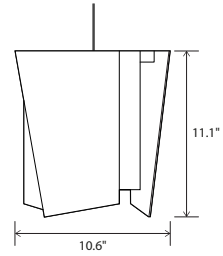

Dimensions: 10.6" Ø, 11.1"  
 Materials: polymer, veneer and aluminum options  
 Product weight: 7 lb  
 Suitable for a sloped ceiling  
**Integrated LED Specifications**  
 Light output: 1250 Lumens (source)  
 Light color: 2700 K or 3500 K  
 Color accuracy: 90+ CRI  
 Power usage: 13 W  
 Dimmable (see driver below)  
 Brushed aluminum (CM-006) extended-profile square canopy with white braided cord included  
 Canopy dimensions: 4.5" x 4.5", 1.63"  
 Canopy required to house LED driver (3.3" x 1.6" x 1.0")  
 See website for more canopy information  
 6'-0" drop length, field adjustable  
**Medium Base Specifications**  
 Lamping: E26 base, type A lamp, 60 W max  
 Input voltage: 250 V AC Max  
 White (CM-060) low-profile round canopy with clear SVT cord included  
 Canopy dimensions: 5"Ø, 0.3"  
 6'-0" drop length, field adjustable  
 Specifications subject to change



MATERIAL & FINISH OPTIONS

Levis accent part # 06-100-

|                            |    |
|----------------------------|----|
| Shade                      |    |
| frosted polymer (CM-024)   | F  |
| beech wood veneer (CM-019) | B  |
| brushed aluminum (CM-012)  | A  |
| Lamping                    |    |
| 2700 K LED                 | 27 |
| 3500 K LED                 | 35 |
| Driver                     |    |
| 120 V AC input voltage     | P1 |
| ELV dimming only           |    |

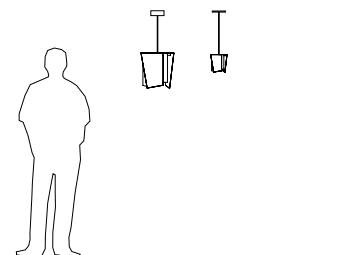

MATERIAL & FINISH OPTIONS

Levis L part # 06-170-

|  |    |
|--|----|
| Shade                                  |    |
| frosted polymer (CM-024)               | F  |
| beech wood veneer (CM-019)             | B  |
| brushed aluminum (CM-012)              | A  |
| Lamping                                |    |
| 2700 K LED                             | 27 |
| 3500 K LED                             | 35 |
| medium base E26 socket                 | MB |
| Driver (LED version only)              |    |
| 120-277 V AC input voltage             | P1 |
| 0-10 V dimming                         |    |
| TRIAC and ELV dimming at 120 V AC only |    |



Levis L, frosted polymer

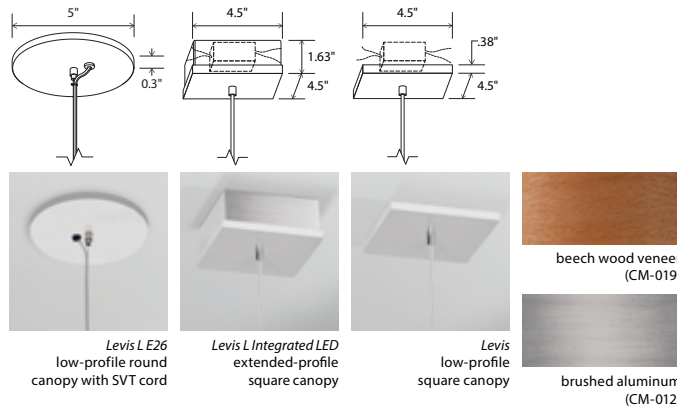

The Levis is simple and clean at first glance: complex upon closer review. The rhythm in the facets gives a dynamic feel from different vantage points, creating a sophistication to its presence.

Nick Sheridan  
Designer

**Salix**  
accent pendant

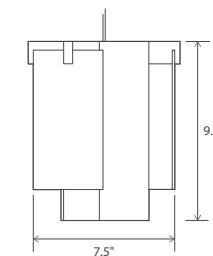

Dimensions: 7.5" x 7.5", 9.0"  
 Materials: solid wood, polymer, aluminum  
 Product weight: 3 lb  
 Light source: integrated LED  
 Light output: 345 Lumens (source)  
 Light color: 2700 K or 3500 K  
 Color accuracy: 90+ CRI  
 Power usage: 3.2 W  
 Dimmable (see driver below)  
 Driver location: must be housed in J-box  
 Driver dimensions: 2" x 1.3" x 1", included  
 Brushed aluminum (CM-006) low-profile square canopy with white braided cord included  
 Canopy dimensions: 4.5" x 4.5", 0.38"  
 Must use included external LED driver (2.25" x 1.5" x 1")  
 Accent pendants can be clustered by using multi-point round canopy or multi-point linear canopy  
 See website for more canopy information  
 6'-0" drop length, field adjustable  
 Suitable for a sloped ceiling  
 Wood grain will vary  
 Specifications subject to change

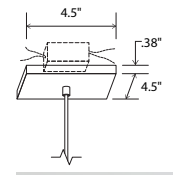

low-profile square canopy



Salix, brushed aluminum

MATERIAL & FINISH OPTIONS

Salix part # 06-120-W A -

|                           |    |
|---------------------------|----|
| Wood Body                 |    |
| walnut (CM-001)           | W  |
| Metal Finish              |    |
| brushed aluminum (CM-012) | A  |
| Lamping                   |    |
| 2700 K LED                | 27 |
| 3500 K LED                | 35 |
| Driver                    |    |
| 120VAC input voltage      | P1 |
| ELV dimming only          |    |

Includes  
frosted polymer (CM-024)



The Salix pendant's materials and proportions are in perfect harmony. The brushed aluminum set against the oiled walnut in this fixture still feels strikingly fresh and beautiful after years of production.

Nick Sheridan  
Designer

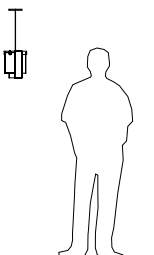





The Plura is a simple, straight forward fixture that is excellently executed. With the Plura it was about resolving the seams and edges and their relationships to one another. The result is a scalable fixture that has a sharp, sophisticated feel.

Nick Sheridan  
Designer

BOBBY BERK INTERIORS AND DESIGN



Plura 36 Pendant, walnut

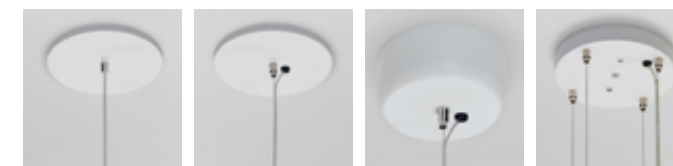
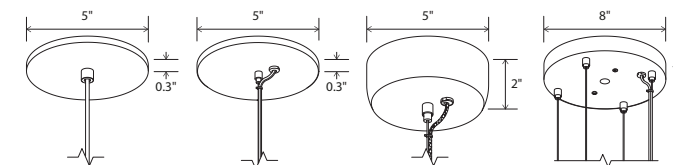

Plura 18 and Plura 24 low-profile round canopy with white SVT  
 Plura 30 GU-24 Base Sockets low-profile round canopy clear SPT with steel cable  
 Plura 30 Integrated LED extended round canopy, clear SPT with steel cable  
 Plura 36 8" round canopy clear SPT with four 1/16" Ø steel cables



Plura pendant

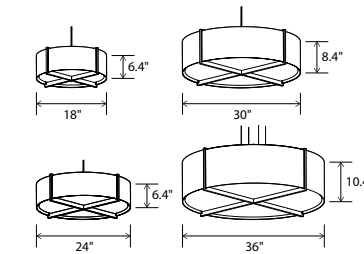

Dimensions:  
 Plura 18: 18" Ø, 6.4"  
 Plura 24: 24" Ø, 6.4"  
 Plura 30: 30" Ø, 8.4"  
 Plura 36: 36" Ø, 10.4"  
 Materials: solid wood, polymer  
 Product weight:  
 Plura 18: 5 lb  
 Plura 24: 6 lb  
 Plura 30: 9 lb  
 Plura 36: 13 lb

Integrated LED Specifications  
 Light output:  
 Plura 18 & 24: 1690 Lumens (source)  
 Plura 30 & 36: 2815 Lumens (source)  
 Light color: 2700 K or 3500 K  
 Color accuracy: 90+ CRI  
 Power usage:  
 Plura 18 & 24: 19.5 W  
 Plura 30 & 36: 32.5 W  
 Dimmable (see driver below)

Plura 18 & 24 driver location: must be housed in J-box  
 Driver dimensions: 3.3" x 1.6" x 1", included  
 Plura 30 & 36 driver location: housed in canopy

GU-24 Base Specifications  
 Light source:  
 Plura 18 & 24: 2x GU-24 base socket  
 Plura 30 & 36: 4x GU-24 base socket  
 Lamping:  
 Plura 18 & 24: 2x GU-24 base, 18 W max each  
 Plura 30 & 36: 4x GU-24 base, 18 W max each  
 Bulbs not included  
 Input voltage: 300 V AC max

96" drop length, field adjustable  
 Suitable for a sloped ceiling  
 Wood grain will vary  
 Specifications subject to change



MATERIAL & FINISH OPTIONS

Plura pendant part # 06-230-

|       |    |
|-------|----|
| Ø:    |    |
| 18" Ø | 18 |
| 24" Ø | 24 |
| 30" Ø | 30 |
| 36" Ø | 36 |

|                              |   |
|------------------------------|---|
| Wood Body                    |   |
| walnut (CM-001)              | W |
| dark stained walnut (CM-002) | D |
| white washed oak (CM-095)    | O |

|                            |   |
|----------------------------|---|
| Shade Material             |   |
| frosted polymer (CM-051)   | F |
| matte black (CM-085)       | B |
| with matte white interior  |   |
| brushed aluminum (CM-012)  | A |
| brushed rose gold (CM-046) | R |
| brushed brass (CM-047)     | G |
| distressed brass (CM-096)  | D |
| gloss white (CM-054)       | W |

|                    |    |
|--------------------|----|
| Lamping            |    |
| 2700 K LED         | 27 |
| 3500 K LED         | 35 |
| GU-24 base sockets | GU |

|  |    |
|--|----|
| Driver (LED version only)              |    |
| 120-277 V AC input voltage             |    |
| 0-10 V dimming                         |    |
| TRIAC and ELV dimming at 120 V AC only | P1 |

Includes  
 frosted polymer (CM-051)

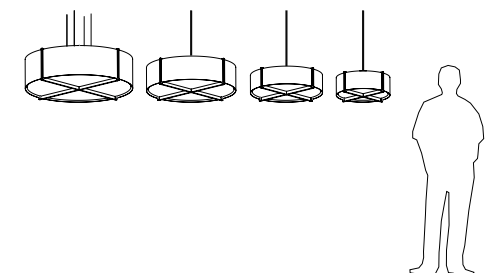





## Flush Mount



Plura Flush Mount



Casia



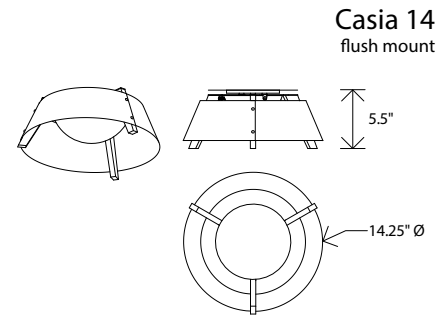

Casia 14  
flush mount



walnut  
(CM-001)

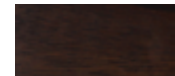

dark stained  
walnut (CM-002)



white washed oak  
(CM-095)



matte black (CM-085)  
with matte white interior



distressed brass  
(CM-009)



gloss white  
(CM-054)

Dimensions: 14.25" Ø, 5.5"  
Product weight: 3 lb  
Light output: minimum 831 Lumens (source)  
See Lamping options below  
Light color: 2700 K or 3500 K  
Color accuracy: 90+ CRI  
Power usage: 10 W  
Dimmable (see power options below)  
Wood grain will vary  
Specifications subject to change  
UL Pending

MATERIAL & FINISH OPTIONS

Casia 14 part # 08-110-14

|  |    |  |
|--|----|--|
| <b>Shade Material</b>                            |    |  |
| matte black (CM-085) with matte white interior   | B  |  |
| distressed brass (CM-009)                        | D  |  |
| gloss white (CM-054)                             | W  |  |
| <b>Wood Body</b>                                 |    |  |
| walnut (CM-001)                                  | W  |  |
| dark stained walnut (CM-002)                     | D  |  |
| white washed oak (CM-095)                        | O  |  |
| <b>Lamping</b>                                   |    |  |
| 2700 K LED - 831 Lumens (source)                 | 27 |  |
| 3500 K LED - 873 Lumens (source)                 | 35 |  |
| <b>Power Option</b>                              |    |  |
| 120-277 V AC input voltage TRIAC and ELV dimming | P1 |  |

Includes: white glass diffuser (CM-109)  
Available soon in a pendant version



Casia 14, white washed oak, gloss white



Casia detail

Casia is a fresh and innovative approach to a flush mount light fixture. Each carefully selected material plays an integral role in the aesthetic design and performance. The wood arms, metal shade, and glass diffuser combine to create a minimalist form well suited for a modern environment or a more traditional space. The 14" version works well in bathrooms, closets, narrow corridors, and smaller kitchens. The 18" and 22" sizes are incredibly dynamic and work well in different environments such as commercial, residential, and hospitality applications.

Casia 18  
flush mount

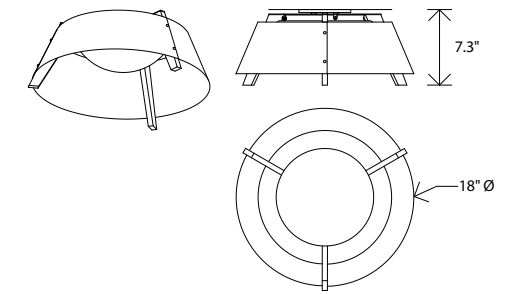

Dimensions: 18" Ø, 7.3"  
Product weight: 4 lb  
Light output: minimum 1310 Lumens (source)  
See Lamping options below  
Light color: 2700 K or 3500 K  
Color accuracy: 90+ CRI  
Power usage: 15 W  
Dimmable (see power options below)  
Wood grain will vary  
Specifications subject to change  
UL Pending

MATERIAL & FINISH OPTIONS

Casia 18 part # 08-110-18

|  |    |  |
|--|----|--|
| <b>Shade Material</b>                            |    |  |
| matte black (CM-085) with matte white interior   | B  |  |
| distressed brass (CM-009)                        | D  |  |
| gloss white (CM-054)                             | W  |  |
| <b>Wood Body</b>                                 |    |  |
| walnut (CM-001)                                  | W  |  |
| dark stained walnut (CM-002)                     | D  |  |
| white washed oak (CM-095)                        | O  |  |
| <b>Lamping</b>                                   |    |  |
| 2700 K LED - 1310 Lumens (source)                | 27 |  |
| 3500 K LED - 1378 Lumens (source)                | 35 |  |
| <b>Power Option</b>                              |    |  |
| 120-277 V AC input voltage TRIAC and ELV dimming | P1 |  |

Includes: white glass diffuser (CM-109)  
Available soon in a pendant version

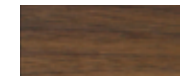

walnut  
(CM-001)

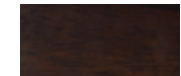

dark stained  
walnut (CM-002)



white washed oak  
(CM-095)



matte black (CM-085)  
with matte white interior



distressed brass  
(CM-009)



gloss white  
(CM-054)



Casia 18, dark stain walnut, matte black with matte white interior

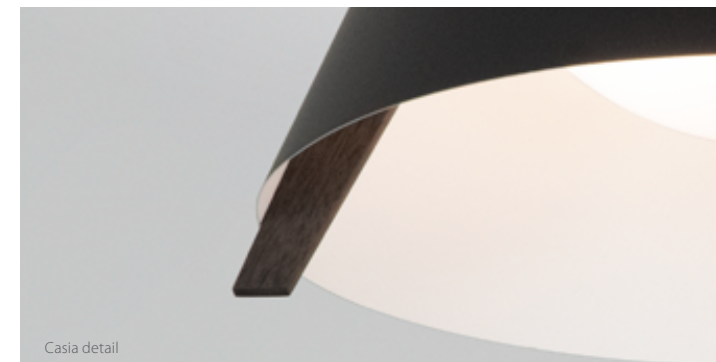

Casia detail

Casia is a fresh and innovative approach to a flush mount light fixture. Each carefully selected material plays an integral role in the aesthetic design and performance. The wood arms, metal shade, and glass diffuser combine to create a minimalist form well suited for a modern environment or a more traditional space. The 14" version works well in bathrooms, closets, narrow corridors, and smaller kitchens. The 18" and 22" sizes are incredibly dynamic and work well in different environments such as commercial, residential, and hospitality applications.

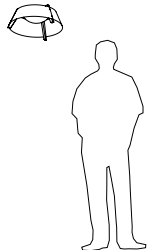
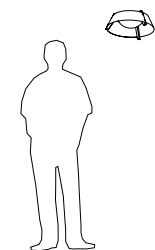





Casia 22, dark stain walnut, distressed brass

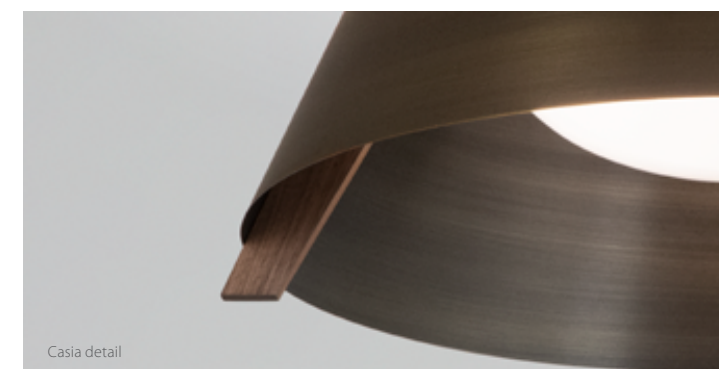

Casia detail

**Casia 22**  
flush mount

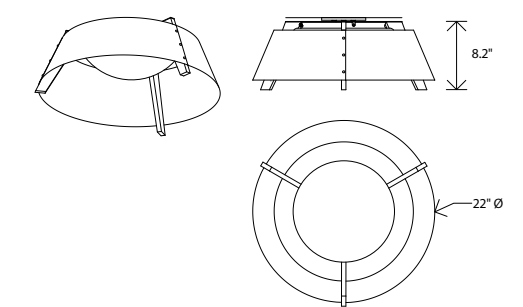

Dimensions: 21.5" Ø, 8.2"  
 Product weight: 5 lb  
 Light output: minimum 1981 Lumens (source)  
 See Lamping options below  
 Light color: 2700 K or 3500 K  
 Color accuracy: 90+ CRI  
 Power usage: 23 W  
 Dimmable (see power options below)  
 Wood grain will vary  
 Specifications subject to change  
 UL Pending

**MATERIAL & FINISH OPTIONS**

Casia 22 part # 08-110-22

|  |    |
|--|----|
| Shade Material                                   |    |
| matte black (CM-085) with matte white interior   | B  |
| distressed brass (CM-009)                        | D  |
| gloss white (CM-054)                             | W  |
| Wood Body  |    |
| walnut (CM-001)                                  | W  |
| dark stained walnut (CM-002)                     | D  |
| white washed oak (CM-095)                        | O  |
| Lamping  |    |
| 2700 K LED - 1981 Lumens (source)                | 27 |
| 3500 K LED - 2083 Lumens (source)                | 35 |
| Power Option                                     |    |
| 120-277 V AC input voltage TRIAC and ELV dimming | P1 |



Includes: white glass diffuser (CM-109)  
 Available soon in a pendant version

*Casia is a fresh and innovative approach to a flush mount light fixture. Each carefully selected material plays an integral role in the aesthetic design and performance. The wood arms, metal shade, and glass diffuser combine to create a minimalist form well suited for a modern environment or a more traditional space. The 14" version works well in bathrooms, closets, narrow corridors, and smaller kitchens. The 18" and 22" sizes are incredibly dynamic and work well in different environments such as commercial, residential, and hospitality applications.*

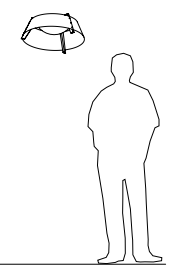





Plura 36 flush mount, walnut

**Plura**  
flush mount

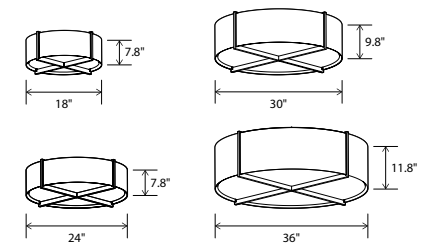

**Dimensions:**  
 Plura 18: 18" Ø, 7.8"  
 Plura 24: 24" Ø, 7.8"  
 Plura 30: 30" Ø, 9.8"  
 Plura 36: 36" Ø, 11.8"  
**Materials:** solid wood, metal, polymer  
**Product weight:**  
 Plura 18: 5 lb  
 Plura 24: 6 lb  
 Plura 30: 9 lb  
 Plura 36: 13 lb

**Integrated LED Specifications**  
**Light output:**  
 Plura 18 & 24: 1690 Lumens (source)  
 Plura 30 & 36: 2815 Lumens (source)  
**Light color:** 2700 K or 3500 K  
**Color accuracy:** 90+ CRI  
**Power usage:**  
 Plura 18 & 24: 19.5 W  
 Plura 30 & 36: 32.5 W  
 Dimmable (see driver below)

**GU-24 Base Specifications**  
**Light source:**  
 Plura 18 & 24: 2x GU-24 base socket  
 Plura 30 & 36: 4x GU-24 base socket  
**Lamping:**  
 Plura 18 & 24: 2x GU-24 base, 18 W max each  
 Plura 30 & 36: 4x GU-24 base, 18 W max each  
**Bulbs not included**  
**Input voltage:** 300 V AC max

Suitable for a sloped ceiling  
 Wood grain will vary  
 Specifications subject to change

 Emergency backup option available upon request  
 Also available in a pendant version

**MATERIAL & FINISH OPTIONS**

Plura flush mount part # 08-100-

|       |    |  |
|-------|----|--|
| Ø:    |    |  |
| 18" Ø | 18 |  |
| 24" Ø | 24 |  |
| 30" Ø | 30 |  |
| 36" Ø | 36 |  |

|                              |   |  |
|------------------------------|---|--|
| <b>Wood Body</b>             |   |  |
| walnut (CM-001)              | W |  |
| dark stained walnut (CM-002) | D |  |
| white washed oak (CM-095)    | O |  |

|                            |   |  |
|----------------------------|---|--|
| <b>Shade Material</b>      |   |  |
| frosted polymer (CM-051)   | F |  |
| matte black (CM-085)       | B |  |
| with matte white interior  |   |  |
| brushed aluminum (CM-012)  | A |  |
| brushed rose gold (CM-046) | R |  |
| brushed brass (CM-047)     | G |  |
| distressed brass (CM-096)  | D |  |
| gloss white (CM-054)       | W |  |

|                    |    |  |
|--------------------|----|--|
| <b>Lamping</b>     |    |  |
| 2700 K LED         | 27 |  |
| 3500 K LED         | 35 |  |
| GU-24 base sockets | GU |  |

|  |    |  |
|--|----|--|
| <b>Driver (LED version only)</b>       |    |  |
| 120-277 V AC input voltage             |    |  |
| 0-10 V dimming                         |    |  |
| TRIAC and ELV dimming at 120 V AC only | P1 |  |

**Includes**  
 frosted polymer (CM-051)

|   |  |   |  |   |   |   |
|---|--|---|--|---|---|---|
| <br>white washed oak (CM-095)    | <br>frosted polymer (CM-051)  | <br>brushed rose gold (CM-046) | <br>walnut (CM-001) | <br>matte black (CM-085) with matte white interior | <br>brushed brass (CM-047) | <br>gloss white (CM-054) |
| <br>dark stained walnut (CM-002) | <br>brushed aluminum (CM-012) | <br>distressed brass (CM-096)  |  |   |   |   |

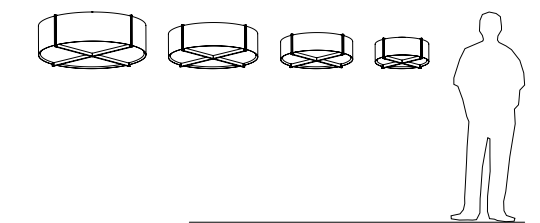



### Outdoor Sconces



Tersus Outdoor



Calx Outdoor



Ansa Outdoor



Acuo Outdoor



**Tersus Outdoor**  
sconce

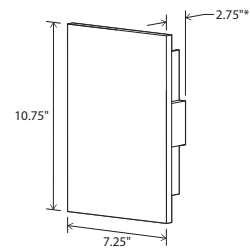

Dimensions: 10.75" x 7.25" x 2.75" (3.5" concrete)  
 Product weight: 4 lb (9 lb concrete)  
 Light source: integrated LED  
 Light output: see options below  
 Light color options: 2700 K, 3000K, 3500 K, or 4000 K  
 Color accuracy: 90+ CRI  
 Power usage: 13 W  
 Dimmable (see options below)  
 UL listed for wet locations, suitable for use indoor and outdoors  
 Antique bronze and concrete finishes will vary  
 Antique bronze is a living finish and will change over time depending on environmental conditions  
 Custom backlit address or room numbers available  
 Specifications subject to change  
 J-box centered behind fixture



**MATERIAL & FINISH OPTIONS**

Tersus part # 03-242- -

| Shade Material                                |    |
|---|----|
| white concrete (CM-104)                       | W  |
| black concrete (CM-105)                       | B  |
| marine grade brushed stainless steel (CM-102) | S  |
| antique bronze (CM-103)                       | R  |
| textured black powdercoat (CM-099)            | K  |
| textured white powdercoat (CM-100)            | Y  |
| matte grey powdercoat (CM-101)                | G  |
| Lamping                                       |    |
| 2700 K LED                                    | 27 |
| 3000 K LED                                    | 30 |
| 3500 K LED                                    | 35 |
| 4000 K LED                                    | 40 |
| Light Distribution and Driver Options         |    |
| Uplight & Downlight                           |    |
| 120-277 V AC input voltage                    |    |
| Standard output - 1130 Lumens (source)        | P1 |
| 0-10 V dimming                                |    |
| TRIAC and ELV dimming at 120 V AC only        |    |
| Reduced output - 540 Lumens (source)          | PR |
| Nondimmable                                   |    |
| Downlight Only - Dark Sky Compliant           |    |
| 120-277 V AC input voltage                    |    |
| Standard output - 1130 Lumens (source)        | D1 |
| 0-10 V dimming                                |    |
| TRIAC and ELV dimming at 120 V AC only        |    |
| Reduced output - 540 Lumens (source)          | DR |
| Nondimmable                                   |    |

Includes marine grade brushed stainless steel (CM-102) (except for Antique Bronze version)  
 2700 K & 3000 K downlight only options are dark sky compliant



Cerno's Tersus Outdoor sconce is an existing design that we modified to withstand the elements. The materials and components were meticulously designed and engineered to comply and pass UL's wet location requirements.

Nick Sheridan  
Designer

**Calx Outdoor**  
sconce

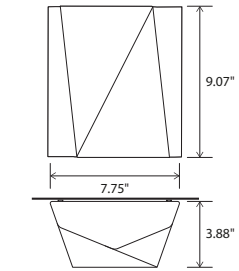

Dimensions: 9.07" x 7.75" x 3.88"  
 Product weight: 2 lb  
 Light source: integrated LED  
 Light output: see options below  
 Light color options: 2700 K, 3000K, 3500 K, or 4000 K  
 Color accuracy: 90+ CRI  
 Power usage: 13 W  
 Dimmable (see options below)  
 UL listed for wet locations, suitable for use indoor and outdoors  
 Antique bronze finishes will vary  
 Antique bronze is a living finish and will change over time depending on environmental conditions  
 Custom backlit address or room numbers available  
 Specifications subject to change  
 J-box centered behind fixture



**MATERIAL & FINISH OPTIONS**

Calx Outdoor Sconce part # 03-244 -

| Shade Material                                |    |
|---|----|
| marine grade brushed stainless steel (CM-102) | S  |
| antique bronze (CM-103)                       | R  |
| textured black powdercoat (CM-099)            | K  |
| textured white powdercoat (CM-100)            | Y  |
| matte grey powdercoat (CM-101)                | G  |
| Lamping                                       |    |
| 2700 K LED                                    | 27 |
| 3000 K LED                                    | 30 |
| 3500 K LED                                    | 35 |
| 4000 K LED                                    | 40 |
| Light Distribution and Driver Options         |    |
| Uplight & Downlight                           |    |
| 120-277 V AC input voltage                    |    |
| Standard output - 1130 Lumens (source)        | P1 |
| 0-10 V dimming                                |    |
| TRIAC and ELV dimming at 120 V AC only        |    |
| Reduced output - 540 Lumens (source)          | PR |
| Nondimmable                                   |    |
| Downlight Only - Dark Sky Compliant           |    |
| 120-277 V AC input voltage                    |    |
| Standard output - 1130 Lumens (source)        | D1 |
| 0-10 V dimming                                |    |
| TRIAC and ELV dimming at 120 V AC only        |    |
| Reduced output - 540 Lumens (source)          | DR |
| Nondimmable                                   |    |

2700 K & 3000 K downlight only options are dark sky compliant

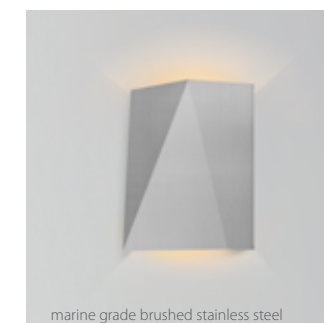
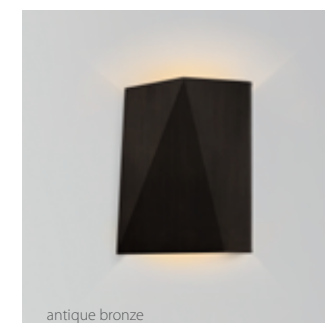

Cerno's Calx Outdoor sconce is an existing design that we modified to withstand the elements. The materials and components were meticulously designed and engineered to comply and pass UL's wet location requirements.

Nick Sheridan  
Designer

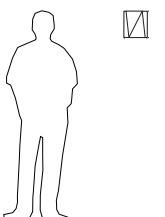
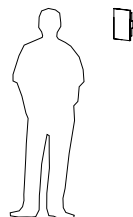



**Ansa Outdoor**  
sconce

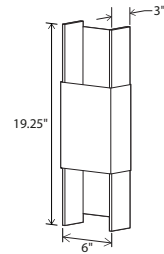

Dimensions: 19.25" x 6" x 3"  
 Product weight: 5 lb  
 Light source: integrated LED  
 Light output: see options below  
 Light color options: 2700 K, 3000K, 3500 K, or 4000 K  
 Color accuracy: 90+ CRI  
 Power usage: 13 W  
 Dimmable (see options below)  
 UL listed for wet locations, suitable for use indoor and outdoors  
 Antique bronze finishes will vary  
 Antique bronze is a living finish and will change over time depending on environmental conditions  
 Custom backlit address or room numbers available  
 Specifications subject to change  
 J-box centered behind fixture



**MATERIAL & FINISH OPTIONS**

Ansa Outdoor part # 03-243-

|   |    |
|---|----|
| <b>Shade Material</b>                         |    |
| marine grade brushed stainless steel (CM-102) | S  |
| antique bronze (CM-103)                       | R  |
| textured black powdercoat (CM-099)            | K  |
| textured white powdercoat (CM-100)            | Y  |
| matte grey powdercoat (CM-101)                | G  |
| <b>Lamping</b>                                |    |
| 2700 K LED                                    | 27 |
| 3000 K LED                                    | 30 |
| 3500 K LED                                    | 35 |
| 4000 K LED                                    | 40 |
| <b>Light Distribution and Driver Options</b>  |    |
| <b>Uplight &amp; Downlight</b>                |    |
| 120-277 V AC input voltage                    |    |
| Standard output - 1130 Lumens (source)        | P1 |
| 0-10 V dimming                                |    |
| TRIAC and ELV dimming at 120 V AC only        |    |
| Reduced output - 540 Lumens (source)          |    |
| Nondimmable                                   | PR |

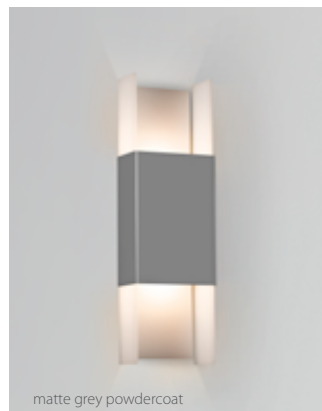

Cerno's Ansa Outdoor sconce is an existing design that we modified to withstand the elements. The materials and components were meticulously designed and engineered to comply and pass UL's wet location requirements.

Nick Sheridan  
Designer

**Acuo Outdoor**  
sconce

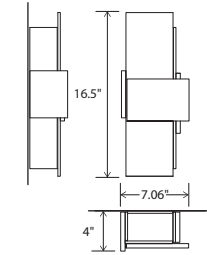

Dimensions: 16.5" x 7.06" x 4"  
 Product weight: 6 lb  
 Light source: integrated LED  
 Light output: see options below  
 Light color options: 2700 K, 3000K, 3500 K, or 4000 K  
 Color accuracy: 90+ CRI  
 Power usage: 13 W  
 Dimmable (see options below)  
 UL listed for wet locations, suitable for use indoor and outdoors  
 Specifications subject to change  
 J-box centered behind fixture



**MATERIAL & FINISH OPTIONS**

Acuo Outdoor part # 03-241-

|  |    |
|--|----|
| <b>Shade Material</b>                        |    |
| textured black powdercoat (CM-099)           | K  |
| textured white powdercoat (CM-100)           | Y  |
| matte grey powdercoat (CM-101)               | G  |
| <b>Lamping</b>                               |    |
| 2700 K LED                                   | 27 |
| 3000 K LED                                   | 30 |
| 3500 K LED                                   | 35 |
| 4000 K LED                                   | 40 |
| <b>Light Distribution and Driver Options</b> |    |
| <b>Uplight &amp; Downlight</b>               |    |
| 120-277 V AC input voltage                   |    |
| Standard output - 1130 Lumens (source)       | P1 |
| 0-10 V dimming                               |    |
| TRIAC and ELV dimming at 120 V AC only       |    |
| Reduced output - 540 Lumens (source)         |    |
| Nondimmable                                  | PR |
| <b>Includes</b>                              |    |
| frosted polymer (CM-024)                     |    |

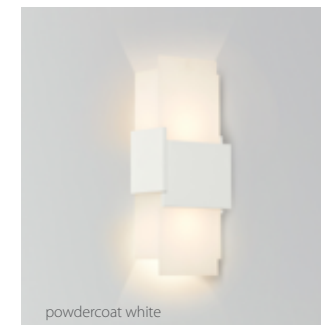
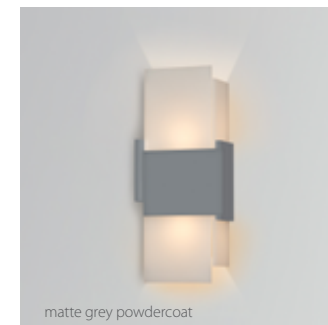

Cerno's Acuo Outdoor sconce is an existing design that we modified to withstand the elements. The materials and components were meticulously designed and engineered to comply and pass UL's wet location requirements.

Nick Sheridan  
Designer



marine grade brushed stainless steel (CM-102)



antique bronze (CM-103)



textured black powdercoat (CM-099)



textured white powdercoat (CM-100)



matte grey powdercoat (CM-101)



textured black powdercoat (CM-099)



textured white powdercoat (CM-100)



matte grey powdercoat (CM-101)

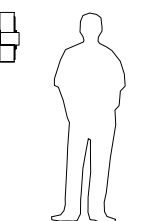
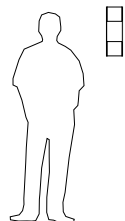





Allavo, walnut

### Vanity Lighting



Allavo



Merus



**Allavo**  
vanity sconce

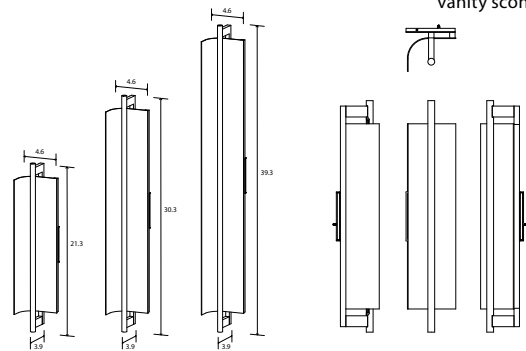

Allavo 22 dimensions: 21.3" x 4.6" x 3.9"  
 Allavo 31 dimensions: 30.3" x 4.6" x 3.9"  
 Allavo 40 dimensions: 39.3" x 4.6" x 3.9"

Allavo 22/31 weight: 2 lb  
 Allavo 40 weight: 3 lb

Light source: integrated LED

Allavo 22 light output: 780 Lumens (source)

Allavo 31 light output: 1170 Lumens (source)

Allavo 40 light output: 1560 Lumens (source)

Light color options: 2700 K, 3000K, 3500 K, or 4000 K

Color accuracy: 90+ CRI

Allavo 22 power usage: 11 W

Allavo 31 power usage: 16 W

Allavo 40 power usage: 21 W

Dimmable (see options below)

Specifications subject to change

Driver location: must be housed in J-box

Allavo 22 driver dimensions: 2.63" x 1.25" x 0.8", included

Allavo 31 driver dimensions: 3.0" x 1.0" x 1.5", included

Allavo 40 driver dimensions: 2.82" x 2.5" x 1.2", included

The Allavo can be oriented as a vertical sconce or horizontal sconce. When oriented vertically, a right or left orientation can be achieved by flipping the fixture vertically.

be achieved by flipping the fixture vertically.



walnut (CM-001)

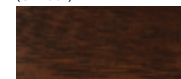

dark stain walnut (CM-002)

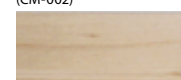

white washed oak (CM-095)



matte black (CM-085) exterior with matte white reflector



matte white (CM-107) exterior with matte white reflector

**MATERIAL & FINISH OPTIONS**

Allavo part # 03-250-

**Size**

22"

31"

40"

**Metal Finish**

matte black (CM-085) exterior with matte white reflector

matte white (CM-107) exterior with matte white reflector

with matte white reflector

with matte white reflector

**Wood Finish**

walnut (CM-001)

dark stained walnut (CM-002)

white washed oak (CM-095)

**Lamping**

2700 K LED

3000 K LED

3500 K LED

4000 K LED

**Driver**

120 V AC input voltage

TRIAC, ELV & 0-10 V dimming

277 V AC input voltage

TRIAC, ELV & 0-10 V dimming

**Includes**

brushed aluminum (CM-006)

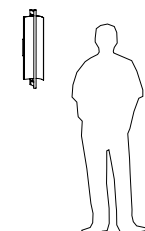
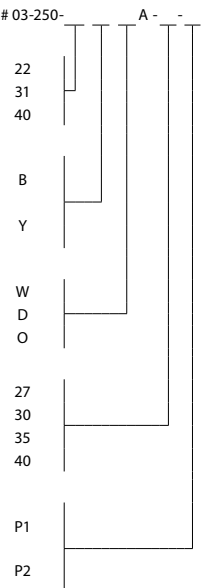

matte white, walnut



matte white



Cerno's product development team prioritized the utility of the Allavo vanity, while not ignoring the importance of the aesthetic. Drawing from our experience with product photography, we knew that a large diffuse light source was the key to achieving our goal. The novel design uses indirect lighting that bounces off a curved metal surface. Cerno's signature use of wood is integrated seamlessly into a design we believe harmonizes usefulness and beauty.



matte white, white washed oak



walnut



Merus is a quintessential Cerno design. Clean, modern lines paired with a novel indirect light source compose a form that balances beauty and usefulness. Our team used Cerno's signature material palette of wood and metal.

**Merus**  
sconce

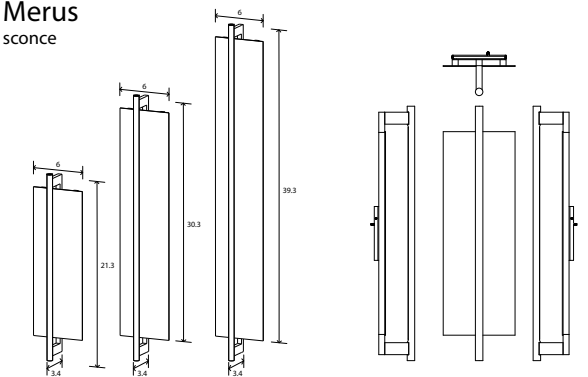

Merus 22 dimensions: 21.3" x 6" x 3.4"

Merus 31 dimensions: 30.3" x 6" x 3.4"

Merus 40 dimensions: 39.3" x 6" x 3.4"

Merus 22/31 weight: 2 lb

Merus 40 weight: 3 lb

Light source: integrated LED

Merus 22 light output: 780 Lumens (source)

Merus 31 light output: 1170 Lumens (source)

Merus 40 light output: 1560 Lumens (source)

Light color options: 2700 K, 3000 K, 3500 K, or 4000 K

Color accuracy: 90+ CRI

Merus 22 power usage: 11 W

Merus 31 power usage: 16 W

Merus 40 power usage: 21 W

Dimmable (see options below)

Specifications subject to change

Driver location: must be housed in J-box

Merus 22 driver dimensions: 2.63" x 1.25" x 0.8", included

Merus 31 driver dimensions: 3.0" x 1.0" x 1.5", included

Merus 40 driver dimensions: 2.82" x 2.5" x 1.2", included

The Merus can be oriented as a vertical sconce or horizontal sconce. When oriented vertically, a right or left orientation can be achieved by flipping the fixture vertically.

be achieved by flipping the fixture vertically.



walnut (CM-001)

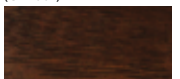

dark stain walnut (CM-002)



white washed oak (CM-095)

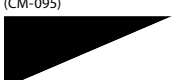

matte black (CM-085) exterior with matte white reflector



**MATERIAL & FINISH OPTIONS**

Merus part # 03-251-

**Size**

22"

31"

40"

**Wood Finish**

walnut (CM-001)

dark stained walnut (CM-002)

white washed oak (CM-095)

**Lamping**

2700 K LED

3000 K LED

3500 K LED

4000 K LED

**Driver**

120 V AC input voltage

TRIAC, ELV & 0-10 V dimming

277 V AC input voltage

TRIAC, ELV & 0-10 V dimming

**Includes**

matte black (CM-085) exterior with matte white reflector

brushed aluminum (CM-006)

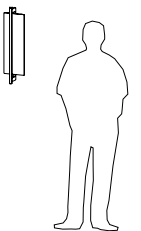
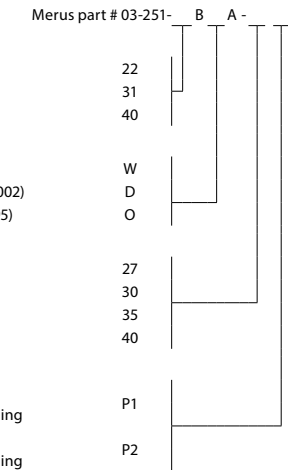



## Sconces

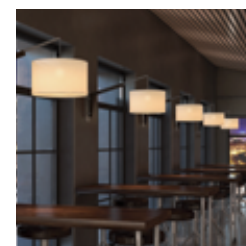

Talea



Talea



Tersus



Sedo



Via



Calx Sconce



Ansa



Ansa

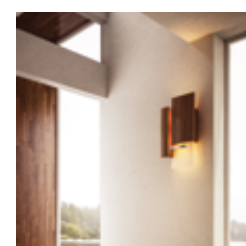

Vesper



Vesper



Fortis



Claudo Sconce



Acuo



Acuo



Cubo



Libri

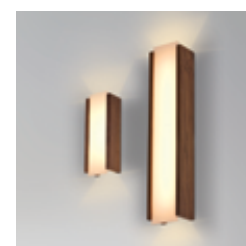

Capiro family



Oris



Tersus Outdoor



Levo





Talea, burlap shade, walnut body, textured black powdercoat

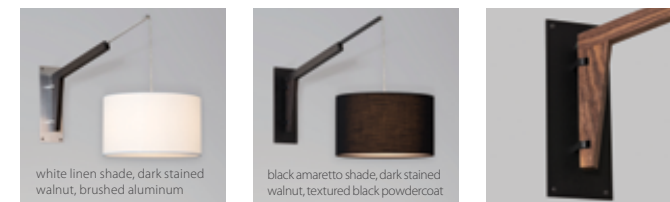

white linen shade, dark stained walnut, brushed aluminum

black amaretto shade, dark stained walnut, textured black powdercoat

The adaptive and interactive features of the Talea introduced exciting challenges to the design process. I believe we found a balance that allows this fixture to thrive in a range of spaces and different applications. I am really pleased with how the design language turned out, specifically how the expressive hinge suggests its ability to swing, and how the wood to metal arm detailing suggests the arm can telescope. It's a beautiful mixture of utility and elegance.

Nick Sheridan  
Designer

Talea, white linen shade, dark stained walnut body, brushed aluminum,

**Talea**  
articulate wall sconce

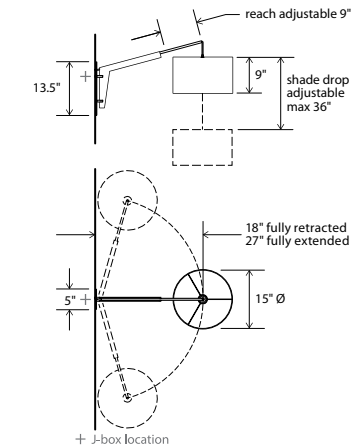

Dimensions: 18.38" x 5" x 34.75", 15" Ø shade  
Materials: solid wood, metal  
Product weight: 5 lb  
Light source: medium base E26 socket  
Lamping: E26 base, type A lamp, 60 W max  
Bulb not included  
Input voltage: 250 V AC max  
Clear SVT-3 cord included  
Top and bottom diffusers included (CM-051)  
Wood grain will vary  
Specifications subject to change  
Patent No.: US D846,180 S



**SWING ARM LENGTH**

Arm length (from the wall to center of shade) can be adjusted between 18" and 27"

**DROP LENGTH**

Max drop length from tip of extended arm to top of shade is 36"

**SWING ARM ROTATION**

Adjustable resistance in pivot hinge

**MATERIAL & FINISH OPTIONS**

Talea part # 03-210-

**Metal Finish**

brushed aluminum (CM-006) A  
textured black powdercoat (CM-049) B

**Wood Body**

walnut (CM-001) W  
dark stained walnut (CM-002) D

**Fabric Shade**

burlap (CM-017) N  
white linen (CM-016) L  
black amaretto (CM-018) A

**Includes**

frosted polymer diffuser (CM-051)

For additional products that utilize the swing arm bracket, please see our Motus Swing Arm Bracket on page 78



brushed aluminum (CM-006)



textured black (CM-049)

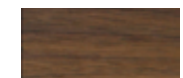

walnut (CM-001)

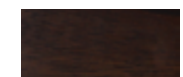

dark stained walnut (CM-002)

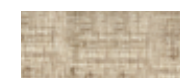

burlap (CM-017)



white linen (CM-016)



black amaretto (CM-018)

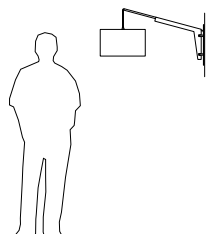



**Via**  
sconce or ceiling flush mount

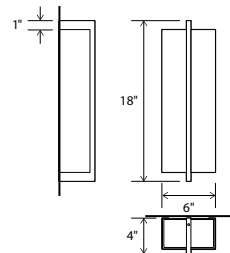

Dimensions: 18" x 6" x 4"  
Materials: solid wood, polymer  
Product weight: 2 lb

**Integral LED Specifications**

Light output: 500 Lumens (source)  
Light color: 2700 K or 3500 K  
Color accuracy: 90+ CRI  
Power usage: 7 W  
Dimmable (see driver below)  
Input voltage: 24 V DC (driver included)  
Driver location: must be housed in J-box  
Driver dimensions: 3" x 1.5" x 1"  
Mounting: ceiling or wall

**Candelabra Base Specifications**

Lamping: 2x candelabra E12 base sockets,  
10 W max each (bulbs not included)  
Select bulbs can achieve over 500 lumens each  
Input voltage: 120 V AC max  
Mounting: wall only



**MATERIAL & FINISH OPTIONS**

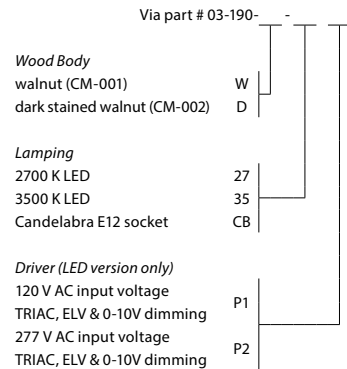

Includes  
frosted polymer (CM-051)

Inquire about other input voltages  
Emergency backup option available upon request

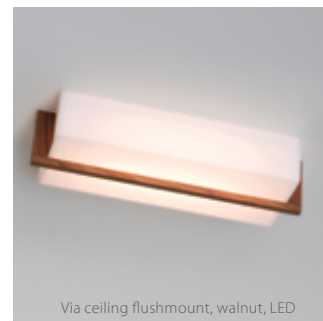

*The Via has an understated geometry with sophisticated detailing and proportion. The substantial glowing volume of the Via is punctuated by a thin plane of rich American walnut striking a balance and harmony.*

Nick Sheridan  
Designer

**Calx**  
sconce

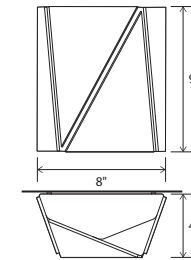

Dimensions: 8" x 9" x 4"  
Materials: wood, metal  
Product weight: 2 lb  
Light source: integrated LED  
Light output: 1130 Lumens (source)  
Light color: 2700 K or 3500 K  
Color accuracy: 90+ CRI  
Power usage: 13 W  
Dimmable (see driver below)  
Wood grain will vary  
Specifications subject to change



**MATERIAL & FINISH OPTIONS**

Calx sconce part # 03-138-

**Metal Finish**

brushed aluminum (CM-012) A  
brushed rose gold (CM-046) G  
brushed brass (CM-047) R

**Wood Finish**

walnut (CM-055) W  
dark stained walnut (CM-056) D

**Lamping**

2700 K LED 27  
3500 K LED 35

**Driver**

120-277 V AC input voltage  
0-10 V dimming  
TRIAC and ELV dimming at  
120 V AC only P1

Calx pendants also available. [Click here.](#)

*Inspired by the Calx pendant, the materials and method inform the design greatly. While the Calx sconce is clean and simple, it also offers a beautiful texture and subtle complexity to a wall.*

Nick Sheridan  
Designer

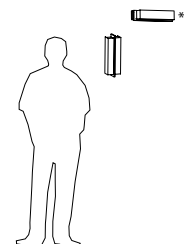

\* LED version only





Penna 16 / Penna 40 / Penna 64  
sconce

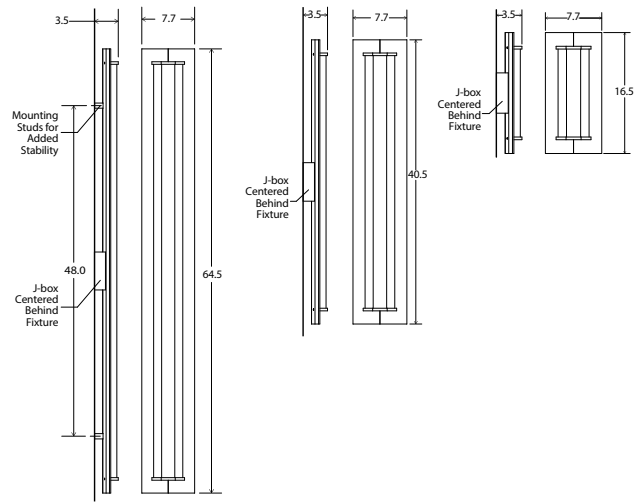

Penna 16 dimensions: 16.5" x 7.7" x 3.5"  
 Penna 40 dimensions: 40.5" x 7.7" x 3.5"  
 Penna 64 dimensions: 64.5" x 7.7" x 3.5"  
 Penna 16 weight: 4 lb  
 Penna 40 weight: 6 lb  
 Penna 64 weight: 9 lb  
 Light source: integrated LED  
 Penna 16 light output: 510 Lumens (source)  
 Penna 40 light output: 1530 Lumens (source)  
 Penna 64 light output: 2550 Lumens (source)  
 Light color: 2700 K or 3500 K  
 Color accuracy: 90+ CRI  
 Penna 16 power usage: 7 W  
 Penna 40 power usage: 21 W  
 Penna 64 power usage: 35 W  
 Dimmable (see driver below)  
 Wood grain will vary  
 Specifications subject to change

MATERIAL & FINISH OPTIONS

|                              |    |    |
|------------------------------|----|----|
| Penna sconce part # 03-220-  |    | B  |
| Penna 16                     | 16 |    |
| Penna 40                     | 40 |    |
| Penna 64                     | 64 |    |
| <b>Metal Finish</b>          |    | R  |
| brushed brass (CM-008)       |    | D  |
| distressed brass (CM-009)    |    |    |
| <b>Wood Body</b>             |    | W  |
| walnut (CM-001)              |    | D  |
| dark stained walnut (CM-002) |    |    |
| <b>Lamping</b>               |    | 27 |
| 2700 K LED                   |    | 35 |
| 3500 K LED                   |    |    |
| <b>Driver</b>                |    | P1 |
| 120 V AC input voltage       |    | P2 |
| TRIAC, ELV & 0-10 V dimming  |    |    |
| 277 V AC input voltage       |    |    |
| TRIAC, ELV & 0-10 V dimming  |    |    |
| Includes                     |    |    |
| frosted polymer (CM-057)     |    |    |



On our Cerno journey, we continue to evolve as designers and craftsmen. The Penna is a celebration of us drawing and reflecting on our last ten years. This design is an embodiment of all the lessons that we have learned from designing and building thousands of lights. This fixture balances utility and sophisticated beauty well. The walnut, brass, and leather work in concert to compose a modern form with materials that have been used for thousands of years.

Nick Sheridan  
Designer



Vesper  
sconce

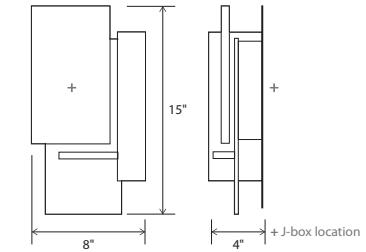

Dimensions: 15" x 8" x 4"  
 Materials: solid wood, polymer, aluminum  
 Product weight: 4 lbs  
 Light source: integrated LED  
 Light output: 1130 Lumens (source)  
 Light color: 2700 K or 3500 K  
 Color accuracy: 90+ CRI  
 LED power consumption: 13W  
 Dimmable (see driver below)  
 ADA compliant hotel room signage with tactile numbering and corresponding braille available  
 Wood grain will vary  
 Specifications subject to change



MATERIAL & FINISH OPTIONS

|  |  |    |
|--|--|----|
| Vesper part # 03-132-                  |  | -  |
| <b>Wood Body</b>                       |  | W  |
| walnut (CM-001)                        |  | D  |
| dark stained walnut (CM-002)           |  |    |
| <b>Lamping</b>                         |  | 27 |
| 2700 K LED                             |  | 35 |
| 3500 K LED                             |  |    |
| <b>Driver</b>                          |  | P1 |
| 120-277 V AC input voltage             |  |    |
| 0-10V dimming                          |  |    |
| TRIAC and ELV dimming at 120 V AC only |  |    |
| Includes                               |  |    |
| frosted polymer (CM-024)               |  |    |
| brushed aluminum (CM-006)              |  |    |

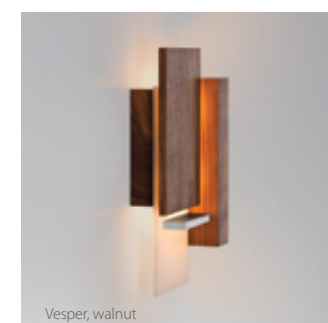
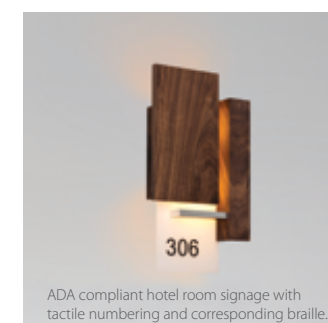

The Vesper is a very simple geometric sculpture composed of brushed aluminum, American black walnut, and white polymer. The light not only washes up and down the wall but also filters out through the composition, exhibiting the fixture's depth in three dimensions.

Nick Sheridan  
Designer



Acuo  
sconce

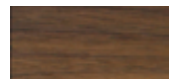
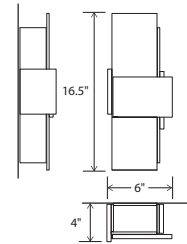

walnut  
(CM-001)

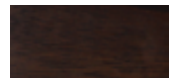

dark stained walnut  
(CM-002)



brushed aluminum  
(CM-006)

Dimensions: 16.5" x 6" x 4"  
 Materials: solid wood, polymer, aluminum  
 Product weight:  
 3 lb (CM-001/CM-002)  
 5 lb (CM-006)  
**Integrated LED Specifications**  
 Light output: 1130 Lumens (source)  
 Light color: 2700 K or 3500 K  
 Color accuracy: 90+ CRI  
 Power usage: 13 W  
 Dimmable (see driver below)

**GU-24 Base Specifications**  
 Lamping: 2x GU-24 base sockets, 18 W max each  
 Input voltage: 300 V AC max

ADA compliant hotel room signage with tactile numbering and corresponding braille available

Wood grain will vary  
 Specifications subject to change



MATERIAL & FINISH OPTIONS

Acuo part # 03-130-

Body

walnut (CM-001)  
 dark stained walnut (CM-002)  
 brushed aluminum (CM-006)

Lamping

2700 K LED  
 3500 K LED  
 GU-24 base sockets

Driver (LED version only)

120-277 V AC input voltage  
 0-10 V dimming  
 TRIAC and ELV dimming at 120 V AC only

Includes

frosted polymer (CM-024)

J-box centered behind wood/aluminum body



Acuo, walnut



Acuo, walnut



Acuo, brushed aluminum

*It's a 3 sided box, which has been carefully deconstructed to a sculptural state. The careful composition of overlap and void create interest and complexity to a very straightforward, well-functioning wall sconce. The tectonic disconnection in form allows you to witness the solid American black walnut's grain as it travels through each solid block.*

Nick Sheridan  
 Designer

Emergency backup option available upon request, requires oversized J-box.



Acuo, walnut

SARAH GALLOP INTERIOR DESIGN PHOTO BY PAUL GRDINA



**Capio S**  
sconce

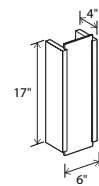

Dimensions: 17" x 6" x 4"  
 Materials: solid wood, polymer  
 Product weight: 4 lb  
 Light source: integrated LED  
 Light output: 500 Lumens (source)  
 Light color: 2700 K or 3500 K  
 Color accuracy: 90+ CRI  
 Power usage: 7 W  
 Dimmable (see driver below)  
 Input voltage: 24 V DC (driver included)  
 Driver location: must be housed in J-box  
 Driver dimensions: 2.6" x 1.3" x 0.8" ADA compliant hotel room signage with tactile numbering and corresponding braille available  
 Wood grain will vary  
 Specifications subject to change



**Capio L**  
sconce

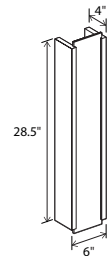

Dimensions: 28.5" x 6" x 4"  
 Materials: solid wood, polymer  
 Product weight: 7 lb  
 Light source: integrated LED  
 Light output: 1000 Lumens (source)  
 Light color: 2700 K or 3500 K  
 Color accuracy: 90+ CRI  
 Power usage: 14 W  
 Dimmable (see driver below)  
 Input voltage: 24 V DC (driver included)  
 Driver location: must be housed in J-box  
 Driver dimensions: 3" x 1.5" x 1" ADA compliant hotel room signage with tactile numbering and corresponding braille available  
 Wood grain will vary  
 Specifications subject to change



MATERIAL & FINISH OPTIONS

Capio S part # 03-180-S

| Wood Body                    |    |
|------------------------------|----|
| walnut (CM-001)              | W  |
| dark stained walnut (CM-002) | D  |
| maple (CM-005)               | M  |
| Lamping                      |    |
| 2700 K LED                   | 27 |
| 3500 K LED                   | 35 |
| Driver                       |    |
| 120 V AC input voltage       | P1 |
| TRIAC, ELV & 0-10 V dimming  |    |
| 277 V AC input voltage       | P2 |
| TRIAC, ELV & 0-10 V dimming  |    |

Includes  
 frosted polymer (CM-024)

MATERIAL & FINISH OPTIONS

Capio L part # 03-180-L

| Wood Body                    |    |
|------------------------------|----|
| walnut (CM-001)              | W  |
| dark stained walnut (CM-002) | D  |
| maple (CM-005)               | M  |
| Lamping                      |    |
| 2700 K LED                   | 27 |
| 3500 K LED                   | 35 |
| Driver                       |    |
| 120 V AC input voltage       | P1 |
| TRIAC, ELV & 0-10 V dimming  |    |
| 277 V AC input voltage       | P2 |
| TRIAC, ELV & 0-10 V dimming  |    |

Includes  
 frosted polymer (CM-024)



Capio S, Capio L, walnut

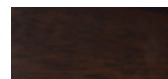

dark stained walnut (CM-002)

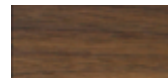

walnut (CM-001)



maple (CM-005)



Capio L, maple Capio L, walnut

The Capio is an exercise in restraint and efficiency consisting of just two solid wood sides that capture a single light diffusing lens. The clean and simple design allows for horizontal or vertical mounting as well as compelling compositions when used in multiples.

Nick Sheridan  
 Designer

Emergency backup option available upon request, requires oversized J-box.



Oris, walnut



Oris, walnut

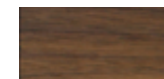

walnut (CM-001)

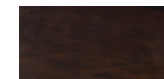

dark stained walnut (CM-002)

The Oris has a strong and commanding presence with its highly architectonic form. The thick solid stock walnut and solid aluminum central fin give the Oris a feeling of permanence and integration into the surrounding architecture. The simple asymmetrical composition adds an understated complexity, as well as excellent illumination, to any wall.

Nick Sheridan  
 Designer

Emergency backup option available upon request, requires oversized J-box.

**Oris**  
sconce

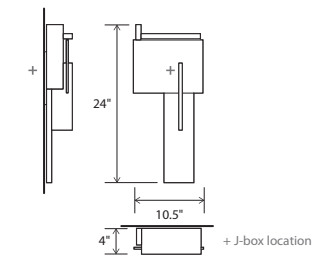

Dimensions: 24" x 10.5" x 4"  
 Materials: solid wood, polymer, aluminum  
 Product weight: 6 lbs  
 Light source: integrated LED  
 Light output: 1130 Lumens (source)  
 Light color: 2700 K or 3500 K  
 Color accuracy: 90+ CRI  
 LED power consumption: 13W  
 Dimmable (see driver below)  
 ADA compliant hotel room signage with tactile numbering and corresponding braille available  
 Wood grain will vary  
 Specifications subject to change



MATERIAL & FINISH OPTIONS

Oris part # 03-140-

| Metal Finish                           |    |
|--|----|
| brushed aluminum (CM-006)              | A  |
| Wood Body                              |    |
| walnut (CM-001)                        | W  |
| dark stained walnut (CM-002)           | D  |
| Lamping                                |    |
| 2700 K LED                             | 27 |
| 3500 K LED                             | 35 |
| Driver                                 |    |
| 120-277 V AC input voltage             | P1 |
| 0-10V dimming                          |    |
| TRIAC and ELV dimming at 120 V AC only |    |

Includes  
 frosted polymer (CM-024)

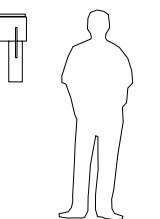
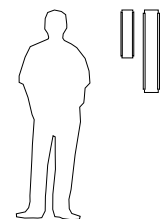







**Tersus**  
sconce

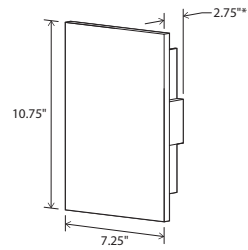

Dimensions: 10.75" x 7.25" x 2.75" (\*3.13" marble)  
 Materials: solid wood, polymer, metal option, stone option  
 Product weight: 2 lb (5 lb marble)  
 Light source: integrated LED  
 Light output: 1130 Lumens (source)  
 Light color: 2700 K or 3500 K  
 Color accuracy: 90+ CRI  
 Power usage: 13 W  
 Dimmable (see driver below)  
 Wood grain and stone will vary  
 Specifications subject to change



**MATERIAL & FINISH OPTIONS**

Tersus part # 03-136-

|  |    |
|--|----|
| <b>Wood Body</b>                       | W  |
| walnut (CM-001)                        | W  |
| dark stained walnut (CM-002)           | D  |
| maple (CM-005)                         | M  |
| <b>Optional Face Material</b>          |    |
| brushed aluminum (CM-012)              | A  |
| brushed rose gold (CM-046)             | G  |
| brushed brass (CM-047)                 | R  |
| carrara marble (CM-078)                | C  |
| none (leave blank)                     |    |
| <b>Lamping</b>                         |    |
| 2700 K LED                             | 27 |
| 3500 K LED                             | 35 |
| <b>Driver</b>                          |    |
| 120-277 V AC input voltage             | P1 |
| 0-10V dimming                          |    |
| TRIAC and ELV dimming at 120 V AC only |    |
| <b>Includes</b>                        |    |
| frosted polymer (CM-024)               |    |

J-box centered behind fixture

**WOOD BODY AND OPTIONAL FACE MATERIALS**

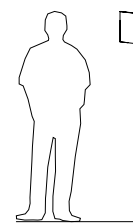
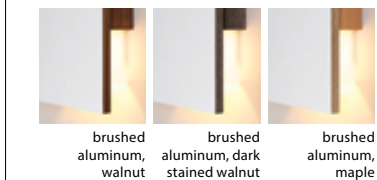
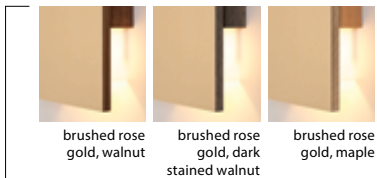

The Tersus is an example of the simplest form unlocking a myriad of design possibilities. The long reaching light pattern cast on the wall coupled with the numerous finishes and materials offered makes the Tersus well versed for all kinds of compositions and applications.

Nick Sheridan  
Designer



Tersus, walnut, carrara marble

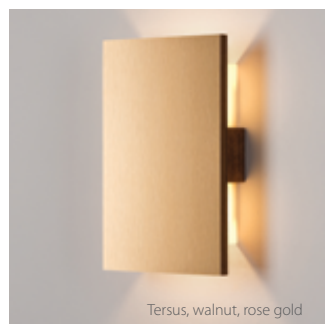

Tersus, walnut, rose gold

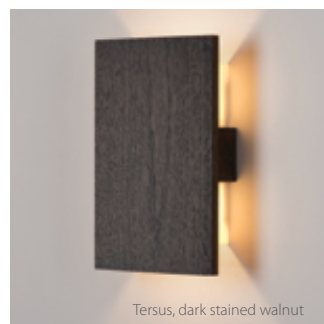

Tersus, dark stained walnut

**Sedo**  
sconce

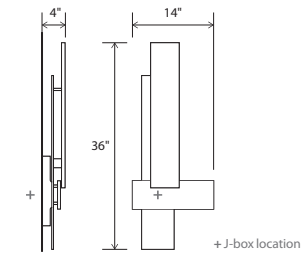

Dimensions: 36" x 14" x 4"  
 Materials: solid wood, polymer  
 Product weight: 6 lbs  
 Light source: integrated LED  
 Light output: 1130 Lumens (source)  
 Light color: 2700 K or 3500 K  
 Color accuracy: 90+ CRI  
 Power usage: 13 W  
 Dimmable (see driver below)  
 ADA compliant hotel room signage with tactile numbering and corresponding braille available  
 Wood grain will vary  
 Specifications subject to change



**MATERIAL & FINISH OPTIONS**

Sedo part # 03-133-

|  |    |
|--|----|
| <b>Wood Body</b>                       | W  |
| walnut (CM-001)                        | W  |
| dark stained walnut (CM-002)           | D  |
| <b>Lamping</b>                         |    |
| 2700 K LED                             | 27 |
| 3500 K LED                             | 35 |
| <b>Driver</b>                          |    |
| 120-277 V AC input voltage             | P1 |
| 0-10 V dimming                         |    |
| TRIAC and ELV dimming at 120 V AC only |    |
| <b>Includes</b>                        |    |
| frosted polymer (CM-024)               |    |



Sedo, walnut

The Sedo is composed of just three floating planes all kept parallel to the wall. This simple composition cloaks the light engine from view and filters the light as it is delivered far up and down the wall. It's this wall grazing and diffuser glow that gives the Sedo a strong architectural presence.

Nick Sheridan  
Designer

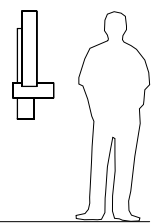

Emergency backup option available upon request, requires oversized J-box.





Ansa, distressed brass



Ansa, distressed brass



brushed aluminum brushed brass distressed brass oiled bronze

**Ansa**  
sconce

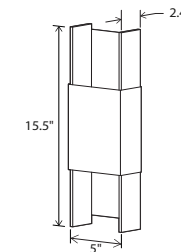

Dimensions: 15.5" x 5" x 2.4"  
 Materials: metal, polymer  
 Product weight: 3 lbs  
 Light source: integrated LED  
 Light output: 1130 Lumens (source)  
 Light color: 2700 K or 3500 K  
 Color accuracy: 90+ CRI  
 Power usage: 13 W  
 Dimmable (see driver below)  
 Specifications subject to change



**MATERIAL & FINISH OPTIONS**

|  |    |
|--|----|
| Ansa part # 03-137 -                   |    |
| <i>Body</i>                            |    |
| brushed aluminum (CM-006)              | A  |
| brushed brass (CM-008)                 | R  |
| distressed brass (CM-009)              | D  |
| oiled bronze (CM-010)                  | Z  |
| <i>Lamping</i>                         |    |
| 2700 K LED                             | 27 |
| 3500 K LED                             | 35 |
| 120-277 V AC input voltage             |    |
| 0-10V dimming                          |    |
| TRIAC and ELV dimming at 120 V AC only | P1 |

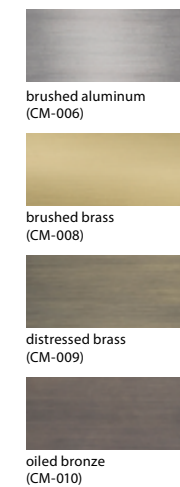

*Includes*  
 frosted polymer (CM-024)  
 J-box centered behind fixture

*The Ansa is a simple form that has been detailed and executed without compromise. The robust metal collar broadly trains the light while the light diffusing blades closely attenuate the wash pattern on the wall, yielding a simple and sophisticated feel.*

Nick Sheridan  
 Designer

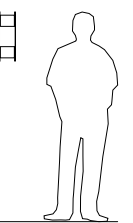



in collaboration with  
**DESIRON FRANK CARFARO**  
HAND CRAFTED AMERICAN FURNITURE

**Fortis**  
sconce

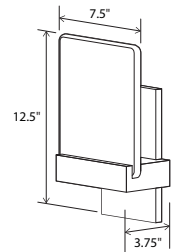

Dimensions: 12.5" x 7.5" x 3.75"  
Materials: solid wood, metal,  
artisan glass option, marble option  
Product weight: 10 lb  
Light source: integrated LED  
Light output: 565 Lumens (source)  
Light color: 2700 K or 3500 K  
Color accuracy: 90+ CRI  
Power usage: 7 W  
Dimmable (see driver below)  
Wood grain, bubbles in glass, and stone will vary  
Specifications subject to change



MATERIAL & FINISH OPTIONS

Fortis part # 03-170-

| Metal Finish                                  |    |
|---|----|
| brushed brass (CM-008)                        | R  |
| distressed brass (CM-009)                     | D  |
| oiled bronze (CM-010)                         | Z  |
| brushed aluminum (CM-006)                     | A  |
| Wood Finish                                   |    |
| walnut (CM-001)                               | W  |
| dark stained walnut (CM-002)                  | D  |
| Diffuser                                      |    |
| artisan bubble glass (CM-059)                 | B  |
| carrara marble (CM-078)                       | C  |
| Lamping                                       |    |
| 2700 K LED                                    | 27 |
| 3500 K LED                                    | 35 |
| Driver  |    |
| 120 V AC input voltage<br>TRIAC & ELV dimming | P1 |
| 277 V AC input voltage<br>0-10V dimming       | P2 |

J-box centered behind metal plate

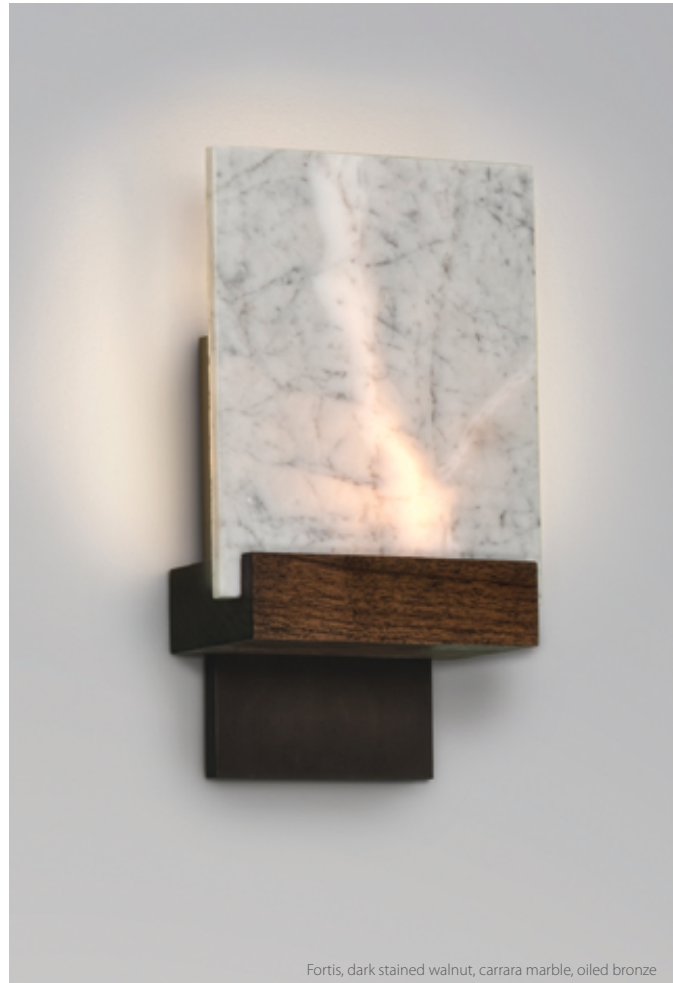

The Fortis wall sconce is a great example of the collaborative design process. The initial concept from the New York based Desiron was refined over many iterations. We then worked with the local Southern California artisan glass company Siemon & Salazar to achieve a very specific bubbled glass lens that diffuses the light. It is a strong and sophisticated display of three elements: a piece of metal, a piece of wood, and a piece of glass all beautifully showcased in light.

Nick Sheridan  
Co-Designer

**Claudo**  
sconce

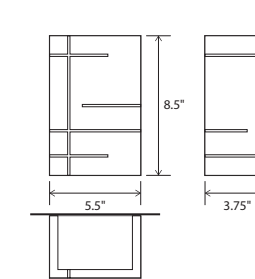

Dimensions: 8.5" x 5.5" x 3.75"  
Materials: solid wood, polymer  
Product weight: 4 lb  
Light source: integrated LED  
Light output: 1130 Lumens (source)  
Light color: 2700 K or 3500 K  
Color accuracy: 90+ CRI  
Power usage: 13 W  
Dimmable (see driver below)  
Wood grain will vary  
Specifications subject to change



MATERIAL & FINISH OPTIONS

Claudo sconce part # 03-150-

| Wood Body  |    |
|--|----|
| walnut (CM-050)  | W  |
| dark stained walnut (CM-002)   | D  |
| Lamping  |    |
| 2700 K LED   | 27 |
| 3500 K LED   | 35 |
| Driver   |    |
| 120-277 V AC input voltage<br>0-10V dimming<br>TRIAC and ELV dimming at<br>120 V AC only | P1 |

Includes  
frosted polymer (CM-024)

J-box centered behind fixture  
Also available in a pendant version, see page 41



The Claudio sconce showcases the beautiful natural walnut wood grain and sets it against the rigorous slits cut in each face as they wrap around the simple, clean shade form. A beautiful glow emanates from each slit, showing the striking rectilinear composition, in which all three sides are unique.

Nick Sheridan  
Designer

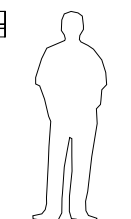
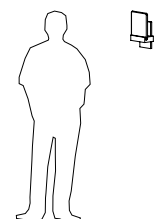



**Cubo**  
bedside wall sconce/reading lamp hybrid

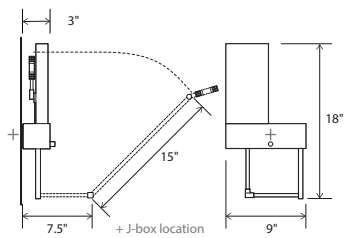

Dimensions: 18" x 9" x 3", 22.5" articulating arm  
 Materials: solid wood, aluminum, polymer  
 Product weight: 3 lb  
 Full arm and light head articulation  
 Light source: integrated LED  
 Light output: 345 Lumens (source)  
 Light color: 2700 K  
 Color accuracy: 90+ CRI  
 Power usage: 3.2 W  
 Dimmable on fixture  
 Input voltage: 12 V DC (adapter included)  
 Hardwired and corded versions available  
 Hardwired model includes an external power adapter (3" x 1.63" x 1.25")  
 Requires space in J-box for included power adapter  
 Wood grain will vary  
 Specifications subject to change



**OPTIONS**

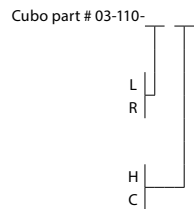

**Includes**  
 solid walnut body (CM-001)  
 aluminum arms (CM-006)  
 frosted polymer shade

Alternate voltage / plug styles available

\*Hardwired installation uses a standard 3" round plaster ring and requires room in the j box for the included external power supply. Get installation instructions at [www.cernogroup.com](http://www.cernogroup.com)

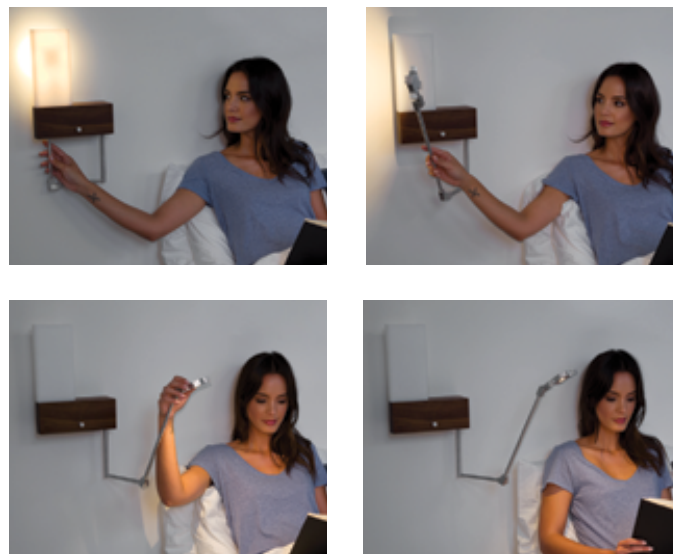
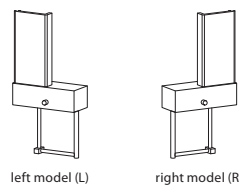

*Necessity is the mother of invention, and in this case illuminated activities in bed need highly controlled light — provided here without compromise, while still delivering a simple, clean wall sconce with ambient light — all in one fixture! — and it leaves your nightstand clutter free! Now that is modern.*

Nick Sheridan  
Designer

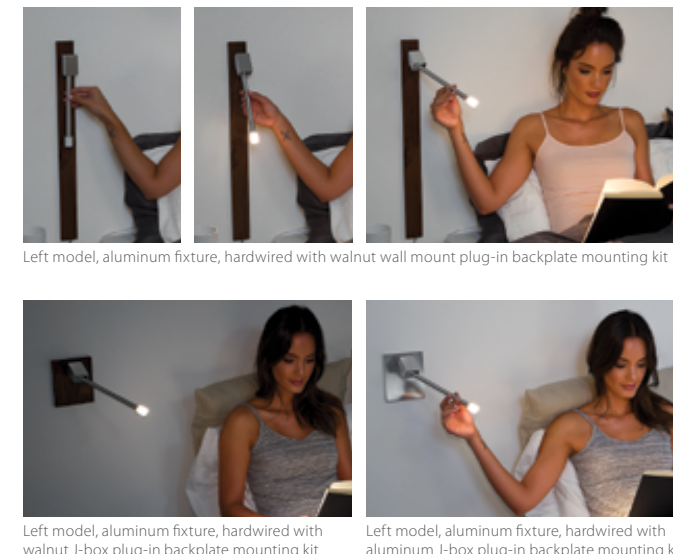

**Libri**  
bedside sconce reading light

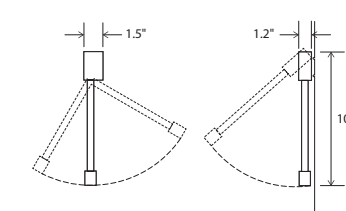

Dimensions: 10.5" x 1.5" x 1.2"  
 Materials: aluminum, polymer, optional solid wood mounting  
 Product weight: 1 lb  
 Light source: integrated LED  
 Light output: 160 Lumens (source)  
 Light color: 2700 K  
 Color accuracy: 90+ CRI  
 Power usage: 2 W  
 Automatic ON/OFF when arm is pulled away from wall  
 Specifications subject to change



**MATERIAL & FINISH OPTIONS**

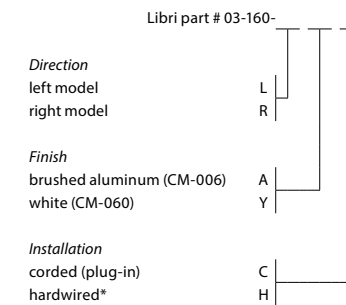

Alternate voltage / plug styles available  
 J-box centered behind fixture

**DIRECTION**

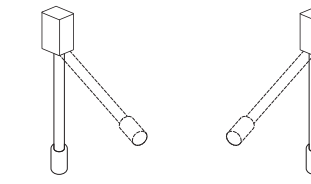

**INSTALLATION**

\*Hardwired installation requires room in the J-box for the included external power adapter (2" x 1" x 1.25"). Typically mounting kit is used. See mounting options on this page

**MOUNTING OPTIONS**  
 Mounting kits are sold separately from the Libri fixture.  
 No Mounting kit is required if the Libri fixture is to be installed using the Direct Mount option.

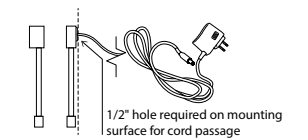

**Direct Mount**  
 Direct mount option is used when mounting directly to a headboard. There is no backplate and the cord must be fed through a hole in the headboard directly behind where the fixture is mounted and plugged into a wall outlet using the included AC adapter.

**Libri Mounting Kit**  
sconce backplate

**J-box Backplate: Mounting Kit (3)**  
 J-box backplate is typically used when mounting to a J-box. Hardwired installation requires room in the J-box for the included external power adapter (2" x 1" x 1.25").

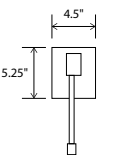

**Wall Mount Plug-in Backplate: Mounting Kit (1, 2)**  
 Wall mount plug-in backplate is used when mounting directly to the wall and plugging into a wall outlet. The wall mount is an elongated rectangle that allows the cord to exit discreetly below the fixture.

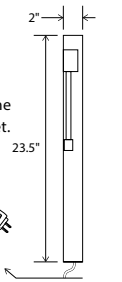

**MOUNTING KIT OPTIONS**

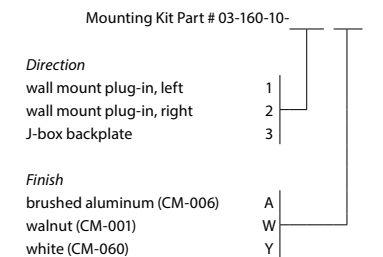

*The Libri is about function and ease: an extremely articulate directional task light in a discrete and sturdy form that is very intuitive to use.*

Nick Sheridan,  
Designer





Levo, walnut

REDDYMADE ARCHITECTURE AND DESIGN



Levo, right model

**Levo**  
bedside wall sconce/reading  
lamp hybrid with USB charger

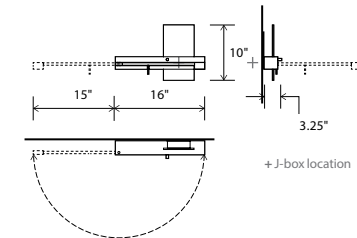

Dimensions: 10" x 16" x 3.25"  
 Materials: solid wood, aluminum, polymer  
 Product weight: 3 lb  
 Light source: 2x integrated LED  
 Static sconce light + swing arm with rotating head light  
 Light output of static sconce source: 565 Lumens (source)  
 Light output of swing arm source: 160 Lumens (source)  
 Light color: 2700 K  
 Color accuracy: 90+ CRI  
 Power usage: 20 W total (10 W USB charger)  
 USB charge current: 2 A  
 Fully dimmable static sconce light with Automatic ON/OFF swing arm light source  
 Swing arm light is not dimmable  
 Input voltage: 12 V DC (adapter included)  
 Hardwired and corded versions available  
 Hardwired model includes an external power supply (2.75" x 1.63" x 1.13")  
 Requires space in J-box for included power adapter  
 Alternate voltage/plug styles available  
 Hardwired adapter input voltage: 120-277 V AC  
 Corded adapter input voltage: 120 V AC  
 Wood grain will vary  
 Specifications subject to change



**MATERIAL & FINISH OPTIONS**

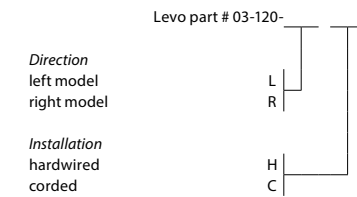

Includes  
solid walnut body (CM-001)  
brushed aluminum (CM-006)  
frosted polymer (CM-024)

Alternate voltage / plug styles available

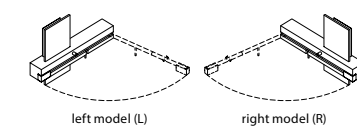

**Levo Shelf Option**



Levo, right model with shelf option

The introduction of the optional shelf for the Levo increases the utility of this fixture without compromising any aspect of the design. The shelf provides a perfect place to rest your phone or tablet while charging it. It is important to note that shelf is purchased separately from the Levo and can be retrofitted on existing Levos.

**MATERIAL & FINISH OPTIONS**

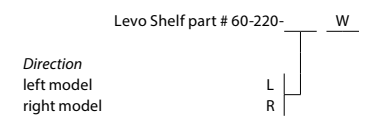

Includes  
solid walnut shelf (CM-001)  
brushed aluminum (CM-006)

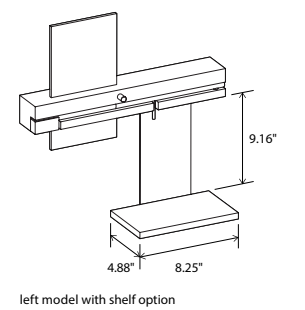

The goal for the Levo was to create a bedside wall fixture with great task lighting articulation that was intuitive enough to be used without prior knowledge of the fixture: all the while making it slender, sexy, and very robust.

Nick Sheridan,  
Designer

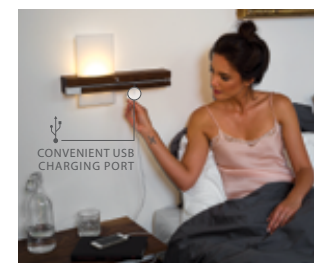
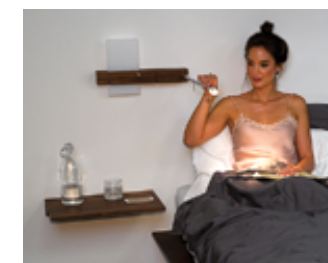



## Table



Forma



Nauta



Silva



Macto





in collaboration with  
**DESIRON FRANK CARFARO**  
HAND CRAFTED AMERICAN FURNITURE

**Forma Table**  
desk/table

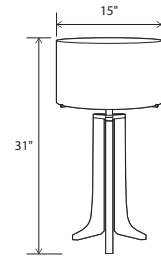

Dimensions: 15" Ø shade, 31"  
Materials: solid wood, aluminum, fabric shade  
Product weight: 10 lb  
Light source: medium base E26 socket  
Lamping: E26 base, type A lamp, 60 W max  
Input voltage: 120 V AC max  
Dimmable on fixture  
Wood grain will vary  
Specifications subject to change

Included dimmable LED A19 bulb  
Light output: 800 Lumens (source)  
Light color: 2700 K  
Color accuracy: 90+ CRI  
Power usage: 11 W

MATERIAL & FINISH OPTIONS

Forma Table part # 02-150-

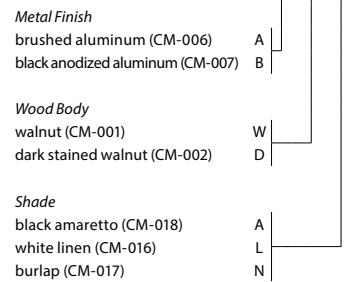

Alternate voltage / plug styles available  
Also available as a Floor Lamp, See page 16



Forma Table, walnut, black anodized aluminum, white linen



Being our most traditional fixture, Frank Carfaro and I worked to design a piece that embraced both Cerno and Desiron's aesthetic, without deviating too much from either brand's design language. I am really pleased with the fluidity, posture and scale we achieved with the Forma table, and its likeness to the Forma floor lamp.

Nick Sheridan  
Co-Designer

**Nauta Table**  
desk/table

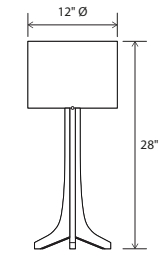

Dimensions: 12" Ø, 28"  
Materials: solid wood, aluminum, fabric shade  
Product weight: 3 lb  
Light source: medium base E26 socket  
Lamping: E26 base, 60 W max  
Input voltage: 250 V AC max  
Includes 8' clear silver cord with white plug  
On/Off rocker switch on socket  
Wood grain will vary  
Specifications subject to change

Included dimmable LED A19 bulb  
Light output: 800 Lumens (source)  
Light color: 2700 K  
Color accuracy: 90+ CRI  
Power usage: 11 W

MATERIAL & FINISH OPTIONS

Nauta Table part # 02-160-

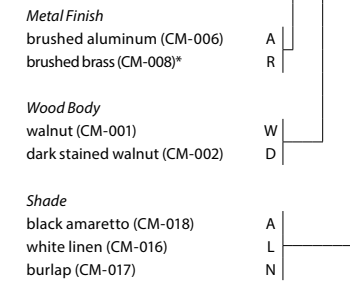

\*Brass shade support arms feature wood plug in end of arm

in collaboration with  
**DESIRON FRANK CARFARO**  
HAND CRAFTED AMERICAN FURNITURE



walnut, brushed brass, burlap

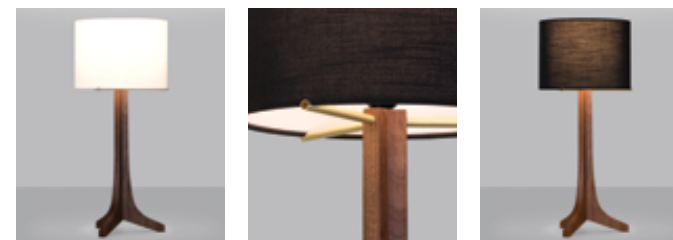

Efficiency and simplicity guided the design process for the Nauta table lamp. We designed the Forma several years ago with Frank Carfaro of Desiron, which profoundly influenced the Nauta's form. Our goal was to distill the Forma design without compromising it. The Nauta is clean, modern, and priced competitively.

Nick Sheridan  
Designer

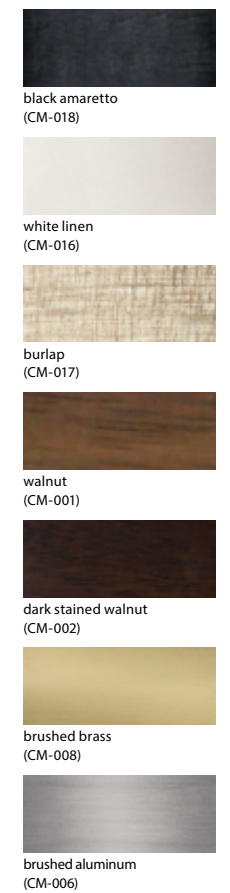



**Silva**  
desk/table

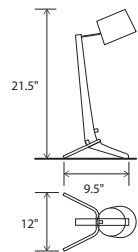

Dimensions: 12" x 9.5", 21.5"  
 Materials: solid wood, aluminum, bent shade  
 Articulating head  
 Product weight: 2 lb  
 Light source: integrated LED  
 Light output: 565 Lumens (source)  
 Light color: 2700 K  
 Color accuracy: 90+ CRI  
 Power usage: 7 W  
 Input voltage: 12V DC (adapter included)  
 White braided cord  
 Dimmable on fixture  
 Wood grain will vary  
 Specifications subject to change



**MATERIAL & FINISH OPTIONS**

Silva part # 02-100- A

- |                              |   |
|------------------------------|---|
| <b>Metal Finish</b>          | A |
| brushed aluminum (CM-006)    |   |
| <b>Wood Body</b>             |   |
| walnut (CM-001)              | W |
| dark stained walnut (CM-002) | D |
| <b>Bent Shade</b>            |   |
| beech wood veneer (CM-019)   | B |
| ebony eco veneer (CM-020)    | E |
| white linen (CM-058)         | L |

Alternate voltage / plug styles available  
 Also available in two larger versions



Silva Table, walnut, white linen



The structural connection between metal and wood was the inspiration here, where the fixture's stance is only strengthened by gravity. The tri-leg base finds stability on uneven surfaces and allows the cord to exit discreetly and effectively. It feels signature and iconic while still keeping a clean and timeless modern aesthetic.

Nick Sheridan  
 Designer

**Macto**  
desk/task

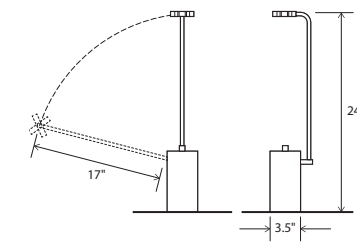

Dimensions: 3.5" x 3.5", 17" arm reach  
 Materials: solid wood, aluminum arm  
 Product weight: 5 lb  
 Light source: integrated LED  
 Light output: 345 Lumens (source)  
 Light color: 2700 K  
 Color accuracy: 90+ CRI  
 Power usage: 3.2 W  
 Input voltage: 12V DC (adapter included)  
 Black braided cord  
 Dimmable on fixture  
 Wood grain will vary  
 Specifications subject to change



**MATERIAL & FINISH OPTIONS**

Macto part # 02-140- A

- |                              |   |
|------------------------------|---|
| <b>Metal Finish</b>          | A |
| brushed aluminum (CM-006)    |   |
| <b>Wood Body</b>             |   |
| walnut (CM-001)              | W |
| dark stained walnut (CM-002) | D |

Alternate voltage / plug styles available



Macto, walnut

The Macto showcases the breathtaking natural beauty of the solid walnut base. Only in a truly solid piece of wood can you see the fascinating way that the grain changes as it passes from face to face. Great reach and articulation make the Macto an extremely functional and versatile fixture: while its form and composition are kept remarkably simple.

Nick Sheridan  
 Designer







Artist: Roy Nachum

STACI RUIZ LIGHTING CONSULTANT PHOTO BY ARI BURLING



Guy Rose, Impressionist

**Revelite AL**  
art light

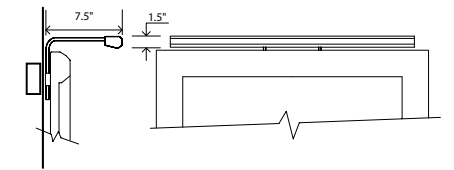

The Revelite AL brings art to life. A challenge resolved by a slim luminaire that discreetly and evenly illuminates an artwork surface with beautiful color rendering accuracy.

**CUSTOMIZED**

Each AL is custom built and factory calibrated for an artwork's specific dimensions, distributing even illumination across the full width and height of the surface.

**HIGH COLOR ACCURACY**

To accurately reflect the artist's vision, the LED light source was designed to provide full color spectrum lighting with a color rendering index over 90 and an R9 value of 83.

**ART SAFE**

Revelite AL's LED technology provides a much safer alternative to legacy sources that emit excessive and damaging UV and heat.

**LOW PROFILE**

The minimal form virtually disappears against the frame or wall and pairs well with various styles of art, including contemporary, photographs behind glass and more traditional works.

**VISIT**

[www.revelite.com](http://www.revelite.com) for detailed specifications and options.

US Patent # 7,070,293 and 9,134,004.

Other US and International Patents Pending.

*These lights revealed subtleties in paintings you just don't see with ordinary lights. I think we are seeing, truly for the first time, what the artist really wanted us to see.*

*Pat Trenton, Ph.D.*

*Art expert, curator and writer*



Wolfgang Bloch, Contemporary



Tom Lamb, Photograph (behind glass)



Accessories



Motus Swing Arm Bracket accessory

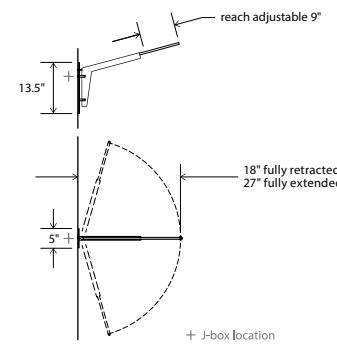

Dimensions: 18.38" x 5" x 26.8"  
 Materials: solid wood, metal  
 Product weight: 3 lb  
 Max suspension weight: 5 lb  
 Swing arm length can be adjusted from 18" to 27"  
 Max drop length from tip of extended arm to top of pendant is 36"  
 Swing arm rotation has adjustable resistance in pivot hinge  
 Wood grain will vary  
 Specifications subject to change  
 Patent No. : US D846,180 S

MATERIAL & FINISH OPTIONS

Motus Swing Arm Bracket part # 60-210-

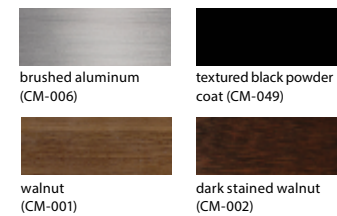

**Metal Finish**  
 brushed aluminum (CM-006)  
 textured black powdercoat (CM-049)

**Wood Body**  
 walnut (CM-001)  
 dark stained walnut (CM-002)

Please see the Talea on page 51

How it works: Build your own fixture

Pick one of the pendants listed below and pair it with the Motus Swing Arm Bracket for a unique and versatile light fixture. To order, you will need to select a SKU for the pendant that you choose and a SKU for the Motus Swing Arm Bracket. The SKU builder for the Motus Swing Arm Bracket is above, and the SKU builders for the pendants are located on their respective tear sheets.



Canopy Accessories



Multi-Point Round Canopy  
 For 3 accent pendants

Dimensions: 12"Ø, 1.25" H

MATERIAL & FINISH OPTIONS

12" Round Canopy part # 60-120-R

**Finish**  
 brushed aluminum (CM-006)  
 black anodized (CM-007)



Multi-Point Linear Canopy  
 For linear pendants or 2 or 3 accent pendants

Dimensions: 20.6" x 4", 1.3" H

MATERIAL & FINISH OPTIONS

Multi-Point Linear Canopy part # 60-130-

**Finish**  
 brushed aluminum (CM-006)  
 black anodized (CM-007)

**Number of Holes**  
 2 Holes (linear pendant) leave blank  
 3 Holes (pendant cluster)



Wood Canopy Cover

Fits over linear canopies except for Camur canopy (Camur wood canopy is on page 23)

Dimensions: 21" x 4.6", 1.75" H

MATERIAL & FINISH OPTIONS

Wood Canopy Cover part # 60-130-005

**Finish**  
 walnut (CM-001)  
 dark stained walnut (CM-002)

**Number of Holes**  
 2 Holes (linear pendant) leave blank  
 3 Holes (pendant cluster)

Finish and Material Options

Hard Surface Shade

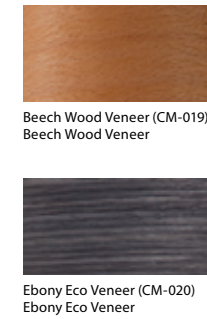

Fabric Shade

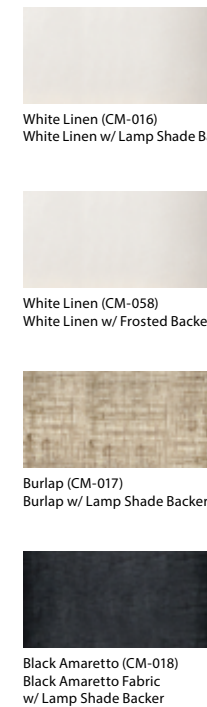

- Brushed Aluminum (CM-006)  
Brushed Aluminum
- Brushed Aluminum (CM-012)  
Brushed Anodized Aluminum Veneer
- Black Anodized Aluminum (CM-007)  
Black Anodized Aluminum
- Brushed Rose Gold (CM-046)  
Brushed Rose Gold Anodized Aluminum Veneer
- Brushed Brass (CM-047)  
Brushed Brass Anodized Aluminum Veneer
- Distressed Brass (CM-009)  
Distressed Brass - Patina
- Brushed Brass (CM-008)  
Brushed Brass
- Oiled Bronze (CM-010)  
Oiled Bronze - Patina
- Textured Black Powdercoat (CM-049)  
Textured Black Powdercoat
- Textured White Powdercoat (CM-060)  
Textured White Powdercoat
- Gloss White (CM-054)  
White Powdercoat Aluminum Sheet

Metal

Wood

- Walnut (CM-001)  
Solid Oiled Walnut
- Walnut (CM-055)  
Oiled Walnut Veneer
- Dark Stained Walnut (CM-002)  
Solid Dark Stained Oiled Walnut
- Dark Stained Walnut (CM-056)  
Dark Stained Oiled Walnut Veneer
- Double Dark Stained Walnut (CM-048)  
Solid Lacquered Double Dark Stained Walnut
- Maple (CM-005)  
Solid Oiled Maple
- White Washed Oak (CM-095)  
Solid White Washed Oak

Polymer

- Frosted Polymer (CM-051)  
Frosted White Polycarbonate
- Frosted Polymer (CM-057)  
Frosted Polycarbonate
- Frosted Polymer (CM-024)  
Frosted Acrylic
- Polymer (CM-052)  
Natural Polyethylene

Stone

Artisan Bubble Glass

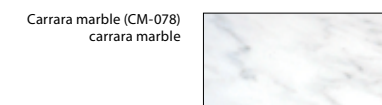

⚠️ **WARNING.** California Proposition 65 Warning for California Consumers. This product can expose you to chemicals including wood dust and lead which are known to the State of California to cause cancer or birth defects or other reproductive harm. For more information go to [www.P65Warnings.ca.gov](http://www.P65Warnings.ca.gov)



D E S I G N E D   A N D   M A D E   I N   C A L I F O R N I A



cerno®  
DESIGNED AND MADE IN CALIFORNIA

22892 GLENWOOD DRIVE, ALISO VIEJO, CA 92656 | 949.715.1534 | WWW.CERNOGROUP.COM