

Fons 8 / Fons 10
floor

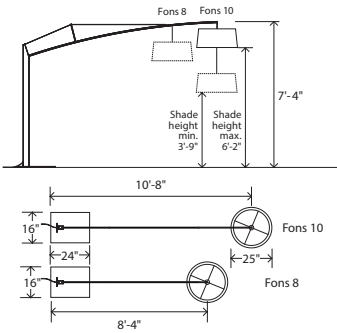

Dimensions: 7'-4" H max, 25" Ø shade
 Materials: solid wood, metal, linen shade
 Product weight: 65 lbs
 Input Voltage: 120VAC Max
 Universal medium base E26 socket 60W Max
 Included LED A19 bulb
 Light output: 800 Lumens
 Light color: 2700 K (warm)
 Color accuracy: 90+ CRI
 Power usage: 11W
 Dimmable (use TRIAC or ELV dimmer)
 Includes 72" clear silver cord with inline foot switch 24" from base.
 Bottom diffuser included
 Wood grain will vary
 Specifications subject to change



MATERIAL & FINISH OPTIONS

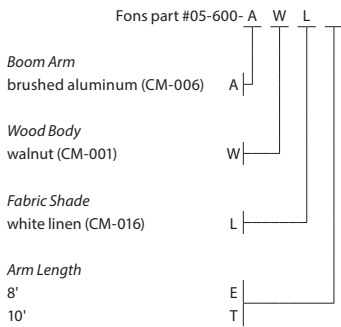

Includes
 stainless steel tension cable (CM-053)
 black powder coated steel base (CM-049)
 frosted polymer diffuser (CM-051)

Alternate voltage/plug styles are available



ARM LENGTH
 Available in 10'-8" and 8'-4" arm lengths
 Arm length is from back of base to center of shade
 Arm lengths are not adjustable

SHADE HEIGHT
 Shade height (floor to bottom edge of shade)
 can be adjusted between 6'-2" maximum and
 3'-9" minimum.

The goal with the Fons was to minimize the structure and visual massing of the fixture while maximizing the reach or cantilever. The delicate boom arm, upheld by a tension cable, gently bends while reaching out to almost horizontal where it suspends the light. The structural design is an extremely effective way to resolve the forces associated with such a long reach. It is so effective and efficient that it seems to float with a weightlessness at the tip.

Nick Sheridan
 Designer

