



walnut, brushed brass

Inspired by the Calx pendant, again here the materials and method inform the design greatly. While the Calx sconce is clean and simple, it also offers a beautiful texture and subtle complexity to a wall.

Nick Sheridan  
Designer



walnut and brushed brass

**Calx**  
sconce

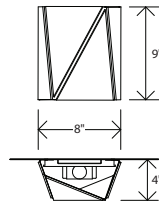

Dimensions: 8" x 9" x 4"  
 Materials: wood, metal  
 Product weight: 2 lbs  
 Energy efficient LED light source  
 Light output: 1130 Lumens (source)  
 Light color: 2700 K (warm) or 3500 K (cool)  
 Color accuracy: 90+ CRI  
 LED power consumption: 13W  
 Dimmable (see driver below)  
 Wood grain will vary  
 Specifications subject to change



**MATERIAL & FINISH OPTIONS**

Calx sconce part #03-138-

**Metal Finish**

- brushed aluminum (CM-012) A
- brushed rose gold (CM-046) G
- brushed brass (CM-047) R

**Wood Finish**

- walnut (CM-055) W
- dark stained walnut (CM-056) D

**Lamping**

- 2700 K LED 27
- 3500 K LED 35

**Driver**

- 120-277VAC input voltage
- 0-10V dimming
- TRIAC and ELV dimming at 120VAC only P1

Calx pendants also available



brushed aluminum  
(CM-012)



brushed rose gold  
(CM-046)



brushed brass  
(CM-047)



walnut  
(CM-055)

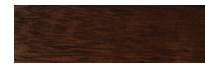

dark stained walnut  
(CM-056)

