

Acuo  
sconce

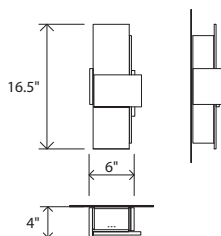

walnut  
(CM-001)

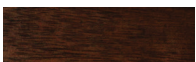

dark stained walnut  
(CM-002)



brushed aluminum  
(CM-006)

Dimensions: 16.5" x 6" x 4"  
 Materials: solid wood, polymer, aluminum  
 Product weight: 3 lbs  
 Energy efficient LED light source  
 Light output: 1130 Lumens (source)  
 Light color: 2700 K (warm) or 3500 K (cool)  
 Color accuracy: 90+ CRI  
 LED power consumption: 13W  
 Dimmable (see driver below)  
 ADA compliant hotel room signage with tactile numbering and corresponding braille available.  
 Wood grain will vary  
 Specifications subject to change



MATERIAL & FINISH OPTIONS

Acuo part #03-130-

<i>Body</i>	
walnut (CM-001)	W
dark stained walnut (CM-002)	D
brushed aluminum (CM-006)	A
<i>Lamping</i>	
2700 K LED	27
3500 K LED	35
<i>Driver</i>	
120 VAC input voltage	P1
TRIAC and ELV dimming	

*Includes*  
 frosted polymer (CM-024)

Emergency backup option available upon request,  
 requires oversized J-box.

J-box centered behind wood/aluminum body  
 GU-24 base version available upon request



brushed aluminum



walnut



brushed aluminum

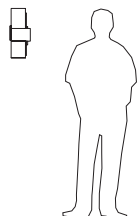

*It's a 3 sided box, which has been carefully deconstructed to a sculptural state. The careful composition of overlap and void create interest and complexity to a very straightforward, well-functioning wall sconce. The tectonic disconnection in form allows you to witness the solid American black walnut's grain as it travels through each solid block.*

Nick Sheridan  
 Designer